



INSTALLATION INSTRUCTIONS

PART NUMBER: 29-0008

2010-2013

Kia

Forte Koup L4-2.4L

PARTS LIST

Description	Qty.	Part Number
FRONT STRUT BAR, 2011 KIA FORTE KOUP PC	1	83044-PC
10mm washer	8	RHWA-M10

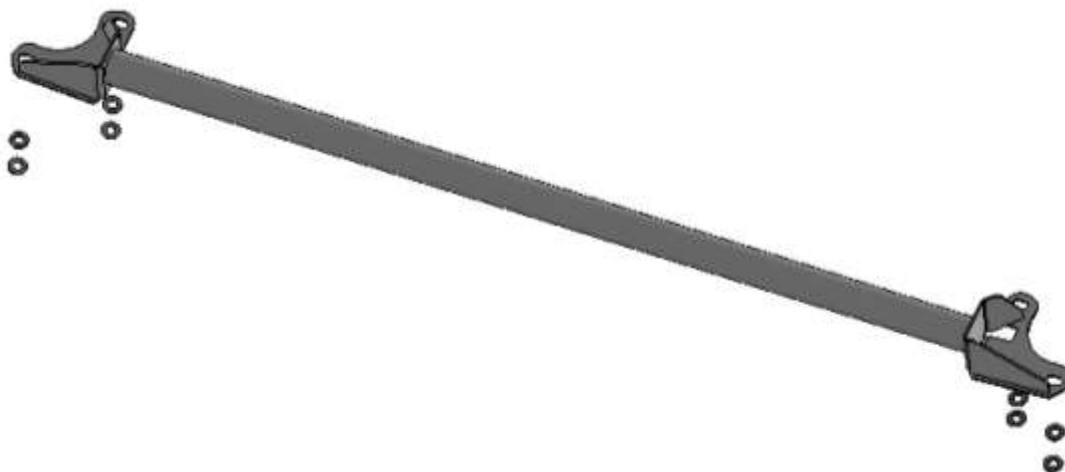

Read and understand these instructions **BEFORE** attempting to install this product. Failure to follow installation instructions and not using the provided hardware may damage the strut bar.

1. Preparing Vehicle

- a. Make sure vehicle is parked on a level surface.
- b. Do not lift car, make sure front wheels are on the ground
- c. Set parking brake.
- d. If engine has run in the past two hours, let it cool down.
- e. Do not discard stock components after removal of the factory system.

2. Removal of stock parts



- a. Remove the front and inside strut top nuts, that will be used to secure the AEM Strut Bar.

3. Installation of AEM Strut Bar



- a. Place two (2) included washers over each of the strut top studs, as shown.



- b. Place the AEM Strut Tower Bar over the strut top studs and washers, and replace the strut top nuts.

AEM Strut Tower Bar Warranty Policy

AEM® warrants that its Strut Tower Bars will last for the life of your vehicle. AEM will not honor this warranty due to mechanical damage (i.e. improper installation or fitment), damage from misuse, or accidents. AEM will not warrant its powder coating if the finish has been cleaned with a hydrocarbon-based solvent. The powder coating should only be cleaned with a mild soap and water solution. Proof of purchase of the AEM Strut Tower Bar is required for redemption of a warranty claim.

This warranty is limited to the repair or replacement of the AEM part. In no event shall this warranty exceed the original purchase price of the AEM part nor shall AEM be responsible for special, incidental or consequential damages or cost incurred due to the failure of this product. Warranty claims to AEM must be transportation prepaid and accompanied with dated proof of purchase. This warranty applies only to the original purchaser of product and is nontransferable. Improper use or installation, or an accident, abuse, unauthorized repairs or alterations voids this warranty. AEM disclaims any liability for consequential damages due to breach of any written or implied warranty on all products manufactured by AEM.

Warranty returns will only be accepted by AEM when accompanied by a valid Return Merchandise Authorization (RMA) number. Credit for defective products will be issued pending inspection. Product must be received by AEM within 30 days of the date RMA is issued.

If you have a warranty issue, please call (800) 992-3000 and our customer service department will assist you. A proof of purchase is required for all AEM warranty claims.

For technical inquiries e-mail us at sales@aemintakes.com or call us at 800.992.3000