

AMP RESEARCH Power Step

MADE IN USA

RUNNING BOARD TRIM STRIP

Requires New Twin Rib Extrusion

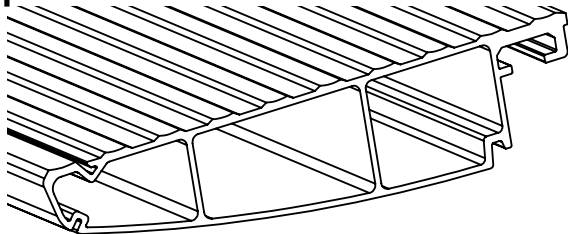

Trim Strip Part #

10-75148-01A

10-75149-90

10-75150-90

Board Length

72"

79"

85"

INSTALLATION TIME

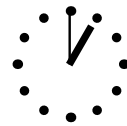

1:00 hr

SKILL LEVEL



2= Moderate

TOOLS REQUIRED

- Safety glasses
- 3/16 Allen
- Saw (some Applications)

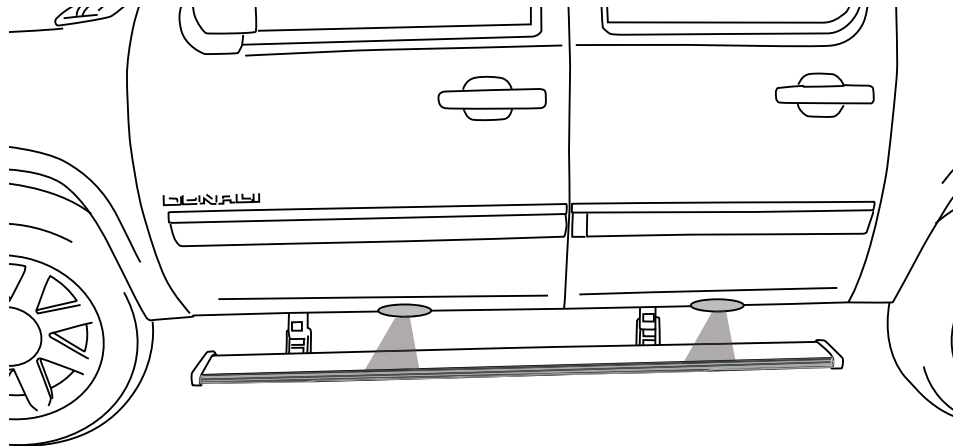

TECH SUPPORT 1-888-983-2204 (Press 2) Monday - Friday, 6:00 AM - 5:00 PM PST

Designed and manufactured by AMP Research. Patent 6,830,257 / 6,641,158 / 6,834,875 / 6,938,909 / 6,942,233 / 7,007,961 Other US and worldwide patents pending. 5-year limited warranty. Professional installation is recommended.

1 x2

10-75149-90 (79" Board)
10-75150-90 (85" Board)
Trim Strip

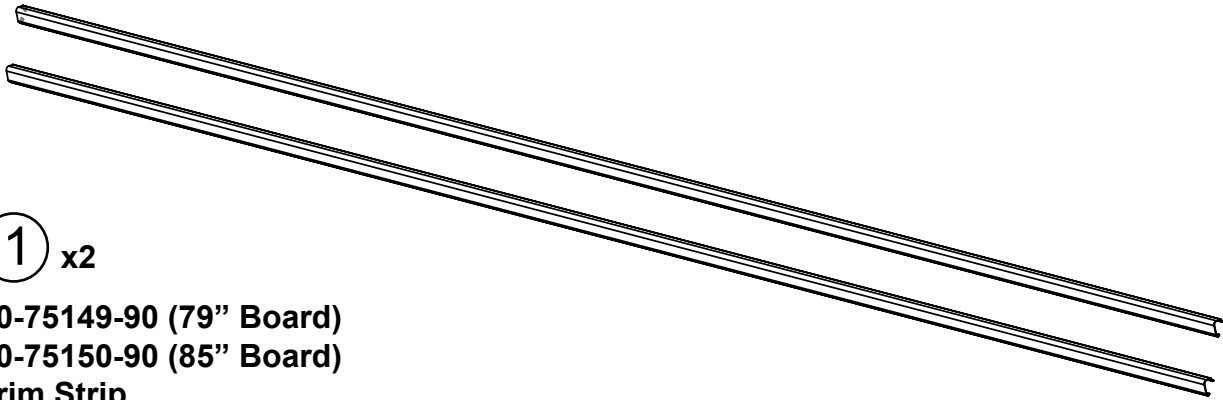

Using a 3/16" Allen head loosen screw on end cap.

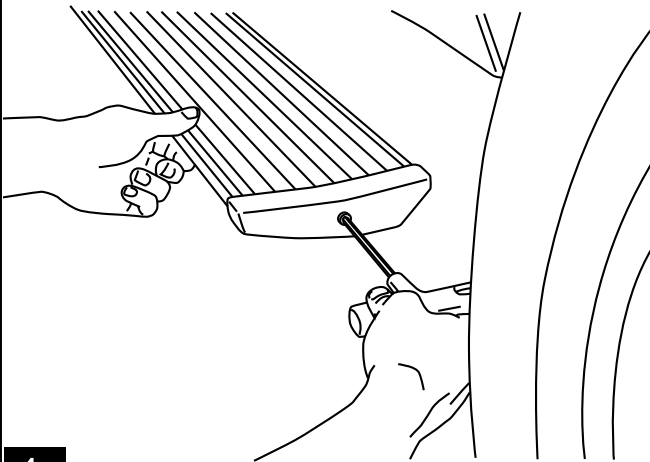

1

Remove end cap.

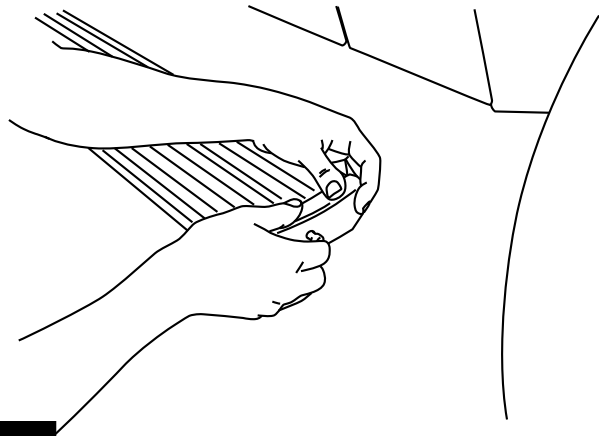

2

Peel off protective film on Trim Strip.

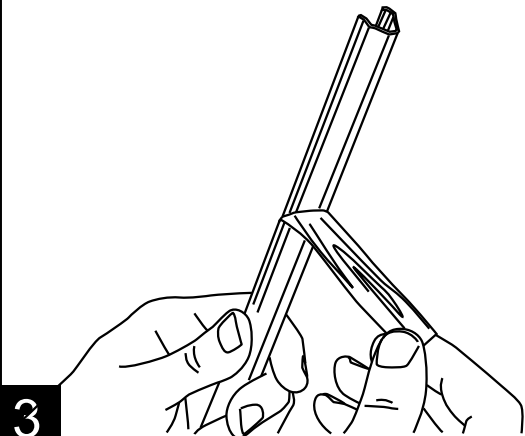

3

Line Trim Strip to the groove on the Running Board Extrusion. See Step 5 for proper Trim Strip engagement. **Caution: Trim Strip edges can be sharp.**

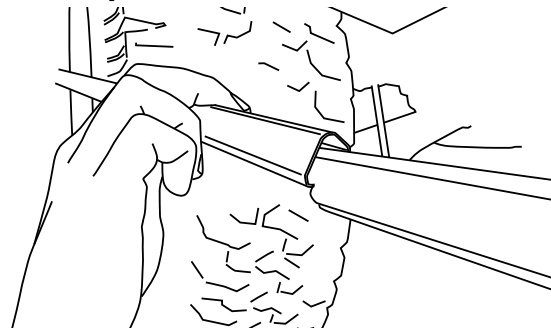

4

NOTE: Wheels may need to be adjusted to allow for clearance during install.

NOTE: Trim Strip should be lined up in both the upper and lower grooves.

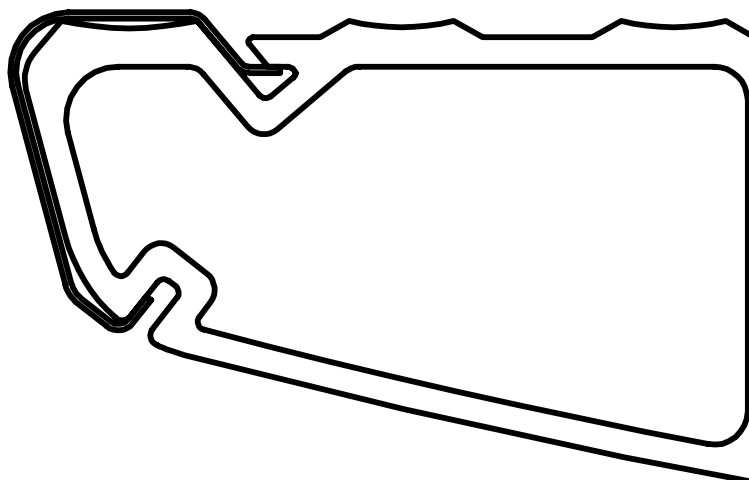

5

With Trim Strip lined up to the groove slide it onto Running Board and under the cap on the opposite end. **Ensure that the Trim Strip does not buckle during install.**
Caution: Trim Strip edges can be sharp.

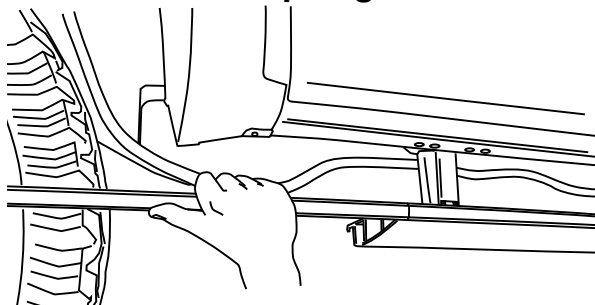

6

Once Trim Strip is installed verify that it is properly engaged along the Running Board.

Cutting may be required if your Running Board is less than 79". Excess material can be trimmed with a Hacksaw.

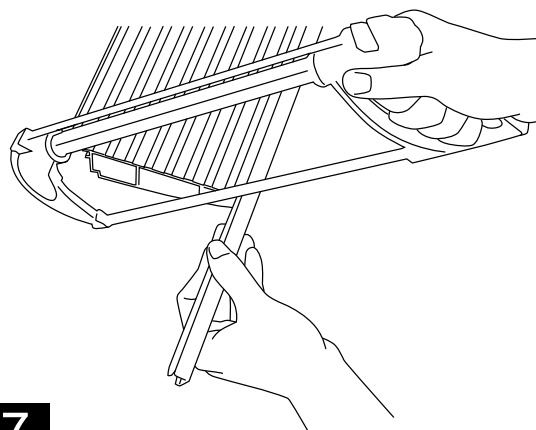

7

If End Cap wedge was completely removed reinstall onto End Cap.

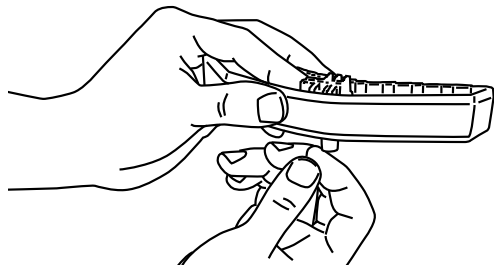

Wedge Orientation

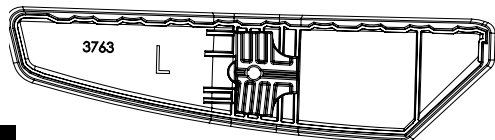

Note: Left and Right End Caps have matching Wedges.

8

Slide End Cap onto board.

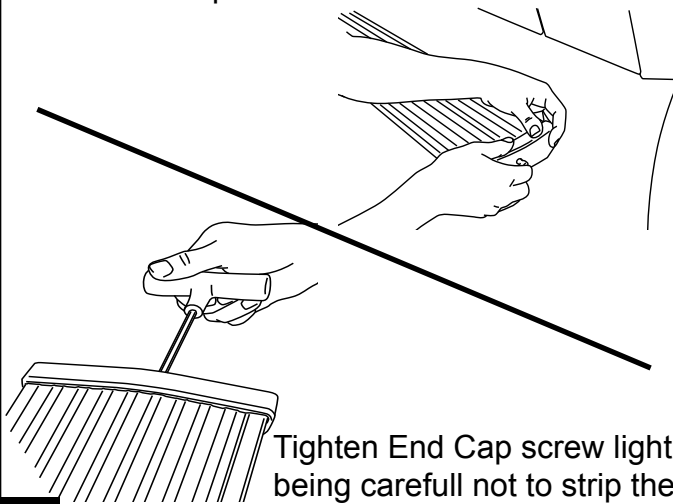

Tighten End Cap screw lightly being carefull not to strip the End Cap Wedge.

9