

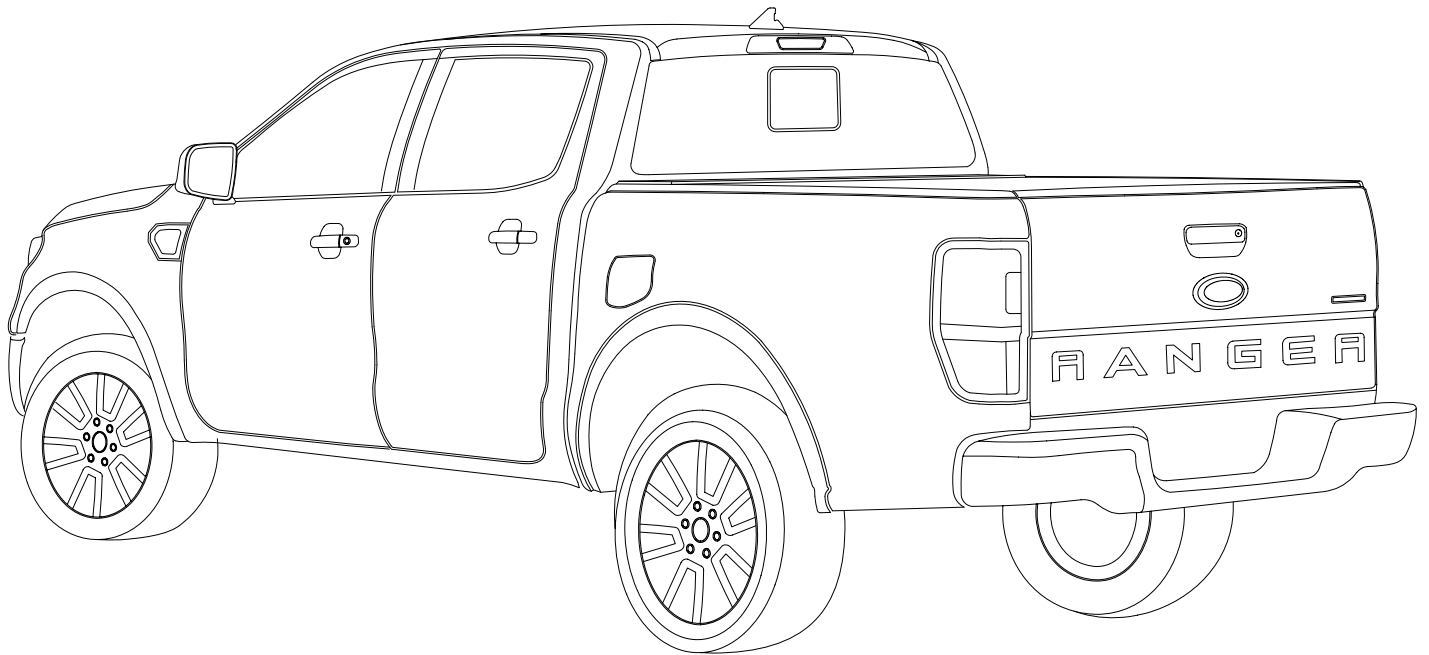

# Installation Guide 2019 Ford Ranger



Product Code  
122-123

# Parts List

Item	Part Name	Qty.	Item	Part Name	Qty.	Item	Part Name	Qty.
A	Housing	1	G	Cargo Nut	2	M	1/4-20 Lid Screw	2
B	Track	2	H	5/16-18 x 1" Cap Screw	6	N	1/4-20 x 1" Screw	2
C	Cargo Shield/Track spacer	1	I	5/16 Lock Washer	6	O	1/4-20 Nut	2
D	Bulkhead Flashing	1	J	Black Rubber Washer	4	P	Butyl Caulk Strip	2
E	Bed Clamp	6	K	1/4-20 x 3/8" Screw	4	Q	Allen Wrench (1/4")	1
F	#10-24 Screw	2	L	Drain Tube	2		303 Vinyl Protector	1

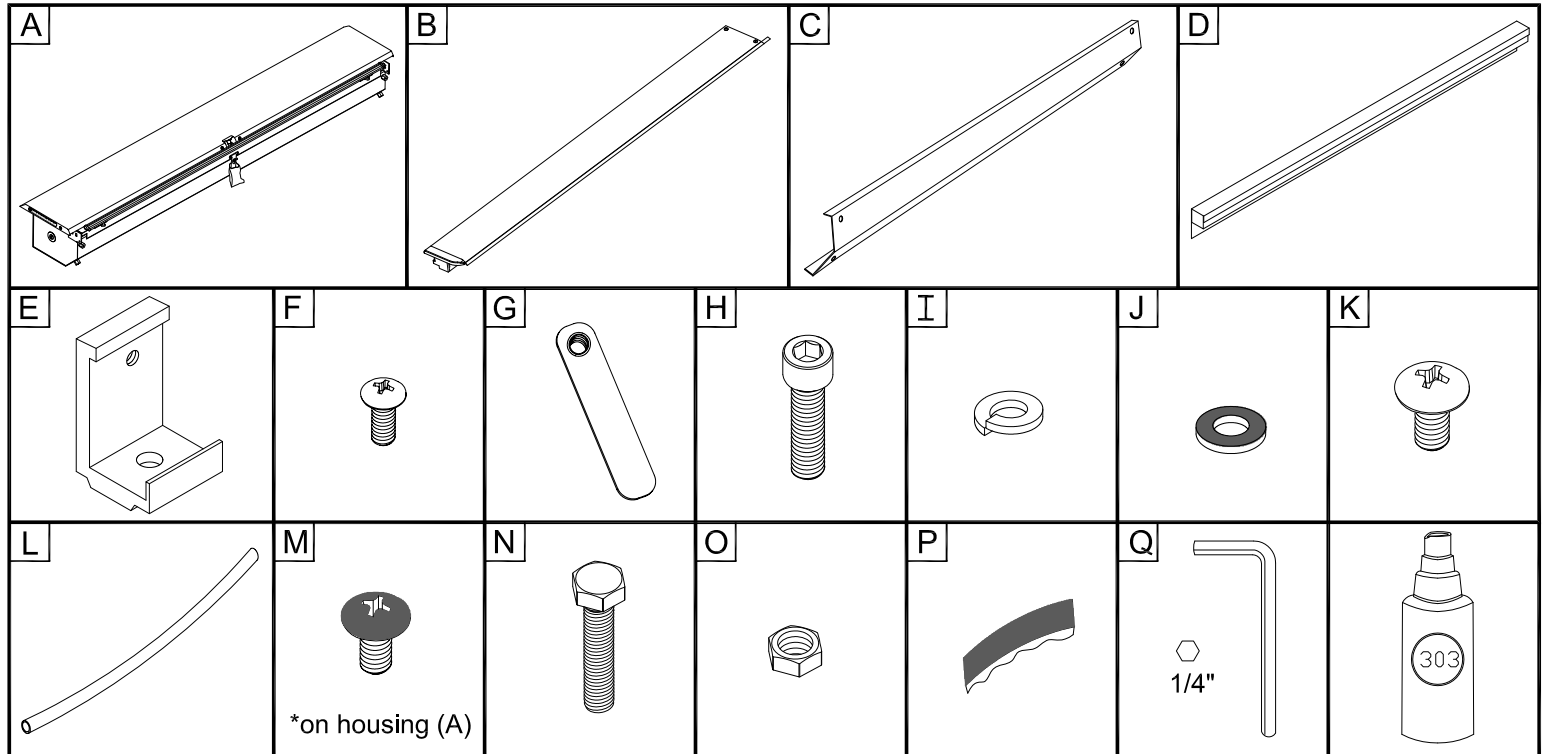

## Tools Needed

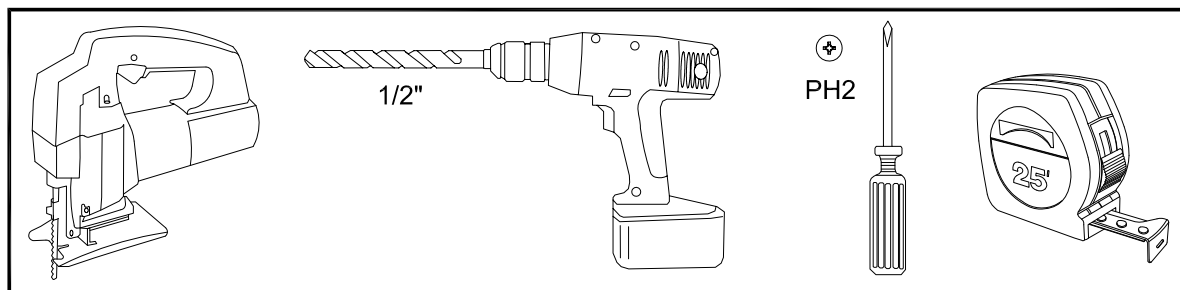

1a

If no plastic bedliner  
present proceed to  
page 4 - Step 1

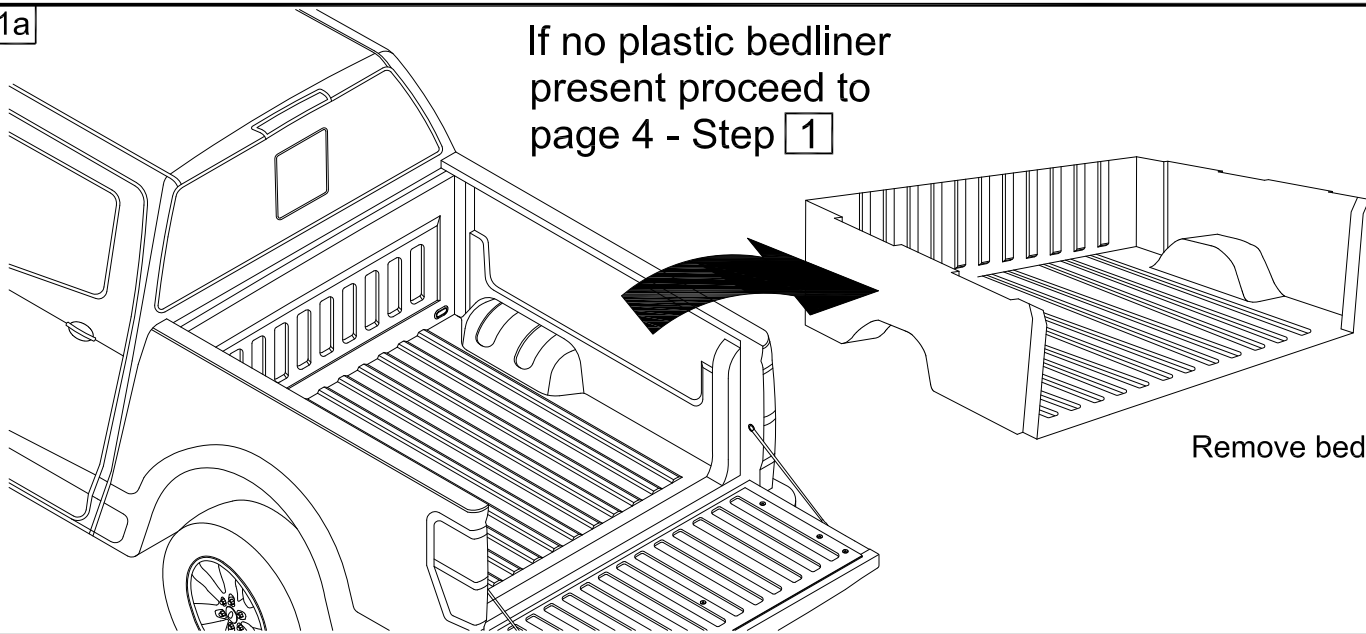

Remove bedliner

1b

Cut bedliner  
as shown.

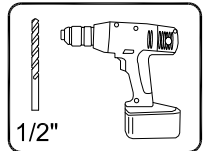
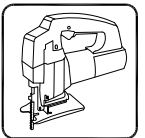
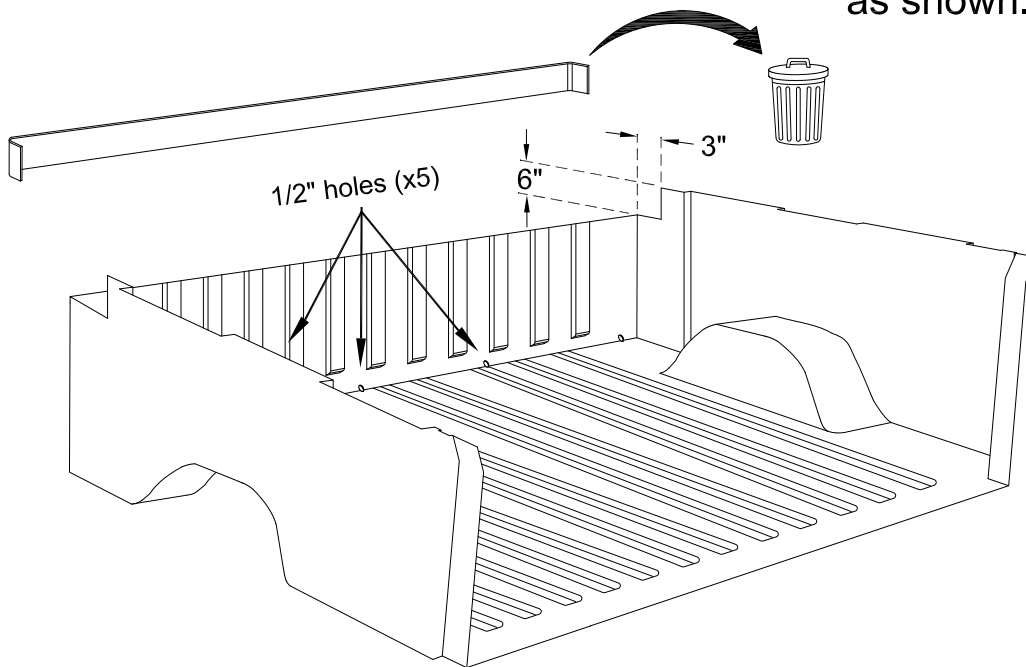

1c

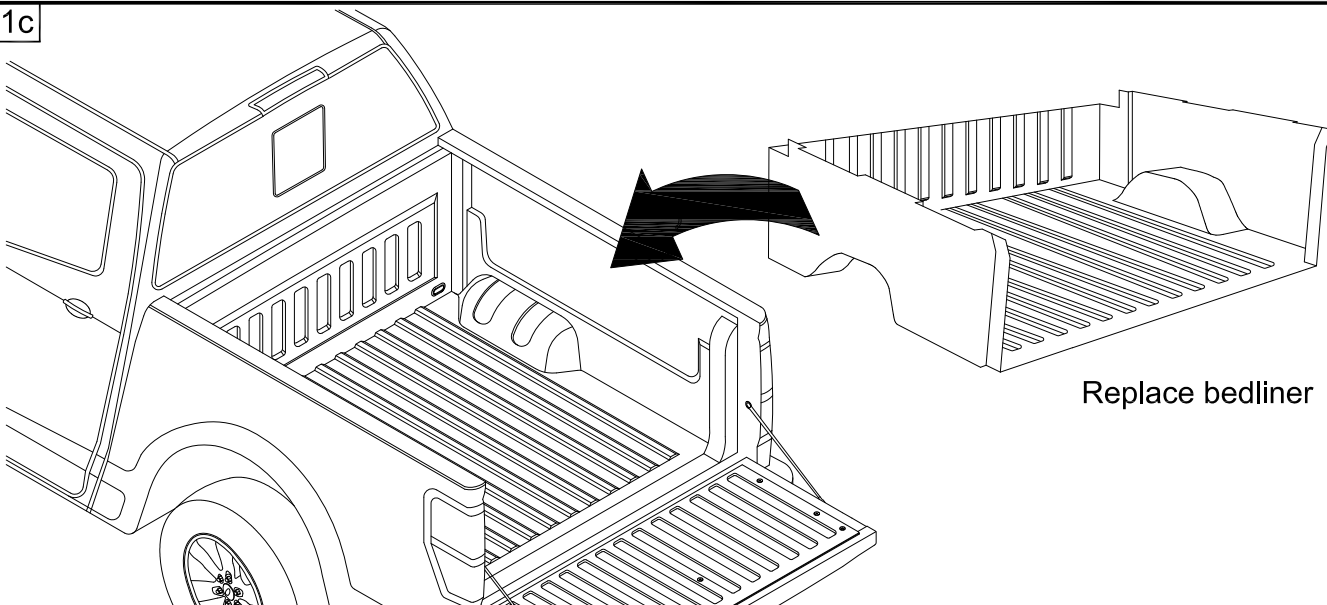

Replace bedliner

1 LHS = RHS

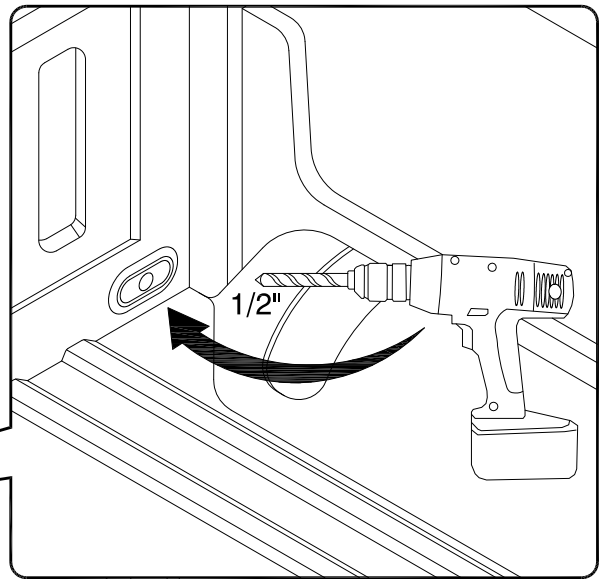

Drill 1/2" hole for  
Drain Tube.

2

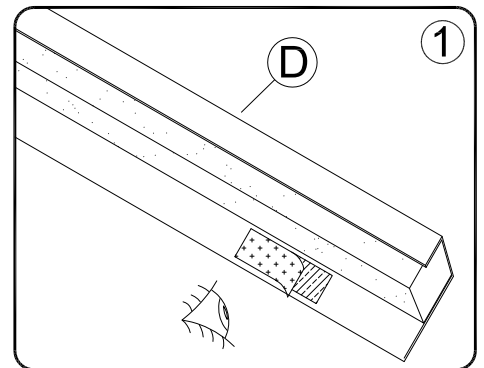
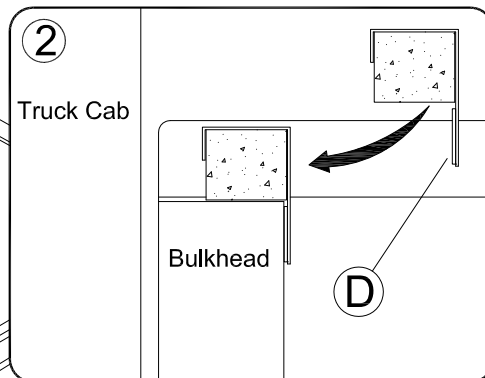

Peel paper from foam and stick  
Bulkhead Flashing **D** onto bulkhead.

3 LHS = RHS

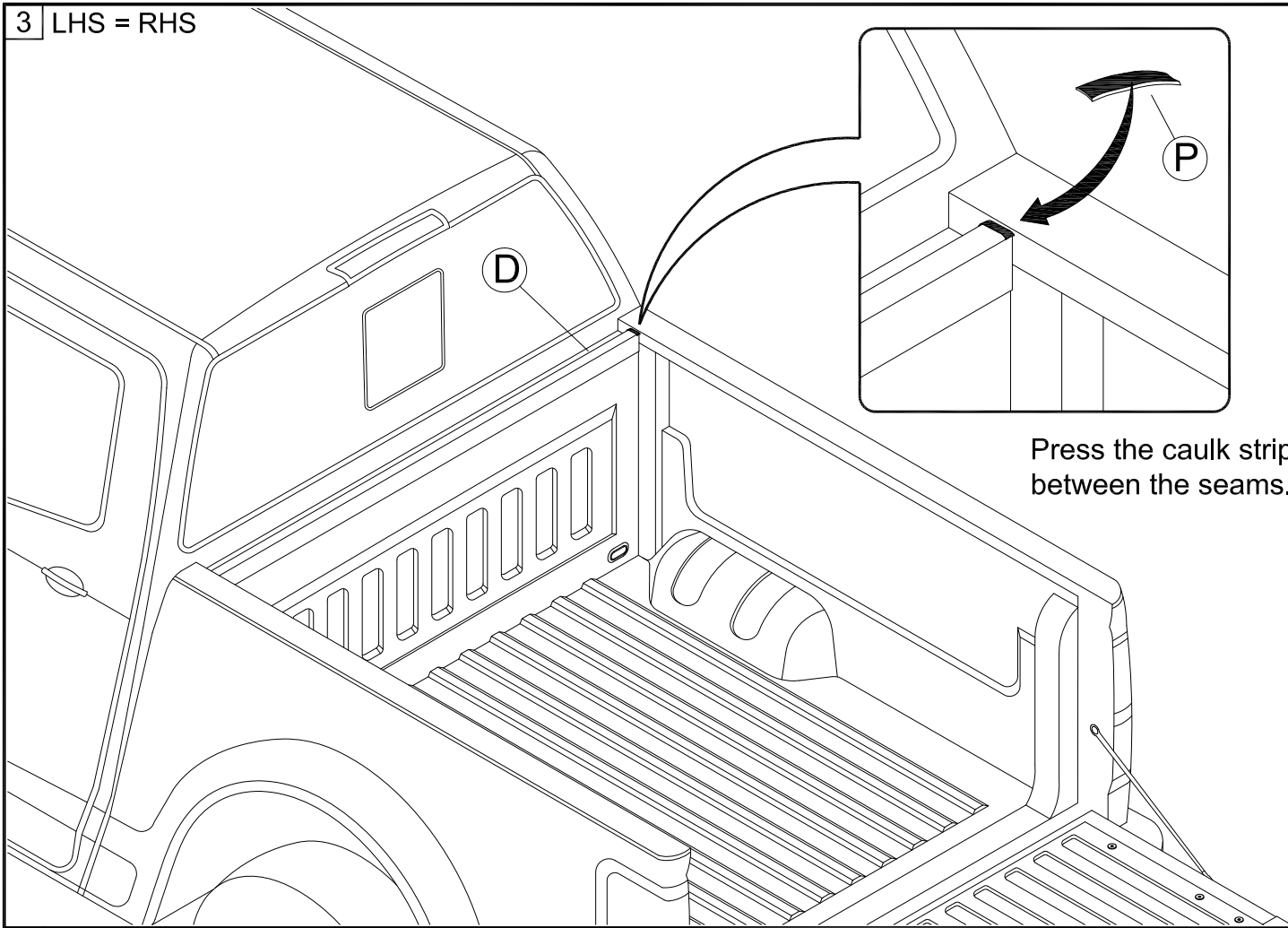

Press the caulk strip (P) between the seams.

4 LHS = RHS

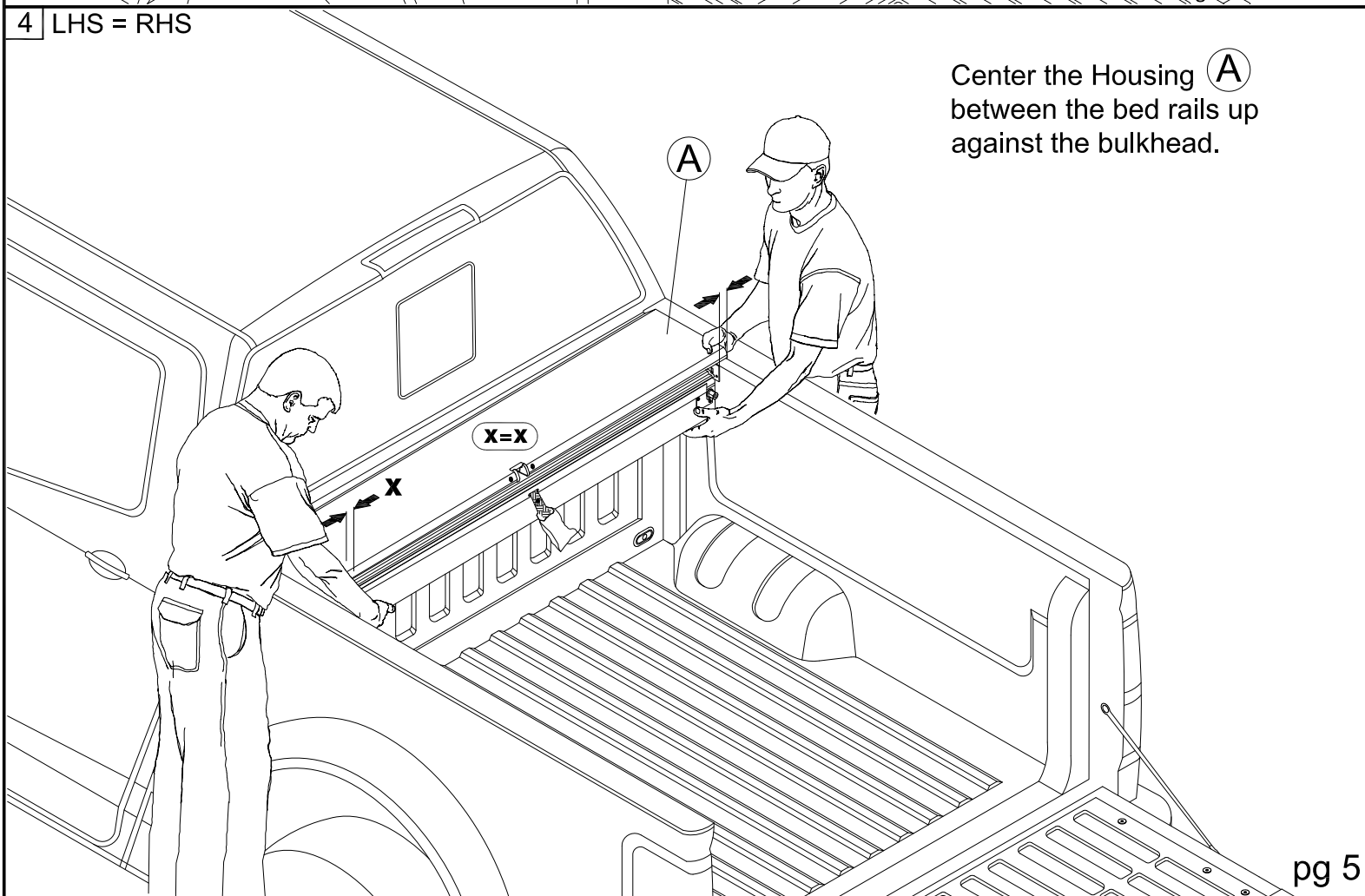

Center the Housing (A) between the bed rails up against the bulkhead.

5 LHS = RHS

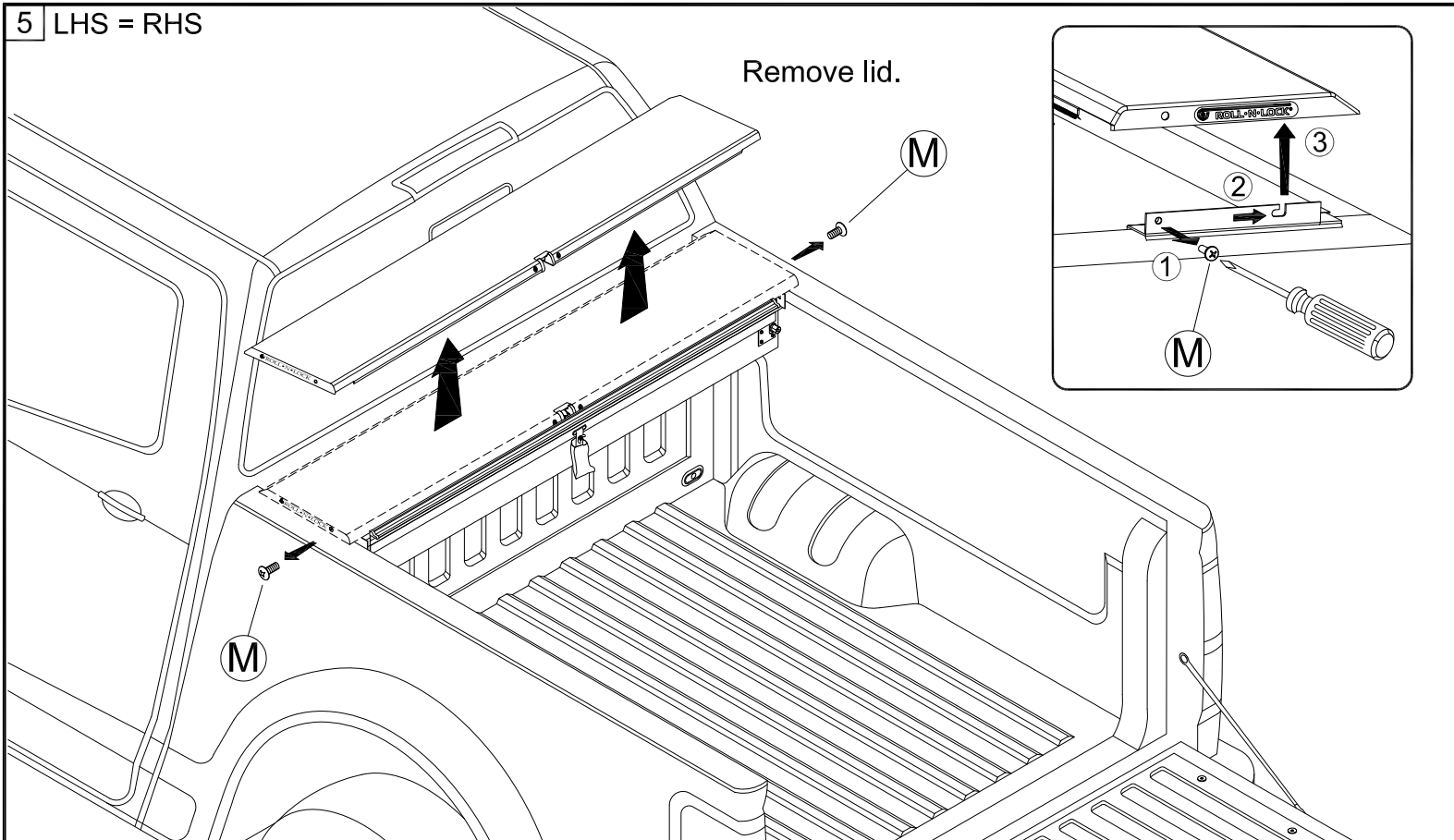

6 LHS = RHS

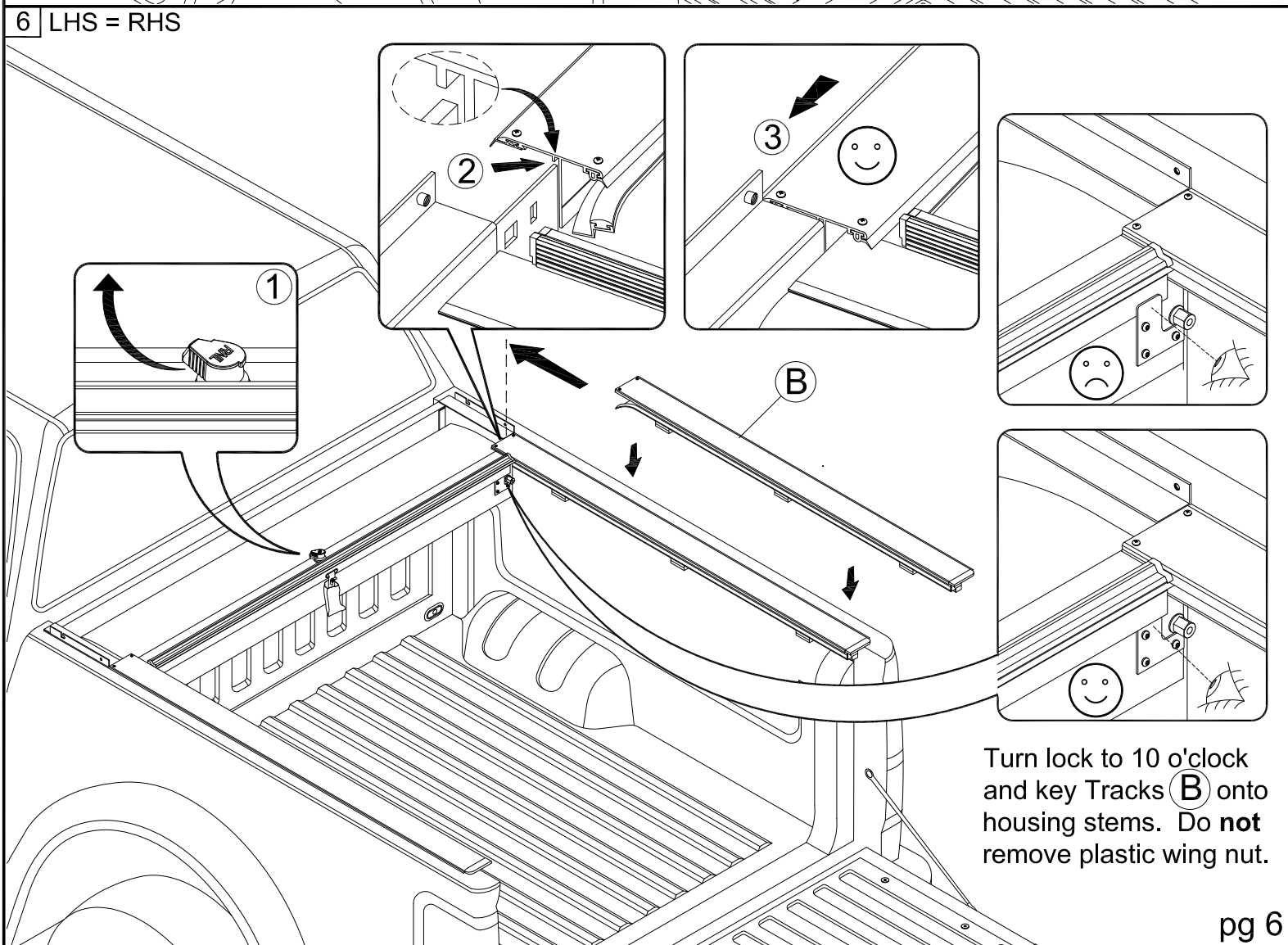

7 LHS = RHS

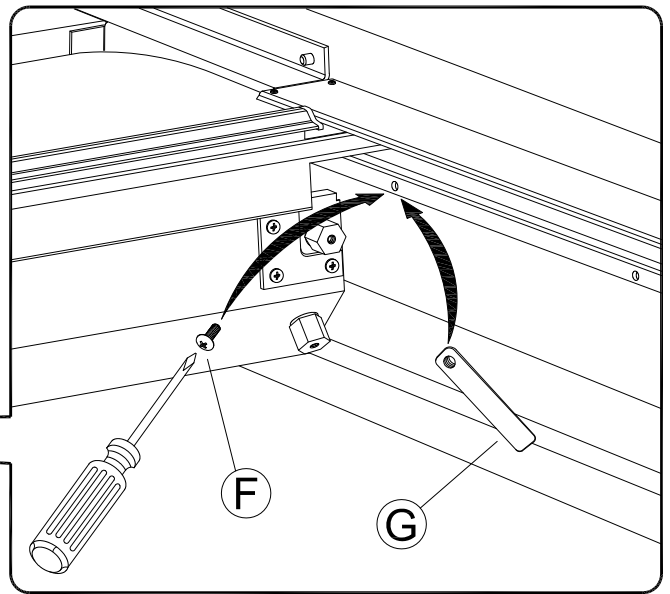
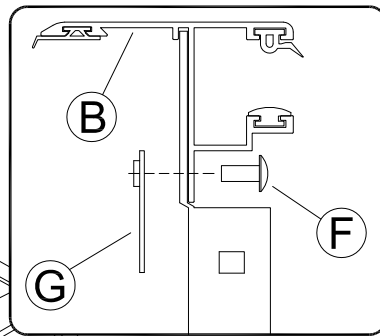

Secure Tracks to housing stems.

8 LHS = RHS

Loosely attach the Bed Clamps **E** to the track clamps.

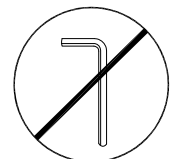
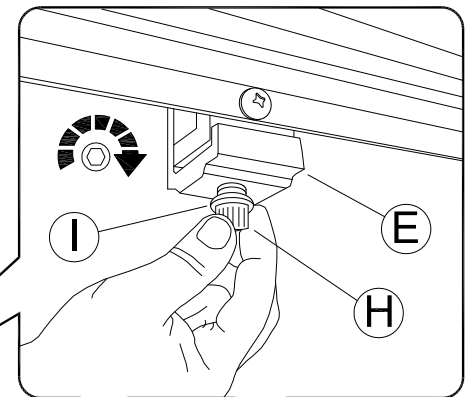

9 LHS = RHS

Close tailgate, shift the Housing back so the end of the Tracks are up against the tailgate.

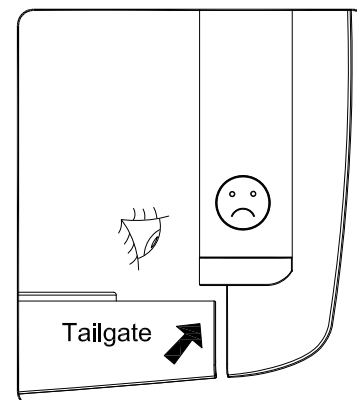
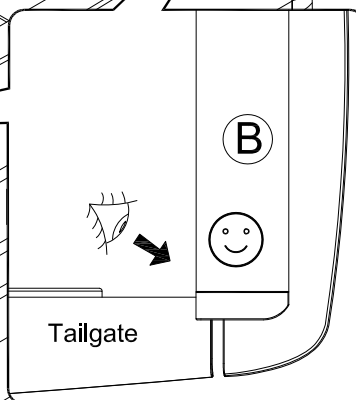
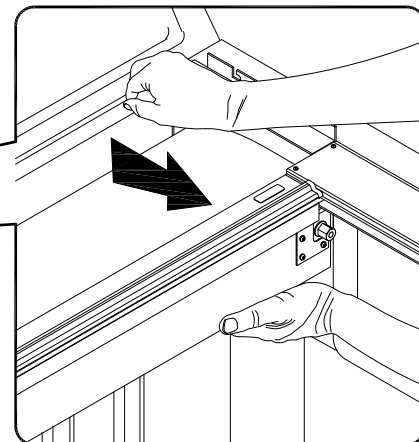

10 LHS = RHS

52 1/2"

52 1/2"

Notch

C



Use Cargo Shield notches to ensure correct spacing of tracks.



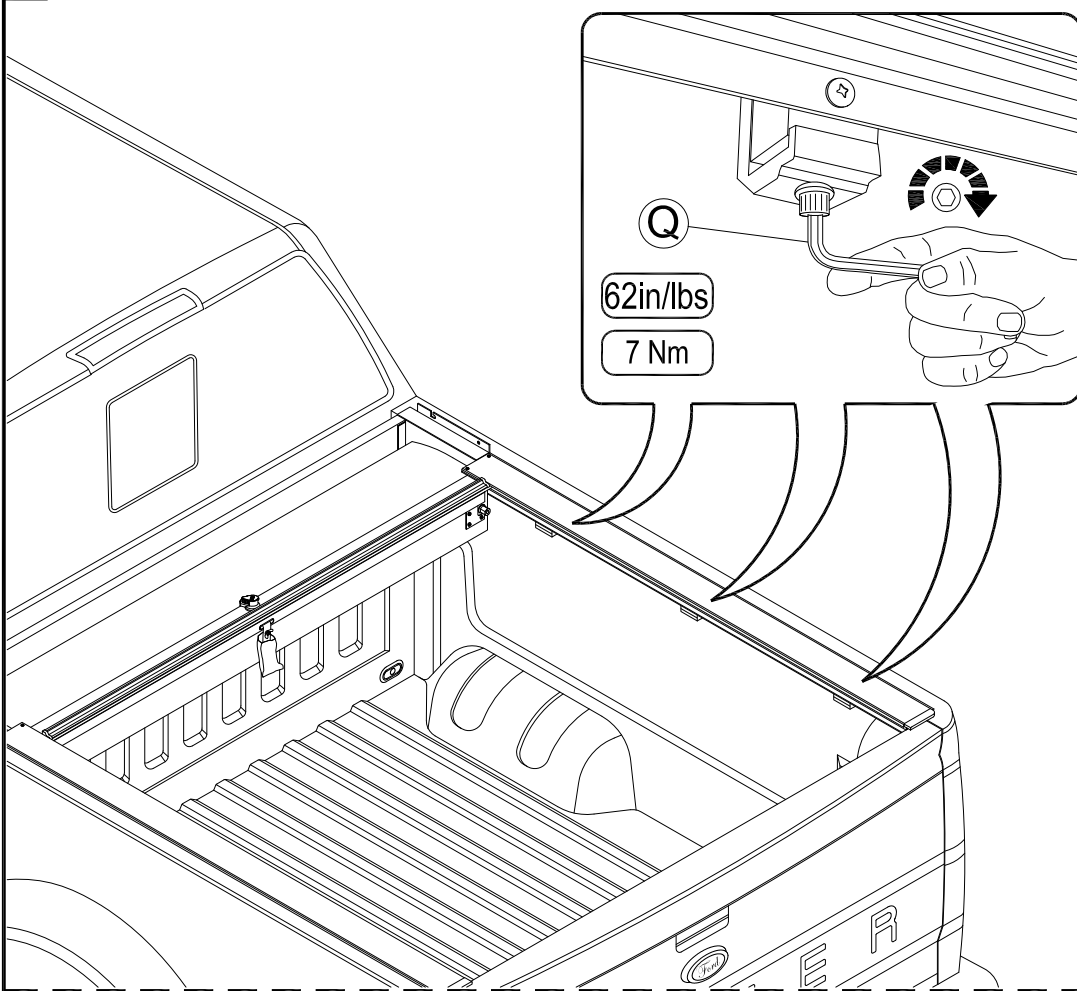

Tighten bed clamps to the track clamps.

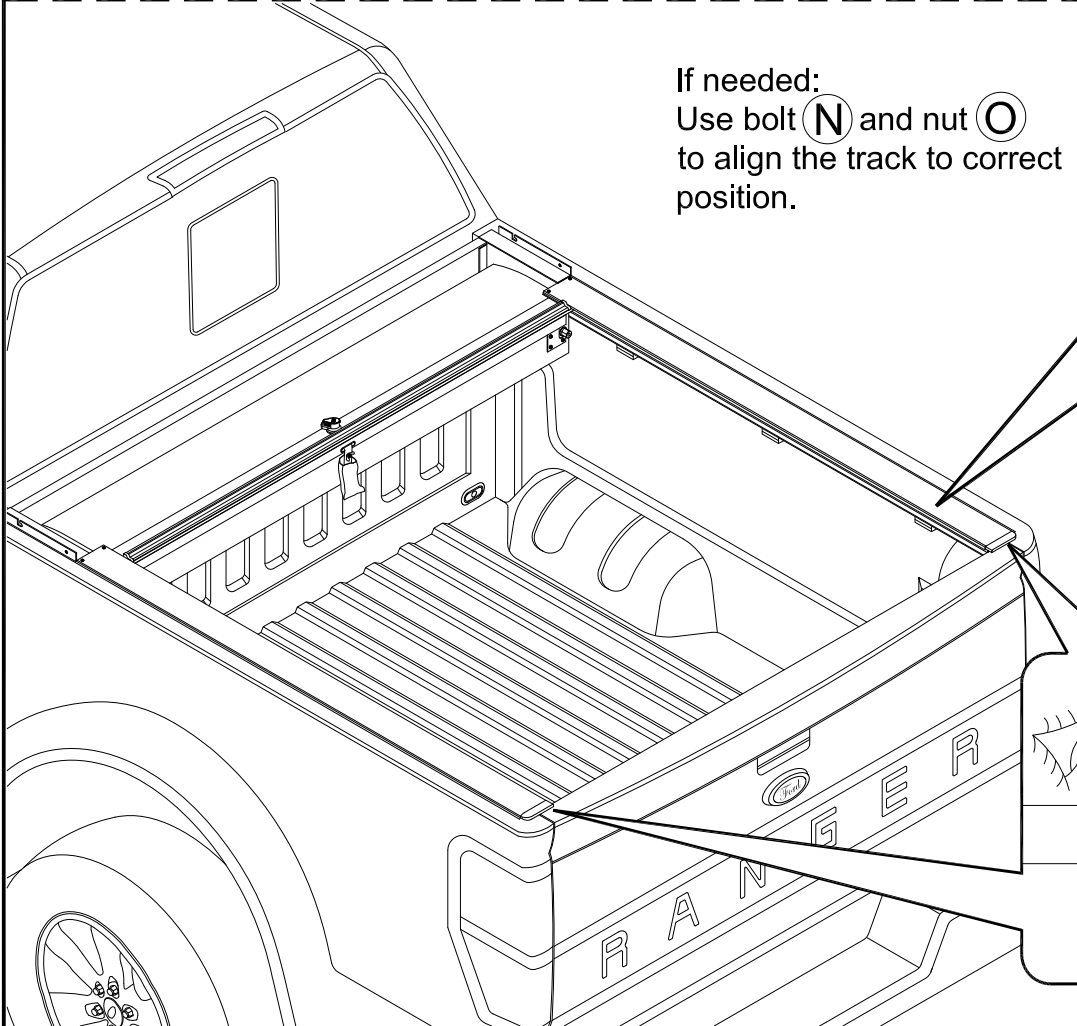
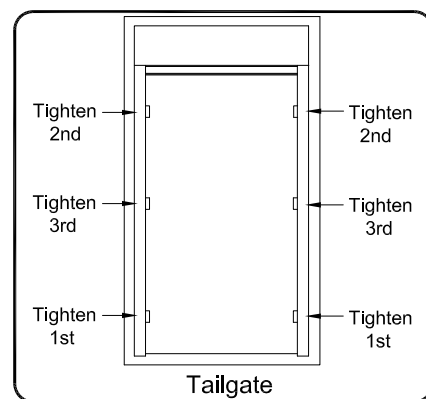

If needed:  
Use bolt (N) and nut (O)  
to align the track to correct  
position.

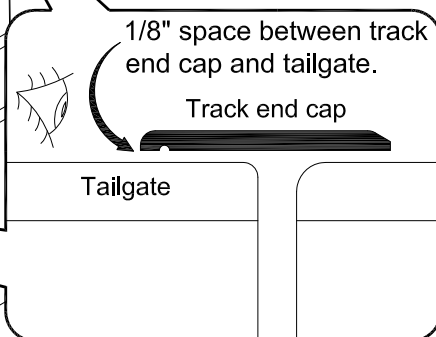
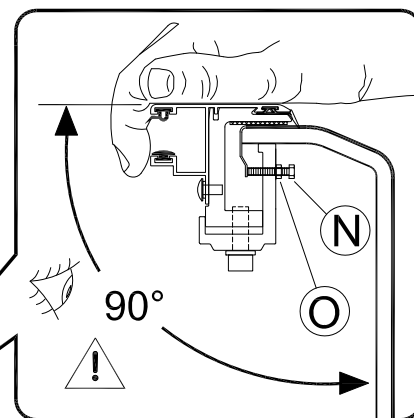

12

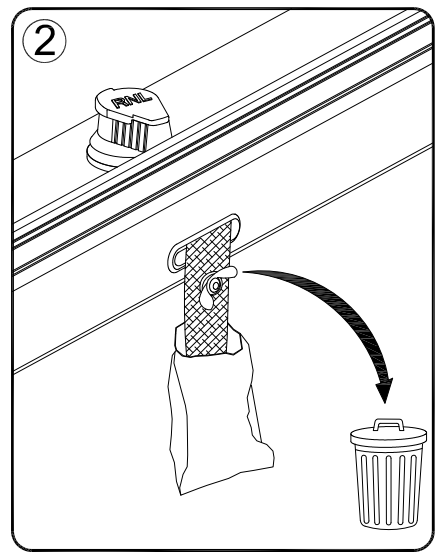
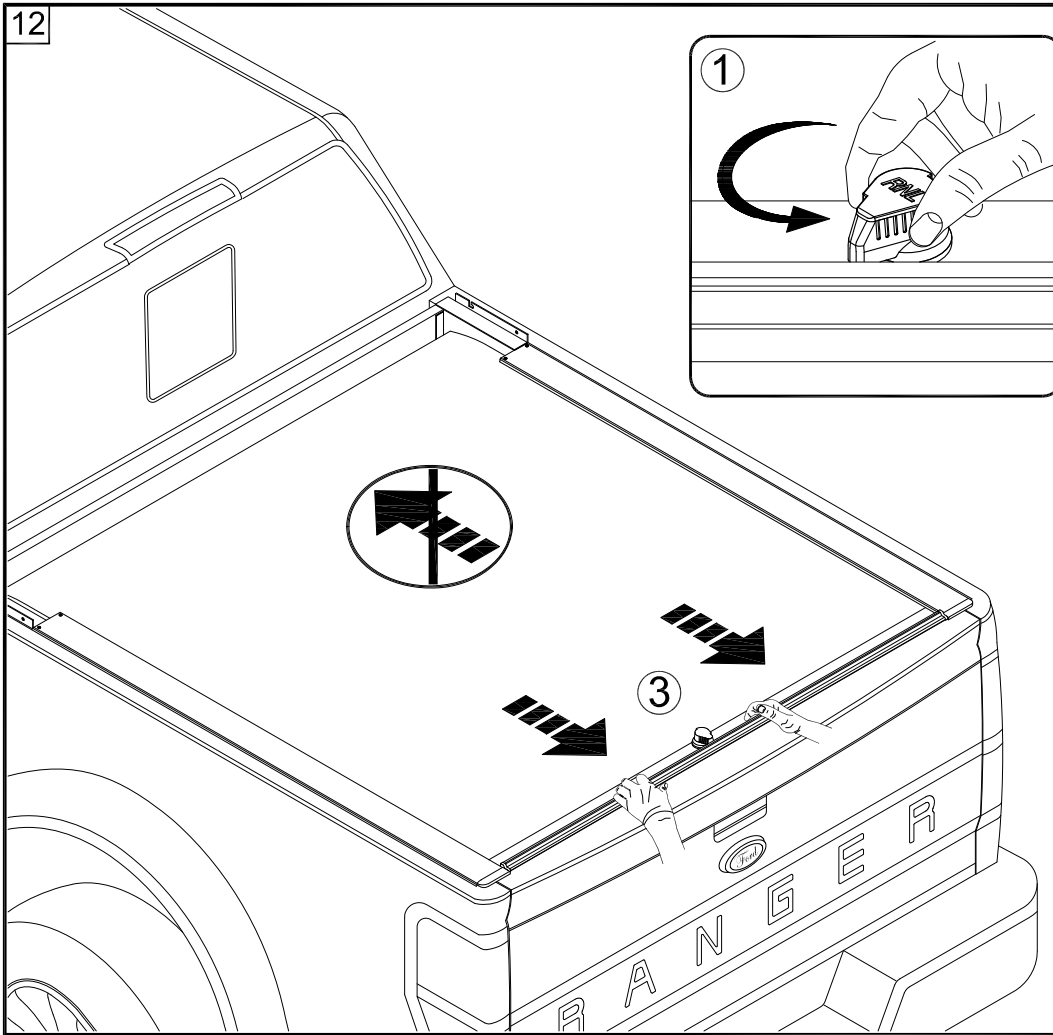

Turn lock to 7 o'clock, remove plastic wing nut and using both hands pull cover back to tailgate.

13

Replace lid.

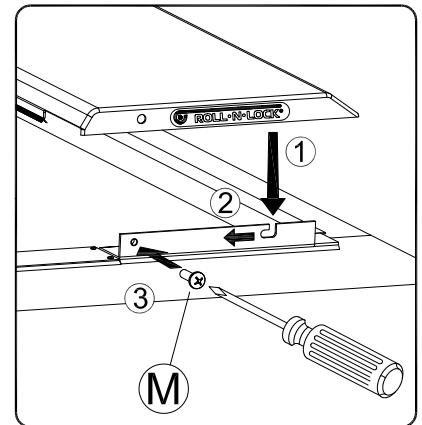
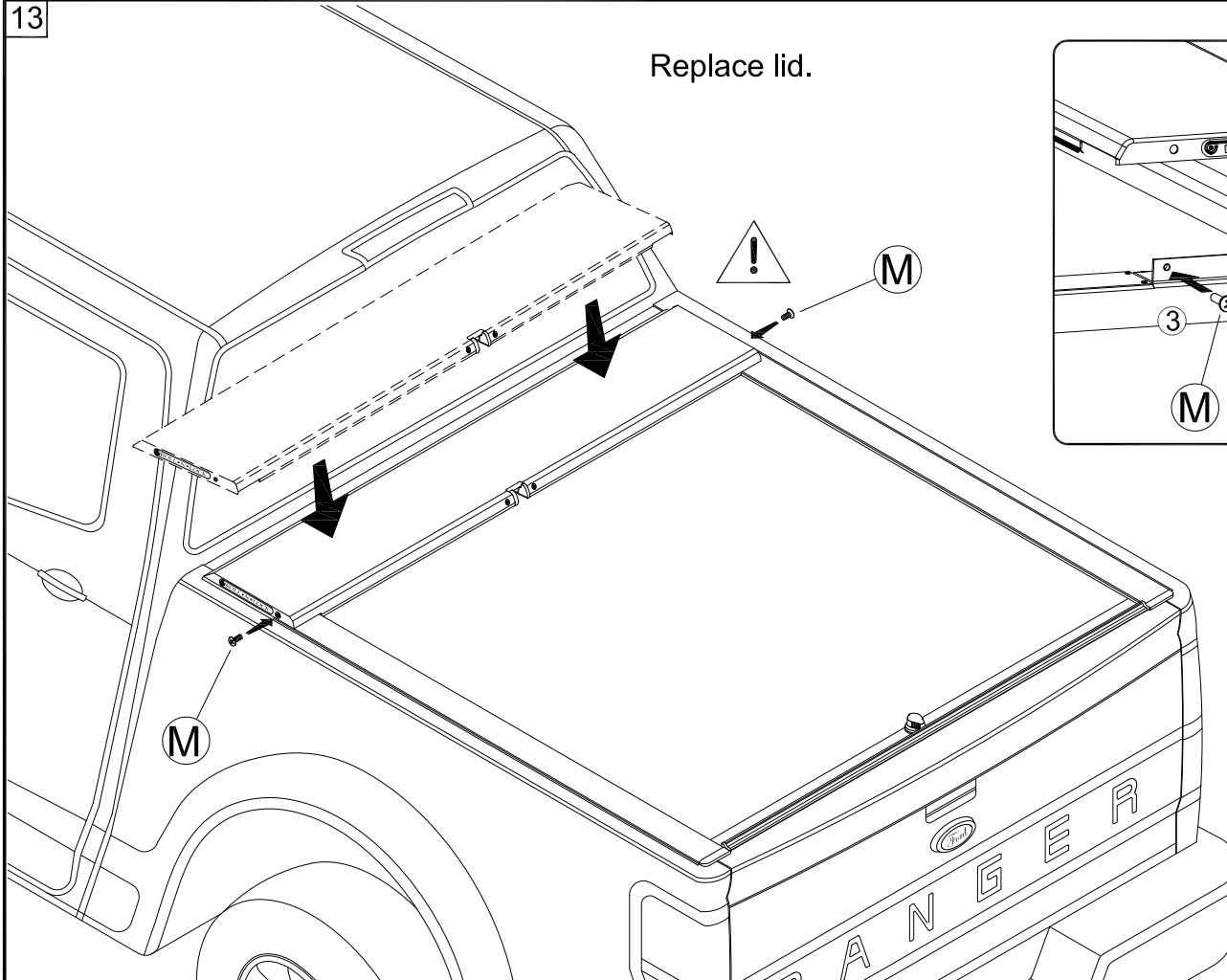

14

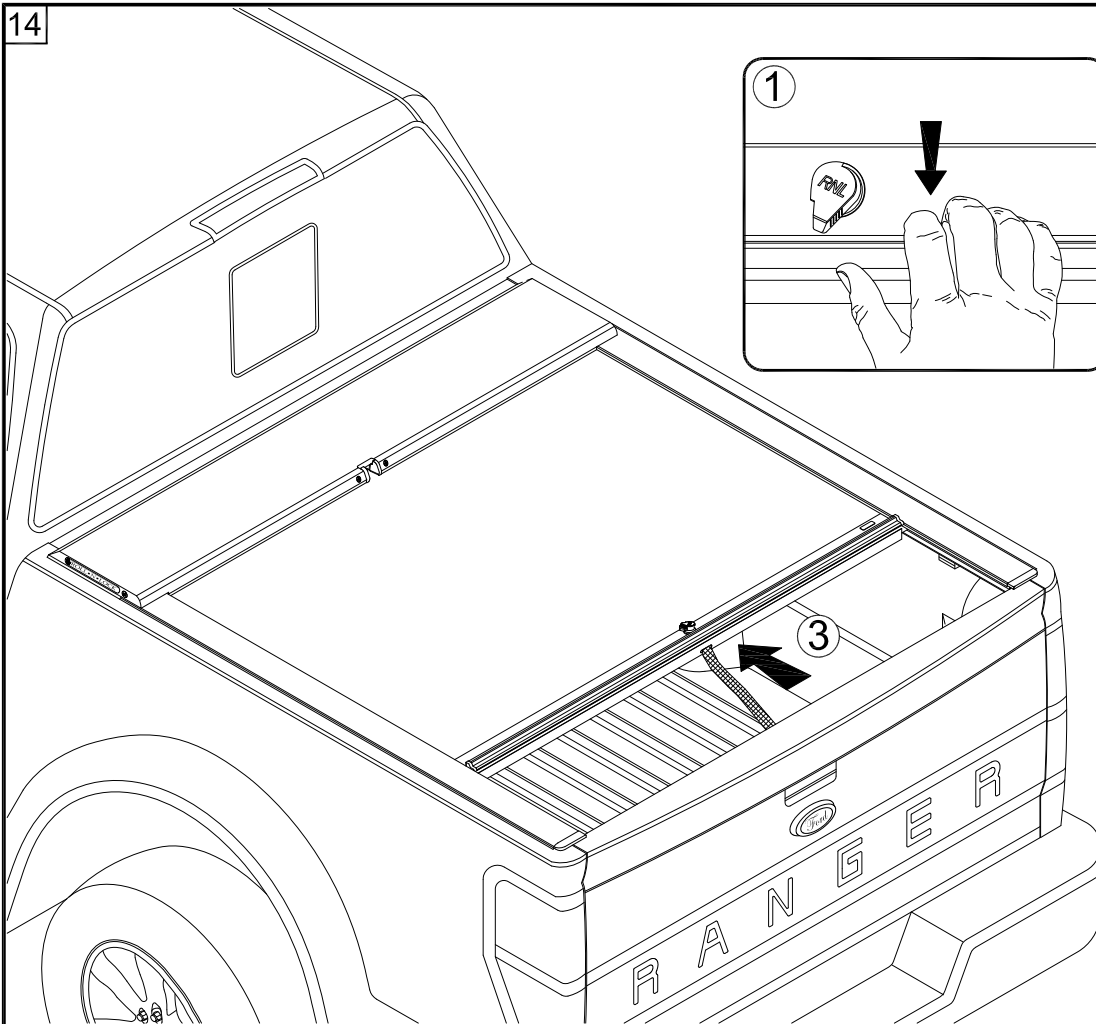

To open cover pull back on the handle, turn the lock to 10 o'clock and let the cover retract into the housing while holding onto the pull-strap.

15 LHS = RHS

Attach the Cargo Shield **C** to the housing. Note washer **J** placement.

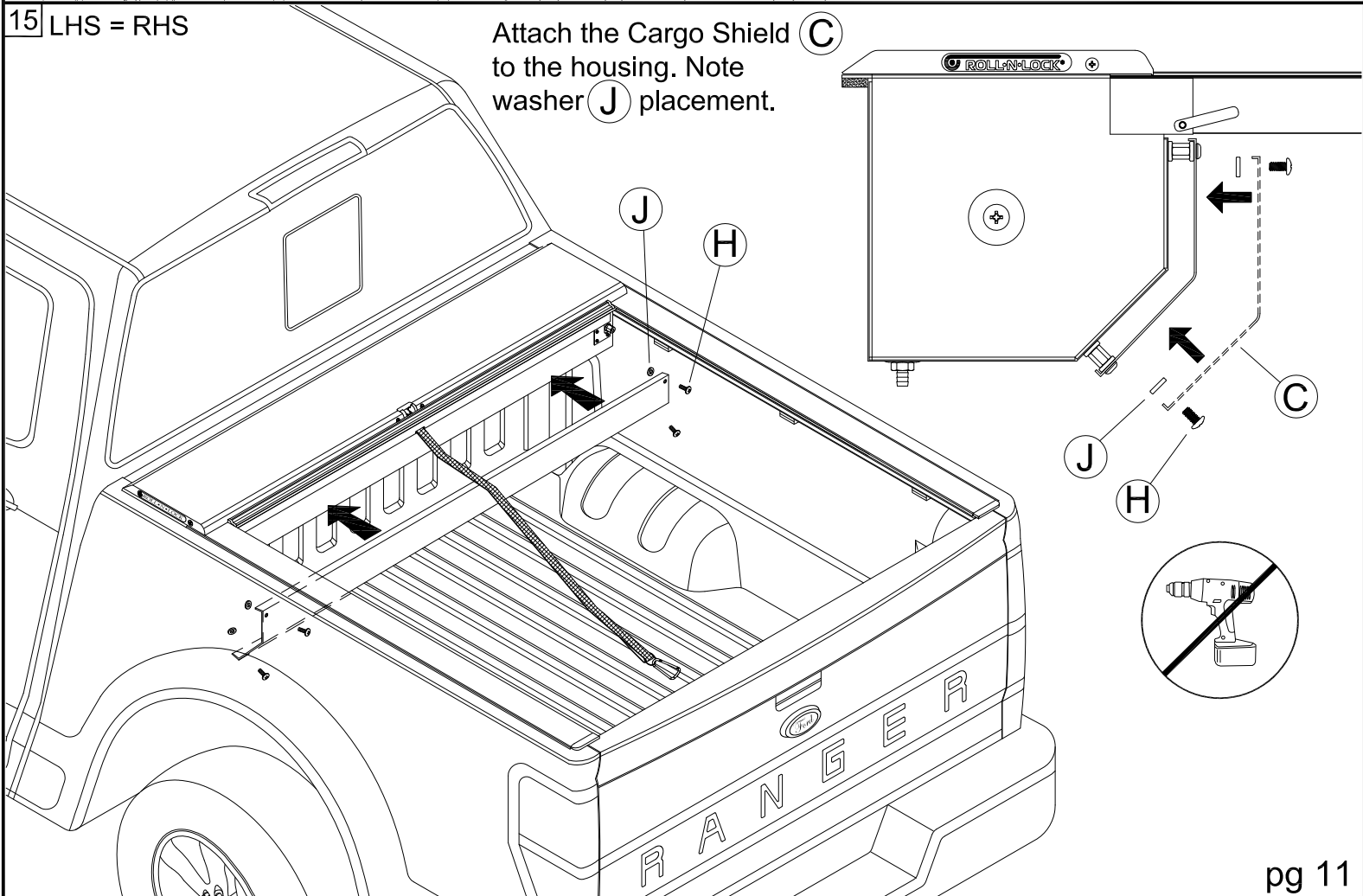

16 LHS = RHS

Insert one end of the drain tube (L 1/2") through the truck bed and insert the other end onto the housing fitting. May need to cut tube to size.

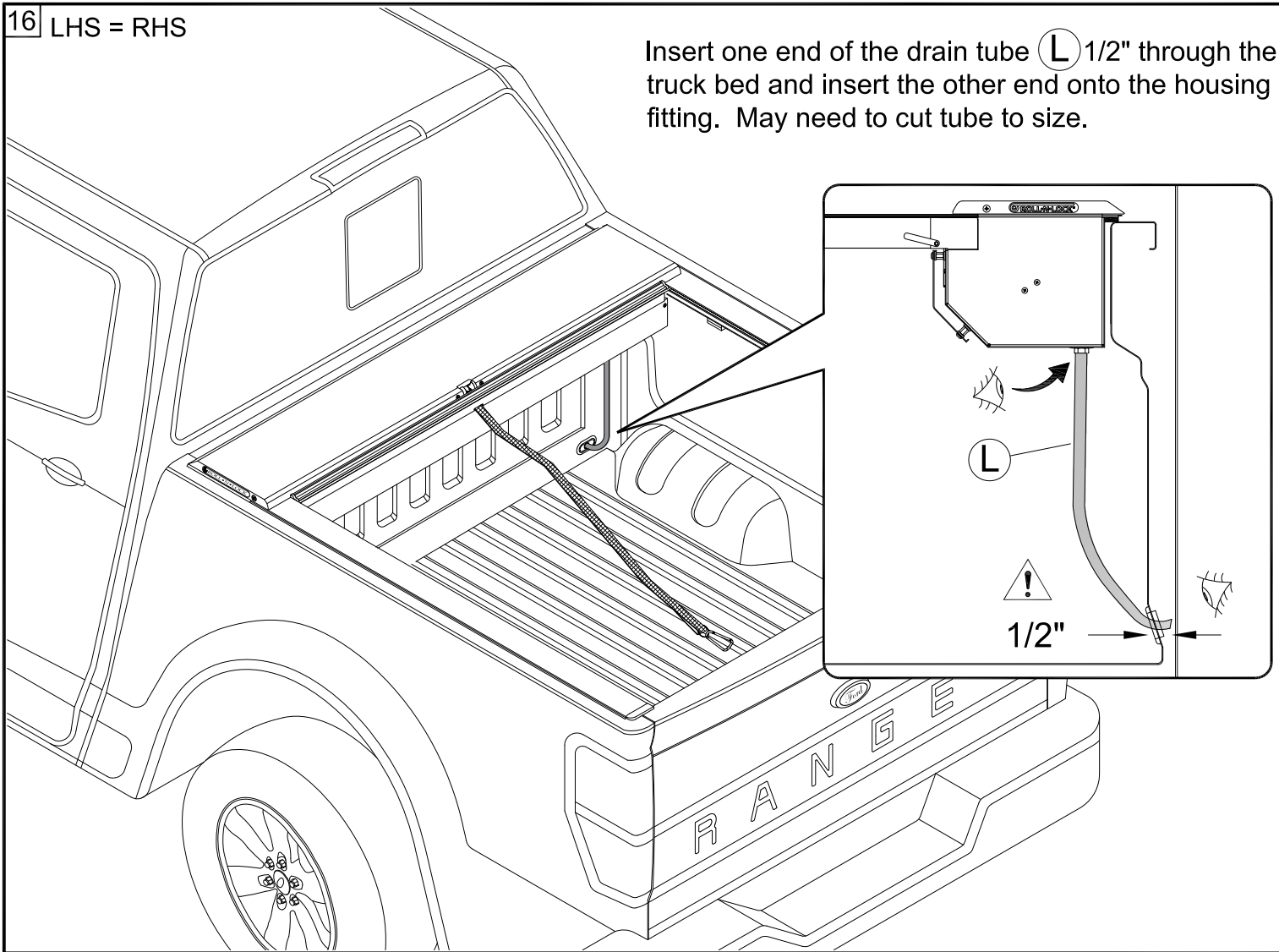

17

Clip pull-strap to truck.

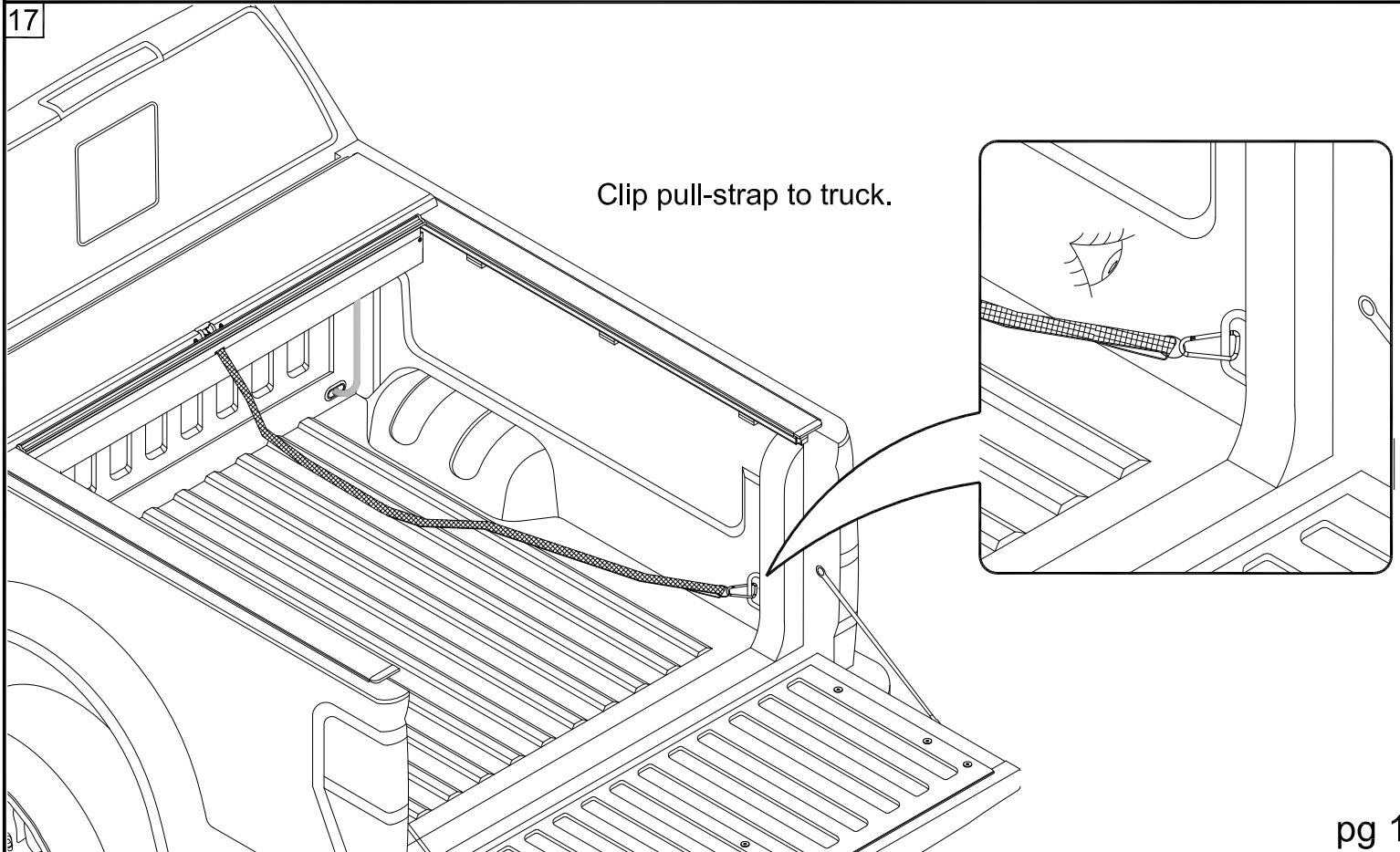

# Troubleshooting

Cover is hard to pull or retract.



Spray 303<sup>®</sup> on a rag and wipe the top gasket in the Track back and forth.

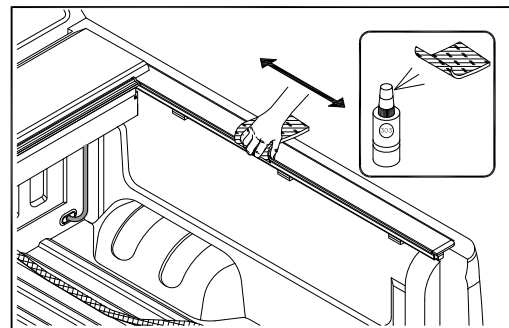

Cover does not latch.



Check Track to Track measurement.

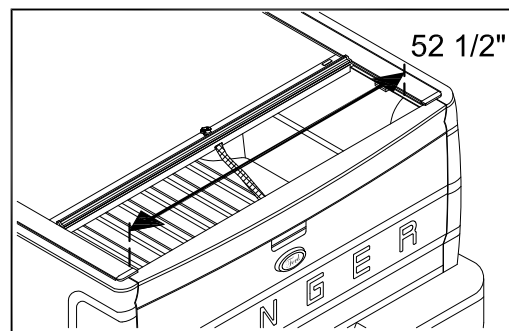

Cover does not latch.



Make sure Tracks are back against tailgate.

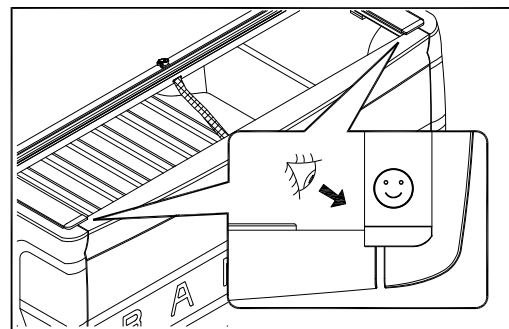

Track tips up.



Use angularity bolt to level Track.

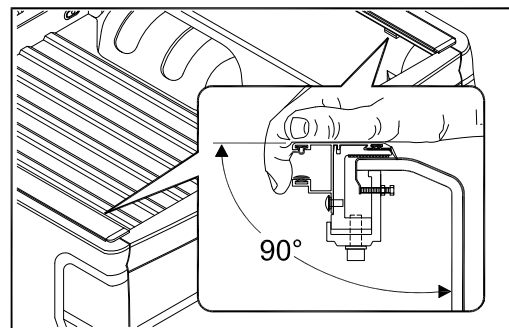

Any questions please call Customer Service at 800-952-7655  
or email [customerservice@rollnlock.com](mailto:customerservice@rollnlock.com)