



Assembly overview.....	2-3
1. Frame inspection.....	4
2. Headset installation.....	5
3. Cables & housing installation.....	6-9
4. Electronic drive-train specification.....	10-13
5. Saddle adjustment.....	14-15
6. Derailleur hanger adjustment.....	16
7. Parts listing.....	17-20

For the warranty to be valid, the bicycle must be fully assembled by an authorized Argon 18 dealer. High-end components, particularly carbon parts, need extra care when assembled. Those components must be installed using a calibrated torque wrench to make sure every bolt is at the right torque setting to prevent damage.



1. Frame inspection



2. Headset installation



3. Cable housing installation

IMPORTANT NOTICE: It is easier to install the cable housings before the bottom bracket, crank & fork.



4. Electronic drive-train cable routing specification



5. Seatpost installation



6. Derailleur hanger adjustment

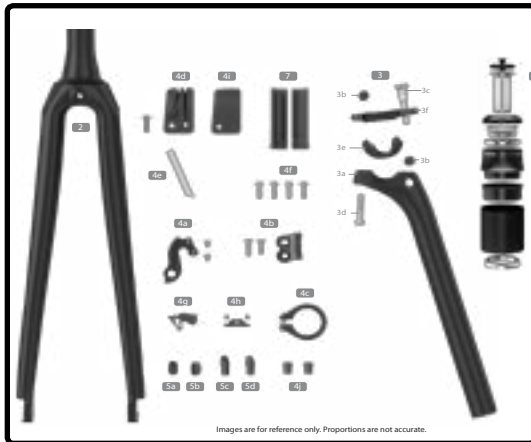

7. Parts Listing



When assembling a new frame, be sure to check if the following parts are assembled correctly.

Parts installed on the frame Description			Screw type	Torque Nm	Detail
1	Seatpost, Ø 27.2mm	Seatpost			Carbon paste
2	Front derailleur hanger	Screw	3mm	3Nm	Loctite
3	Rear derailleur hanger	Screw (2)	3mm	4Nm	Loctite
4	Bottle cage	Screw (4)	4mm	3Nm	Grease
5	Seatpost collar	Clamp	4mm	6Nm	Grease
6	Rear derailleur cable stopper	Screw (2)	2mm	2Nm	Loctite
7	Bottom bracket cable guide	Screw	5mm	3Nm	Grease

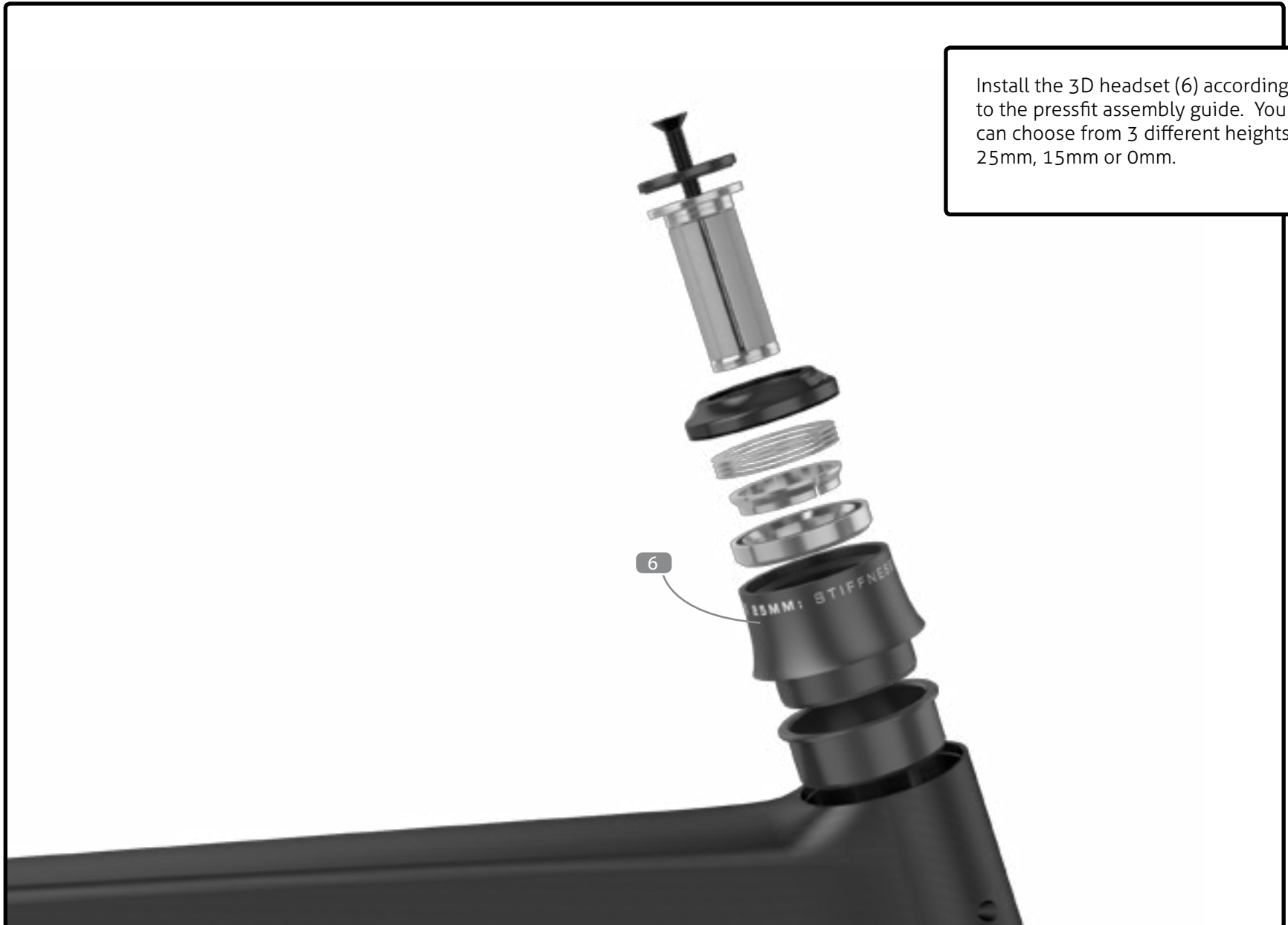

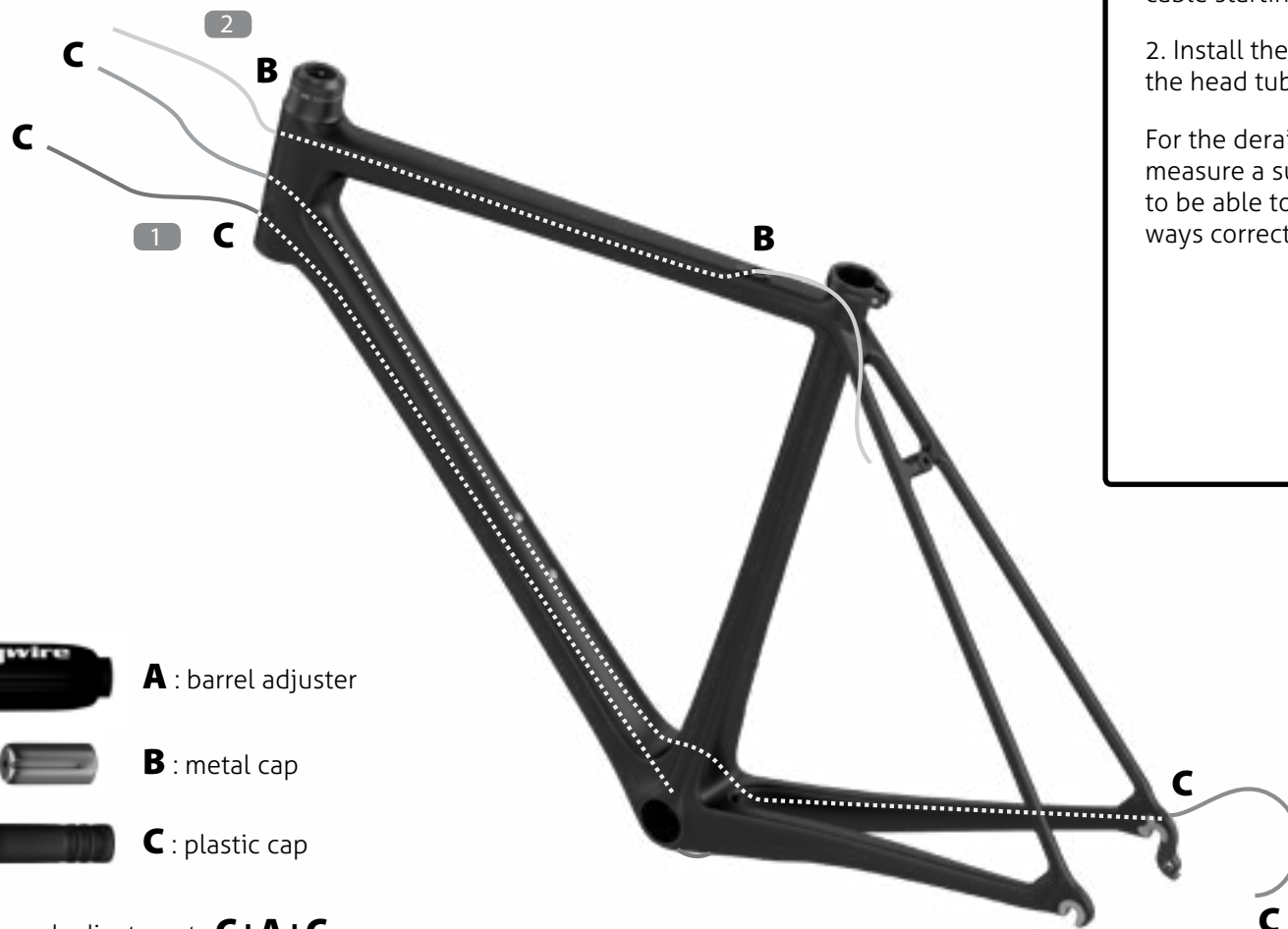

A : barrel adjuster



B : metal cap



C : plastic cap

speed adjustment : **C+A+C**



1. Install the front and rear derailleur cable starting at the head tube.

2. Install the rear brake cable starting the head tube.

For the derailleur and brake housing, measure a sufficient length of housing to be able to turn the handlebar both ways correctly.



Rear brake cable housing

Remove the cable stopper (4g) near the seat collar.

Front section: Measure the necessary cable housing to ensure a proper rotation of the handlebar. Insert the cable through the shifter, then insert the cable and the housing with a ferrule in the head tube.

Rear section: With a magnet, get the rear brake cable out of the frame, and pass it through the rear cable stopper. Measure the rear housing correctly to avoid interference with the rider's left leg. Fix the cable to the brake according to the brake manufacturer assembly guide.



Front and rear derailleur: Pass the two cables inside the frame starting from the top tube until they come out under the bottom bracket.

Pass both cables into the cable guide (4d). Make sure the 5mm screw is set to 1.5 Nm.

For a Di2 configuration, use the bottom bracket dedicated cover for electric shifting (4i).

It's better to install the cables before installing the bottom bracket and crank.



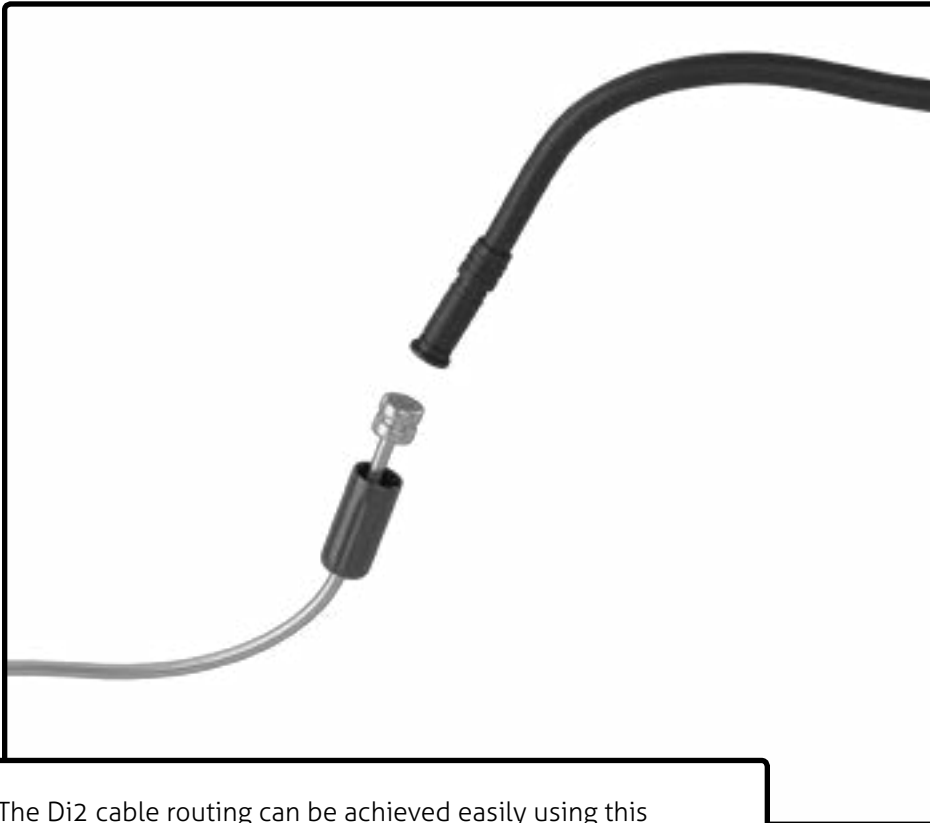

The Di2 cable routing can be achieved easily using this simple trick: use a brake cable and a metal cable end to fix the Di2 cable. For more information on Shimano Di2 electronic system installation, go to : <http://si.shimano.com>.



Use the proper grommet on the headtube to fix the cable correctly (depending if you use a mechanical or electronic drive-train).

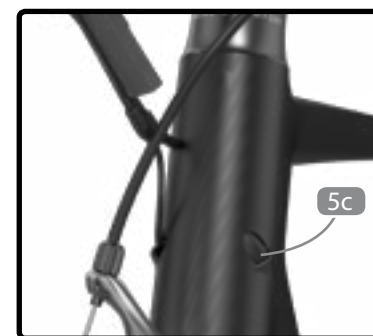
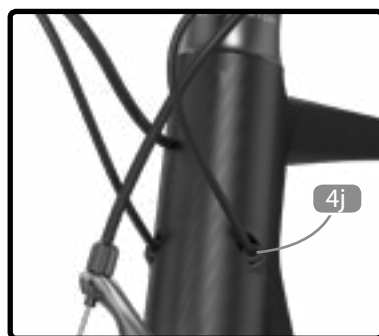



Use the proper grommet / cable stopper for the rear derailleur (depending if you use mechanical or electronic drive-train).

In a Di2 configuration, remove the cable stopper (4h) and use the Di2 grommet (5a) instead, but leave the 2 screws to avoid empty holes on the frame.



In a mechanical configuration, use the provided cable guide pipe (4e) for the front derailleur. For an electronic drive-train configuration, remove the cable guide pipe and use the proper grommet (5b) to fix the cable correctly.





The Di2 battery is hidden in the seatpost; use the Di2 battery holder to fix the battery correctly. Apply a slight amount of grease on both parts.



5.1 Install the saddle on the rocker (3e) and tighten the rail clamp (3f) using the screw (3d).

5.2 Adjust the angle of the saddle using a 8mm open wrench on the 3c bolt. Then tighten the assembly with the rear bolt (3d) to 6Nm.

5.3 The rail clamp (3f) can be flipped to change the saddle offset.



Seat clamp offset (-15mm to -25mm)
by flipping the rail clamp (3f).



The front derailleur hanger can be adjusted according to the front derailleur angle to get an equal curve between the derailleur and the big chain ring. Once at the right angle, use blue 242 Loctite and screw in at 6Nm.



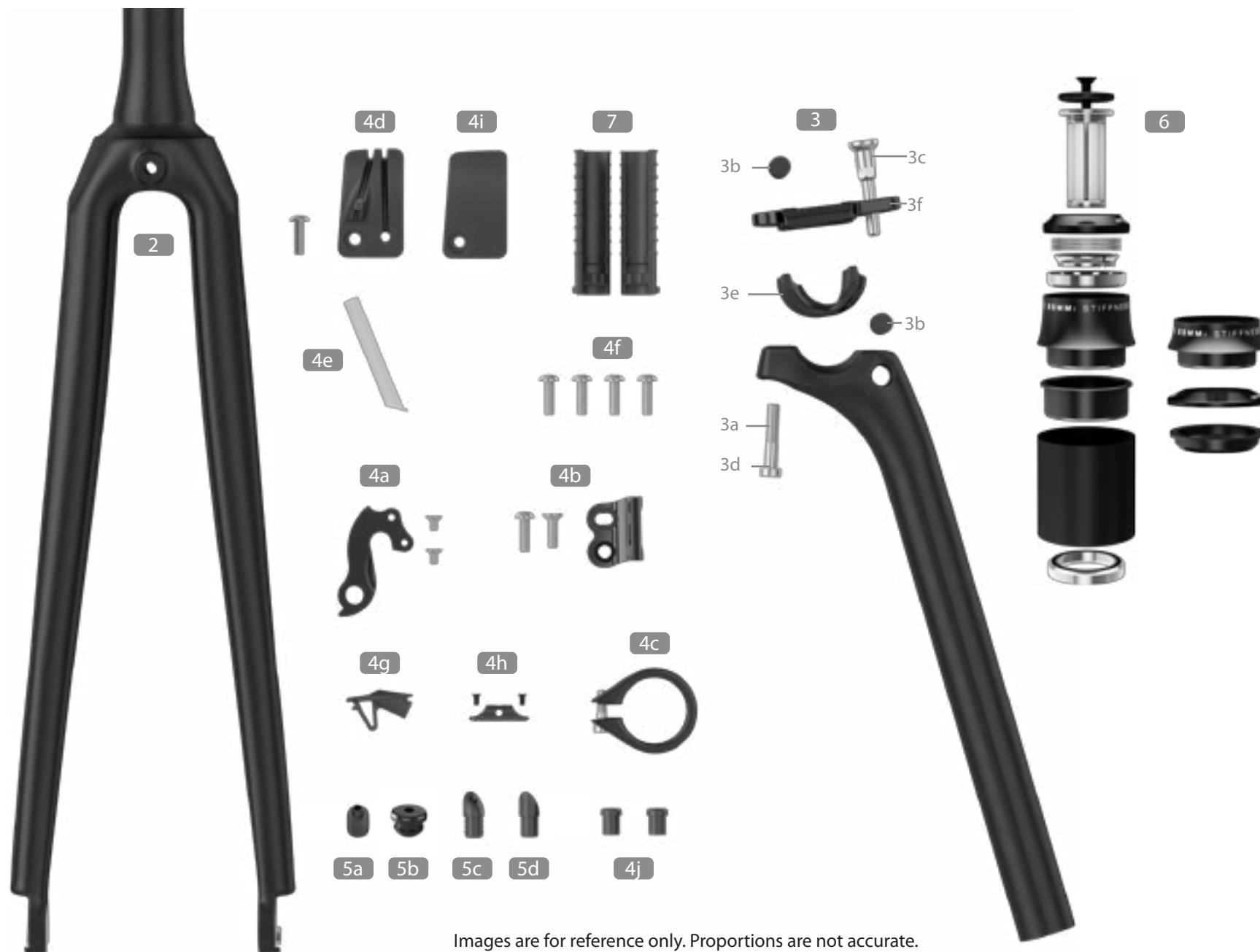

Images are for reference only. Proportions are not accurate.



No #	Name Frameset parts	Supplier Description
1	Gallium Pro frame	AR-R03C-UD, artwork, 210A, black/red, mat/gloss
2	Gallium Pro fork	AR-R03-FKF-43*305*56, artwork 210A-FK, black/red, mat/glo:

#	Seat post with the following parts assembled	
3	Gallium Pro seat post (ASP-6550)	AR-R03SP-UD, 27.2mm*300, artwork 210ASP, black/mat
3a	Hex cap screw (M6*40mm S)	M6*40mm S
3b	Cylinder nuts	SP24
3c	SP special bolt (M6*45mm)	Special bolt M6*45mm, LD20100402
3d	Convex M6 washer	Washer A2110-M
3e	Rocker	SP107
3f	Rail clamp	SP106



No #	Name Frameset parts	Supplier Description
---------	------------------------	----------------------

#	Parts installed on the frame	
---	------------------------------	--

4a	Rear derailleur hanger with screws - Model C	RD125, rear DO hanger with D/O hanger flat head HexSocket screws (M4*8mm F), black
4b	Front derailleur hanger with screws - Model D	M-RD03(R2) + ButtonHead HexSocket screw (M5*16mm B) and flat head HexSocket screw (M5*16mm F)
4c	Seat clamp with screw and washer	SC-137, seat clamp black polished, HexSocket screw (M5*16mm S) + washer, 0209320042, M001E90518 & 0224E90007
4d	BB cable guide with screw	OS-368, BB cable guide with screw for AR-R03, nut-117 round head Phillips (M5*9.5mm), 0299RD0081
4e	BB cable guide pipe	OS-369, BB cable guide pipe for AR-R03, 0299RD0082
4f	Screw for water bottle cage	Aluminum SocketHead screw (M5*15mm) for bottle cages (AR-R03C), M001210501
4g	TT Cable stopper	CD-177, TT cable stopper
4h	Removable CS cable stopper	CS-147, Removable CS Cable stopper with flat head HexSocket Screws (M3x10mmF) BOT115
4i	Di2 BB recess cover guide	OS-370, plastic recess cover for Di2 BB guide with screw for AR-R03, nut-117 round head Phillips (M5*9.5mm)
4j	Headtube cable stopper	OS-340, AR-R03 DT cable stopper, 0299320007

#	Di2 configuration specific parts	
---	----------------------------------	--

5a	Di2 cable grommet	OS-285, Di2 cable grommet for AR-R02-UDG, AR-R01D2-UDG, AR-R03-UD, 0299FH0033
5b	Cable Di2 grommet	Front derailleur Di2 wire grommet (round flat)
5c	Downtube Di2 grommet	OS-342, downtube Di2 grommet for AR-R03, 0299FH0027
5d	Downtube Di2 grommet filler	OS-341, downtube Di2 grommet filler for AR-R03-UD, 0299FH0026



No #	Name Frameset parts	Supplier Description
#	Also included with the frameset - shipped separately	
6	Headset No 37 + 3D with compressor TH-881-1	No 37 + 3D (Argon 18 exclusive) with TH-881-1 (23mm), H0539C0045E101 ; Ano black, with MW006x4, with 881-1 23mm, E0247, MW170A/B (Ano black), logo: 3D headtube (AM packaging)
7	Internal Di2 battery support for Gallium Pro seatpost	DIS22, seatpost Di2 battery mount for AR-R03C-UD 27.2mm