

OWNER:
TOWN OF JAMESTOWN
P.O. BOX 848
JAMESTOWN, N.C. 27282
PHONE: (336) 454-1138
FAX: (336) 886-3504

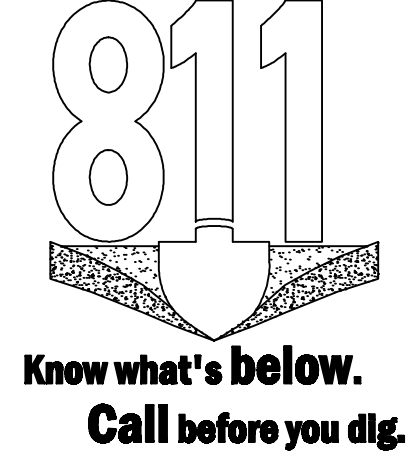

- NOTES:
1. SITE AREA = 167.15± ACRES
 2. D.B. 2493 PG.765, P.B. 5956 PG. 1973
 3. ZONING: CIVIC
 4. PUBLIC WATER IS AVAILABLE ONSITE
 5. THE PARKS RESTROOM IS SERVED BY AN ONSITE SEPTIC SYSTEM. SEPTIC TANK AND DRAIN LINES WERE REPLACED IN 2024.
 6. WATERSHED: CITY LAKE WATERSHED, WS-IV
 7. SOIL TYPES: ApB, ApC, EnB, CeB2, CeC2, MoE
 8. EXISTING IMPERVIOUS SURFACE AREA (ISA): 6.10± AC = 4.80%
 9. EFFECTIVE AREA: 167.15± AC = 161.05± AC FOR WATERSHED (WS) CALCULATIONS
 10. PROPOSED WS ISA %: 0.197± AC = 0.122% (PLAY - 6500, S/W 2080 SF)
 11. PROPOSED WS ISA %: 0.197/161.05 = 0.122%
 12. CUMULATIVE WS ISA: 2764 + 8500 SF = 11,265 SF = 0.258± AC
 13. CUMULATIVE WS ISA %: .258/161.05 = 0.161%
 14. AREA TO BE DISTURBED: 17,000 SF = 0.39± AC

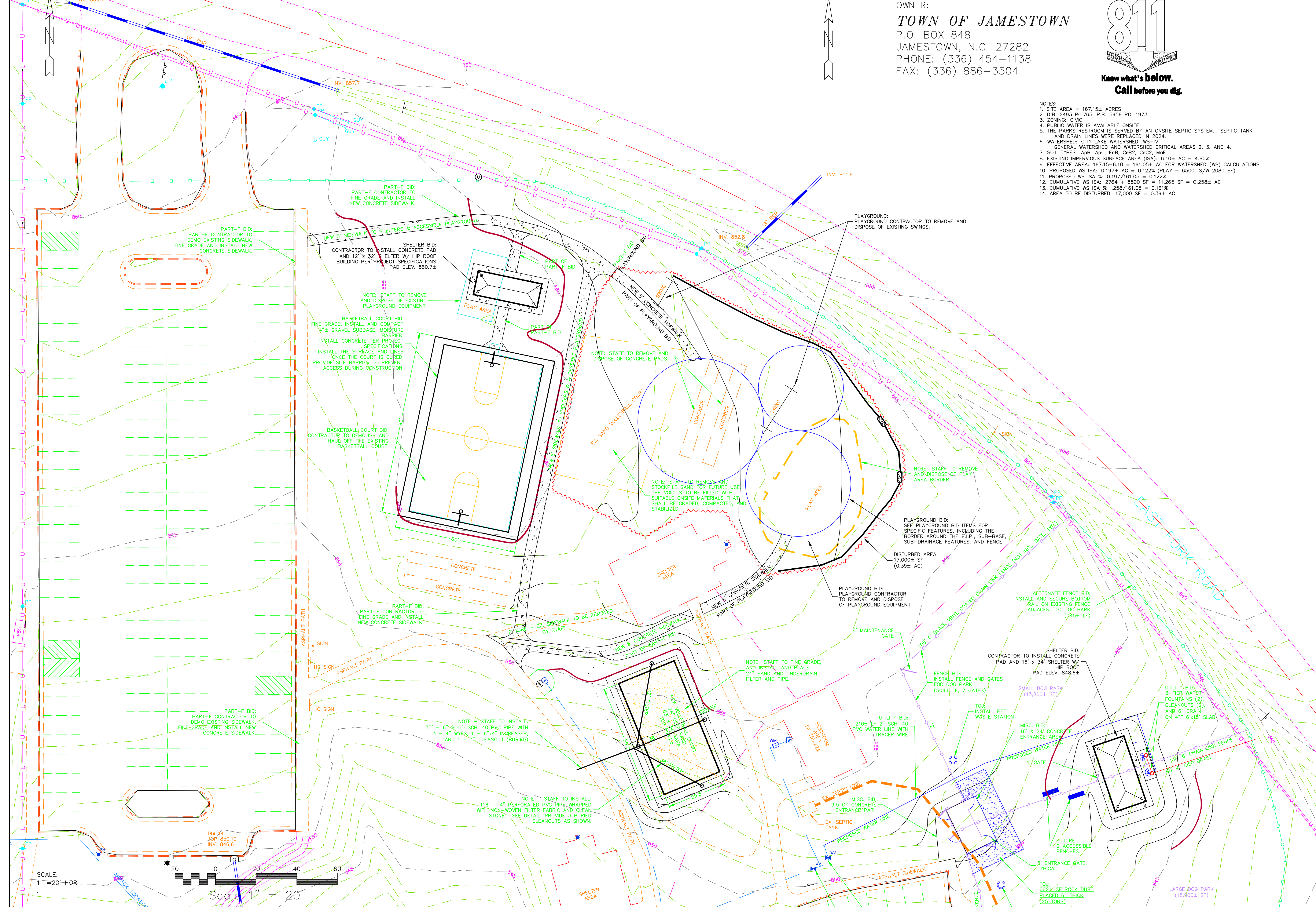

Civil Engineering by:
TOWN OF JAMESTOWN
PUBLIC SERVICES DEPARTMENT
301 EAST MAIN STREET
P.O. BOX 848
JAMESTOWN, NORTH CAROLINA 27282
TELEPHONE 336-454-1138 FAX 336-886-3504
EMAIL: pblanchard@jamestown-nc.gov

JOB NUMBER	2023-09
DATE	7-3-24
DESIGNED	PRB
DRAWN	CP
CHECKED	PRB
SCALE	1"=20' HOR
BY	AS NOTED

PLAYGROUND PLAN
TOWN OF JAMESTOWN
JAMESTOWN PARK
JAMESTOWN, N.C.
JAMESTOWN TOWNSHIP – GUILFORD COUNTY – NORTH CAROLINA