

ENRICO MARONE CINZANO

FURNITURE

ASSEMBLY INSTRUCTIONS

TANK LAMP

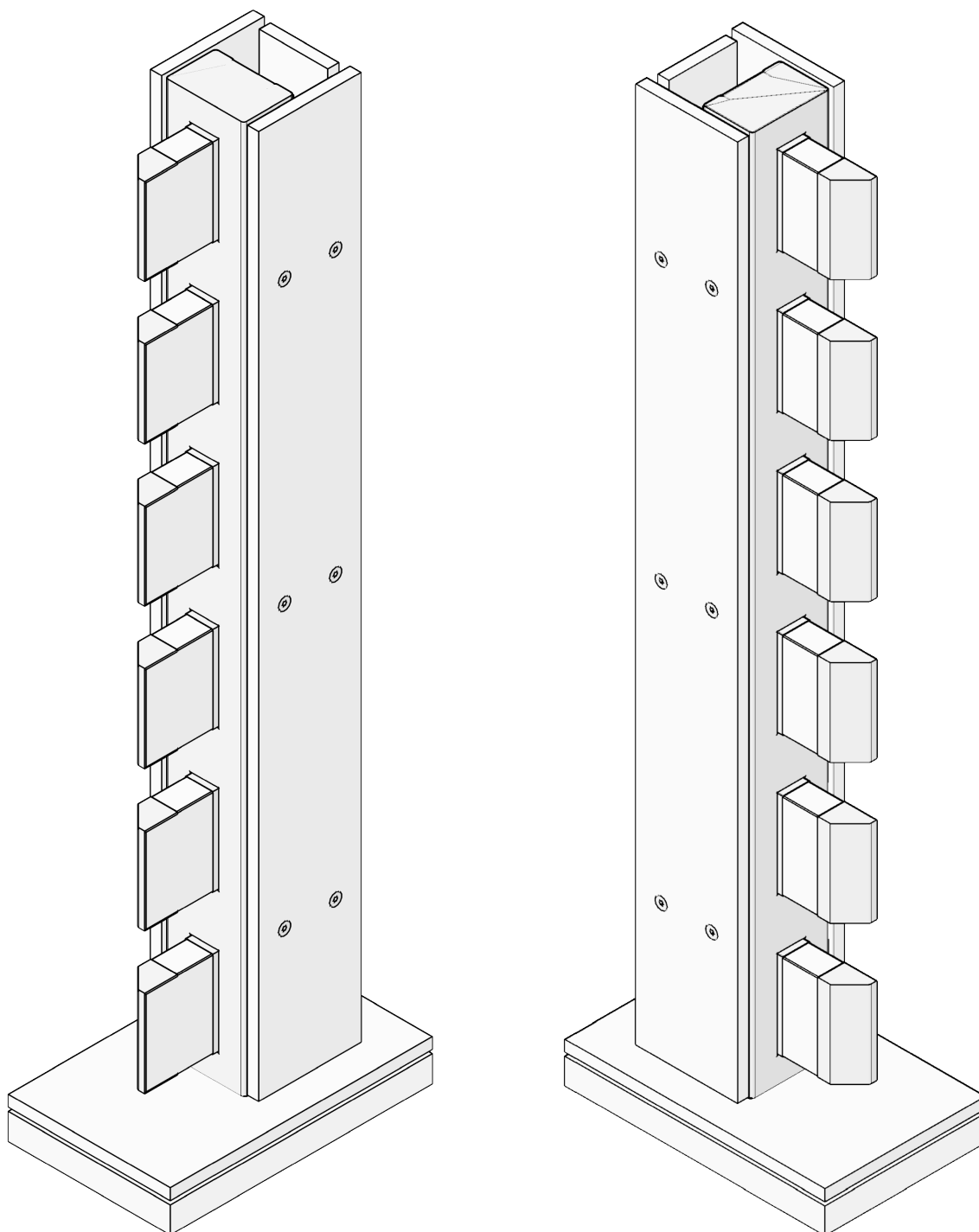

THE CORRECT ASSEMBLY REQUIRES 1 PERSONS.
TOOLS ARE REQUIRED.

TANK LAMP

1.

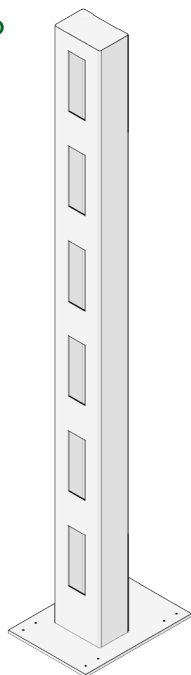

2.

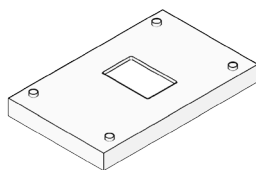

3.

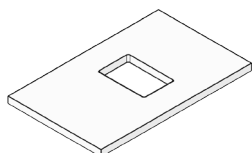
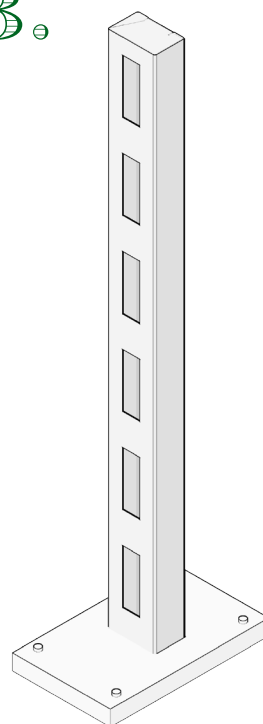

4.

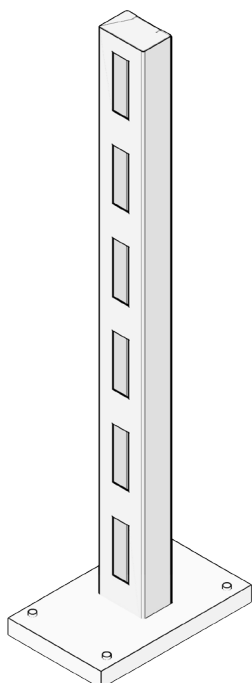

5.

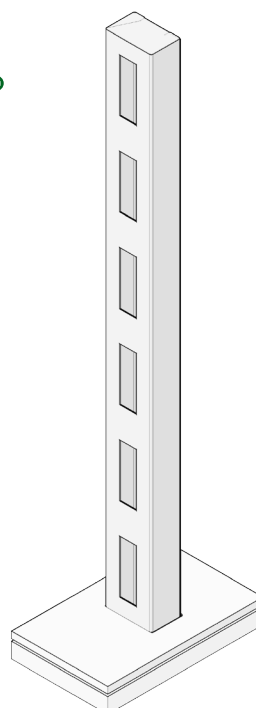

TANK LAMP

6.

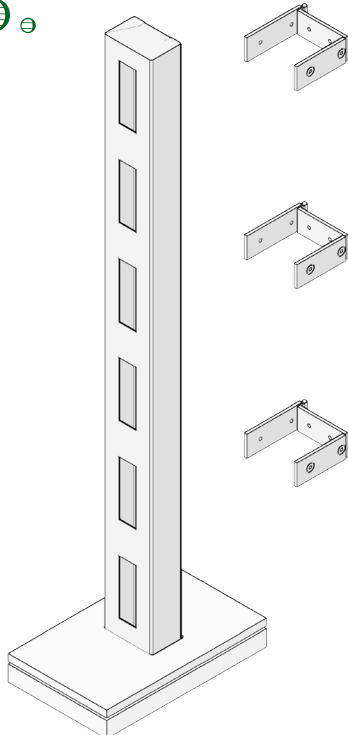

7.

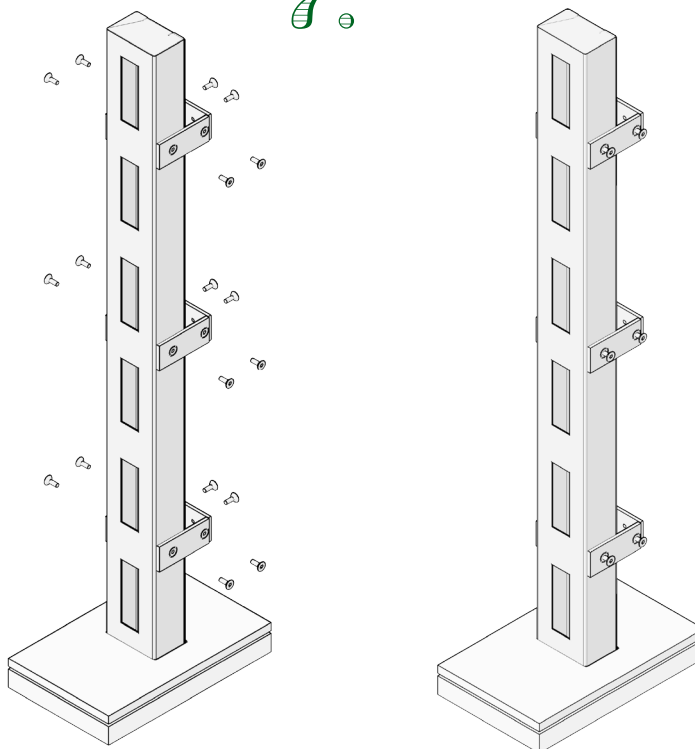

8.

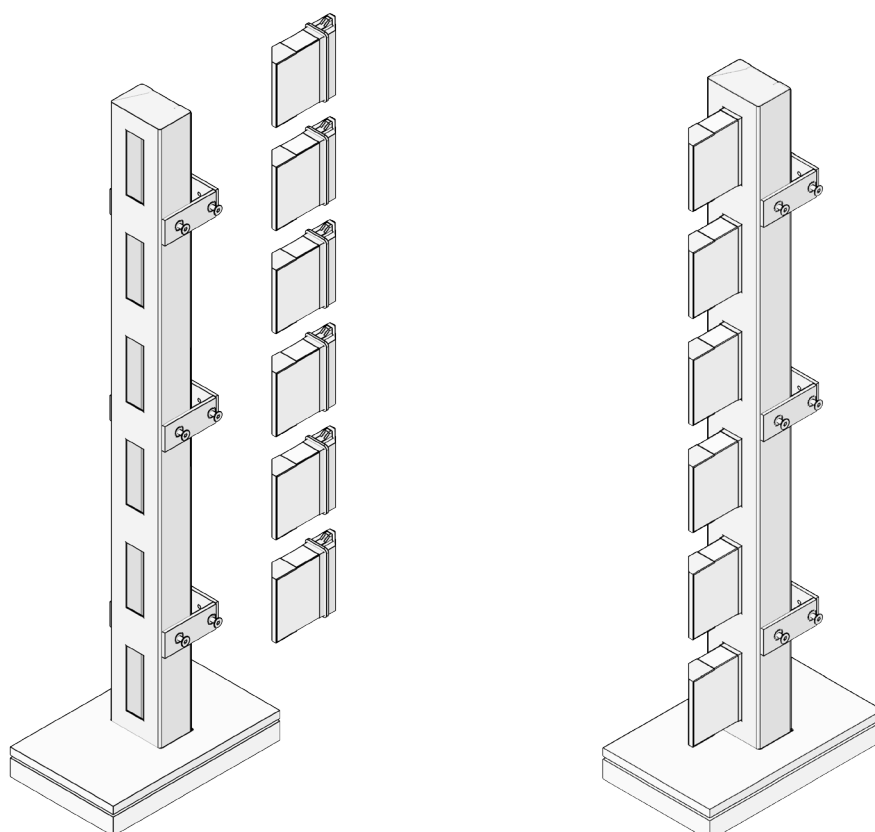

TANK LAMP

9.

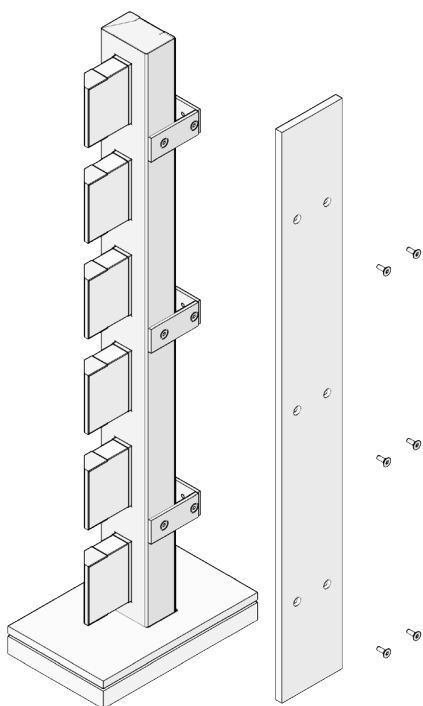

10.

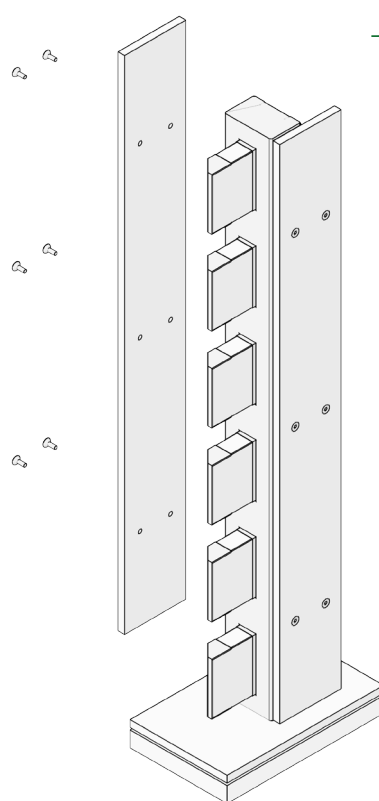

11.

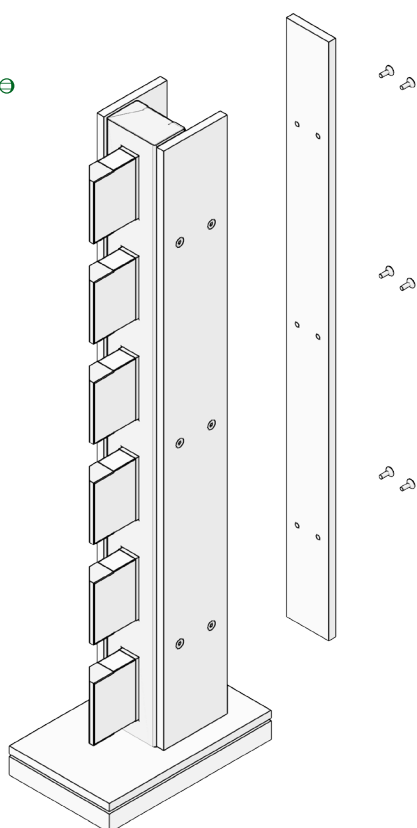

12.

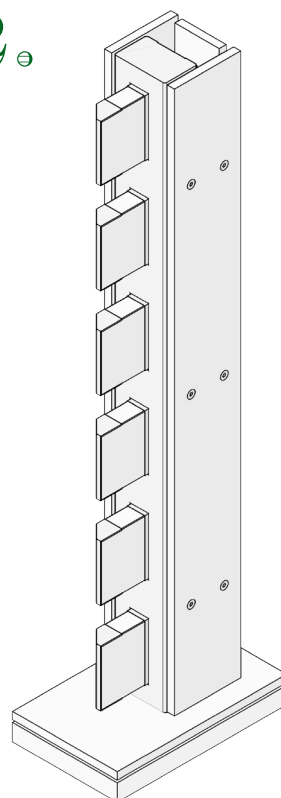

TANK LAMP

MAINTENANCE INSTRUCTIONS

WOOD SURFACES:

DUST WITH A SOFT AND COMPLETELY DRIED CLOTH.
FOR A BETTER AND LONG-LASTING PROTECTION EVERY 6
MONTHS TREAT THE WOOD WITH LINSEED OIL.

STEEL:

DUST WITH A SOFT AND WET CLOTH, USING ONLY NEUTRAL
DETERGENTS.

GLASS SURFACES:

CLEAN THE GLASS WITH A WET CLOTH, USING ONLY NEU-
TRAL DETERGENTS.