

APPENDIX

*City of San Rafael – Initial Study/Mitigated Negative Declaration
Marin Sanitary Services Facility Project – 1050 Andersen Drive/535-565 Jacoby Street, San
Rafael, CA*

Source Reference 20

**Solid Waste Facility Permit for Marin Sanitary
Service Facility/Permit Number: 21-AA-0005**

SOLID WASTE FACILITY PERMIT

1. Facility/Permit Number:

21-AA-0005

2. Name and Street Address of Facility:

Marin Sanitary Service Transfer Station
Marin Sanitary Resource Recovery Center
565 Jacoby Street
San Rafael, CA 94901

3. Name and Mailing Address of Operator:

Marin Sanitary Service
1050 Andersen Drive
San Rafael, CA 94901

4. Name and Mailing Address of Owner:

Joseph J. Garbarino, Jr.
Marin Sanitary Service
1050 Andersen Drive
San Rafael, CA 94901

5. Specifications:

- a. Permitted Operations: Composting Facility (mixed wastes) Processing Facility
 Composting Facility (yard waste) Transfer Station
 Landfill Disposal Site Transformation Facility
 Material Recovery Facility Other:

b. Permitted Hours of Operation: Waste Receipts: 12 a.m. to 4 p.m.
Site Operations: 5 a.m. to 12 a.m.

c. Permitted Tons per Operating Day:2,640.....Total: Tons/Day

Non-Hazardous - General2,640.....Tons/Day
 Non-Hazardous - SludgeTons/Day
 Non-Hazardous - Separated or commingled recyclables.....2,640.....Tons/Day
 Non-Hazardous - Other (See Section 14 of Permit)Tons/Day
 Designated (See Section 14 of Permit)Tons/Day
 Hazardous (See Section 14 of Permit)Tons/Day

d. Permitted Traffic Volume:800.....Total: Vehicles/Day

e. Key Design Parameters (Detailed parameters are shown on site plans bearing LEA and CIWMB validations):

	Total	Disposal	Transfer	MRF	Composting	Transformation
Permitted Area (In acres)	~ 8.5 a		~ 8.5 a	~ 8.5 a		
Design Capacity (Combined total from both buildings is 2,640 tpd)			2,640 tpd Includes MRF >	2,640 tpd < Includes Transfer		
Max. Elevation (Ft. MSL)						
Max. Depth (Ft. BGS)						
Estimated Closure Date						

Upon a significant change in design or operation from that described herein, this permit is subject to revocation or suspension. The stipulated permit findings and conditions are integral parts of this permit & supersede the conditions of any previously issued permit.

6. Approval:

Approving Officer Signature

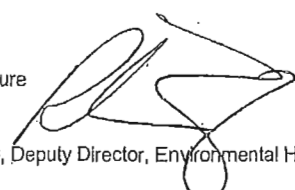

Name/Title: Rebecca Ng, Deputy Director, Environmental Health Services

7. Enforcement Agency Name and Address:

Marin County Environmental Health Services
3501 Civic Center Drive, Room 236
San Rafael, CA 94901

8. Received by CIWMB:

N/A

9. CIWMB Concurrence Date:

N/A

10. Permit Issued Date:

May 17, 2010

11A. Next Permit Review Due Date:

May 17, 2015

11B. Permit Transfer Date:

11C. Permit Review Date:

April 13, 2009

SOLID WASTE FACILITY PERMIT

Facility Number:

21-AA-0005

12. Legal Description of Facility:

The legal description of this facility is contained in attachment A to this permit. The map is attachment B.

13. Findings:

- a. This permit is consistent with the Marin County Integrated Waste Management Plan, which was approved by the CIWMB on April 10, 1997. The location of the facility is identified in the Countywide Siting Element, pursuant to Public Resources Code (PRC), Section 50001(a).
- b. This permit is consistent with the standards adopted by the CIWMB, pursuant to PRC 44010.
- c. The design and operation of the facility is consistent with the State Minimum Standards for Solid Waste Handling and Disposal as determined by the Local Enforcement Agency, pursuant to PRC 44009.
- d. The San Rafael Fire Department has determined that the facility is in conformance with applicable fire standards, pursuant to PRC, 44151.
- e. A CEQA document was filed with the State Clearinghouse (SCH #92103067) and certified by the San Rafael Planning Commission in January 1993. The CEQA document describes and supports the design and operation which will be authorized by the issuance of this permit. A Notice of Determination was filed with the State Clearinghouse in January 1993.
- f. The San Rafael Planning Commission has made a determination that the facility is consistent with, and designated in, the applicable General Plan as specified in Resolution 92-70 approved January 12, 1993. Public Resources Code, Section 50000.5(a).
- g. The San Rafael Planning Commission has made a written finding that surrounding land use is compatible with the facility operation, as required in Public Resources Code, Section 50000.5(b).

14. Prohibitions:

The permittee is prohibited from accepting the following wastes:

Hazardous, radioactive, medical (as defined in Chapter 6.1, Division 20 of the Health and Safety Code), liquid, designated, or other wastes requiring special treatment or handling, except as identified in the Report of Station Information and approved amendments thereto and as approved by the Local Enforcement Agency and other federal, state, and local agencies.

The permittee is additionally prohibited from the following activities:

- a. Scavenging
- b. Salvaging by the public
- c. Disposal of dead animals
- d. Open burning of wastes
- e. Acceptance of hot ashes

SOLID WASTE FACILITY PERMIT

Facility Number:

21-AA-0005

15. The following documents describe and/or restrict the operation of this facility:

DOCUMENT	DATE
Report of Station Information (RSI)	October 2003
Master Use Permit, City of San Rafael	December 1992
Bay Area Air Quality Management District Plant Number 2111 with two Permits to Operate: <ul style="list-style-type: none">• Number 6307• Number 5645 One Authority to Construct: <ul style="list-style-type: none">• Number 7089	Annual Renewal
Negative Declaration, Resolution No. 92-70, Clearinghouse No. 92103067	December 1992
Marin Municipal Water District Reclaimed Water Use Permit	April 26, 1993
Wastewater Discharge Permit No. 92-12 for Central Marin Sanitation Agency	September 1992

16. Self-Monitoring:

Results of all self-monitoring programs (as described below) will be available for review by the LEA and the CIWMB upon request during inspections:

1. Tons of waste received at the facility per day. (Tonnage at the Resource Recovery Center will be calculated from cubic yards and will be available within 24 hours of request.)
2. Tons of waste transferred for disposal per day.
3. Number of commercial, industrial, municipal vehicles delivering waste to the facility per day.
4. Number of private vehicles delivering to the facility per day.
5. Number of vehicles transferring waste for disposal per day.
6. Number of vehicles transporting materials off-site from material recovery operation per day.
7. Litter control program dates at Transfer Station and Resource Recovery Center. Names of streets and dates when cleaned.
8. Unscheduled shut-downs.
9. Delivery/attempted delivery of unpermitted and/or unacceptable waste.
10. Employee or customer injury.
11. Results of the hazardous waste screening program.
12. Tons of recycled material per category (glass, paper, wood, etc.) per month.
13. A log of special occurrences, (i.e. fires, structural damage, flooding) shall be maintained daily.

SOLID WASTE FACILITY PERMIT

Facility Number:

21-AA-0005

17. Local Enforcement Agency (LEA) Conditions:

- a. The operator shall comply with all State Minimum Standards for solid waste handling and disposal as specified in Titles 14 and 27, California Code of Regulations.
- b. The operator shall maintain a log of special/unusual occurrences. This log shall include, but is not limited to, fires, explosions, the discharge and disposition of hazardous or unpermitted wastes, and significant injuries, accidents or property damage. Each log entry shall be accompanied by a summary of any actions taken by the operator to mitigate the occurrence. The log shall be available to site personnel, the LEA and CIWMB at all times.
- c. Additional information concerning the design and operation of the facility shall be furnished upon request and within the time frame specified by the LEA.
- d. The maximum permitted daily tonnage for this facility is 2640 tons per day, and the facility shall not receive more than this amount without a revision of this permit.
- e. This permit is subject to review by the LEA and may be suspended, revoked, or revised at any time for sufficient cause.
- f. The LEA reserves the right to suspend or modify waste receiving and handling operations when deemed necessary due to an emergency, a potential health hazard, or creation of a public nuisance.
- g. Any change that would cause the design or operation of the facility not to conform to the terms and conditions of this permit is prohibited. Such a change may be considered a significant change, requiring a permit revision. In no case shall the operator implement any change without first submitting a written notice of the proposed change, in the form of an RSI amendment, to the LEA at least 150 days in advance of the change.
- h. The operator shall maintain a copy of this permit at the facility to be available at all times to facility personnel and Enforcement Agency personnel.
- i. Any hazardous waste recovered from the operations area shall be handled and removed in accordance with standards from the Department of Toxic Substances Control.
- j. This permit supercedes previous permit # 21-AA-0005 issued January 20, 1999.

<p>Attachment A SOLID WASTE FACILITY PERMIT</p> <p>Marin Sanitary Service Property Description</p>	Facility Name: MARIN SANITARY SERVICE TRANSFER STATION / MARIN RESOURCE RECOVERY CENTER	
	Facility Name: 21-AA-0005	Page 1 of 1

DESCRIPTION

All that certain real property situated in the City of San Rafael, County of Marin, State of California, described as follows:

BEGINNING at a point on the Northerly line of the Old County Road leading from San Rafael to San Quentin, now known as Jacoby Street, said point being distant South 44°17' East 206.943 feet from the most Southerly corner of that certain parcel described in Deed from J. E. Davis to Roland N. Fisher and recorded April 4, 1947, in Book 544 of Official Records at Page 374, Marin County Records;

running thence along the northerly right-of-way line of Jacoby Street South 42°48'27" East 88.09 feet; South 56°08'23" East 131.50 feet; South 70°35' East 46.19 feet; thence continuing South 70°35' East 117.47 feet; thence continuing South 70°35' East 105.69 feet; thence South 38°26'50" West 31.74 feet to a point on the centerline of Jacoby Street, formerly known as the San Rafael-San Quentin Toll Road 60' wide right of way;

thence along former centerline South 70°35' East 88.51 feet; South 36°08' East 187.60 feet; South 49°32' East 36.10 feet; thence South 15°02' West 37.97 feet; thence South 74°58' East 407.23 feet; thence North 15°52' East 72.13 feet to a point on the former centerline of the San Rafael-San Quentin Toll Road;

thence continuing North 15°52' East 63.05 feet; thence North 74°58' West 365.12 feet; thence North 38°25'50" East 500.96 feet to the southerly right-of-way line of Andersen Drive; thence along said right-of-way line North 49°05' West 300.31 feet; thence continuing North 49°05' West 100.00 feet; thence continuing North 49°05' West 112.76 feet; thence North 49°05' West 134.20 feet; thence northwesterly along a curve to the left, tangent to the preceding course an arc distance of 91.58 feet having a radius of 964.00 feet through a central angle of 05°26'35"; thence North 58°32'35" West 36.27 feet; thence South 38°18'17" West 663.47 feet to the POINT OF BEGINNING.

Attachment B
SOLID WASTE
FACILITY PERMIT

Marin Sanitary Service
Property Description

Facility Name:
MARIN SANITARY SERVICE
TRANSFER STATION / MARIN
RESOURCE RECOVERY CENTER

Facility Name:
21-AA-0005

Page 1 of 1

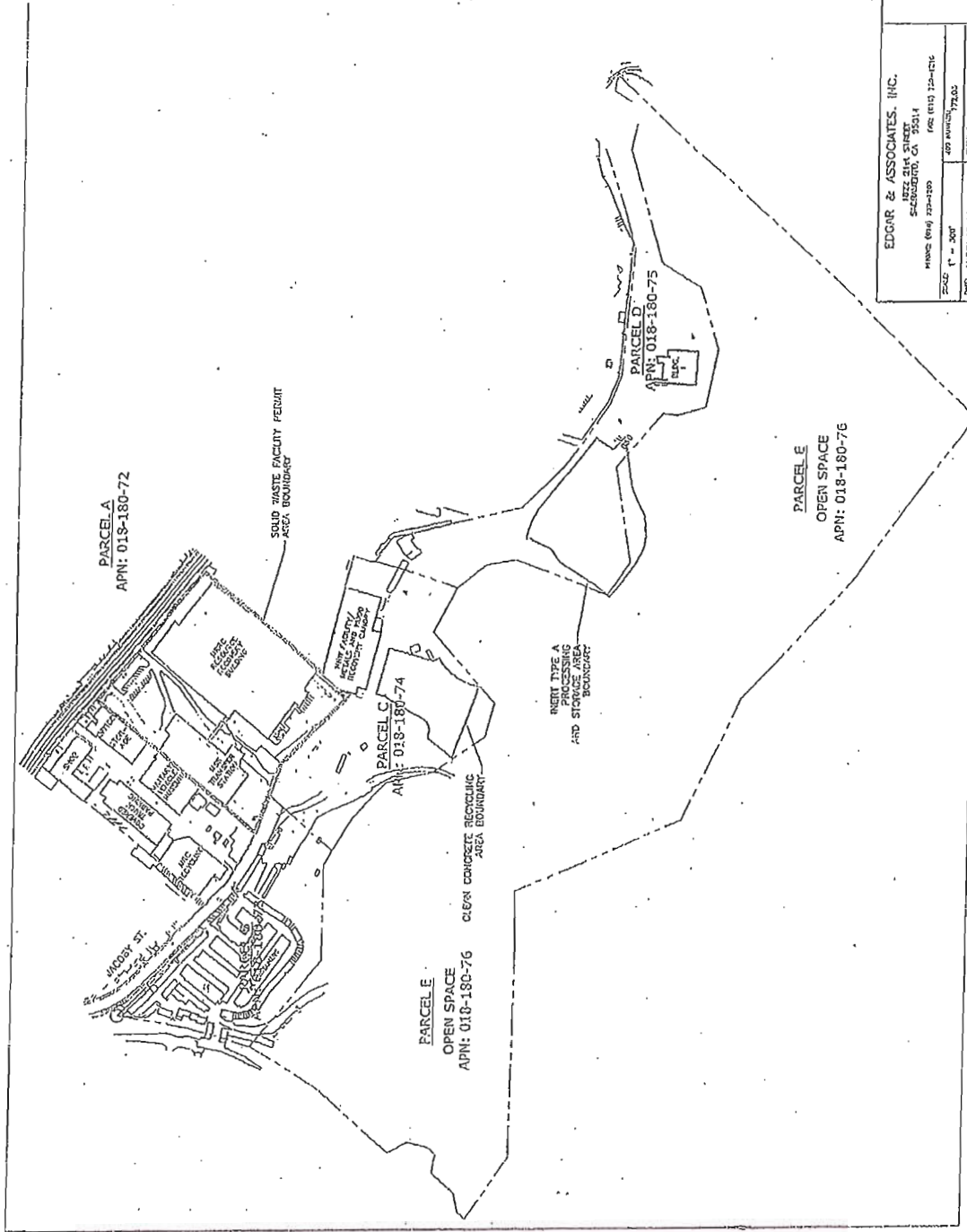

EDGAR & ASSOCIATES, INC. 1872 214 STREET SACRAMENTO, CA 95811 PHONE (916) 438-1100 FAX (916) 438-1116 SCALE 1" = 200'		MSS COMPLEX MAP SHEET NO. 3	
FOR: MARIN SANITARY SERVICE 300 ANDERSON DRIVE SAN RAFAEL, CALIFORNIA		DATE: 7/2/02	
DATE: 7/2/02	BY: JAVIER M. SOTO	DATE: 7/2/02	BY: JAVIER M. SOTO