

INFORMATION

SHICK TUBE-VEYOR CORPORATION'S durable Rotary Airlocks and Feeders are available in various materials of construction and are uniquely designed for a wide variety of applications. Airlocks are precision machined for close tolerances and are designed for gravity feeding applications, to hold pressure or vacuum in a system, and to meter material into or out of a pressure or vacuum conveying line. Shick's Feeders are used to meter material into pressure or vacuum conveying lines in applications where stack-up height is limited or where conveying air passing through the vanes assists in material discharge.

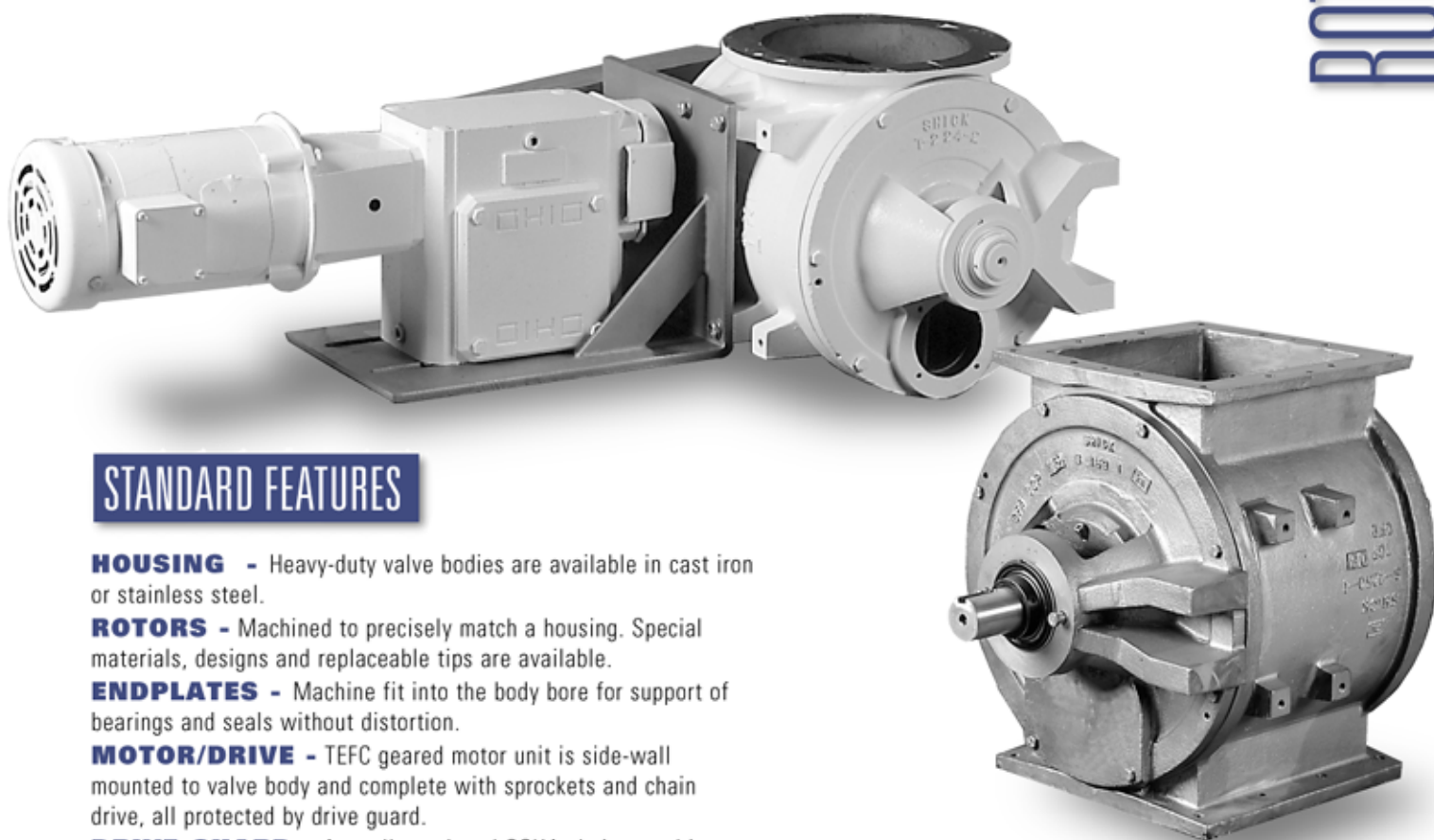

ROTARY VALVES



STANDARD FEATURES

HOUSING - Heavy-duty valve bodies are available in cast iron or stainless steel.

ROTORS - Machined to precisely match a housing. Special materials, designs and replaceable tips are available.

ENDPLATES - Machine fit into the body bore for support of bearings and seals without distortion.

MOTOR/DRIVE - TEFC geared motor unit is side-wall mounted to valve body and complete with sprockets and chain drive, all protected by drive guard.

DRIVE GUARD - A totally enclosed OSHA chain guard is provided.

SEALS - Valves are available with internal garlock or external Teflon with the option of air purge.

FLANGE - Available with round and square inlet and discharge, depending on applications and valve size.

SHICK TUBE-VEYOR CORPORATION

4346 Clary Boulevard • Kansas City, Missouri 64130 • P (816) 861-7224 • F (816) 921-1901

OPTIONS FOR

ROTORS: Heavy-duty, replaceable tips, reinforcement rods, pocket filler, quick-take-apart, seal protection plate.

SEAL PROTECTOR PLATE: Protects the seal area against abrasive material in a blow-thru application.

MOTORS: Variable speed drives, explosion-proof, double reduction, brake motors.

FINISHES: Exterior - white enamel (CI) or bead blast (S/S). Interior - machined cast iron, machined 304 S/S or 316 S/S, hard chrome plated cast iron, Teflon.

AIR PURGE KIT: Includes air purge ring, solenoid and filter regulator. For use with abrasive or fine materials to keep seal area clean.

EXTERNAL SEALS: For use in abrasive product applications.

FLOOR STAND: Provides support of airlock or feeder.

BLOW-THRU ADAPTER: Allows airlock to be directly connected to a customer-specified tube or pipe conveying line.

CAST PELLET FEEDER: Minimizes material sheer points at the inlet of an airlock.

NOTES:

1. Motors are available in sizes from 1/2 HP to 2 HP.
2. Explosion-proof motors are available in 1 HP and above.
3. All seal protector plates have a .002-.003 clearance.
4. Dimensions are without gaskets.
5. Maximum pressure not to exceed 14.7 psig, maximum vacuum 17 Hg.
6. Dimensions for airlocks and feeders are with maximum-sized motors.

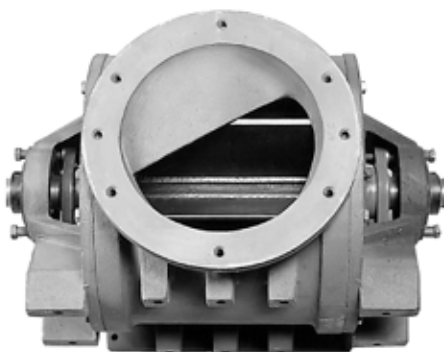

Cast Pellet Inlet

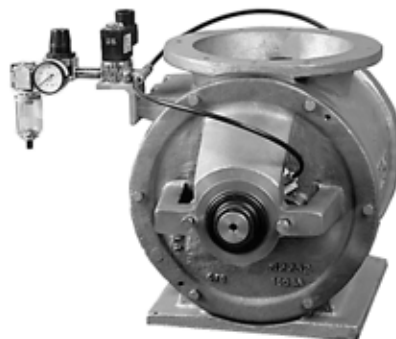

Air Purge Kit



Quick Take Apart

Information on this page is subject to change without notice. For additional information on this and other Shick Tube-Veyor products and services, please call Shick directly or your local representative.

HEADQUARTERS:

Shick Tube-Veyor Corporation
4346 Clary Boulevard, Kansas City, MO 64130
P (816) 861-7224 / F (816) 921-1901

Shick Tube-Veyor Asia Pacific PTE LTD
32 Ang Mo Kio Industrial Park 2
#02-03 Sing Industrial Complex, Singapore 569510
Tel: (65) 4824600 Fax: (65) 4818255
www.shicktube.com

REPRESENTED BY:



SCHEMATICS - AIRLOCK

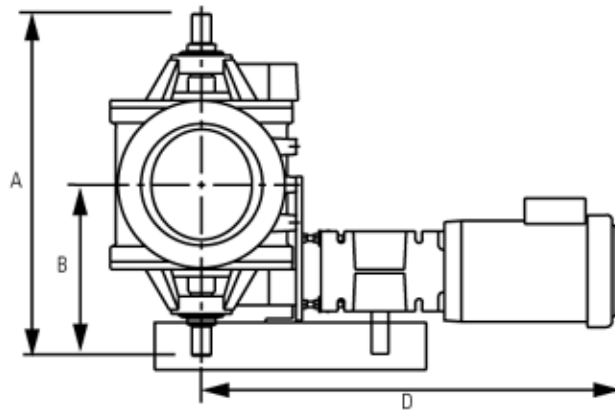
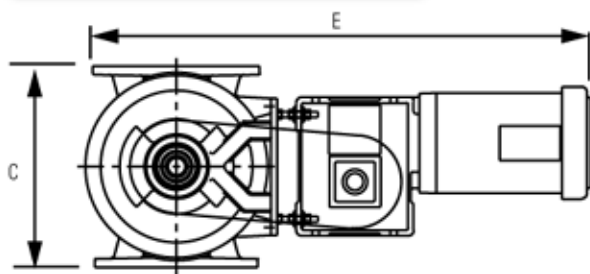

DIMENSIONS - AIRLOCK/FEEDER



Housing Style	020	075	700	1250	175	420	2000	420F	2000F	700F	685F	1250F
Cu. Ft. per Rev.	.020	.075	.745	1.23	.163	.432	1.75	.420	1.75	.745	.657	1.25
Vanes	6	8	8	8	8	8	8	8	8	8	8	8
Air Leakage PSI	1.8	2.6	5.53	6.32	3.33	4.57	7.56	4.57	7.56	5.53	5.21	6.32
Shaft Diam. In/mm	.75/19	1.1875/30	1.5/38	2/51	1.1875/30	1.25/32	2/51	1.25/32	2/51	1.5/38	1.25/32	1.5/38
Weight** Cl/304 S/S	50/70	75/95	280/300	490/510	90/110	160/180	530/550	160/180	530/550	280/300	210/230	490/510
A In/mm	8.5/216	16.375/416	26/660	29.5/749	18.25/464	22.5/572	34.5/876	21/533	34.5/876	24/610	30.4375/773	35/889
B In/mm	4.75/121	8.1875/208	13/330	14.75/375	9.125/232	11.25/288	17.25/438	11.625/295	17.25/438	13/330	15.2188/387	17.5/445
C In/mm	5.875/149	10/254	15.25/387	20/508	10/254	13.125/333	18.25/463	12.375/314	18.25/464	14.625/371	10.75/273	14.25/362
D In/mm	25.1875/640	27/686	33.5/851	35/889	27.125/689	29.625/752	35.75/908	29.625/752	35.75/908	33.5/851	28.625/727	32/813
E In/mm	27.9375/710	31.5/800	40.75/1035	44/1118	31.625/803	35.75/908	44.5/1130	35.75/908	44.5/1130	40.75/1035	36.125/918	39/991
F In/mm	-	-	-	-	-	-	-	3.75/95	6/152	4.25/108	3.375/86	4.25/108
Flange Style	A/A	B/B	C/C	C/C	A/B	A/B	A/C	A	A	C	D***	D
# of Mount Holes	4/4	8/8	12/12	12/12	6/8	6/8	6/12	6	6	12	18	14
Size of Holes/Tap	5/16 - 18	5/16 - 18	1/2 - 13	1/2 - 13	5/16 - 18	3/8 - 16	1/2 - 13	3/8 - 16	1/2 - 13	1/2 - 13	3/8 - 16	1/2 - 13
G (OD Round)	5.5/140	-	-	-	9/229	11/279	17/432	11/279	17/432	-	-	-
H (ID Round)	3.5/89	-	-	-	6/152	8/202	13/330	8/203	13/330	-	-	-
I Bolt Circle	4.75/121	-	-	-	8/203	9.75/248	15.5/394	9.75/248	15.5/394	-	-	-
J In/mm	-	8/203	14.5/368	14.5/368	8.125/206	10.75/273	16/406	-	-	14.5/368	15/381	14/356
K In/mm	-	5/127	10.5/267	10.5/267	5.125/130	7.75/197	12/305	-	-	10.5/267	9/229	9/229
L In/mm	-	7/178	14.5/368	13.5/343	9/229	11.125/283	16/406	-	-	14.5/368	17/432	21/533
M In/mm	-	4/102	10.5/267	10.5/267	6/225	8.125/206	12/305	-	-	10.5/267	12/305	16/406
N In/mm	-	3/76	4.125/105	4.125/105	4/102	5.1875/132	4.875/124	-	-	4.125/105	2.5/64	4.75/121
O In/mm	-	3.5/89	4.125/105	4.125/105	3.5/89	4.875/124	4.875/124	-	-	4.125/105	3/76	3/76

Note: all dimensional information shown in inches/millimeters

*Standard rotor & tips **Weights estimated for bare valve

FLANGES - AIRLOCK/FEEDER

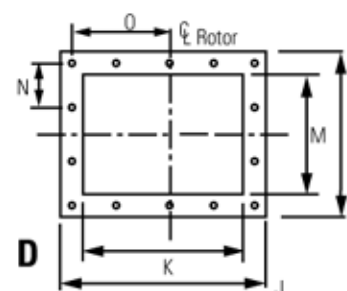
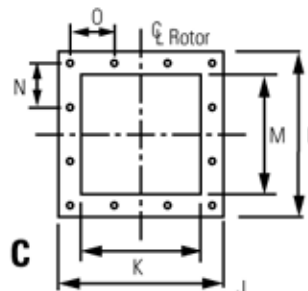
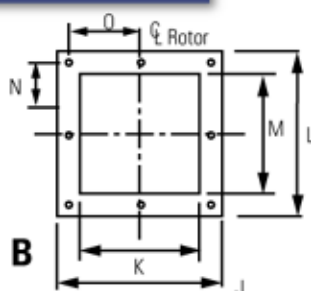
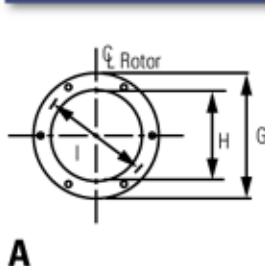

***685 18-hole flange not illustrated.

SCHEMATICS - FEEDER

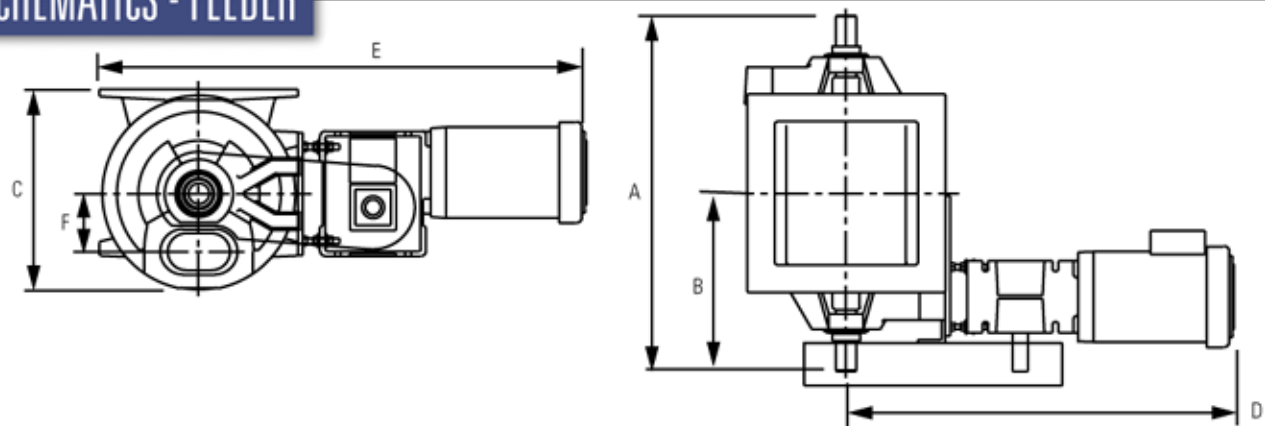

EXPLODED VIEWS

AIRLOCK

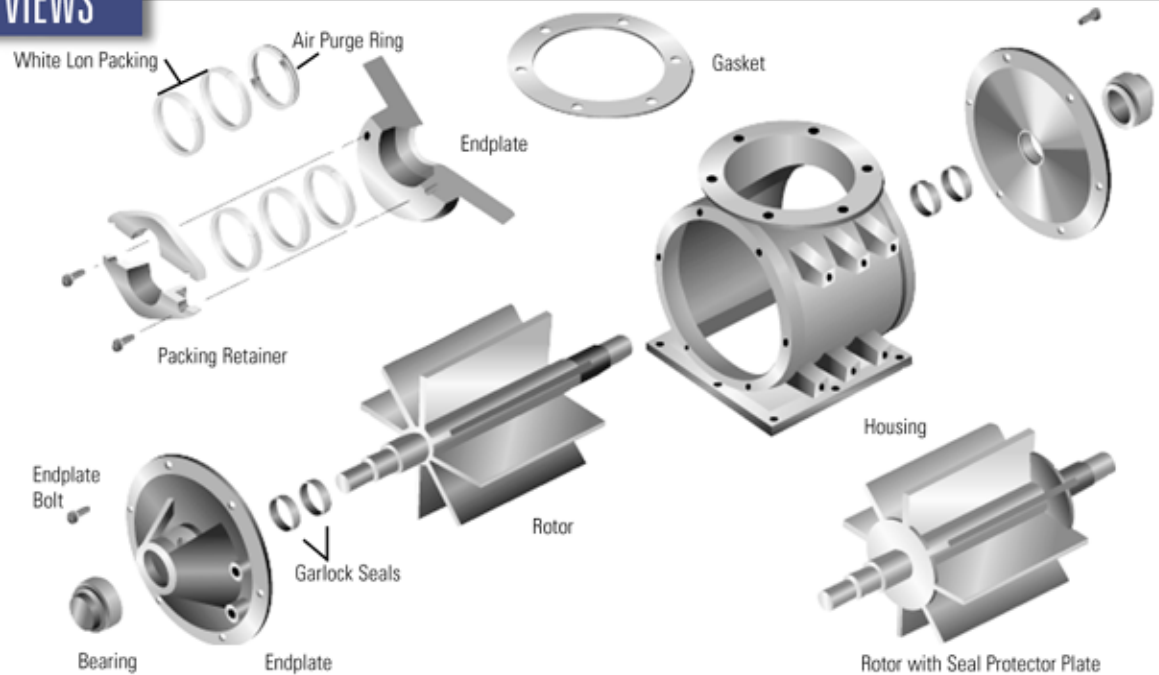

FEEDER

