

2016-17 FNA INFORMATION

Youth and Family Services — 100 S. Greenleaf St., Gurnee, IL 60031 — 847-244-1101 ext. *401

WELCOME

The parents of the FNA Planning Committee invite you and your child to another wonderful year of FNA Dances. If you wish to be involved in the planning or have any suggestions, please feel free to call 847-244-1101 x *401.

INSTRUCTIONS FOR THE CARD

Only students registered for the dances will be admitted. An Admission Card is required for quick entry into the dances. Those students who present the Admission Card will enter at no charge.

Inside, the students can use the open gym, dance, sing karaoke, eat pizza and hang out with their friends. The pizza slices are \$2.00 and the soda is \$1.00.

CHAPERONES

The most important part of ensuring that the dances are safe and orderly are the volunteer chaperones. Each dance requires a minimum of 30 chaperones. Parents who sign-up to chaperone will receive a *courtesy* reminder email two weeks before the dances. Exception: There will be no reminder notice sent for the first dance, please arrive at the designated time. If you have not received a reminder notice a week prior to the dance or wish to volunteer, please call us to confirm your attendance.

Arrival time for the chaperones is 6:30 pm and they will be checked against our masterlist. There will be a required orientation at 6:45 pm. Parents must attend the orientation to chaperone the dance. Please park on the Washington Street side at the west end of the parking lot.

COMMON QUESTIONS

What if my child's card is lost?

Cards may be replaced at the Youth Service's office for \$5.00. However, students are limited to 1 replacement Card during the year. Replacement cards may be purchased at the Youth Services office (100 S. Greenleaf St, Gurnee) anytime we are open.

What happens if a student hasn't registered?

Without the completed registration on record, the student cannot enter the dance.

What if a student is registered, but forgot to bring his/her card to the dance?

Students who are registered for 2016-2017 FNA will be admitted once checked against the master registration list. Please bring identification to expedite the process. Students who fail to bring an FNA Card should be prepared to wait until other students have entered the dance— which can result in missing 10-15 minutes of the dance.

Can a student let a friend borrow the card?

Under no circumstances can one student allow another student to borrow their card. **Use of another student's card may result in permanent suspension from the dances for both students.**

Can an out of the area guest of the student come along?

At no time may a student bring a guest who is not registered to the dance. The dance is intended for registered Warren Township students only.

How will I know if there are not enough chaperones and the dance is at risk of being cancelled?

Parents may go online or call for up-to-date information. Parents who provide an email will receive direct updates.

FOR UP TO DATE INFORMATION

www.wtyouthservices.com/fna-events

QUESTIONS OR WANT TO VOLUNTEER... CALL 847-244-1101 ext. *401 or
youthservices@warrentownship.net

PARENT ADVISORY COMMITTEE

The FNA Dance is a parent run event. If you have an interest in being an advisory committee member (Red Shirt) or making a suggestion for the committee to hear, please call Adam Krieger at 847-244-1101 ext. *402.

www.wtyouthservices.com/fna-events

DATES

All dates are subject to change during the school year — school events always take priority. There is no reimbursement for cancelled events. FNA events are not rescheduled, unless notified otherwise. Dates will not be confirmed until mid-August.

2016
Sept 30
Oct 21
Nov 11

2017
Feb 10
March 17
April 21

*If a December event is planned, you will be notified by email.

DANCE HOURS

Dance starts: 7:00 pm

Dance ends: 9:00 pm — No pick-up before 9:00 pm

CANCELLATION OF FNA EVENTS

Events may be cancelled due to weather, building conflicts or lack of chaperones.

We will make an effort to determine dance cancellations at least 24 hours in advance. However, weather related conditions frequently change quickly and dances may be cancelled the day of the event. It is the parents responsibility to check our website the day of the dance to confirm. There is no reimbursement for cancelled FNA events. The events are not rescheduled, unless notified prior.

Cancellation information is on our website and we send out email updates

Every situation will be individually assessed, but these are some basic guidelines for dance cancellation due to weather:

- **Forecasted severe weather conditions or a wind-chill 10°F or below**
- **A severe storm as defined as one that produces (6) six inches or more of snow in (48) forty-eight hours or less or damaging ice**
- **Advisories to remain off the roads**

DISCIPLINE & EMERGENCIES

Parents will be contacted immediately if a youth is to be discharged from the dance for any reason. If a medical emergency occurs, staff will attempt to contact the parents. If the parents are unavailable or the emergency requires immediate attention, emergency services will be contacted.

Please let us know if you change your address or phone numbers— 847-244-1101x *401 or email youthservices@warrentownship.net.

VALUABLE ITEMS

The Township is not responsible for lost or stolen items. We strongly recommend that items of value not be brought to the dance. When such items are brought to the dance, we encourage youth to keep the items on themselves (e.g., cell phones) or leave the items at the Item Check by the Girls Coat Check. Although coats are monitored, items left in coat pockets have an increased risk of being dislodged or stolen.

RULES

The following list is not exhaustive, but highlight of some important rules:

- Do not leave the building once you have entered or leave the grounds when dropped off
- No articles of cloth that have metal studs or chains that may pose a risk to other students
- Skirt/short length should be approximately no higher than fingertips, spaghetti straps, no exposed navels, halter tops or exposed bra straps
- No clothing representing alcohol, tobacco, drugs, gangs, violence or sex is be allowed
- All carry-in articles (hats, purses, backpacks, etc.) must be checked in at the Item Check
- Students must have a ride home or be escorted by an adult on foot
- Students must be picked-up at the designated areas—no leaving the area to meet a parent
- Students not picked up by 10:00 pm risk being taken to the Gurnee Police Department to be picked-up by the parents
- Students entering the events are subject to having their items searched and seized
- Cell phones must be kept in the pockets and only used outside or in designated area at the entrance
- No running, pushing or “grinding” on the dance floor
- We discourage Flip-Flops and open toe shoes (feet get stomped in the dance area)

If clothing appears inappropriate, the child may be directed to cover or change the item. Parents should error on the side of modesty.

www.wtyouthservices.com/fna-events

FNA Pick-up Instructions

Pick-up Options

1. Curbside Pick-up

Please follow the directions of the traffic attendants and the posted signs— the traffic will be kept moving in an orderly manner. We strongly encourage the use of *car pools and cell phones (see cell phone policy under Rules)*. Finally, remember that all of the traffic attendants are volunteers and make every effort to keep the traffic moving— so please be patient and expect long pick-up times (45 minutes to an hour minimum).

Woodland Middle School is located at the corner of Almond and Washington, in Gurnee. Enter from Almond Street for drop-off and pick-up. Students will line-up along the sidewalk on the south side of the school for pick-up.

Please make certain that you're children are properly dressed for the weather conditions because they will not be allowed to wait inside.

2. Park and Pick-up

Parents may park at Warren Township Center (kitty-corner to the school—entrance on Almond) and cross Almond and Washington with the assistance of assigned crossing guards. There are approximately 250+ parking spaces, however, there will be no traffic management on the Township property. Parents who choose this option must walk over to the school to get their children—no children will be allowed to leave the middle school property without an adult escort.

Students Who Walk Home: *Students who live near the dance and wish to walk home must do so with an adult— no student will be allowed to walk home on their own*

Dangerous Weather Pick-Up

Please prepare your child to wait outside in inclement weather conditions (such as rain and snow).

In case of severe changes in the weather conditions, parents may be asked to park and pick up in the gym. Please be patient and follow any directions provided.

www.wtyouthservices.com/fna-events

WE LOOK FORWARD TO A FUN AND SAFE YEAR!!!!

Warren Township Parking

Park and Pick-up Parking

Warren Township Parking

Almond Street

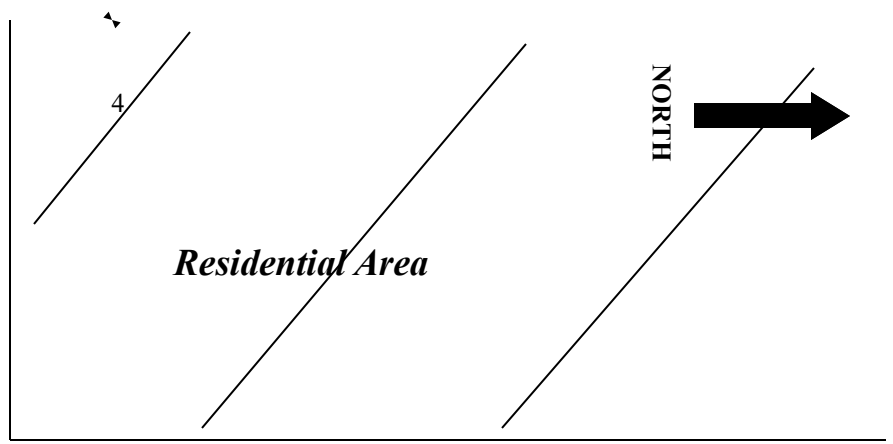

Residential Area

Almond Street

Crossing at the light

Residential Area

Washington Street

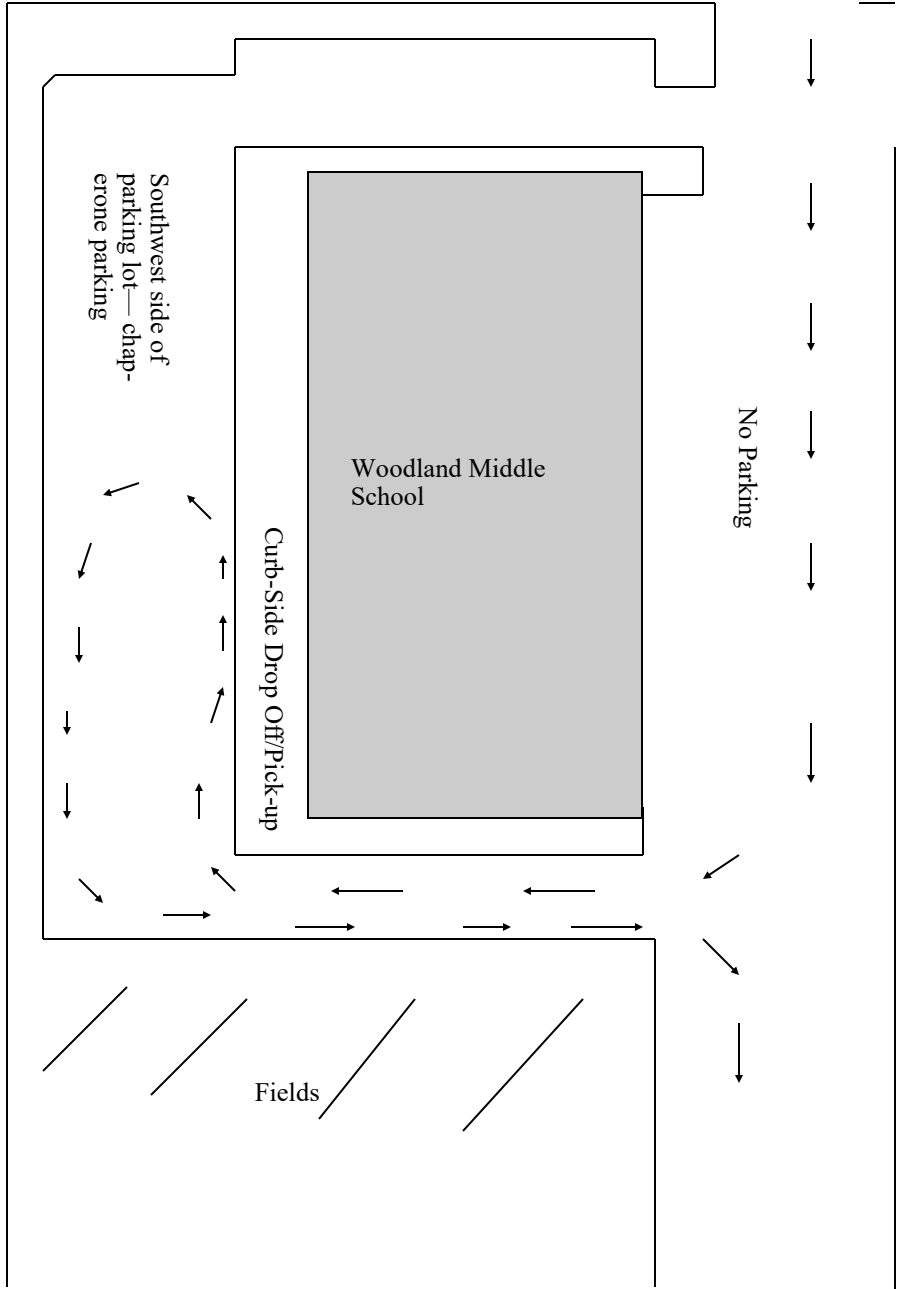

Woodland Middle School

No Parking

Fields

4

TRAFFIC IS MANAGED BY LAKE COUNTY SHERRIF RESERVES