

DRAWING YOUR FLOOR PLAN

We want to design your project accurately from the beginning. You can help us by providing a floor plan. Using the grid indicate your floor plan and record the following dimensions and the location of doors, windows and appliances.

FLOOR PLAN INFORMATION

- Begin by roughly drawing the shape of your room on a plain sheet of paper or a copy of the grid. Add doors, windows, breaks in the wall and all obstructions. Indicate in which direction doors swing and where they lead. Note utility connections, ducts, outlets, lighting fixtures vents and radiators. Record all details in inches on your rough drawing. (see example below)

- Start in one corner of the room, select a wall, and measure the distance in inches, of every item on that wall from the corner. Write all measurements on your sketch. (see example below)
- Continue to measure all around the room until everything is located, measured and marked on your sketch.
- Indicate the overall length of walls, height of the walls and the distance of everything from the floor—like outlets, light switches, ledges and soffits. For new construction, remember to take into consideration sheetrock thickness.
- Check that you correctly measured your room by adding your measurements for each wall and comparing them to the opposite wall.
- Include dimensions of islands or peninsulas.

TRANSFER YOUR INFORMATION

- Using the grid, transfer the information from your sketch. Use the example below as a guide as to what dimensions are necessary to complete your design. Cross check your layout with your measured sketch.

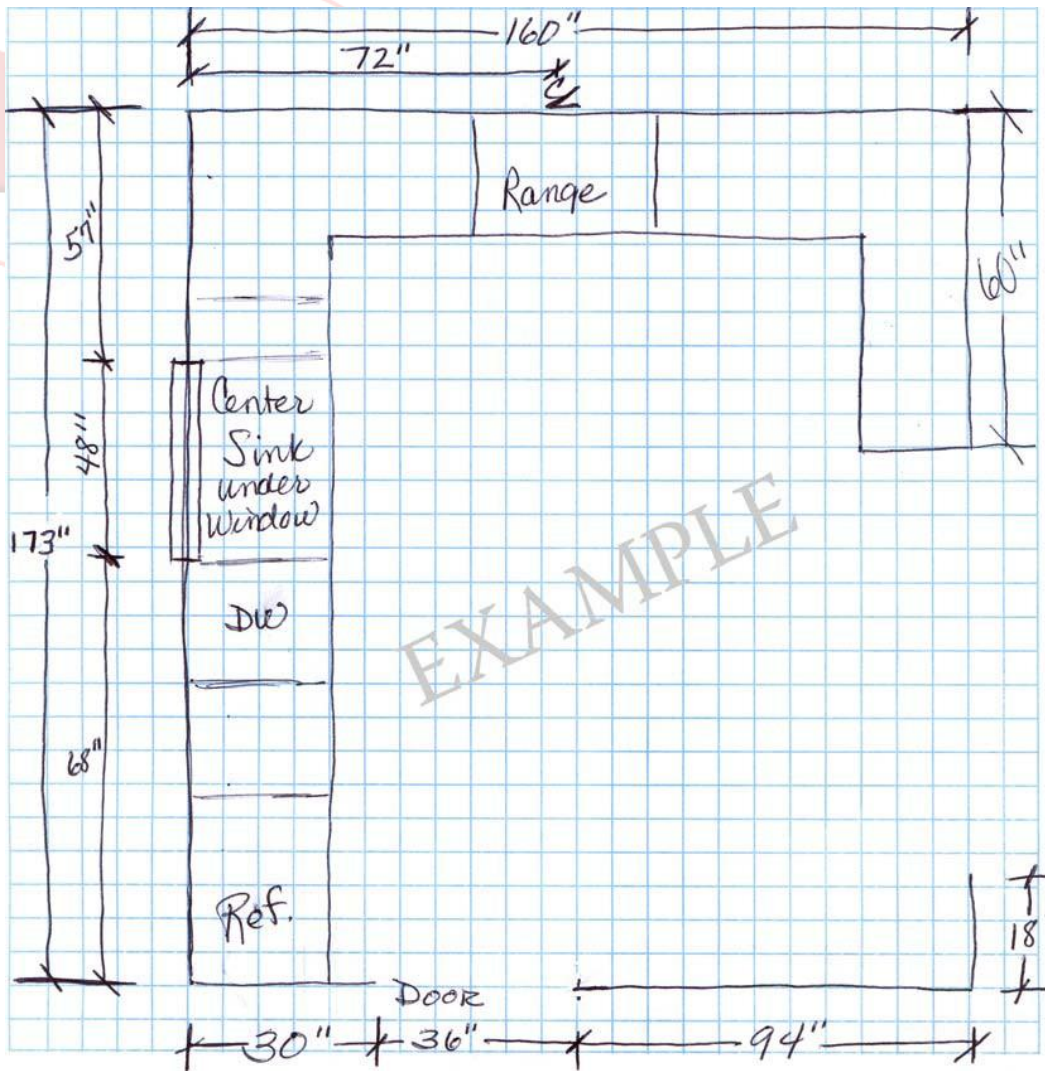

ath
home

EXAMPLE

FLOOR PLAN

So that your sketch is legible after faxing, please use this specially designed floor plan grid instead of other grid paper; and use ink; pencil marks don't fax well.

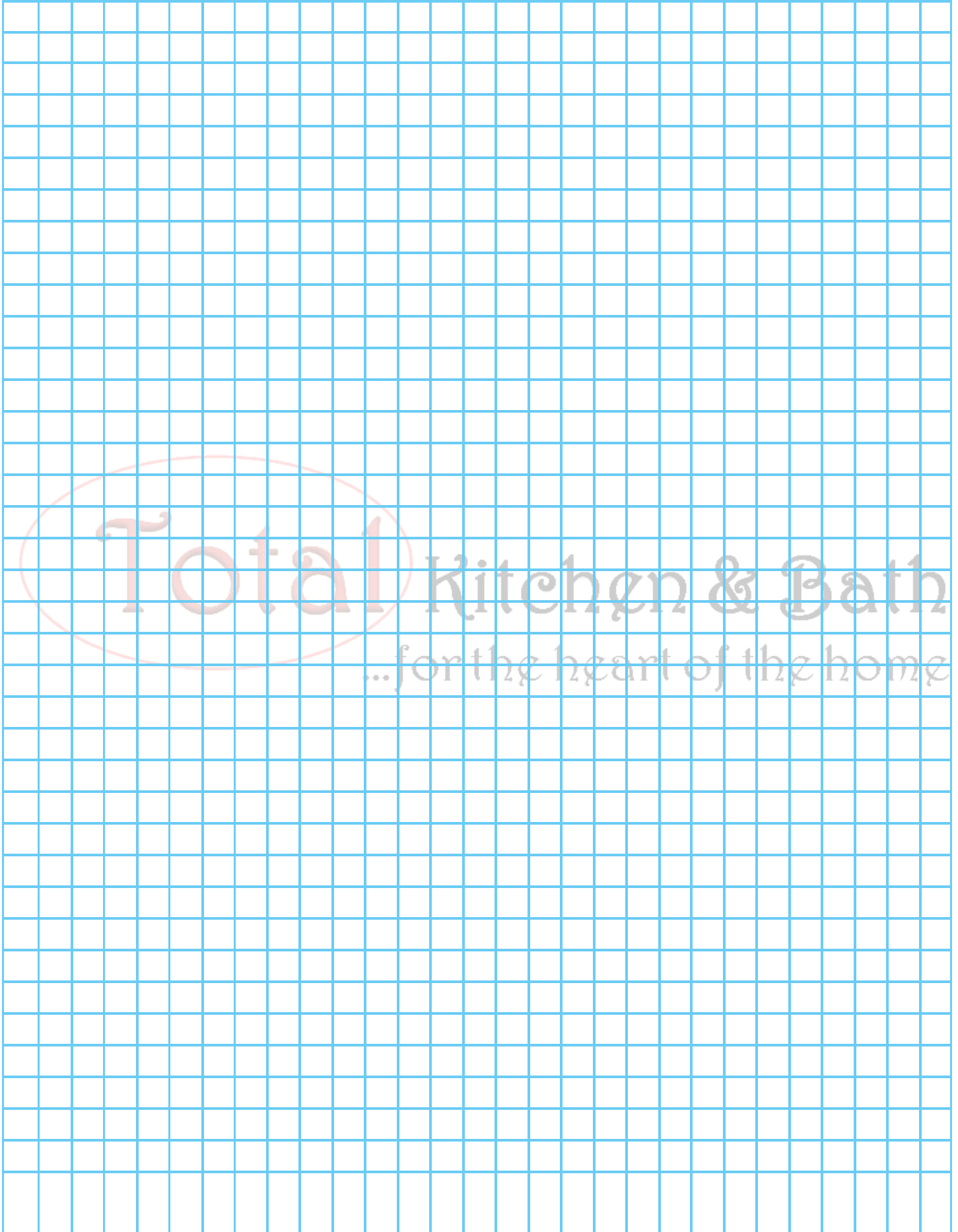

Total

Kitchen & Bath

...for the heart of the home

APPLIANCE SPECIFICATIONS

I'm considering this	I've chosen this	Brand and Model	DIMENSIONS			Decorative Appliance Panels?	Other Information
			Width	Height	Depth		
<input type="checkbox"/>	<input type="checkbox"/>	Refrigerator				YES or NO	
<input type="checkbox"/>	<input type="checkbox"/>	Mini fridge					
<input type="checkbox"/>	<input type="checkbox"/>	Fridge drawer					
<input type="checkbox"/>	<input type="checkbox"/>	Range					
<input type="checkbox"/>	<input type="checkbox"/>	Range Hood					
<input type="checkbox"/>	<input type="checkbox"/>	Cook top					
<input type="checkbox"/>	<input type="checkbox"/>	Single Oven					
<input type="checkbox"/>	<input type="checkbox"/>	Double Oven					
<input type="checkbox"/>	<input type="checkbox"/>	Microwave					
<input type="checkbox"/>	<input type="checkbox"/>	Microwave Space Saver					
<input type="checkbox"/>	<input type="checkbox"/>	Dishwasher One				YES or NO	
<input type="checkbox"/>	<input type="checkbox"/>	Dishwasher Two				YES or NO	
<input type="checkbox"/>	<input type="checkbox"/>	Sink					Single or Double Bowl?
<input type="checkbox"/>	<input type="checkbox"/>	Auxiliary Sink					Location:
<input type="checkbox"/>	<input type="checkbox"/>	Compactor				YES or NO	
<input type="checkbox"/>	<input type="checkbox"/>	Ice Maker					
<input type="checkbox"/>	<input type="checkbox"/>	Built in coffee maker					
<input type="checkbox"/>	<input type="checkbox"/>	Wine Cooler					
<input type="checkbox"/>	<input type="checkbox"/>	Warming Drawer					
<input type="checkbox"/>	<input type="checkbox"/>	Washer					
<input type="checkbox"/>	<input type="checkbox"/>	Dryer					
<input type="checkbox"/>	<input type="checkbox"/>	Television					
<input type="checkbox"/>	<input type="checkbox"/>	Other					
<input type="checkbox"/>	<input type="checkbox"/>	Other					

AN IMPORTANT NOTE ABOUT APPLIANCES We want your cabinetry order to proceed on a timely basis, so please provide complete appliance information as early as possible in the design process.



155 S Rohlwing Rd, Addison IL 60101
 Ph: 630 495 2010
 Email: info@totalstonesolutions.com
 www.totalkitchenbath.com