

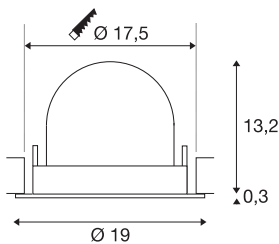

## NUMINOS® GIMBLE XL

black recessed ceiling light, 2700K 20°

NUMINOS is the best possible coordinated light system from SLV that combines function, design and technology. The various downlights and spotlights make a thousand lighting design options possible. Like with the NUMINOS® GIMBLE XL recessed ceiling light, which impresses with its high-quality workmanship and light. In this way, you can create unobtrusive, modern and space-saving lighting that draws the focus to objects or the room. Installation is then done in no time at all. When do you choose NUMINOS ® from SLV?



## TECHNICAL DATA

Item no.:	1006029
Number of different light outlets	1
Secondary power / secondary voltage	1000/1050mA
Height	13.5 cm
Diameter	19 cm
Installation diameter	17.5 cm
Installation depth	13.5 cm
Net weight	0.85 kg
Gross weight	0.91 kg
Safety class	III
Assembly	Recessed
Assembly details	Ceiling
Wattage	37.4 W
Lumen	3300 lm
Colour temperature	2700 Kelvin
Beam angle	20 °
Color	black
CRI	90
UGR ≤	22
BIG WHITE Page	57

## Light Source

791857	
--------	--

## Accessories

1004059	LED driverm 40W multi mA
1004066	LED driver , 28-40W 1000mA PHASE
1004071	LED driver 4.2-50W 1050mA DALI
1004798	NUMINOS® XL , diffuser Ellipse
1004799	NUMINOS® XL , diffuser Prisma
1004800	NUMINOS® XL , diffuser Frosted
1004801	NUMINOS® XL , diffuser Wabe
1006151	Numinos® XL Mounting Frame , round 240/180mm black
1006152	Numinos® XL Mounting Frame , round 240/180mm white
1006153	Numinos® XL Mounting Frame , square 240/180mm black
1006154	Numinos® XL Mounting Frame , square 240/180mm white