

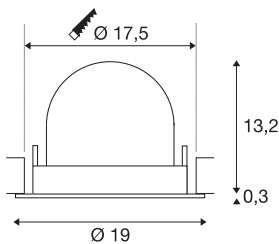

## NUMINOS® GIMBLE XL

black / white recessed ceiling light, 3000K 20°

The NUMINOS light system from SLV skilfully combines function, design and technology. This way, you can experience a thousand lighting design possibilities with different downlights and spotlights. Also with the NUMINOS® GIMBLE XL recessed ceiling light, which convinces with the best workmanship and lighting quality. Ideal for harmonious, modern and space-saving lighting that directs the accent to objects or the room. Installation is then done in no time at all. When to choose NUMINOS from SLV – modular diversity awaits you.



### TECHNICAL DATA

Item no.:	1006048
Number of different light outlets	1
Secondary power / secondary voltage	1000/1050mA
Height	13.5 cm
Diameter	19 cm
Installation diameter	17.5 cm
Installation depth	13.5 cm
Net weight	0.85 kg
Gross weight	0.91 kg
Safety class	III
Assembly	Recessed
Assembly details	Ceiling
Wattage	37.4 W
Lumen	3550 lm
Colour temperature	3000 Kelvin
Beam angle	20 °
Color	black
CRI	90
UGR ≤	22
BIG WHITE Page	57



## Light Source

791823	
--------	---

## Accessories

1004059	LED driverm 40W multi mA
1004066	LED driver , 28-40W 1000mA PHASE
1004071	LED driver 4.2-50W 1050mA DALI
1004798	NUMINOS® XL , diffuser Ellipse
1004799	NUMINOS® XL , diffuser Prisma
1004800	NUMINOS® XL , diffuser Frosted
1004801	NUMINOS® XL , diffuser Wabe
1006151	Numinos® XL Mounting Frame , round 240/180mm black
1006152	Numinos® XL Mounting Frame , round 240/180mm white
1006153	Numinos® XL Mounting Frame , square 240/180mm black
1006154	Numinos® XL Mounting Frame , square 240/180mm white

