

# Healthcare Hardware

PRODUCT CATALOG



Experience a safer  
and more open world

# Table of Contents

## Cylindrical Locks

[CLX3300 Series with BHSS Trim ..... 3](#)

## Mortise Locks

[ML2000, ML20900 ECL and ML20600 NAC Series with BHSS Trim ..... 4](#)

[ML2000, ML20900 ECL and ML20600 NAC Series with BLSS Trim ..... 5](#)

[ML2000 and ML20900 Series with HSS Trim ..... 6](#)

[ML2000, ML20900 ECL and ML20600 NAC Series with HPSK Trim ..... 7](#)

## Tubular Lock

[HP3000 Series Tubular Lock with Push/Pull Paddle Trim ..... 8](#)

[Cylinders, Latches, Strikes and Options ..... 9](#)

[Thumbturns ..... 10](#)

[How to Order ..... 11](#)

[Quick Codes ..... 12](#)

[Architectural Specifications ..... 13-14](#)

Any retrofit or other field modification to a fire rated opening can potentially impact the fire rating of the opening, and Corbin Russwin makes no representations or warranties concerning what such impact may be in any specific situation. When retrofitting any portion of an existing fire rated opening, or specifying and installing a new fire-rated opening, please consult with a code specialist or local code official (Authority Having Jurisdiction) to ensure compliance with all applicable codes and ratings.

 **WARNING**

This product can expose you to lead which is known to the state of California to cause cancer and birth defects or other reproductive harm. For more information go to [www.P65warnings.ca.gov](http://www.P65warnings.ca.gov).

# Features

## CLX3300 SERIES WITH BHSS TRIM\*

Part of the Behavioral Health Series®, the CLX3300 Series cylindrical lock with BHSS trim features tapered surfaces and an integrated lever and escutcheon to help reduce catch points in behavioral health spaces. Its robust Grade 1 construction delivers long-lasting performance in demanding environments.





### FEATURES

<b>Handing</b>	Handed - Must specify on order.
<b>Door Thickness</b>	1-3/4" (44mm) - 2" (51mm) standard.
<b>Backset</b>	2-3/4" (70mm) backset w/ 1-1/8" front (standard). Optional backsets available; see Quick Codes, page 12.
<b>Minimum Stile</b>	8-1/2" (216mm).
<b>Latchbolt</b>	Stainless steel, 1/2" (13mm) throw.
<b>Strike</b>	Stainless steel. ANSI curved lip standard, 4-7/8" (124mm) x 1-1/4" (32mm) x 1-1/4" (32mm) lip to center. Optional strikes, lip lengths and ANSI wrought strike box available.
<b>Front</b>	Stainless steel. Accommodates flat doors and doors beveled 1/8" in 2" (3mm in 51mm). 2-1/4" x 1-1/8" (57mm x 29mm) standard for 2-3/4" (70mm), 3-3/4" (95mm) and 5" (127mm) backset. 2-1/4" x 1" (57mm x 25mm) standard for 2-3/8" (60mm) backset.
<b>Fasteners</b>	Security pin Torx® standard for exposed fasteners.
<b>Lever &amp; Escutcheon</b>	Cast stainless steel.
<b>Freewheeling Trim</b>	When locked, outside trim will freely rotate. For rigid levers, specify Quick Code M200.
<b>Cylinder</b>	Brass, 6-pin L4 keyway, 0-bitted standard. LFIC and SFIC available.
<b>Keys</b>	Two nickel silver change keys per lock standard.
<b>Masterkeying</b>	Can be master keyed or grand master keyed. Construction key systems available.
<b>Functions</b>	Available with the following functions: CLX3310, CLX3330, CLX3332, CLX3351, CLX3355, CLX3357, CLX3361, CLX3375, CLX3382, CLX33903, CLX33905. Refer to the CLX3300 Series cylindrical lock catalog ( <a href="#">45628</a> ) for function descriptions
<b>Warranty</b>	Ten-year limited. Two-year limited warranty on electronic components.

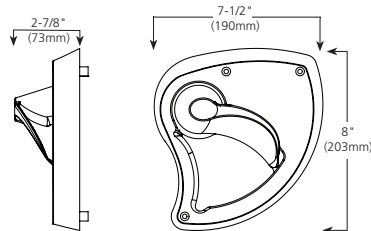
### Trim Dimensions



### CERTIFICATION/COMPLIANCE

<b>ANSI/BHMA</b>	Certified A156.2 (2022) Series 4000 – Grade 1 
<b>A.D.A.</b>	Conforms to ADA requirements for barrier-free accessibility. 
<b>UL/cUL</b>	UL/cUL listed to US and Canadian safety standards for 3 hour doors up to 4' x 10'
<b>NFPA 80</b>	Conforms for life safety and property protection, Standard for Fire Doors and Other Opening Protectives
<b>Positive Pressure</b>	Meets ANSI/UL 10C, Positive Pressure Fire Test of Door Assemblies

\*Although this product is better designed for behavioral health applications than traditional trim, it does not eliminate the risk that an object can be affixed to, or around it. A lockset function that requires a push/turn button may introduce a ligature opportunity.

# Features

## ML2000, ML20900 ECL AND ML20600 NAC SERIES WITH BHSS TRIM\*



As part of the Behavioral Health Series®, the ML2000 Series mortise lock with BHSS trim combines tapered surfaces with an integrated lever and escutcheon to support ligature-resistance goals in behavioral health facilities. The heavy-duty ML2000 platform and Grade 1 performance provide reliable security in high-use areas.

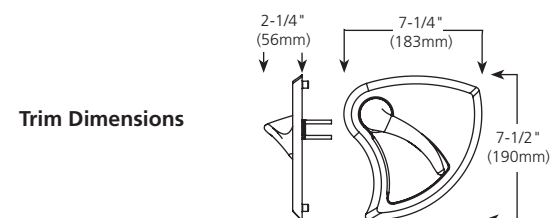

FEATURES	
<b>Handing</b>	Handed - Must specify on order.
<b>Door Thickness</b>	1-3/4" (44mm) standard. Optional door thicknesses available; see Quick Codes, page 12.
<b>Backset</b>	2-3/4" (70mm).
<b>Lockcase</b>	Heavy-gauge steel, 5-7/8" (149mm) x 4" (102mm) x 15/16" (24mm).
<b>Front</b>	Heavy-gauge steel, 8" (203mm) x 1-1/4" (32mm) x -3/32" (2mm). Accommodates flat doors and doors beveled 1/8" (3mm) in 2" (51mm).
<b>Armored Front</b>	Wrought stainless steel attached by machine screws to lockcase front. Utilizes security Torx® screws. Torx® screws come standard.
<b>Latchbolt</b>	2-piece mechanical with anti-friction insert, 5/8" (16mm) x 1" (25mm) x 3/4" (19mm) throw.
<b>Auxiliary Latchbolt</b>	9/16" (14mm) effective throw and 3/8" (10mm) effective auxiliary latch deadlocking.
<b>Deadbolt</b>	One-piece stainless steel, 19/32" (15mm) x 1-1/4" (32mm) x 1" (25mm) throw.
<b>Hub</b>	Lever: steel, 5/16" (8mm).
<b>Lever &amp; Escutcheon</b>	Cast stainless steel.
<b>Strike</b>	Wrought stainless steel, ANSI straight lip standard, 4-7/8" (124mm) x 1-1/4" (32mm) x 1-1/8" (29mm) lip to center. Optional strikes, lip lengths and ANSI wrought strike box available.
<b>Thumbturn</b>	Cast stainless steel construction. See page 10.
<b>Cylinder</b>	Brass, 6-pin, L4 keyway, 0-bitted standard. Optional cylinders available
<b>Keys</b>	Two nickel silver standard.
<b>Masterkeying</b>	Can be master keyed or grand master keyed. Construction key systems available.
<b>Functions</b>	Available with all ML2000 functions except ML2050, ML2070, ML2080 and ML2087. Available with all ML20900 electrified mortise lock functions. Refer to the ML2000 mortise lock catalog ( <a href="#">45300</a> ) for function descriptions.
<b>Electrical Specifications (Fail Safe/Fail Secure)</b>	12/24VDC @ 15mA Continuous 12/24VDC Peak current draw = .5A (Maximum of 2 locks per 1A Power Supply). Monitor Switch Rating: 2 amp @ 24VDC. Note: Operating voltage not to exceed +/- 10%. Fail Safe (SAF) or Fail Secure (SEC).
<b>Monitor Options</b>	See Quick Codes, page 12.
<b>Motorized Electric Latch Retraction (MELR)</b>	Available for ML2010, ML2032 and ML2057 functions. Refer to ML2000 mortise catalog ( <a href="#">45300</a> ) for feature details.
<b>Warranty</b>	Ten-year limited. Five-year limited warranty on MELR. Two-year limited warranty on electronic components.



## CERTIFICATION/COMPLIANCE

<b>ANSI/BHMA</b>	Certified A156.13 Series 1000, Operational and Security Grade 1. Meets A117.1 Accessibility Code. 
<b>A.D.A.</b>	Conforms to ADA requirements for barrier-free accessibility. 
<b>UL-cUL-UL10C Positive Pressure</b>	All locks listed for A label and lesser class doors, 4' (122cm) x 10' (305cm) single or 8' (244cm) x 10' (305cm) pair. Letter F and UL symbol on armored front indicate listing.

\*Although this product is better designed for behavioral health applications than traditional trim, it does not eliminate the risk that an object can be affixed to, or around it.

# Features

## ML2000, ML20900 ECL AND ML20600 NAC SERIES WITH BLSS TRIM\*

Part of the Behavioral Health Series®, the ML2000 Series mortise lock with BLSS trim delivers strength and durability for behavioral healthcare applications. Sloped surfaces and the overlapping lever and rose design help address common ligature concerns while a wide range of functions supports many door types throughout the facility.



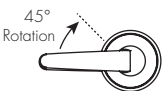

### FEATURES

<b>Handing</b>	Non-handed.
<b>Door Thickness</b>	1-3/4" (44mm) standard. Optional door thicknesses available; see Quick Codes, page 12.
<b>Backset</b>	2-3/4" (70mm).
<b>Lockcase</b>	Heavy-gauge steel, 5-7/8" (149mm) x 4" (102mm) x 15/16" (24mm).
<b>Front</b>	Heavy-gauge steel, 8" (203mm) x 1-1/4" (32mm) x -3/32" (2mm). Accommodates flat doors and doors beveled 1/8" (3mm) in 2" (51mm).
<b>Armored Front</b>	Wrought stainless steel attached by machine screws to lockcase front. Utilizes security Torx® screws. Torx® screws come standard.
<b>Latchbolt</b>	2-piece mechanical with anti-friction insert, 5/8" (16mm) x 1" (25mm) x 3/4" (19mm) throw.
<b>Auxiliary Latchbolt</b>	9/16" (14mm) effective throw and 3/8" (10mm) effective auxiliary latch deadlocking.
<b>Deadbolt</b>	One-piece stainless steel, 19/32" (15mm) x 1-1/4" (32mm) x 1" (25mm) throw.
<b>Hub</b>	Lever: steel, 5/16" (8mm). Cast stainless steel. Inside and outside levers rotate freely up and down at 45 degrees release feature: lever freely rotates up to 45°.
<b>Lever</b>	
<b>Rose</b>	Cast stainless steel.
<b>Strike</b>	Wrought stainless steel, ANSI straight lip standard, 4-7/8" (124mm) x 1-1/4" (32mm) x 1-1/8" (29mm) lip to center. Optional strikes, lip lengths and ANSI wrought strike box available.
<b>Thumbturn</b>	Cast stainless steel construction. See page 10.
<b>Cylinder</b>	Brass, 6-pin, L4 keyway, 0-bitted standard. Optional cylinders available.
<b>Keys</b>	Two nickel silver standard.
<b>Masterkeying</b>	Can be master keyed or grand master keyed. Construction key systems available.
<b>Functions</b>	Available with all ML2000 functions except ML2050, ML2070, ML2080 and ML2087. Available with all ML20900 electrified mortise lock functions. Refer to the ML2000 mortise lock catalog ( <a href="#">45300</a> ) for function descriptions.
<b>Electrical Specifications (Fail Safe/Fail Secure)</b>	12/24VDC @ 15mA Continuous. 12/24VDC Peak current draw = .5A (Maximum of 2 locks per 1A Power Supply). Monitor Switch Rating: 2 amp @ 24VDC. Note: Operating voltage not to exceed +/- 10%. Fail Safe (SAF) or Fail Secure (SEC).
<b>Monitor Options</b>	See Quick Codes, page 12.
<b>Motorized Electric Latch Retraction (MELR)</b>	Available for ML2010, ML2032 and ML2057 functions. Refer to ML2000 mortise catalog ( <a href="#">45300</a> ) for feature details.
<b>Warranty</b>	Ten-year limited. Five-year limited warranty on MELR. Two-year limited warranty on electronic components.

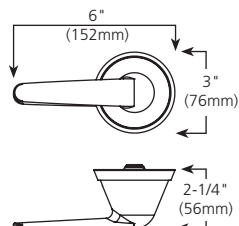
### Trim Dimensions



### CERTIFICATION/COMPLIANCE

<b>ANSI/BHMA</b>	Certified A156.13 Series 1000, Operational and Security Grade 1. Meets A117.1 Accessibility Code. 
<b>A.D.A.</b>	Conforms to ADA requirements for barrier-free accessibility. 
<b>UL-cUL-UL10C Positive Pressure</b>	All locks listed for A label and lesser class doors, 4' (122cm) x 10' (305cm) single or 8' (244cm) x 10' (305cm) pair. Letter F and UL symbol on armored front indicate listing.

\*Although this product is better designed for behavioral health applications than traditional trim, it does not eliminate the risk that an object can be affixed to, or around it.

# Features

## ML2000 AND ML20900 SERIES WITH HSS TRIM\*

The anti-harm knob (HSS) trim is engineered to minimize catch points with a tapered, recessed knob, tapered thumbturn option, and concealed fasteners. Paired with the ML2000 Series Grade 1 mortise lock, it offers a secure, ligature-conscious solution for psychiatric and detention environments.

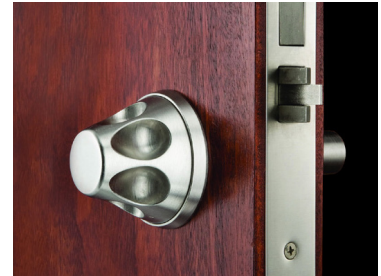

### FEATURES

<b>Handing</b>	Handed; quick reversible. The lockset can be re-handed without disassembling the lock case.
<b>Door Thickness</b>	1-3/4" (44mm) standard. Optional door thicknesses available; see Quick Codes, page 12.
<b>Backset</b>	2-3/4" (70mm).
<b>Lockcase</b>	Heavy-gauge steel, 5-7/8" (149mm) x 4" (102mm) x 15/16" (24mm).
<b>Front</b>	Heavy-gauge steel, 8" (203mm) x 1-1/4" (32mm) x -3/32" (2mm). Accommodates flat doors and doors beveled 1/8" (3mm) in 2" (51mm).
<b>Armored Front</b>	Wrought brass, bronze or stainless steel attached by machine screws to lockcase front.
<b>Latchbolt</b>	2-piece mechanical with anti-friction insert, 5/8" (16mm) x 1" (25mm) x 3/4" (19mm) throw.
<b>Auxiliary Latchbolt</b>	9/16" (14mm) effective throw and 3/8" (10mm) effective auxiliary latch deadlocking.
<b>Deadbolt</b>	One-piece stainless steel, 19/32" (15mm) x 1-1/4" (32mm) x 1" (25mm) throw.
<b>Hub</b>	Lever: steel, 5/16" (8mm).
<b>Strike</b>	Wrought stainless steel, ANSI straight lip standard, 4-7/8" (124mm) x 1-1/4" (32mm) x 1-1/8" (29mm) lip to center. Optional strikes, lip lengths and ANSI wrought strike box available.
<b>Thumbturn</b>	Cast stainless steel construction. See page 10.
<b>Cylinder</b>	Brass, 6-pin, L4 keyway, 0-bitted standard. Brass, fixed 6-pin conventional fixed core cylinder. Optional cylinders available.
<b>Keys</b>	Two nickel silver standard.
<b>Masterkeying</b>	Can be master keyed or grand master keyed. Construction key systems available.
<b>Functions</b>	Available with all ML2000 functions except ML2029, ML2030, ML2049, ML2050, ML2059, ML2062, ML2065, ML2067, ML2070, ML2072, ML2073, ML2075, ML2080, ML2082 and ML2087. Available with all ML20900 electrified mortise lock functions except NAC. Refer to the ML2000 mortise lock catalog ( <a href="#">45300</a> ) for function descriptions.
<b>Electrical Specifications (Fail Safe/Fail Secure)</b>	12/24VDC @ 15mA Continuous. 12/24VDC Peak current draw = .5A (Maximum of 2 locks per 1A Power Supply). Monitor Switch Rating: 2 amp @ 24VDC. Note: Operating voltage not to exceed +/- 10%. Fail Safe (SAF) or Fail Secure (SEC).
<b>Warranty</b>	Ten-year limited. Two-year limited warranty on electronic components.

### Trim Dimensions

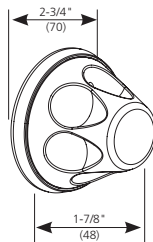

### CERTIFICATION/COMPLIANCE

<b>ANSI/BHMA</b>	Certified A156.13 Series 1000, Operational and Security Grade 1. 
<b>UL /cUL-UL10C Positive Pressure</b>	All locks listed for A label and lesser class doors, 4' (122cm) x 10' (305cm) single or 8' (244cm) x 10' (305cm) pair. Letter F and UL symbol on armored front indicate listing.

\*Although this product is better designed for behavioral health applications than traditional trim, it does not eliminate the risk that an object can be affixed to, or around it.

# Features

## ML2000, ML20900 ECL AND ML20600 NAC SERIES WITH HPSK TRIM

The ML2000 Series mortise lock with HPSK push/pull paddle trim offers a clean, modern alternative to conventional push/pull hardware. Grade 1 performance, multiple mounting orientations, and the ability to operate without using hands make it well suited for healthcare and educational facilities where ease of use and durability are critical.

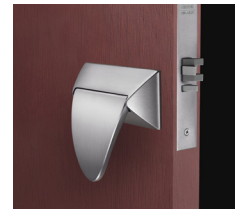

### FEATURES

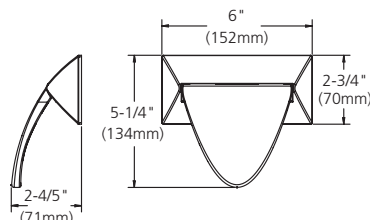

<b>Handing</b>	Handed; quick reversible. The lockset can be re-handed without disassembling the lock case.
<b>Door Thickness</b>	1-3/4" (44mm).
<b>Backset</b>	2-3/4" (70mm).
<b>Lockcase</b>	Heavy-gauge steel, 5-7/8" (149mm) x 4" (102mm) x 15/16" (24mm).
<b>Front</b>	Heavy-gauge steel, 8" (203mm) x 1-1/4" (32mm) x -3/32" (2mm). Accommodates flat doors and doors beveled 1/8" (3mm) in 2" (51mm).
<b>Armored Front</b>	Wrought brass, bronze or stainless steel attached by machine screws to lockcase front.
<b>Latchbolt</b>	2-piece mechanical with anti-friction insert, 5/8" (16mm) x 1" (25mm) x 3/4" (19mm) throw.
<b>Auxiliary Latchbolt</b>	9/16" (14mm) effective throw and 3/8" (10mm) effective auxiliary latch deadlocking.
<b>Deadbolt</b>	One-piece stainless steel, 19/32" (15mm) x 1-1/4" (32mm) x 1" (25mm) throw.
<b>Hub</b>	Lever: steel, 5/16" (8mm).
<b>Covers</b>	Cast stainless steel.
<b>Paddles</b>	Cast stainless steel. Non-handed. "PUSH & PULL" Identification available, Quick Code M38. Laser engraving available.
<b>Strike</b>	Wrought stainless steel, ANSI straight lip standard, 4-7/8" (124mm) x 1-1/4" (32mm) x 1-1/8" (29mm) lip to center. Optional strikes, lip lengths and ANSI wrought strike box available.
<b>Thumbturn</b>	Cast stainless steel construction. See page 10.
<b>Cylinder</b>	Brass, 6-pin, L4 keyway, 0-bitted standard. Optional cylinders available.
<b>Keys</b>	Two nickel silver standard.
<b>Masterkeying</b>	Can be master keyed or grand master keyed. Construction key systems available.
<b>Functions</b>	Available with all ML2000 functions except ML2050, ML2070, ML2080 and ML2087. Available with all ML20900 electrified mortise lock functions. Refer to the ML2000 mortise lock catalog ( <a href="#">45300</a> ) for function descriptions.
<b>Electrical Specifications (Fail Safe/Fail Secure)</b>	12/24VDC @ 15mA Continuous. 12/24VDC Peak current draw = .5A (Maximum of 2 locks per 1A Power Supply). Monitor Switch Rating: 2 amp @ 24VDC. Note: Operating voltage not to exceed +/- 10%. Fail Safe (SAF) or Fail Secure (SEC).
<b>Motorized Electric Latch Retraction (MELR)</b>	Available for ML2010, ML2032 and ML2057 functions. Refer to ML2000 mortise catalog ( <a href="#">45300</a> ) for feature details.
<b>Monitor Options</b>	See Quick Codes, page 12.
<b>Mounting Options</b>	Paddle trim can be mounted as horizontal (up or down) and vertical (sideways) orientations in the field.

### Cover and Paddle Dimensions



<b>Warranty</b>	Ten-year limited. Five-year limited warranty on MELR. Two-year limited warranty on electronic components.
-----------------	---

### CERTIFICATION/COMPLIANCE

<b>ANSI/BHMA</b>	Certified A156.13 Series 1000, Operational and Security Grade 1. Meets A117.1 Accessibility Code. 
<b>A.D.A.</b>	Conforms to ADA requirements for barrier-free accessibility. 
<b>UL-cUL-UL10C Positive Pressure</b>	All locks listed for A label and lesser class doors, 4' (122cm) x 10' (305cm) single or 8' (244cm) x 10' (305cm) pair. Letter F and UL symbol on armored front indicate listing.

# Features/Functions

## HP3000 SERIES TUBULAR LOCK WITH PUSH/PULL PADDLE (HPSK) TRIM

The HP3000 Series tubular lock with push/pull paddle trim brings a refined look and intuitive operation to openings that require simple, reliable access. Its Grade 1 construction, flexible mounting orientations, and hands-free operation make it a strong choice for healthcare and educational environments.



### FEATURES

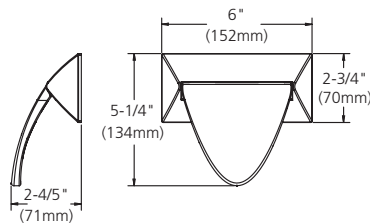

<b>Handing</b>	Passage (HP3010) function is non-handed. Privacy (HP3020) function is handed. Specify hand.
<b>Door Thickness</b>	1-3/4" (44mm) standard. Optional door thicknesses available; see Quick Codes, page 12.
<b>Backset</b>	5" (127mm) standard. Optional: 2-3/4" (70mm) and 7" (177mm); see Quick Codes, page 12.
<b>Latchbolt</b>	Brass, 1/2" (13mm) throw
<b>Strike</b>	ANSI curved lip strike standard, 4-7/8" x 1-1/4" x 1-1/4" lip to center. Optional strikes, lip lengths and ANSI wrought strike box available.
<b>Covers</b>	Cast stainless steel
<b>Paddles</b>	Cast stainless steel. "PUSH & PULL" Identification available, Quick Code M38. Laser engraving available
<b>Mounting Options</b>	Paddle trim can be mounted as horizontal (up or down) and vertical (sideways) orientations in the field.

### Cover and Paddle Dimensions



<b>Warranty</b>	One-year limited
-----------------	------------------

### CERTIFICATION/COMPLIANCE

<b>ANSI/BHMA</b>	Certified A156.2 Series 4000 Grade 1. 
<b>A.D.A.</b>	Conforms to ADA requirements for barrier-free accessibility. 
<b>UL-cUL</b>	Listed for use on 3 hour fire doors (4' x 8' single and smaller doors). UL symbol on front stamped letter F indicates listing.

### FUNCTIONS

Series/Function	Type	Function Description
HP3010	Passage	<ul style="list-style-type: none"> <li>Both paddles retract latch</li> <li>Ideal for patient rooms and closets</li> </ul>
HP3020	Privacy	<ul style="list-style-type: none"> <li>Inside paddle always retracts latch</li> <li>Outside paddle retracts latch, except when locked by inside push button</li> <li>Closing door unlocks outside paddle</li> <li>Includes emergency release</li> <li>Vertical orientation required</li> <li>Ideal for bathrooms</li> </ul>

# Cylinders, Latches, Strikes and Options

For a complete list of available cylinders, latches, strikes and cylinder options, please refer to the following catalogs:

[CLX3300 Cylindrical Locks](#)

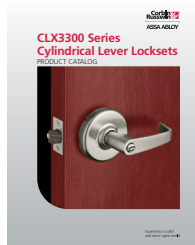

[ML2000 Series Mortise Locks](#)



**KITS**

**Kit for Retrofitting HP3000 Push/Pull Paddle Trim**

Use to cover prep from HL10 series push/pull trim and other manufacturer's trim, when retrofitting HP3000 trim. Contains 2 retrofit plates and 8 screws. Available in 630 finish only. To order, specify 791F39.

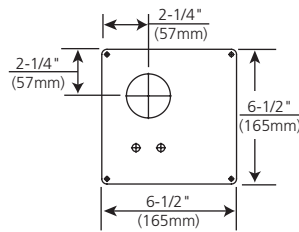

**Positive Pull Stop Kit (HPSK)**

Used on openings where weather stripping is installed or when door closers are not utilized, this kit prevents the latch from retracting when pulling door closed. Contains 2 wood screws, 2 machine screws and instructions. To order, specify 813F068.

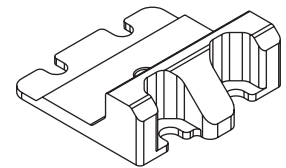

# Thumbturns

## ML2000 AND ML20900 SERIES WITH BHSS, BLSS, HSS, HPSK TRIM



**Thumbturn for BHSS, BLSS, HSS, HPSK\***  
Stainless steel. Used on functions utilizing a thumbturn. Sectional trim only. To order, see table.  
**Plate Size:** 3-3/4" (95mm) x 2-1/2" (64mm)

Door Thickness	Packet
1-3/4" (44mm)	851F627
2" (51mm)	851F637
2-1/4" (57mm)	851F647



**Emergency Turn for BHSS, BLSS, HSS, HPSK\***  
Stainless steel. Used on functions utilizing a thumbturn. Sectional trim only. To order, see table.  
**Plate Size:** 3-3/4" (95mm) x 2-1/2" (64mm)

Door Thickness	Packet
1-3/4" (44mm)	851F677
2" (51mm)	851F687
2-1/4" (57mm)	851F697

\*HPSK available for 1-3/4" door only.

# How to Order

## Stock Order

Quantity	Series/Function	Trim	Finish	Hand	Voltage	Misc. Options
100	ML20907	BLSS	630	RHR	12AD	M105, SEC
100	ML2010	BHSS	630	RHR	—	—
100	HP3000	HPSK	630	RHR	—	—
100	CLX3310	BHSS	630	RHR	—	—

## Contract / Detailed Order

Quantity	Series/Function	Trim	Finish	Hand	Voltage	Door Thickness	Optional Strike	Misc. Options	Optional Cylinder	Keyset
24	ML2055	HPSK	630	RHR	—	D214	SA200	M26	C7	AA1
24	ML20914	BHSS	630	RHR	12AD	—	—	M04, SAF	7P	AA1
24	CLX3355	BHSS	630	RHR	—	—	—	—	7P	AA1

## Anti-Harm Knob (HSS) Trim – Lever Trim x HSS Knob

Quantity	Series/Function	Trim		Finish	Hand
		Outside	Inside		
6	ML2055	NSA	HSS	630C	RH

# Quick Codes

## CYLINDER AND KEYING

For cylinder and keying quick codes, refer to the following catalogs:

[CLX3300 Cylindrical Locks](#)

[ML2000 Series Mortise Locks](#)

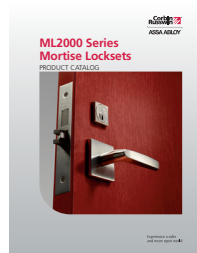
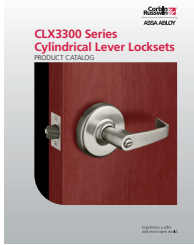

## DOOR THICKNESS

Door Thickness	Specify
1-3/4" (44mm)	(standard)
2" (51mm)	D200
2-1/4" (57mm)	D214

ML2000 or ML20900 x HPSK available 1-3/4" door thickness only.  
 HP3000 not available with D214 option.  
 CLX3300 x BHSS 1-3/4" - 2" door thickness only.

## FINISHES

Description	Specify
ANSI/BHMA 630 (US32D)      Satin Stainless Steel	630
630C      Satin Stainless Steel with MicroShield®	630C

## BACKSET - CLX3300 SERIES

Description	Specify
2-3/4" (70mm)	B234 (standard)
3-3/4" (95mm)	B334
5" (127mm)	B500

## BACKSET - HP3000 SERIES (5" - STANDARD)

Description	Specify
5" (127mm)	(standard)
2-3/4" (70mm)	B234
7" (177mm)	B700

## MISCELLANEOUS OPTIONS

Description	Specify
Half trim (for ML2010, ML2020, ML2022, ML2024, ML2029, ML2030, ML2032, ML2052, ML2053, ML2055, ML2056, ML2057, ML2058, ML2059, ML2062, ML2065) (Supplied with inside trim only. Includes cylinder) <sup>1</sup>	M30
Working trim only <sup>2</sup>	M31
"PUSH & PULL" Identification <sup>3</sup> (HPSK, HP3000)	M38
Motorized Electric Latch Retraction (for ML2010, ML2032, ML2057) BHSS, BLSS, HPSK only	MELR

1. Available on HPSK trim only
2. HSS must be ordered complete with lockbody from the factory. HPSK trim only available for lockbody manufactured after January 2017. BLSS trim only available for lockbody manufactured after July 2008
3. Non-handed

## STRIKES - TUBULAR

Lip to Center	ANSI Curved Lip, Specify	Curved Lip Box, Specify	Full Lip, Specify
1" (25mm)	SA100	SC100	N/A
1-1/8" (29mm)	SA118	SC118	N/A
1-1/4" (32mm)	(standard)	SC114	SF114*
1-3/8" (35mm)	SA138	SC138	N/A
1-1/2" (38mm)	SA112	SC112	N/A
1-3/4" (44mm)	SA134	SC134	N/A
2" (51mm)	SA200	SC200	N/A
2-1/4" (57mm)	SA214	SC214	N/A
2-1/2" (28mm)	SA212	SC212	N/A
2-3/4" (70mm)	SA234	SC234	N/A
3" (76mm)	SA300	SC300	N/A

\*Specify SFR114 for rounded corner.

## ELECTRIC MONITOR OPTIONS (ML20900 SERIES ONLY)

Description	Specify
Latchbolt Monitor	M91
Request to Exit	M92*
Security Monitor	M105

These options may be ordered together only as follows: M91xM92, M92xM105.  
 \*M92 available with MELR for ML2010 or ML2057

# Architectural Specifications

## CLX3300 SERIES CYLINDRICAL WITH BHSS TRIM

- A. Locks shall be CLX3300 Series cylindrical lever locks as manufactured by Corbin Russwin, Berlin, CT.
- B. Locks shall be listed for low, medium and high risk areas in the New York State Office of Mental Health (NYS-OMH) Patient Safety Standard.
- C. Locks shall be ANSI/BHMA Certified Products Directory (CPD) listed.
  - 1. A156.2, Series 4000, Grade 1
  - 2. A156.41
- D. Locks shall exceed the requirements of ANSI/BHMA A156.2 Series 4000, Grade 1 with all standard trims.
- E. Locks shall comply with UL 10C positive pressure requirements.
- F. Locks required for fire doors shall be listed by Underwriters Laboratories for ratings of 3 hours (A label) and less, for doors up to 4'0" (1.2m) x 10'0" (3.0m) and pairs of doors 8'0" (2.4m) x 10'0" (3.0m)
- G. Locks shall have a chassis design that supports all cylinder formats allowing flexibility for changing from fixed core to interchangeable core cylinders.
- H. Lock lever and escutcheon shall be made of solid stainless steel material.
- I. Locks shall have a 2-3/4" (70mm) standard backset.
- J. Strikes shall be non-handed with a curved lip. Provide wrought boxes with strikes.
- K. Locks shall be available with lead-lining and antimicrobial coating.
- L. Exposed fasteners shall be provided as Torx® security pin standard.
- M. Locks shall have brass 6-pin cylinder standard.
  - 1. Provide two nickel silver keys with each lock.
- N. Electrified functions shall be provided with EcoFlex® Technology.
- O. Locks shall have a ten-year limited warranty on mechanical components and a two-year limited warranty on electric components.

## HP3000 SERIES TUBULAR LOCK WITH PUSH/PULL PADDLE TRIM (HPSK)

- 1. Tubular hospital locks shall be HP3000 series as manufactured by Corbin Russwin Architectural Hardware, Berlin, CT.
- 2. Locks shall meet or exceed requirements of ANSI/BHMA A156.2 Series 4000 Grade 1.
- 3. Locks shall be easily re-handed with a non-handed curved lip strike.
- 4. Locks shall be listed for use on 3 hour fire doors (4' x 8' single and smaller doors).
- 5. Locks shall comply with UL10C and UBC 7-2 positive pressure requirements.
- 6. Lockset paddles shall be capable of horizontal or vertical mounting positions.
- 7. Locks shall have 2-3/4", 5" or 7" backset available.
- 8. Locks shall have one-year limited warranty.

# Architectural Specifications

## ML2000 SERIES MORTISE LOCKS WITH BHSS AND BLSS TRIM

1. Ligature Resistant, Mortise: ANSI/BHMA A156.13, Series 1000, Operational and Security Grade 1 mortise type manufactured to accepted OMH requirements with ligature-resistant lever and escutcheon trim. Locksets to be manufactured with a corrosion resistant, formed steel case. Levers and escutcheons are manufactured from stainless steel material. Provide optional lead-lining (lock body), Torx® fasteners, and Antimicrobial coating as specified in Hardware Sets.
2. Ligature Resistant, Mortise: ANSI/BHMA A156.13, Series 1000, Operational and Security Grade 1 mortise type manufactured to [accepted] [Use with caution] OMH requirements with ligature-resistant lever and rose trim. Locksets to be manufactured with a corrosion resistant, formed steel case. Levers and roses are manufactured from stainless steel material. Provide optional lead-lining (lock body), Torx® fasteners, and Antimicrobial coating as specified in Hardware Sets.

## ML2000 AND ML20900 SERIES MORTISE LOCKS WITH PUSH/PULL PADDLE TRIM (HPSK)

1. All locksets shall be ML2000 Series Mortise Locksets as manufactured by Corbin Russwin Architectural Hardware, Berlin, CT.
2. Locks shall meet or exceed the requirements of ANSI/BHMA A156.13 Series 1000, Operational Grade 1, and Security Grade 1.
3. Locks shall be easily re-handed without opening the lock body.
4. Locks required for fire doors shall be listed by Underwriters Laboratories for ratings of A label (3 hours) and less, for doors up to 4'0" (1.2m) x 10'0" (3.05m) and pairs of doors 8'0" (2.4m) x 10'0" (3.05m)
5. Construction:
  - A. Lock functions shall be manufactured in a single-sized case formed from 12 gauge steel minimum.
  - B. Lock cases shall be closed on all sides and back.
  - C. Locks shall have field adjustable, beveled, armored front, with a 1/8" (3mm) thickness minimum.
  - D. Locks shall have a one piece, 3/4" (19mm) throw anti-friction stainless steel latch.
  - E. Deadbolts, where specified, shall be full one inch (25mm) throw made of one-piece hardened stainless steel.
6. Lockset paddles shall be capable of horizontal or vertical mounting positions.
7. Locks shall have a 2-3/4" (70mm) backset, standard.
8. Strikes shall be non-handed with a curved lip.
9. Locks shall have brass 6-Pin cylinder, standard.
10. Locks shall have a 10 year limited warranty. 5 year limited warranty on MELR locks. 2 year limited warranty on electrified locks.

The ASSA ABLOY Group is the global leader in access solutions. Every day, we help billions of people experience a more open world.

ASSA ABLOY Opening Solutions leads the development within door openings and products for access solutions in homes, businesses and institutions. Our offering includes doors, frames, door and window hardware, locks, perimeter fencing, access control and service.



For additional information, contact your  
ASSA ABLOY Door Security Solutions  
sales consultant or  
visit [www.corbinruswin.com](http://www.corbinruswin.com).

**In U.S.**

Corbin Russwin  
Architectural Hardware  
225 Episcopal Road  
Berlin, CT 06037  
Phone: 800-543-3658  
Fax: 800-447-6714  
[www.corbinruswin.com](http://www.corbinruswin.com)

**In Canada**

ASSA ABLOY Door  
Security Solutions Canada  
160 Four Valley Drive  
Vaughan, Ontario  
Canada L4K 4T9  
Phone: 800-461-3007  
Fax: 800-461-8989  
[www.assaabloydss.ca](http://www.assaabloydss.ca)

ASSA ABLOY Group companies offer MicroShield®, an antimicrobial coating for door hardware. MicroShield uses proven silver ion-based technology from Agion®, a leading provider of antimicrobial solutions, to stem the spread of bacteria and other microbes.

MicroShield® is a trademark of ASSA ABLOY Access and Egress Hardware Group, Inc.



The Agion antimicrobial is not intended as a substitute for good hygiene. Coated products must still be cleaned to ensure the surfaces will be free of destructive microbes. ASSA ABLOY makes no representations or warranties, express or implied, as to the efficacy of the Agion antimicrobial. A copy of the Agion warranty is available upon request. Agion is a registered trademark of Agion Technologies, Inc., Wakefield, MA, USA.