



ASSA ABLOY

Experience a safer  
and more open world



## SPECIALTY CLOSERS

High-End Security  
Gate Solutions

Copyright © 2001-2022, ASSA ABLOY Accessories and Door Controls Group, Inc. All rights reserved. Reproduction in whole or in part without the express written permission of ASSA ABLOY Accessories and Door Controls Group, Inc. is prohibited.

TABLE OF CONTENTS

General Information..... 3

How to Select Product ..... 4

Options ..... 5

Certifications..... 6

Limited Warranty..... 6

Specifications..... 6

**Interior Gate Closers**

354 Flange Mounting 1-3/4" Gate Only ..... 7

355 Flange Mounting 1-3/4" Gate Only ..... 7

356 Flat Arm ..... 8

357 Flat Arm ..... 8

359 Independently Hung (Hanging Means by Others) ..... 9

Parts ..... 10-12

**Exterior Gate Closers**

1351 ..... 13

**Security Closers**

SEC27-180 Closer ..... 14

Parts ..... 15

Quick Reference of Options ..... 16

How to Order ..... 16

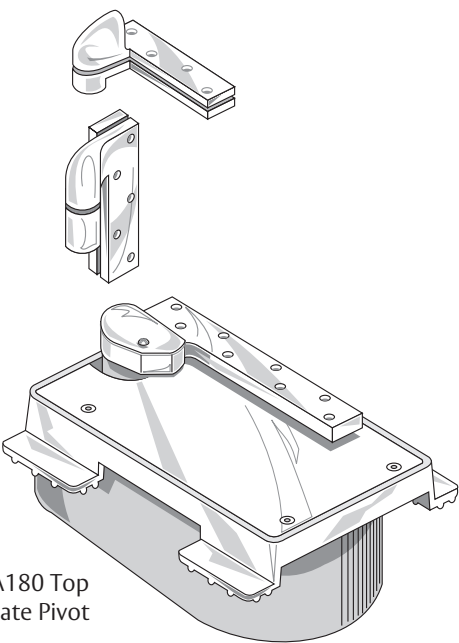

SEC27-180 Closer with FA180 Top  
Pivot and FA19 Intermediate Pivot  
(recommended)



Experience a safer  
and more open world

The closers in this section are for specific niche markets.

### Gate Closers Models 354, 355, 356, 357, 359

Closers that mount to the side jamb for small gates such as teller gates, courtroom gates.

- Closer mounts off the floor approximately 6" under the door
- Double acting with a hold open option
- Single acting when used with butts

### Exterior Gate Closers Model 1351

Surface closers and tracks used on high-end residential and commercial ornamental iron fencing systems that must be self-closing.

- Extremely easy to install
- Uses surface closer technology

### High-Security Models SEC27-180

These closers are used on doors in detention areas in hospitals, detention centers and non-cell prison doors. The weight of the door is supported at bottom.

- Door swings with less resistance
- Heavier doors can be accommodated
- Reduced stress on frame

#### Fasteners are in shear, not tension

- Eliminates door sag
- Vertically adjustable

#### Heavy-duty hardened steel spindles

- Designed to provide positive dead stop
- Thrust bearing supports vertical load
- Needle bearings for lateral force

#### Bottom arm directly attached to closer spindle

- A mechanical advantage that increases efficiency
- One-to-one ratio of door swing to spindle rotation makes controls more precise

#### Helical torsion spring

- Operates in same direction as door movement and contributes to even higher closer efficiency
- A torsion spring has a much longer life than standard compression springs

#### Advantages of security concealed floor closers

- Vandal resistant – mechanism not exposed
- Supplied with Torx® screws



Experience a safer  
and more open world

1. Offset vs. Center Hung Application

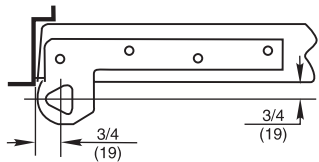

**3/4" Offset**  
Pivot point located 3/4" from the heel edge of the door and 3/4" from face of door.

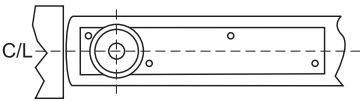

**Center Hung**  
Pivot point centered in thickness of door. Distance from heel edge can vary 2-3/4 and up (Not for use on fire rated doors).

2. Size of Door (width, height, thickness)

Estimated door weights pounds per square foot (PSF)

DOOR MATERIAL	DOOR THICKNESS		
	1-3/4"	2-1/4"	3
Hollow Metal	6.5	7	—
Solid Core Wood	7	9	11.5
Aluminum/Glass Storefront	3.5	4	—
MDF	7	9	11.5
TEMPERED GLASS	3/8"	1/2"	3/4"
	5	7	9.75

**Example: 3/0 X 7/0 X 1-3/4" WD**  
Door: 21sq ft x 7lb.sq ft = 147lbs

**Example: 3/6 X 8/0 X 1/2" Tempered Glass Door**  
Door: 28sq ft x 7lb./sq ft = 196lbs

For doors of other sizes consult factory

3. Expected Frequency of Door Operation

APPLICATION	DAILY	YEARLY	
Large department store entrance	5,000	1,500,000	High
Large office building entrance	4,000	1,200,000	
Theater entrance	1,000	365,000	
School entrance	1,250	225,000	
School restroom door	1,250	225,000	
Store or bank entrance	500	150,000	
Office building restroom door	400	118,000	Average
School corridor door	80	15,000	
Office building corridor door	75	22,000	
Store restroom door	60	18,000	
Residential entrance door	40	15,000	
Residential restroom door	25	9,000	Low
Residential hallway door	10	3,600	
Residential closet door	6	2,200	

## Models 350 Gate Closers - No Options

### **Degree of Swing – Suffix -180**

Single acting, heavy-duty floor closers have a deadstop. This means that the door cannot go past a certain point. The SEC27-180 allows the door to swing to 180°.

### **Non-Hold Open – SEC closers are non-hold open**

### **Less Cement Case – Suffix LCC**

For existing installations or when cement case has been sent earlier in construction. Closer will be packaged without the cement case.

### **Less Top Pivot – Suffix LTP**

For unusual head conditions where the top pivot cannot be used, the closer is shipped without the top pivot.

### **Extended Spindle – Suffix Extra Length**

Any special floor covering or severe door undercuts will affect spindle height. In these applications, an extended spindle may be required. See product template to determine if an extended spindle is needed. Extended spindles available in 1/2" increments up to 2" longer than standard.



Experience a safer  
and more open world

## Certifications

The 350 gate closers and SEC27-180 closers are in compliance with ANSI/BHMA A156.4 standards.

See individual products for sub-section.

## Limited Warranty

Gate closers are warranted for 2-years against defect; SEC27-180 specialty closers are warranted for 10-years against defect. See Price Book for specific details of the limited warranty.

## Specifications

### Interior Gate Closer

All interior gates shall use model 350 closers. Closers shall be mounted above the floor and may be single or double acting, depending on hanging means. Closers shall have hydraulic closing speed adjustment. Units shall have built-in hold open.

### Exterior Gate Closer

All exterior gates shall be model 1351. They shall be surface type with non-corrosive tracks. Track shall be two sided to keep debris from collecting. Must accommodate gates with top cross member or open spokes.

### Security Closer

Closer shall be model SEC27-180 concealed floor closer package. Cement case to be cast iron with cast-in integral anchor extensions. 1/4" thick steel cover plate to be recessed into lip on cement case. Closer mechanism to have individual hydraulic cylinders for closing functions and adjustable hydraulic backcheck and be operated by a torsion spring. Closing and latch speed to be controlled by two independent valves. Closer to have built-in dead stop. Bottom arm shall be 1/2" thick steel. Top pivot shall be asylum type with Torx® security fasteners.

### How to Determine Hand of Door

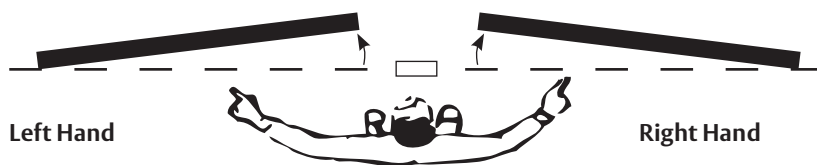

Face a door swinging open away from you. If it opens to the right, it is right handed. If it opens to the left, it is left handed.

## Model 354

SPECIALTY CLOSERS

INTERIOR GATE CLOSERS

### Application

- Double Acting, Non-handed
- Maximum weight: 75 lbs.
- Dwarf doors from 2'2" to 3'0" wide (660 x 914mm)



### Product Description & Features

- Recommended for office rail gates, partitions, and lavatory stall doors
- Body mounts under gate
- Surface mounted top pivot: 3541020
- 1-3/4" door thickness
- Maximum opening 90°
- Arm adjustment door normally comes to rest at closed position. If door is to remain open, arm is set on spindle so door comes to rest at 90°
- Package also includes closer bracket and flange style arm
- Frame carries full weight of door
- Quiet control; no slamming or flapping
- All moving parts enclosed and fully immersed in lubricating checking fluid
- Painted finishes only
- Not compliant with ICC/ANSI A117.1 low opening force requirements

### Compliance

- ANSI C09053

### Technical Information

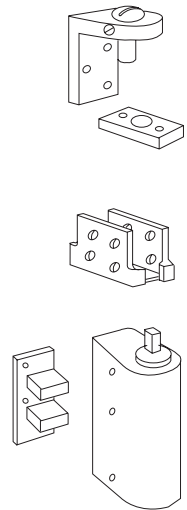

## Model 355

### Application

- Double Acting, Non-handed

### Product Description & Features

Identical to 354 except:

- Mortise top pivot: 3551020

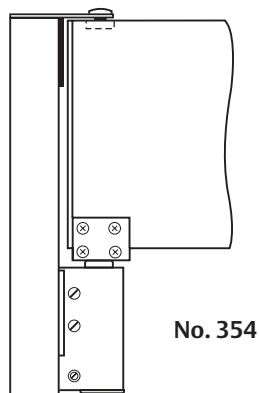

No. 354

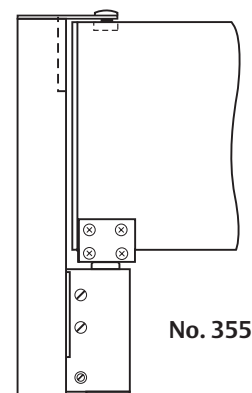

No. 355



Experience a safer  
and more open world

**Application**

- Double Acting, Non-handed
- Maximum weight: 75 lbs.
- Dwarf doors from 2'2" to 3'0" wide (660 x 914mm)

**Product Description & Features**

- Recommended for office rail gates, partitions, and lavatory stall doors
- Body mounts under the gate
- Surface mounted top pivot: 3541020
- 1-3/4" door thickness
- Maximum opening 90°
- Arm adjustment door normally comes to rest at closed position. If door is to remain open, arm is set on spindle so door comes to rest at 90°
- Package also includes closer bracket and arm that may be surface mounted or mortised
- Frame carries full weight of door
- Quiet control; no slamming or flapping
- All moving parts enclosed and fully immersed in lubricating checking fluid
- Painted finishes only
- Not compliant with ICC/ANSI A117.1 low opening force requirements

**Compliance**

- ANSI C09503

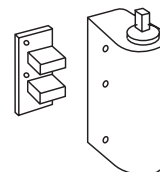
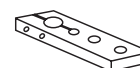
**Technical Information****Application**

- Double Acting, Non-handed

**Product Description & Features**

Identical to 356 except:

- Mortise top pivot: 3551020

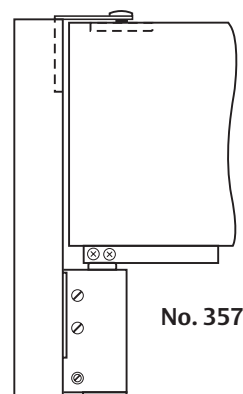
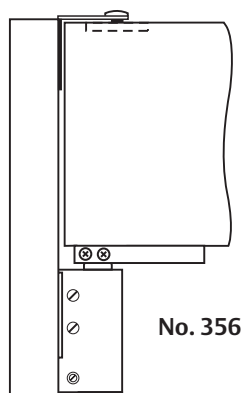

**NORTON  
RIXSON**

**ASSA ABLOY**

Experience a safer  
and more open world



## Application

- Single Acting, Non-handed
- Maximum weight: 75 lbs.
- Dwarf doors from 2'2" to 3'0" wide (660 x 914mm)



## Product Description & Features

- Recommended for office rail gates, partitions, and lavatory stall doors
- Closer mounts under the door
- 1-3/4" door thickness
- Maximum opening 140°
- Surface mounted to edge of partition with edge wide enough for 1-1/2" bracket
- Butt hinges by others
- Frame carries full weight of door
- Track style arm
- Package includes closer, bracket, and slide track arm
- Painted finishes only
- Not compliant with ICC/ANSI A117.1 low opening force requirements

## Compliance

- ANSI C09503

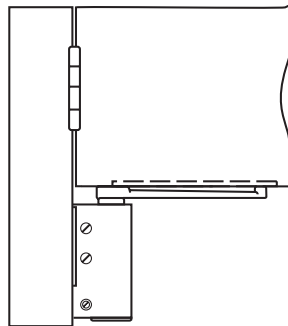

## Technical Information

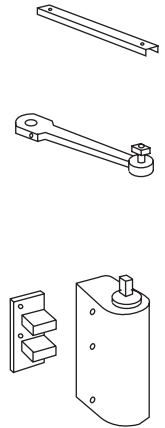

## Model 354

- (A) Jamb Portion  
01960-\*AS
- (B) Gate Portion  
35064-\*AS
- (E) Bracket  
3549000-\*  
(Includes Closer Mtg.  
Screw Kit)

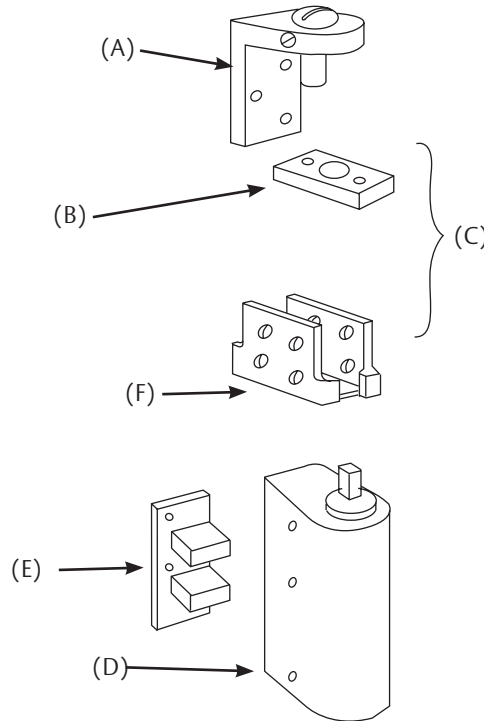

- (C) Top Pivot Package  
3541020-\*  
(Includes A, B and  
attaching screws)
- (F) Arm with Screws  
3542026-\*
- (D) Closer Body  
X03540370-\*  
(Includes E)

## SCREW KITS

Top Pivot Screw Kit  
107017-\*

Closer Mtg. Screw Kit  
107350

## Model 355

- (A) Jamb Portion  
0490-\*AS
- (B) Gate Portion  
35064-\*AS
- (E) Bracket  
3549000-\*  
(Includes Closer Mtg.  
Screw Kit)

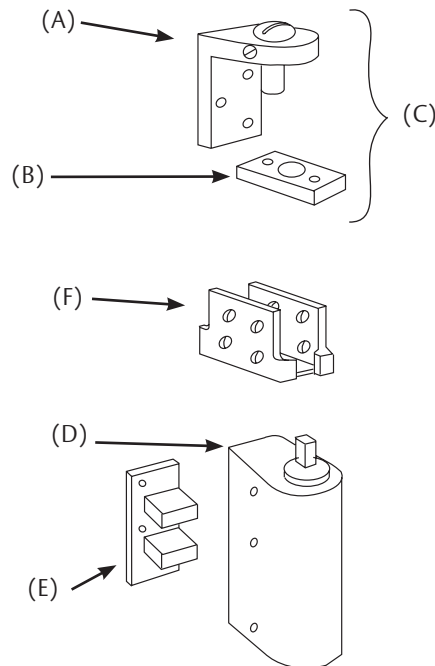

- (C) Top Pivot Package  
3551020-\*  
(Includes A,B and  
attaching screws)
- (F) Arm with Screws  
3542026-\*
- (D) Closer Body  
X03540370-\*  
(Includes E)

## SCREW KITS

Top Pivot Screw Kit  
107017

Closer Mtg. Screw Kit  
107350

\*specify finish

**NORTON  
RIXSON**

**ASSA ABLOY**

Experience a safer  
and more open world

## Model 356

SPECIALTY CLOSERS

### PARTS DRAWINGS

- (A) Jamb Portion  
01960-\*AS
- (B) Gate Portion  
35064-\*AS
- (D) Bushing Only  
35051  
(Included in arm package)
- (F) Bracket  
3549000-\*  
(Includes Closer Mtg. Screw Kit)

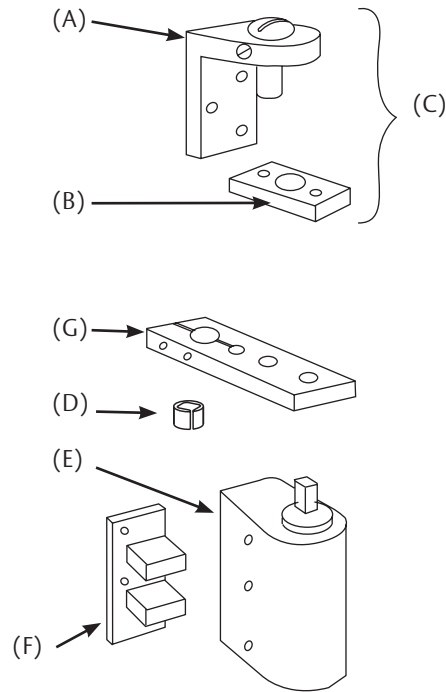

- (C) Top Pivot Package  
3541020-\*  
(Includes A, B and attaching screws)
- (G) Arm with Screws  
3562020-\*  
(Includes D and attaching screws)
- (E) Closer Body  
X03540370-\*  
(Includes F)

### SCREW KITS

Top Pivot Screw Kit  
107017 -\*

Arm Screw Kit  
107359

Closer Mtg. Screw Kit  
107350

## Model 357

- (A) Jamb Portion  
0490-\*AS
- (B) Gate Portion  
35064-\*AS
- (D) Bushing Only  
35051  
(Included in arm package)
- (F) Bracket  
3549000-\*  
(Includes Closer Mtg Screw Kit)

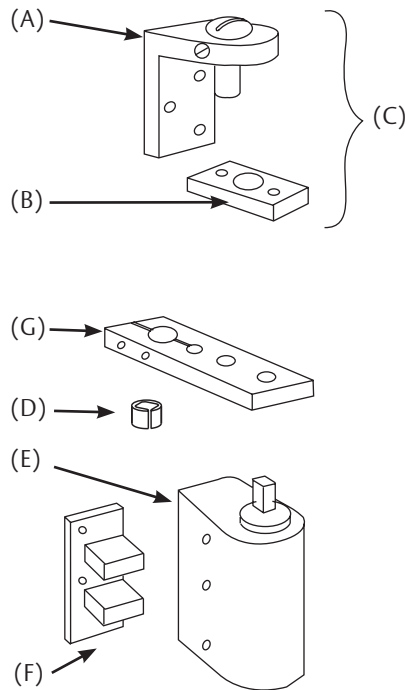

- (C) Top Pivot Package  
3551020-\*  
(Includes A, B and attaching screws)
- (G) Arm with Screws  
3562020-\*  
(Includes D and attaching screws)
- (E) Closer Body  
X03540370-\*  
(Includes F)

### SCREW KITS

Top Pivot Screw Kit  
107017-\*

Arm Screw Kit  
107359

Closer Mtg. Screw Kit  
107350

\*specify finish

**NORTON  
RIXSON**

**ASSA ABLOY**

Experience a safer  
and more open world

- (A) Rail  
35510-\*
- (B) Arm with Screw & Bushing  
35535-\*
- (C) Bushing Only  
35051  
(Included in arm package)
- (F) Bracket  
3549000-  
(Includes Closer Mtg.  
Screw Kit)

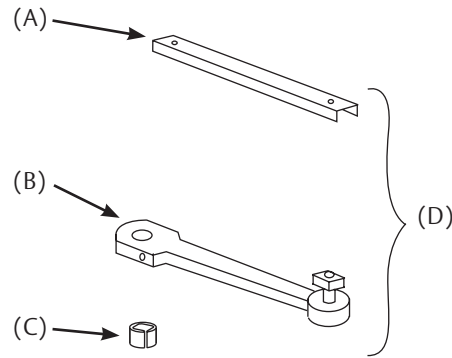

- (D) Arm & Rail Package  
3592010-  
(Includes A, B, C and  
attaching screws)
- (E) Closer Body  
X03540370-  
(Includes F)

### SCREW KITS

Arm Screw Kit  
107003

Closer Mtg. Screw Kit  
107350

\*specify finish

**NORTON  
RIXSON**

**ASSA ABLOY**

Experience a safer  
and more open world

## Model 1351

SPECIALTY CLOSERS

## EXTERIOR GATE CLOSERS

### Application

- Single Acting
- Exterior Ornamental Iron Gates
- Weight to 250 lbs.
- Gate Maximum 4'6" x 10'0"  
(1372 x 3048mm)



### Product Description & Features

Recommended for exterior gates on high-end residences and commercial building campuses.

- Includes closer body, mounting bracket, arm and slide track
- Track has pass thru hole to avoid debris build-up
- Components are rust-resistant
- Surface closer has adjustable latch speed, closing speed and backcheck
- May be mounted on cross-member or spokes
- Hanging means by others
- All weather fluid
- All machine screws
- Black finish only

### Technical Information

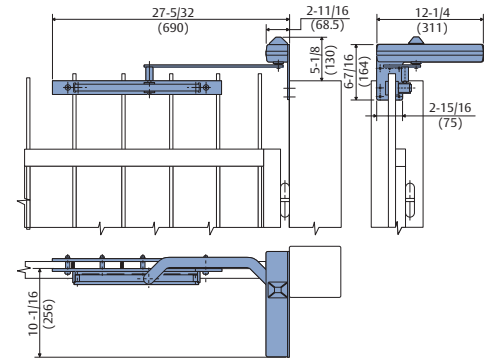

**ASSA ABLOY**

Experience a safer  
and more open world

## Application

- Single Acting, Handed
- Interior Security Doors
- Weight to 650 lbs.
- Door Width up to 4'0" (1219mm)



## Product Description & Features

Recommended for non cell doors in detention facilities or psychiatric centers

- Non-hold open only
- FA180 top pivot included
- FA19 intermediate pivot recommended; order separately
- Door will swing to 180°, trim permitting
- Built-in hydraulic backcheck at 160°
- Cast iron cement case with cast in extensions for positive anchorage in floor
- Solid 1/4" (6mm) thick steel floor plate
- Cast-in lip to provide positive containment of cement case in floor
- Sealed closer standard
- Heavy-duty forged bottom arm
- Adjustable closing speed
- Doors 60" (1524mm) to 90" (2286mm) in height should use one intermediate pivot. Every additional 30" (762mm) of door height warrants another intermediate pivot
- Delayed action not available
- Furnished with Torx® screws
- PH option not available

## Optional Features

- Extended spindles available in 1/2" increments up to 2" longer than standard

## Compliance

- This closer is for fire-rated openings (up to 3 hour assemblies). Only non-hold open closers are used. FA19 intermediate pivot required: order separately.

## Technical Information

Frame stop required

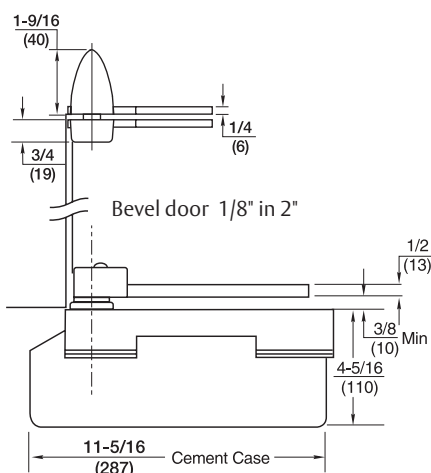
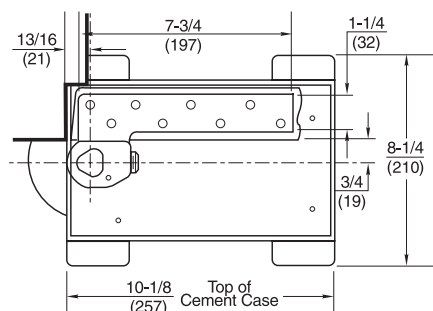
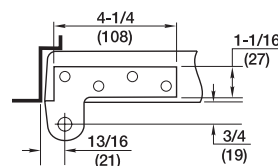

Right hand shown  
3/4" offset only

- (A) Pivot Stud  
181770-Asy
- (B) Finish Cap  
181778 -\*
- (C) Arm Cap & Screw  
012142R\*T (RH, BRS)  
012142L\*T (LH, BRS)  
012144R\*T (RH, SS)  
012144L\*T (LH, SS)
- (D) Arm x Locking Screw  
18550-Asy (RH)  
18650-Asy (LH)
- (E) Arm Locking Screw Only  
88905-PKG (5)
- (F) Arm Shims  
275065-PKG (5)
- (G) Arm Bearing Washer  
275062-PKG (5)
- (H) Spindle Shoulder Collar  
259000 -\*
- (I) Floor Plate with Screws  
274056 -\*
- (J) Closer Body  
(Specify Complete  
Model No. x LAP)
- (K) Cement Case with Screws  
253001SEC

- (L) Bottom Arm Package  
252056R\* (RH)  
252056L\* (LH)  
(Includes C, D, H and  
attaching screws)

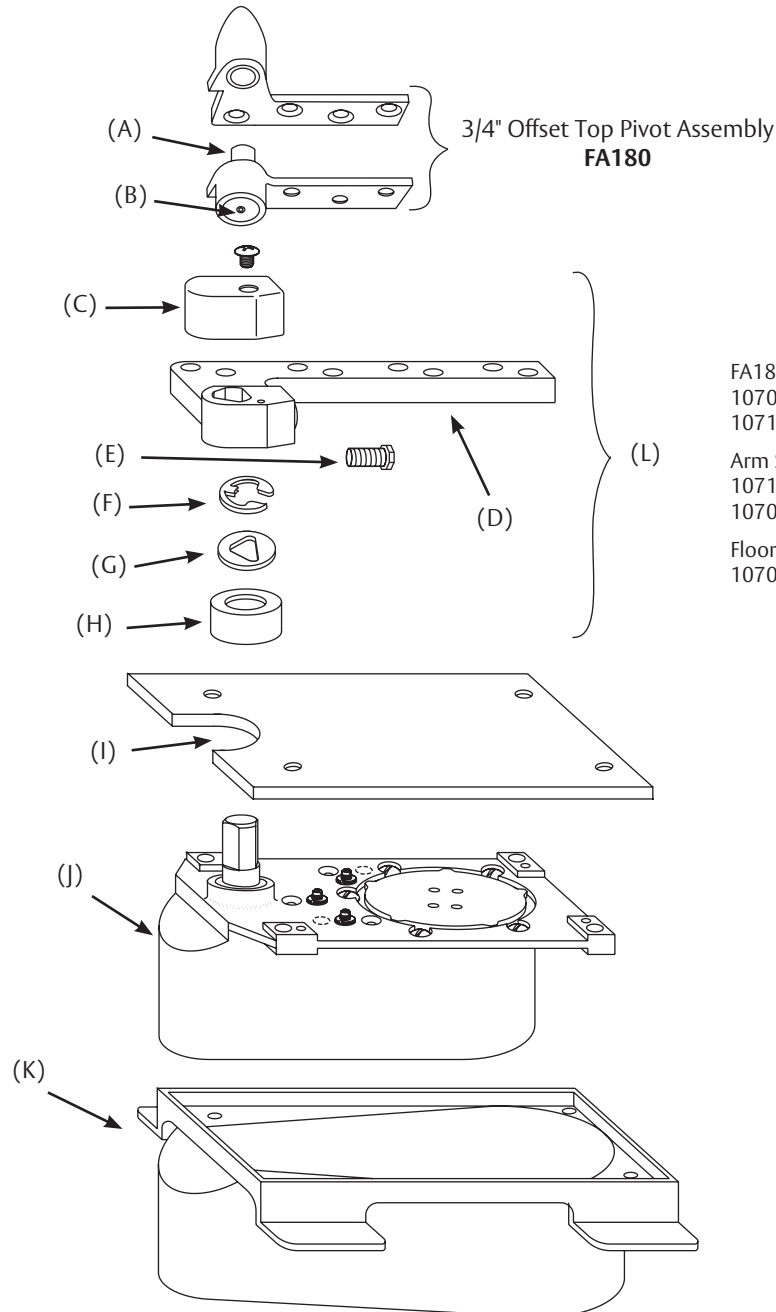

- FA180 Torx® Screw Kit  
107014 - \*T Machine (2 required)  
107114 - \*T Wood (2 required)
- Arm Screw Kit  
107144 Machine (2 required)  
107048 Wood (2 required)
- Floor Plate Screw Kit  
107021 -\*

\*specify finish



Experience a safer  
and more open world

## QUICK REFERENCE OF OPTIONS/HOW TO ORDER

## Quick Reference of Options

Prefix	Model	Degree of Hold Open	Holding Options	General Options	Fire Rated	Handed	Maximum Door Weight
	354	90	A		No	No	75
	355	90	A		No	No	75
	356	90	A		No	No	75
	357	90	A		No	No	75
	359		N		No	No	75
	1351		N				250
	SEC27-180		N	Extended Spindle	Yes	Yes	650

## How To Order

SEC27-180 Model	A Hold Open	LTP Suffix	Hand	626 Finish
	N Non-Hold Open A Automatic Hold Open		Blank Double Acting or Non Handed RH Right Hand LH Left Hand	
354 Gate		Extended Spindles		<b>350 Gate Closer ONLY</b>
355 Gate		LAP Closer Body Only		689 Sprayed Alum
356 Gate		LFP Less Floor Plate		690 Sprayed Dk Brz
357 Gate		LCC Less Cement Case		691 Sprayed Lt Brz
359 Gate		LTP Less Top Pivot		696 Sprayed Brass
1351 Exterior Gate		SPLO Special Layout #		<b>1351 Gate Closers ONLY</b>
SEC27-180 Security				622 Flat Black
				<b>Remainder</b>
				605 Bright Brass
				606 Satin Brass
				611 Bright Bronze
				612 Satin Bronze
				613 Dark Bronze
				613E Dark Oxidized Satin Bronze - equivalent
				619 Satin Nickel
				622 Flat Black
				BSP Black Suede Powder
				WSP White Suede Powder

\*specify finish

**ASSA ABLOY**

 Experience a safer  
and more open world





**ASSA ABLOY**

Experience a safer  
and more open world

The ASSA ABLOY Group is the global leader in access solutions. Every day, we help billions of people experience a more open world.

ASSA ABLOY Opening Solutions leads the development within door openings and products for access solutions in homes, businesses and institutions. Our offering includes doors, frames, door and window hardware, mechanical and smart locks, access control and service.



**CONTACT US AT:**

Norton Rixson  
3000 Highway 74 East  
Monroe, NC 28112  
Tel: 877-974-2255  
Fax: 800-338-0965

ASSA ABLOY Door Security Solutions Canada  
160 Four Valley Drive  
Vaughan, Ontario, L4K 4T9 Canada  
Tel: 800-461-3007  
Fax: 800-461-8989

For a complete listing of products and applications please visit our web site.  
[www.nortonrixson.com](http://www.nortonrixson.com)  
[www.assaabloydss.ca](http://www.assaabloydss.ca)