

# 3000 Series Door Closer

Models UNIJ3301, UNIJ3311, UNIJ3501, UNIJ3511

Top Jamb UNI Stop™, Non-Hold Open or Hold Open

## Installation Instructions

ACCENTRA

ASSA ABLOY

### NOTES:

- Always use template covering door opening angle desired, correct door thickness and frame reveal, and door hanging hardware being used. Template dimensions in these instructions (page 2) cover frame reveals to 7-3/8" (187mm) in opening with 1-3/4" (44mm) thick doors hung on 4-1/2" (114mm) wide template hinges (figure 2), 3/4" (19mm) offset pivots (figure 2) or center pivots (figure 3).
- Check hand of door: right or left (see figure 5, page 3). Make sure that door opens the full angle desired and latches without any binding action or interference. Note that hold open units will require that door swing five (5) degrees past hold-open point, to dead-stop position.
- It is suggested that sex nuts and bolts be used to mount arm foot and to mount closer to flush partitions.
- Top Jamb UNI Stop closers are supplied with arm rod units according to frame reveal. An arm number is stamped on the arm rods, as shown on Figures 2 and 3 (page 2).

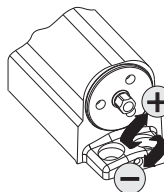
<b>Adjustment Chart</b> Top Jamb UNI Stop™	 <b>Power Adjust</b> Use 5/16" Socket or Adjustable Wrench for this Adjustment				
DOOR	<b>Number of Turns Required</b>				
	MAXIMUM DOOR SIZE				
	32" (81cm)	36" (91cm)	42" (107cm)	48" (122cm)	
	INTERIOR	5	8	11	13
	EXTERIOR	7	10	13	16

\* Twenty (20) 360° Turns Maximum Available

- Closer is shipped set at mid range setting = ten (10) turns
- The closing force is adjustable from size 1 to 6. When adjusted to conform to ADA requirements (5 lbs max.) for interior doors, closer may not have adequate force to reliably close and latch the door.



By law the Americans with Disabilities Act (ADA) may require that door closer installation comply with accessibility guidelines.

### Components

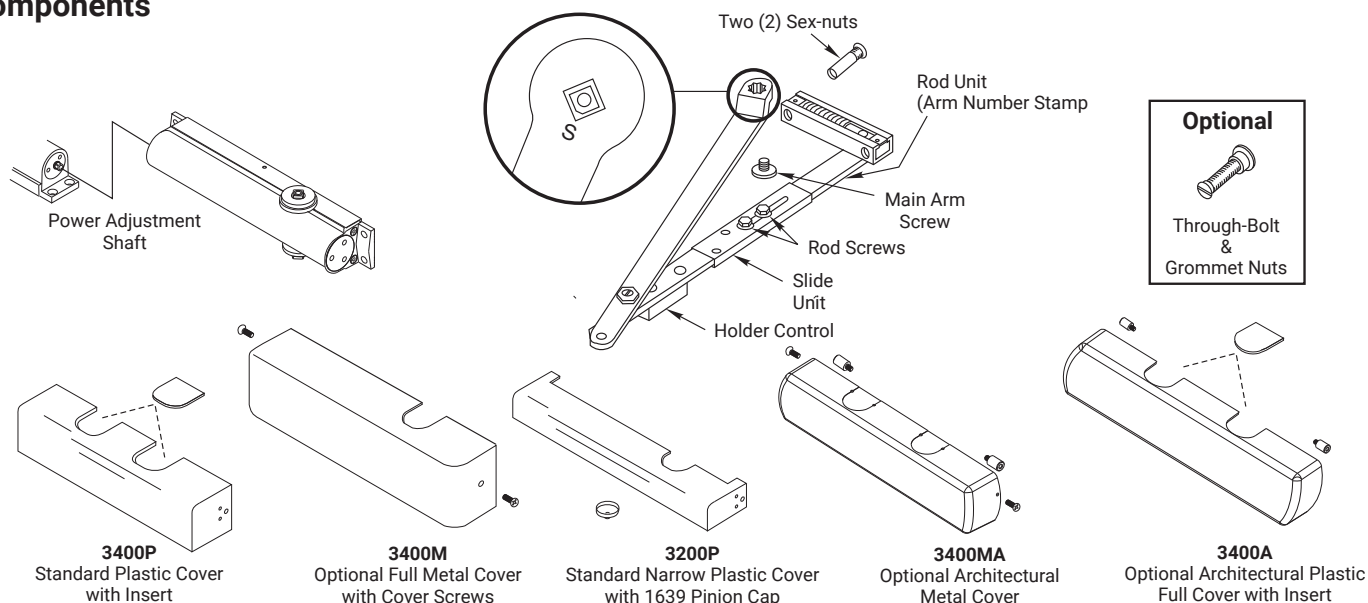

### WARNING

This product can expose you to lead which is known to the state of California to cause cancer and birth defects or other reproductive harm. For more information go to [www.P65warnings.ca.gov](http://www.P65warnings.ca.gov).

### WARNING

Attention Installer: Any retrofit or other field modification to a fire rated opening can potentially impact the fire rating of the opening, and ASSA ABLOY makes no representations or warranties concerning what such impact may be in any specific situation. When retrofitting any portion of an existing fire-rated opening, or specifying and installing a new fire-rated opening, please consult with a code specialist or local code official (Authority Having Jurisdiction) to ensure compliance with all applicable codes and ratings.

855-557-5078 x 2 • [www.accentra-assaabloy.com](http://www.accentra-assaabloy.com)

Copyright © 2005, 2008, 2024, ASSA ABLOY ACCENTRA™ Access and Egress Hardware Group, Inc. All rights reserved. Reproduction in whole or in part without the express written permission of ASSA ABLOY Access and Egress Hardware Group, Inc. is prohibited.

80-9303-2214-010 Rev 3 05/24

Experience a safer  
and more open world

## Installation Template

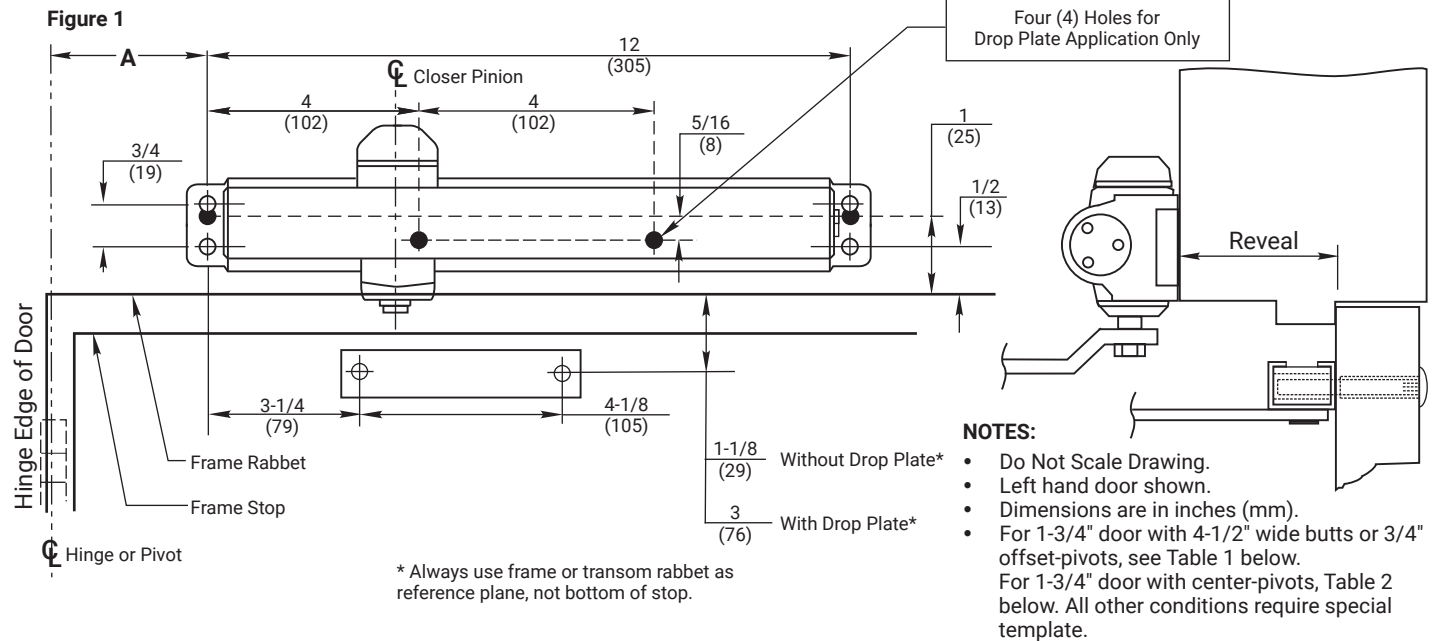

Door-Control location for 1-3/4" (44mm) thick doors hung on 4-1/2" (114mm) wide template-hinges or 3/4" (19mm) offset-pivots.														Table 1	
Arm Number Stamp	Non-Hold	J6600-4		J6200-4		J6100-4		J6400-4		J6500-41		J6400-42		J6500-43	
	Hold Open	J6600-7		J6200-7		J6100-7		J6400-7		J6500-71		J6400-72		J6500-73	
Reveal	inches	0 - 3/8		1/2 - 2		2-1/2 - 3-1/4		3-3/8 - 4-1/4		4-3/8 - 5-3/8		5-1/2 - 6-3/8		6-1/2 - 7-3/8	
	mm	0 - 10		13 - 50		55 - 83		85 - 108		111 - 137		140 - 162		165 - 187	
Door Opening Angle		Dimension A		Dimension A		Dimension A		Dimension A		Dimension A		Dimension A		Dimension A	
Hold Open	Door Stop	inches	mm	inches	mm	inches	mm	inches	mm	inches	mm	inches	mm	inches	mm
85°	90°	9-7/8	251	9-7/8	251	10	254	10	254	10-1/8	257	10-1/4	260	10-1/4	260
90°	95°	9-1/4	235	9-1/4	235	9-3/8	238	9-3/8	238	9-1/2	241	9-5/8	244	9-5/8	244
95°	100°	8-5/8	219	8-5/8	219	8-3/4	222	8-3/4	222	8-7/8	225	9	229	9	229
100°	105°	8-1/8	206	8-1/8	206	8-1/4	210	8-1/4	210	8-3/8	213	8-1/2	216	8-1/2	216
105°	110°	7-5/8	194	7-5/8	194	7-7/8	200	7-7/8	200	8	203	8-1/8	206	8-1/8	206
110°	115°	7-1/4	184	7-1/4	184	7-1/2	191	7-1/2	191	7-3/4	197	7-7/8	200	7-7/8	200

Door-Control location for 1-3/4" (44mm) thick doors hung on center pivots.														Table 2	
Arm Number Stamp	Non-Hold	J6600-4		J6200-4		J6100-4		J6400-4		J6500-41		J6400-42		J6500-43	
	Hold Open	J6600-7		J6200-7		J6100-7		J6400-7		J6500-71		J6400-72		J6500-73	
Reveal	inches	0 - 3/8		1/2 - 2		2-1/2 - 3-1/4		3-3/8 - 4-1/4		4-3/8 - 5-3/8		5-1/2 - 6-3/8		6-1/2 - 7-3/8	
	mm	0 - 10		13 - 50		55 - 83		85 - 108		111 - 137		140 - 162		165 - 187	
Door Opening Angle		Dimension A		Dimension A		Dimension A		Dimension A		Dimension A		Dimension A		Dimension A	
Hold Open	Door Stop	inches	mm	inches	mm	inches	mm	inches	mm	inches	mm	inches	mm	inches	mm
85°	90°	10-1/4	260	10-3/8	264	10-3/8	264	10-1/2	267	10-5/8	270	10-3/4	273	10-3/4	273
90°	95°	9-1/2	241	9-3/4	246	9-3/4	246	9-7/8	251	10	254	10-1/8	257	10-1/8	257
95°	100°	9	229	9-1/8	232	9-1/4	235	9-1/4	235	9-3/8	238	9-1/2	241	9-1/2	241
100°	105°	8-3/8	213	8-1/2	216	8-3/4	222	8-3/4	222	9	229	9-1/8	232	9-1/8	232
105°	110°	8	203	8-1/8	206	8-1/4	210	8-3/8	213	8-5/8	219	8-3/4	222	8-3/4	222
110°	115°	7-1/2	191	7-3/4	197	7-7/8	200	8	203	8-1/4	210	8-3/8	213	8-3/8	213

## Installation Sequence

- Set average-power of multi-size closer.**  
 (UNIJ3301, UNIJ3501 ONLY)  
 See Adjustment Chart on page 1.
- Select template dimensions.**  
 (See Table 1 or Table 2 on page 2)  
Table 1: 1-3/4" (44mm) thick door on 4-1/2" (114mm) wide hinges or 3/4" (19mm) offset pivots.  
Table 2: 1-3/4" (44mm) thick door on center pivots.  
 Frame reveals and door opening angles as charted; shock absorber will permit five (5) degrees of door travel beyond hold open position.  
**NOTE:** Separate template required for other applications.
- Locate holes on frame face, stop-side.**  
 Four (4) for closer (or drop plate).
- Locate holes on door.**  
 Two (2) for arm foot.
- Prepare door and frame for fasteners.**  
 See Preparation for Fasteners chart below (Table 3).  
**NOTE:** Use of sex nuts is recommended for fastening arm foot to door and the closer body to a flush transom.
- Mount drop plate, (if used) and closer.**  
 Closer power adjustment shaft toward lock edge.
- Disassemble rod-unit from arm assembly and install on door.**  
 Rod under shock absorber and closest possible to lock edge (See Figure 1 and Figure 2).
- Mount main arm onto closer pinion shaft, aligning proper arm mark with pinion flat.**  
 Secure with main arm screw. Arm Mark "S" (See Figure 2).
- Insert connecting rod into slide unit and preload arm.**  
 Secure with rod screws. Adjust rod to perpendicular with door. See Figure 2.
- Adjust closer and install cover.**  
 See Adjustments on page 4

Preparation for Fasteners			Table 3
Fasteners	Door or Frame	Drill-Sizes	
Standard	Self-Drilling Screw	Aluminum or Metal	No drill required
		Wood	3/16" (4.30mm)
	1/4"-20 Machine Screw	Metal	Drill: #7 (0.201" dia)
Optional	Sleeve nuts and bolts	Hollow Metal	9/32" (7mm) through; 3/8" (9.5mm) door face opposite of closer
		Aluminum or Wood	3/8" (9.5mm) through
	Through-bolts and grommet-nuts	All	9/32" (7mm); 3/8" (9.5mm) dia. x 3.8" (9.5mm) deep on door face opposite of closer

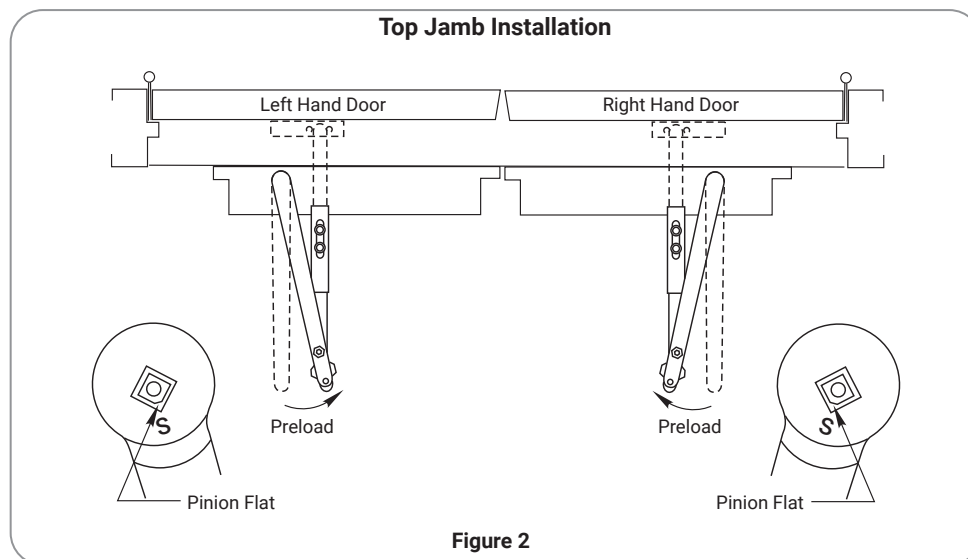

## Adjustments

### Closing Power (See Figure 3)

- Adjust as required.
- Hold Open** controls are at arm elbow (models suffixed "H"). To select hold open on or hold open off and to adjust the hold open force, use a screwdriver as illustrated (See Figure 8)

### Closing Cycle-Hydraulic Control (See Figure 4)

Valve "L" controls door speed in Latch Range.  
Valve "S" control door speed in Sweep Range.  
Valve "D" (Optional) controls door speed in Delay Range.  
For all settings, use 1/8" hex key provided and adjust as shown in Figure 6.

### Opening Cycle-Hydraulic Control (See Figure 5)

Valve "B" cushions (slows) door opening in the Backcheck Range.  
**NOTE:** Never close this valve completely or damage to closer may occur.

For this setting, use 1/8" hex key provided and adjust as shown in Figure 7.

### Installation of Cover:

- Full cover:**  
Slide cover insert into the unused cutout in cover. Install cover using screws provided.
- Narrow cover:**  
Install cover using screws provided. Screw pinion cap onto shaft by hand or with a phillips screwdriver - DO NOT OVER TIGHTEN.
- Full metal cover:**  
Fasten cover to mounting clips with screws provided.
- Architectural plastic cover:**  
Slide cover insert into the unused cutout in cover. Install standoffs in ends of closer. Snap cover onto standoffs.
- Architectural metal cover:**  
Remove cover insert where pinion is located. Install standoffs in ends of closer. Install cover using screws provided.

### Door Holder Option

Figure 8

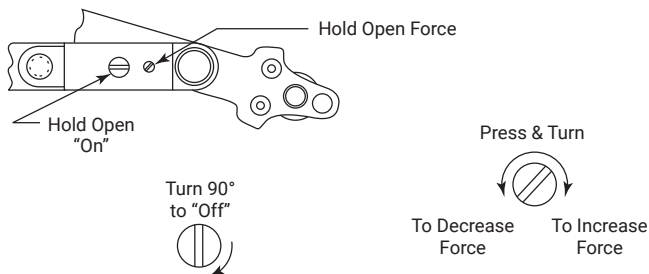

The Hold Open option is found at the arm elbow. To select hold open "on", hold open "off" or to adjust the hold open force, use a flat head screwdriver as illustrated.

### Closing Power Control

Figure 3

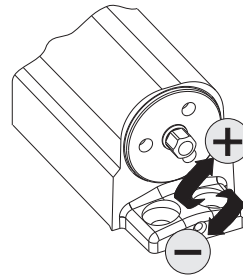

For UNIJ3301 and UNIJ3501 only.  
Refer to Adjustment Chart on page 1

(Use 5/16" socket or adjustable wrench for Adjustment)

### Hydraulic Control

Figure 4

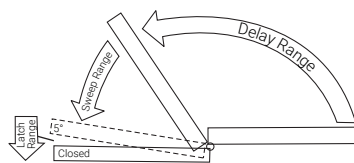

Closing Cycle

Figure 5

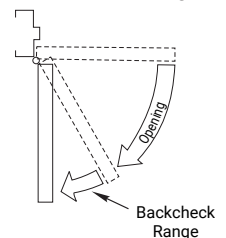

Opening Cycle

### Closing Speed

Figure 6

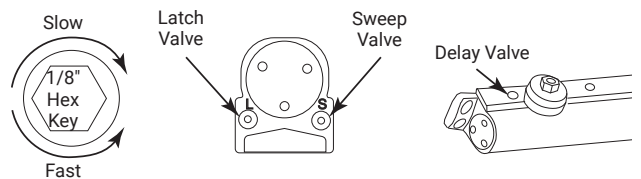

### Backcheck

Figure 7

\*Never close this valve completely.

