

Double Cylinder Latchhead Assembly

Installation Instructions

ACCENTRA
ASSA ABLOY

For use with Rim 7100 Series Double Cylinder Exit Device

1. Follow 626F trim installation instructions. Substitute the cylinder housing assembly with the double cylinder housing assembly supplied with device. Continue with trim mounting instructions.
2. Follow mounting instructions supplied with device, once complete, continue with Double Cylinder instructions listed below.
3. Leave latch cover loose. Pass cylinder thru cylinder collar, latch cover, and cylinder housing as shown. Fasten cylinder housing to cylinder with (2) 12-24 cylinder screws. The keyway position should be vertical with plug in lower side of cylinder as shown. Insert cylinder tail piece into lazy cam slot of double cylinder housing assembly (tailpiece length to be adjusted as needed for non-interference with opposing trim cylinder tailpiece). Install and tighten (2) 8-32 x 5/16" cover screws to latch cover.
4. Check for proper functional operation of trim and exit device.

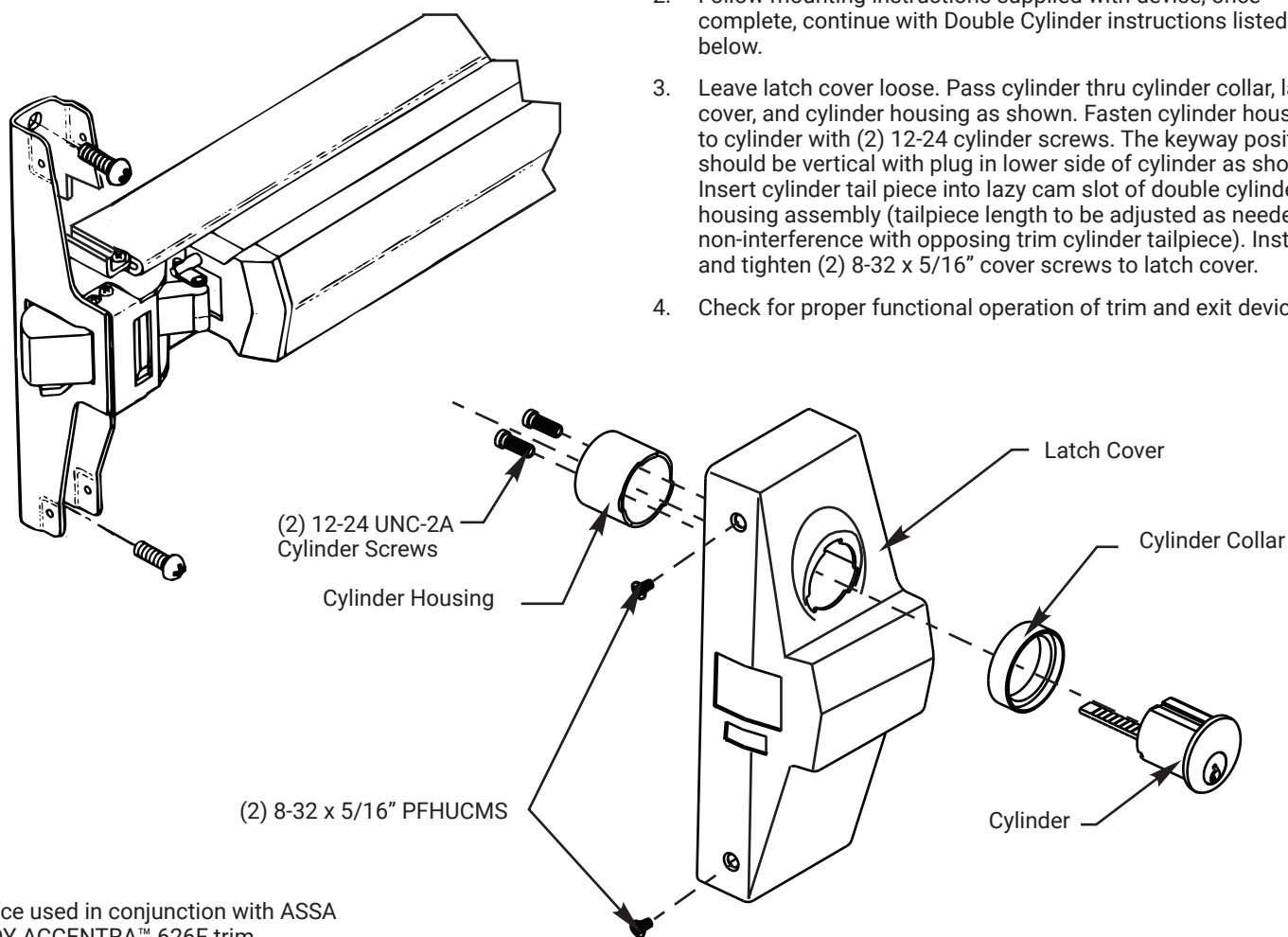

*Device used in conjunction with ASSA
ABLOY ACCENTRA™ 626F trim.

⚠ WARNING

This product can expose you to lead which is known to the state of California to cause cancer and birth defects or other reproductive harm. For more information go to www.P65warnings.ca.gov.

⚠ WARNING

Attention Installer: Any retrofit or other field modification to a fire rated opening can potentially impact the fire rating of the opening, and ASSA ABLOY makes no representations or warranties concerning what such impact may be in any specific situation. When retrofitting any portion of an existing fire-rated opening, or specifying and installing a new fire-rated opening, please consult with a code specialist or local code official (Authority Having Jurisdiction) to ensure compliance with all applicable codes and ratings.

1-855-557-5078 Ext. 2 • www.accentra-assaabloy.com

Copyright © 2012, 2024, ASSA ABLOY ACCENTRA™ Access and Egress Hardware Group, Inc. All rights reserved. Reproduction in whole or in part without the express written permission of ASSA ABLOY Access and Egress Hardware Group, Inc. is prohibited.

80-8470-0002-000 04/24

Experience a safer
and more open world