

Architectural Door Accessories

ASSA ABLOY

Pemko Folding 100 Series

The global leader in
door opening solutions

Folding Wood Doors and Room Dividers - Up to 100 lbs / Up to 24" Wide x 96" Tall

Manufactured by
HENDERSON

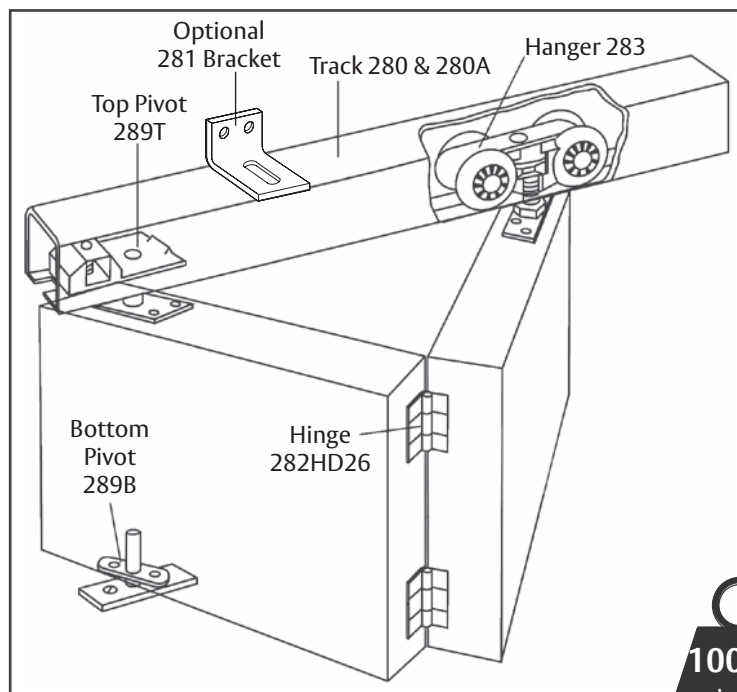

280 Side Wall Mounted

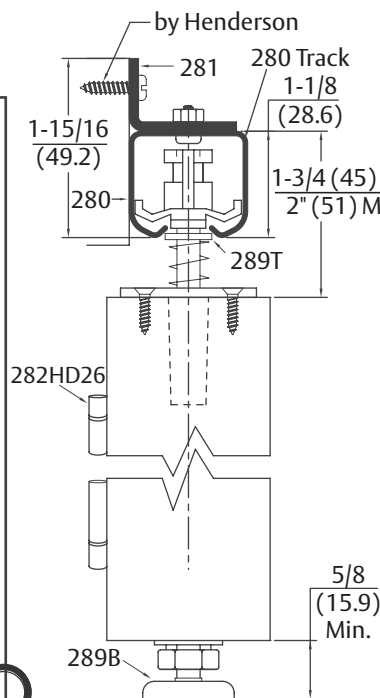

280C Overhead Mounted

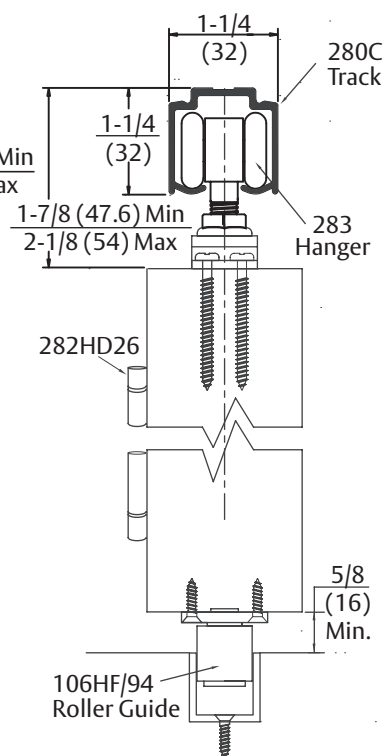

STANDARD KIT SIZES

Part Number	Material	# of Panels	Track Length
HF2/100A/2	Aluminum	2	24"
HF2/100A/2'6	Aluminum	2	30"
HF2/100A/3	Aluminum	2	36"
HF2/100A/4	Aluminum	2	48"
HF4/100A/4	Aluminum	4	48"
HF4/100A/5	Aluminum	4	60"
HF4/100A/6	Aluminum	4	72"
HF4/100A/8	Aluminum	4	96"
HF2/100/4	Steel	2	48"
HF4/100/8	Steel	4	96"

Steel kits include the same components as above, except track is 1 ea 280 galvanized steel.

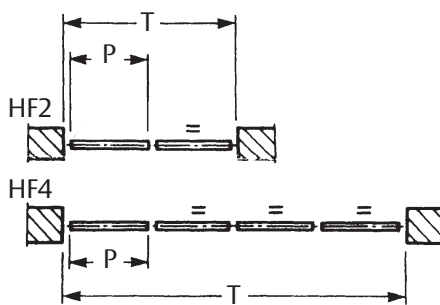

P = Number of Panel
T = Track Length

NOTE: Allow 1/4" (6.4) clearance at pivot jambs and 1/8" (3.2) in between hinged doors if hinges are semi mortised. Allow 3/16" (4.8) between hinged doors if hinges are surface mounted. Allow 1/8" (3.2) between doors meeting in the center of the opening on HF4 kits and allow 1/8" (3.2) between wall and end panel on HF2 kits.

Two Panel: HF2/100A Kits Include:

- 1 ea 280(C) Clear Anodized Aluminum Track
- 1 ea 283 Hanger
- 1 ea 289T Top Pivot
- 1 ea 289B Bottom Pivot
- 3 ea 282HD26 Hinges
- 1 ea 106HF/94 Roller Guide
- 1 ea 94A Aluminum Guide Channel
- 1 ea Adjusting Wrench and Mounting Hardware
- 281 Mounting Bracket - for Side Wall Mounting, optional

Four Panel: HF4/100A Kits Include:

- 1 ea 280(C) Clear Anodized Aluminum Track
- 2 ea 283 Hangers
- 2 ea 289T Top Pivots
- 2 ea 289B Bottom Pivots
- 6 ea 282HD26 Hinges
- 2 ea 106HF/94 Roller Guides
- 1 ea 94A Aluminum Guide Channel
- 1 ea Adjusting Wrench and Mounting Hardware
- 281 Mounting Brackets - for Side Wall Mounting, optional

Door Configuration Options

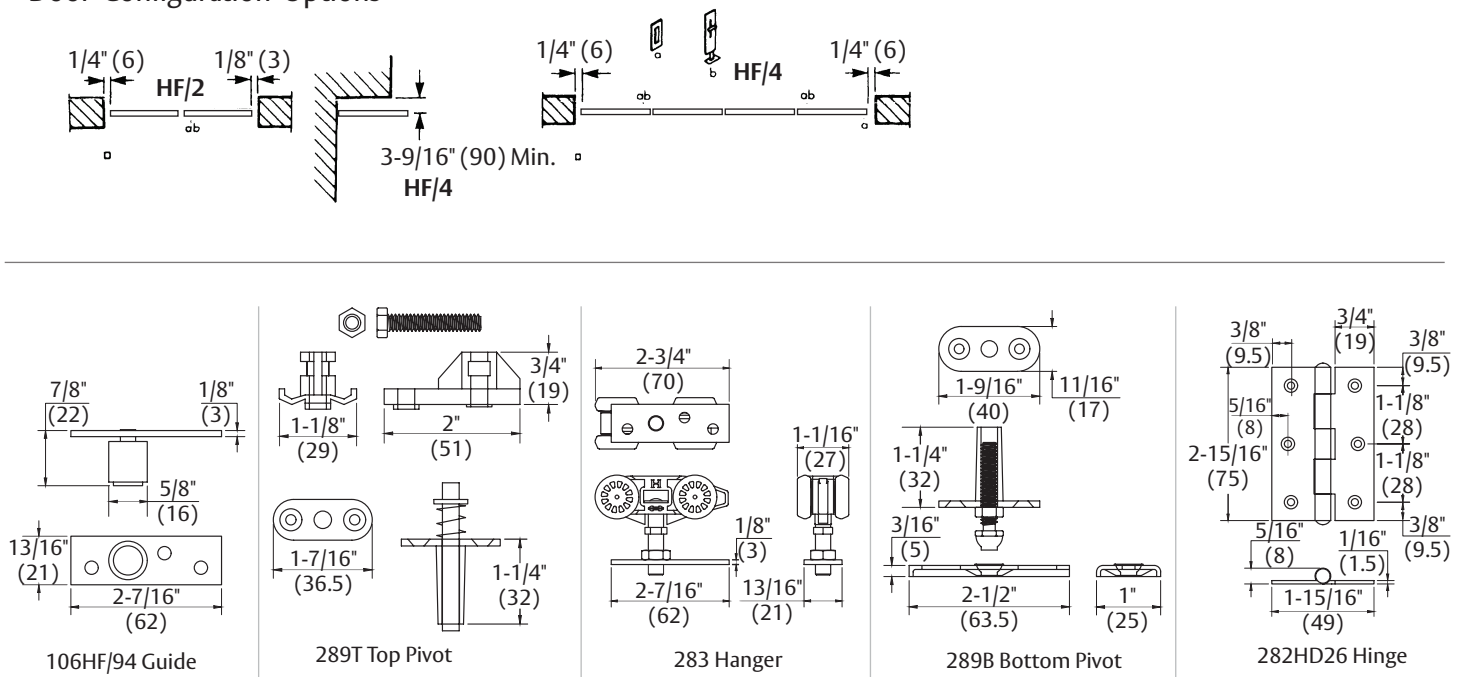

1. Position and secure pivot and hanger apron plates.

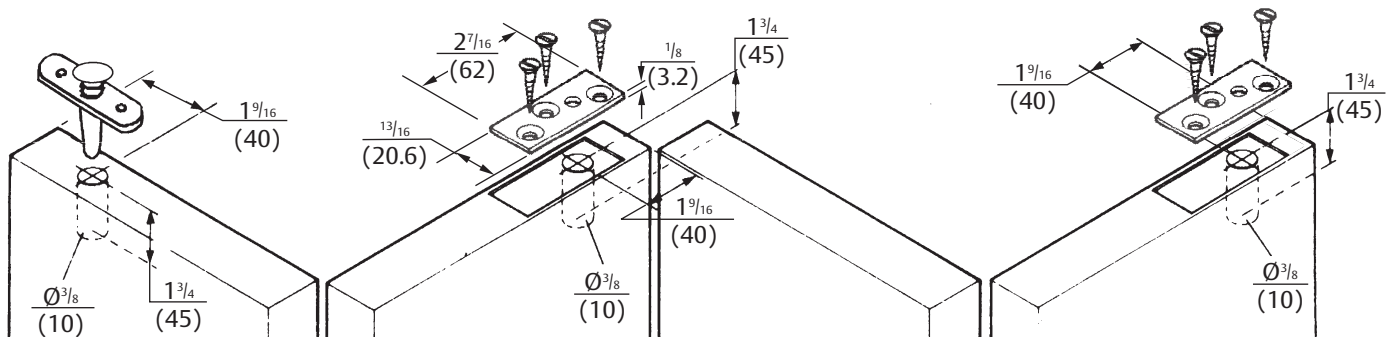

2. Fit bottom pivot assembly.

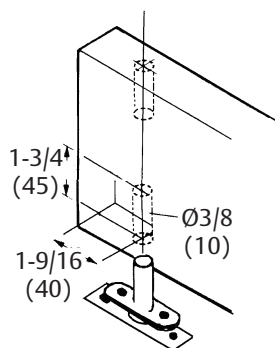

3. Attach hanger to apron plates(s) and bottom guide.

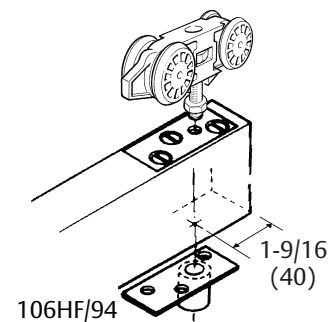

ASSA ABLOY

The global leader in
door opening solutions

Copyright © 2018, ASSA ABLOY Accessories and Door Controls Group, Inc. All rights reserved. Reproduction in whole or in part without the express written permission of ASSA ABLOY Accessories and Door Controls Group, Inc. is prohibited.

81030 10/18

4. Position & secure hinges.

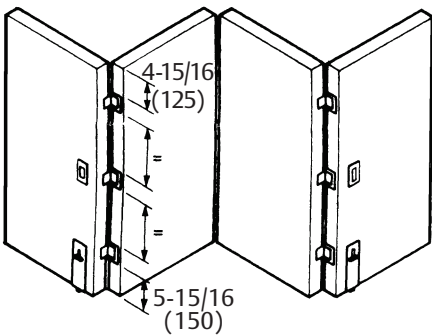

5. Cut track and guide channel to size.

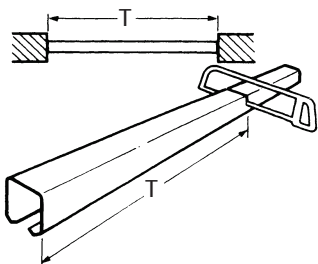

6. Position & secure top bearing plate.

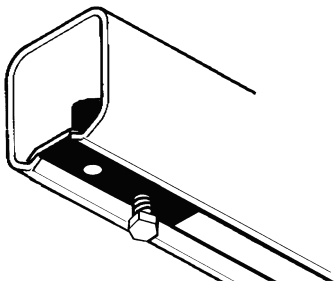

7. Face & Soffit Fix Options

Use one bracket or fastener at each end of track and no more than 3' in between.

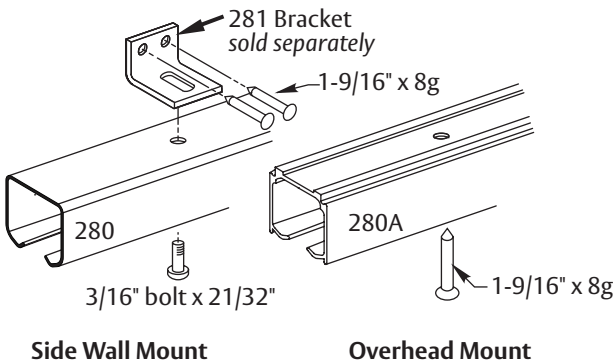

8. Mark for guide channel.

Attach a plumb line to hanger. Using plumb line, mark out the centerline of floor channel.

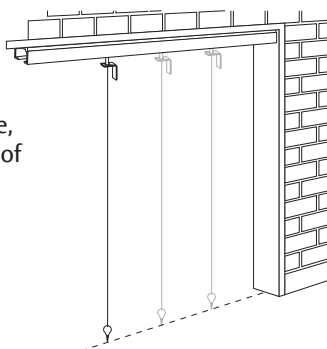

9. Install floor channel.

Check distance between track and floor channel at several intervals along track to ensure track and guide channel are in alignment with each other. Ensure that channel is cut to correct length to accommodate 2-2½" required for pivot plate.

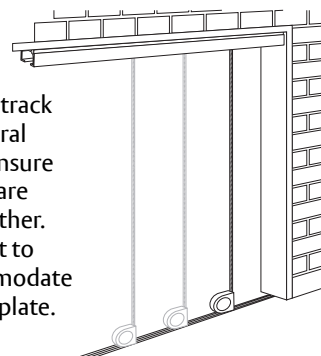

10. Slide doors onto upper track.

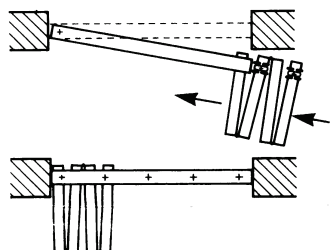

11. Locate & secure bottom pivot plate.

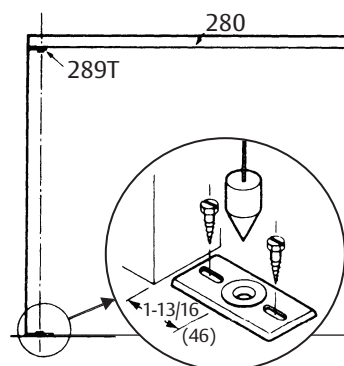

12. Adjust door height.

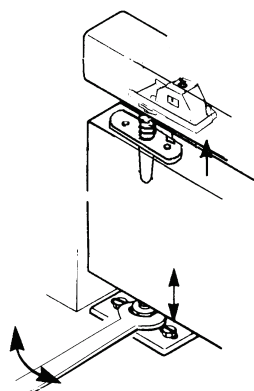

13. Align doors.

