

PEMKO BYPASS TRACK SERIES

Experience a safer
and more open world

NOT TO SCALE

Door Leaf Capacity - Up to 200 lbs

1 3/8" Thick Doors Side Wall Mount

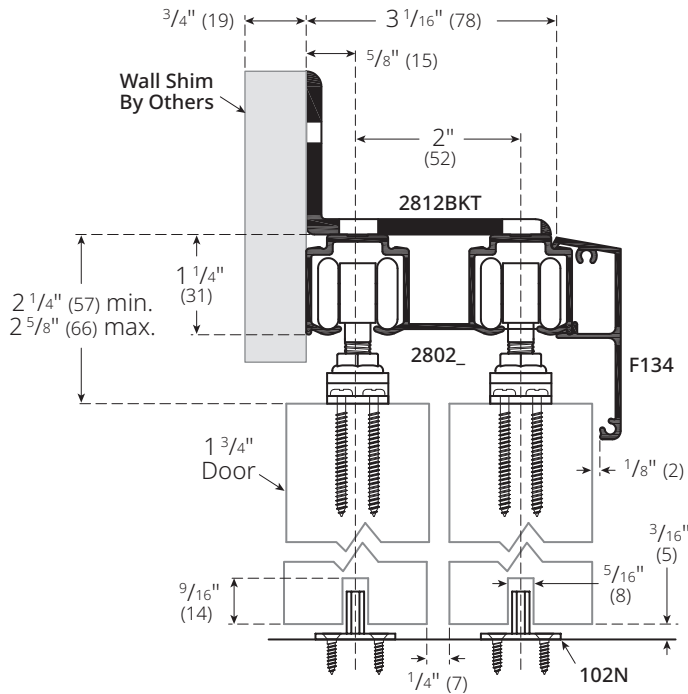

1 3/4" Thick Doors Overhead Mount

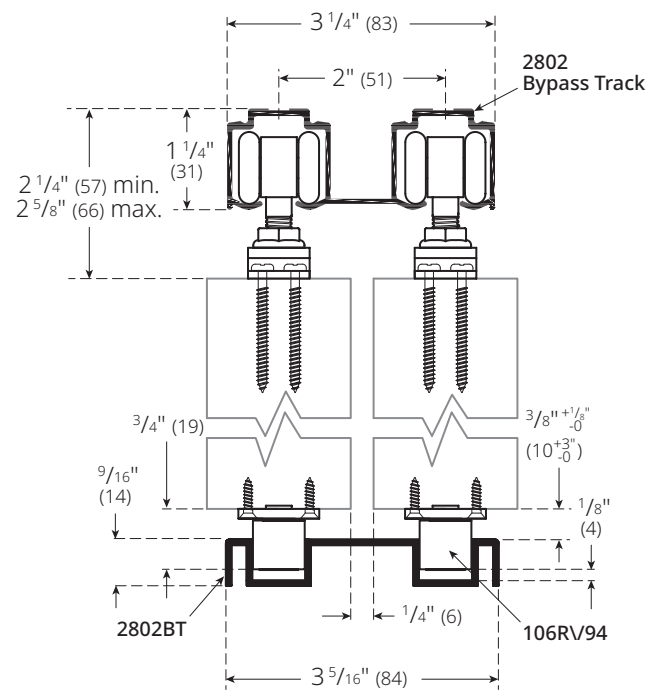

1. Assemble Hanger

If using soft close device, use taller hanger bolt.

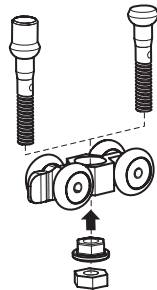

KIT NO.	TRACK LENGTH	DOOR WIDTH
HBP200A/4	48"	2 @ 26" Min*
HBP200A/5'4	64"	2 @ 34" Min*
HBP200A/6	72"	2 @ 38" Min*
HBP200A/7	84"	2 @ 44" Min*
HBP200A/8	96"	2 @ 50" Min*
HBP200A/10	120"	2 @ 62" Min*
HBP200A/12	144"	2 @ 74" Min*

*Minimum door overlap is 2".

2. Fit Hanger Apron to Door Panel

Drill 1/2" (13) dia x 1 1/2" (38) deep hole 5" (127) from door edge to centerline and centered in door thickness.

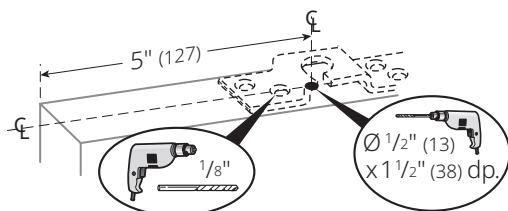

3. Insert Hangers

Ensure that hanger flange is pointing in direction of clip portion of stop as shown. NOTE: If not using soft close, hanger will have shorter hanger bolt.

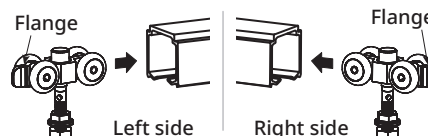

Tools Required:

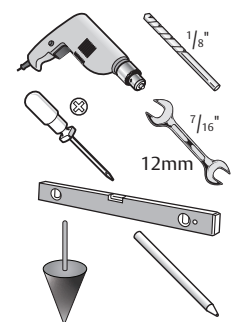

Page 1 of 2

The ASSA ABLOY Group is the global leader in access solutions. Every day, we help billions of people experience a more open world.

ASSA ABLOY Opening Solutions leads the development within door openings and products for access solutions in homes, businesses and institutions. Our offering includes doors, frames, door and window hardware, mechanical and smart locks, access control and service.

4. Secure Track

Ensure track is plumb and level.

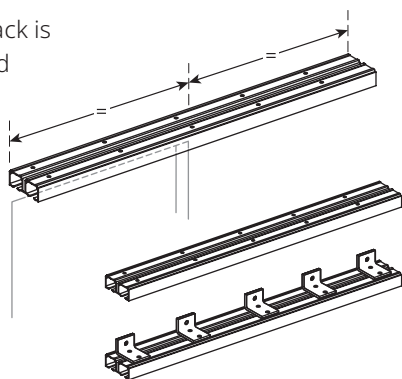

5. Mortise Doors and Fit Door Guides

Attach a plumb line to hanger. Place hanger inside track. Using plumb line, mark for position of door guide on the floor.

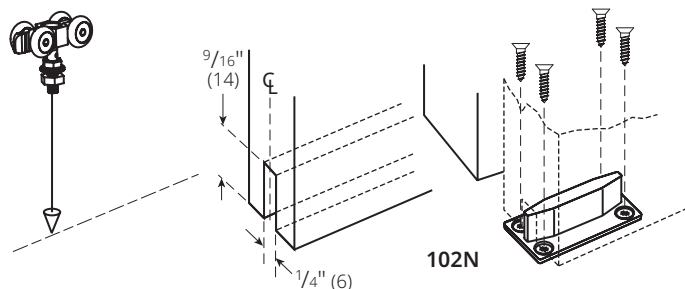

6. Face & Soffit Fix Options

Use one bracket or fastener at each end of track and no more than 3' in between.

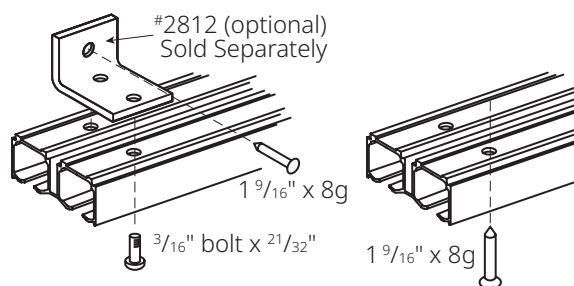

7. Attach Door Panels and Adjust Until Level.

If using soft close device, refer to provided installation instructions beginning with step 3.

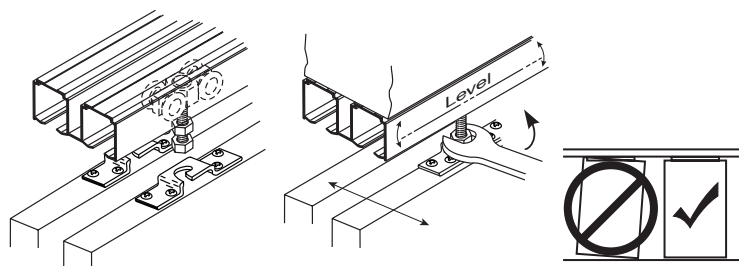

8. Install and secure retaining stops.

If using soft close device, do not install retaining stops.

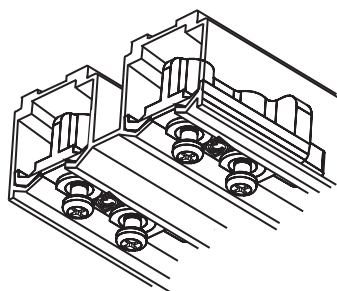

Alternative Guides (Sold Separately)

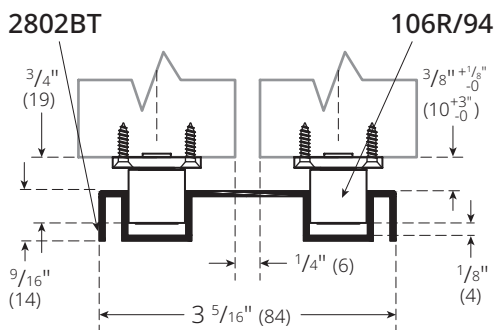

138N-SG2 KIT

Note: This guide is designed for 1 3/8" thick doors.

Position the guide on the floor so that the doors align in the center of each channel.

