

ASSA ABLOY

The global leader in
door opening solutions

Manufactured by
HENDERSON

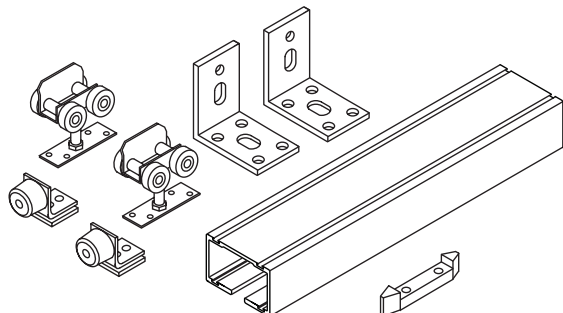
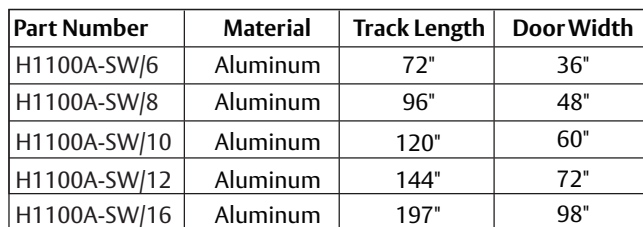

- 1 ea 550A Mill Finished Aluminum Track
 - 1A/550 Aluminum Alloy Side Wall Track Bracket (One at each end and no more than three feet in between.) Fasteners not included.
- 2 ea 556/57 Painted Black Steel Body - Zinc Coated Steel Wheels and Pendant Bolt Hangers
- 2 ea HH3/301 Galvanized Steel In-Track Stop
- 1 ea 89/2N Gray Nylon Mortise Guide

1. Secure track.

Secure track at each end. Inward brackets should be 2' (61m) from each end and centered on track.

Ensure track is plumb and level by adjusting (4) adjustable track screws provided with 1A/550 bracket.

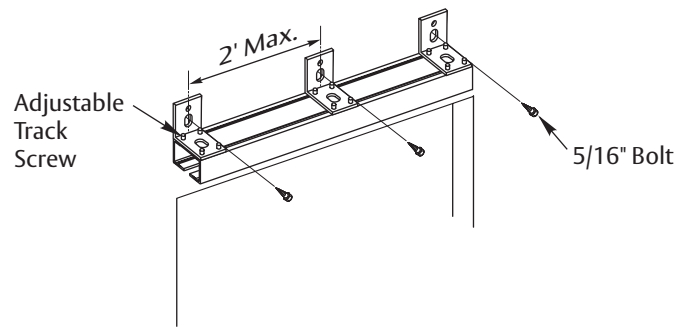

2. Mortise door for door guide.

Attach a plumb line to hanger. Place hanger inside track. Using plumb line, mark the centerline of door guide.

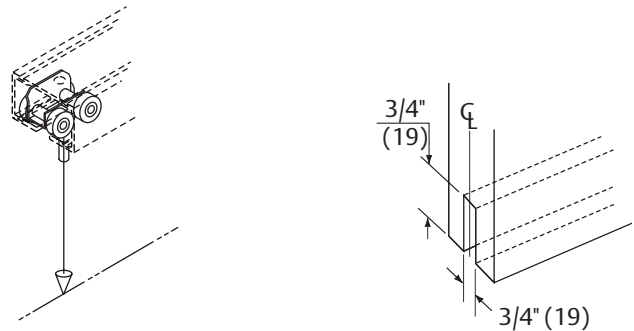

3. Fit door guide to floor.

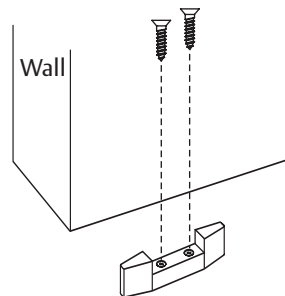

4. Prepare top of door for hanger hardware.

- 1 Drill $1\frac{5}{16}$ " (33.3) dia. x 2" (50.8) deep hole 6" (152.4) from door edge to centerline of hole and centered in thickness of door.
- 2 Route door for $\frac{1}{4}$ " (6.4) thick, $7\frac{5}{16}$ " (185.7) long, and $1\frac{1}{2}$ " (38.1) wide plate centered on centerline of hole and thickness of door.

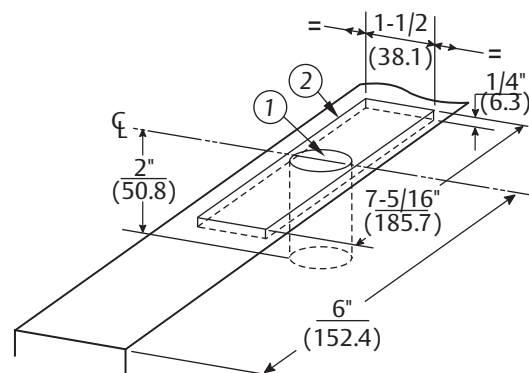

ASSA ABLOY

The global leader in
door opening solutions

Copyright © 2017, Pemko Manufacturing Co., an ASSA ABLOY Group company. All rights reserved.
Reproduction in whole or in part without the express written permission of Pemko Manufacturing Co. is prohibited.

81012 02/17

5. Attach hangers to doors.

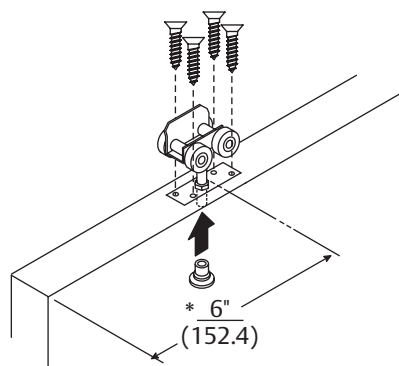

*From door edge to centerline of hanger bolt and plate.

6. Hang door.

Slowly guide complete door unit into track using installed floor guide.

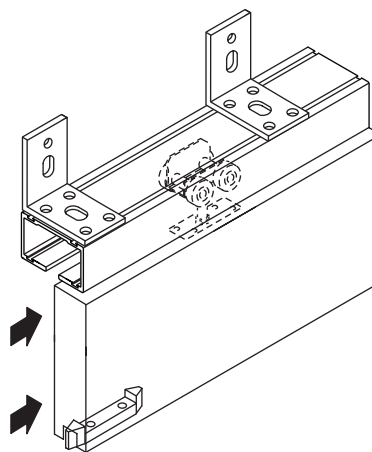

7. Position and secure clip stops.

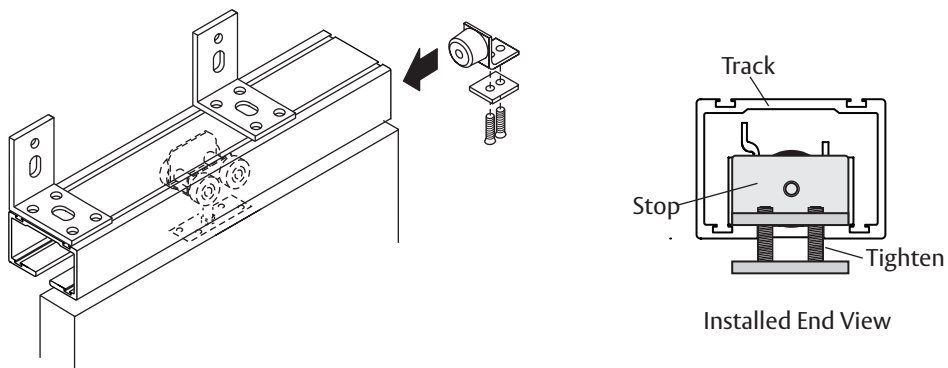

ASSA ABLOY

The global leader in
door opening solutions

Copyright © 2017, Pemko Manufacturing Co., an ASSA ABLOY Group company. All rights reserved.
Reproduction in whole or in part without the express written permission of Pemko Manufacturing Co. is prohibited.

81012 02/17

ASSA ABLOY is the global leader in door opening solutions, dedicated to satisfying end-user needs for security, safety and convenience

ASSA ABLOY

IMPORTANT:

Visually check all bolts and screws; tighten if necessary.

If access door is installed, check operation.

Check operation of doors for ease.

- Door catches floor guide: Check that the track is level. Ensure that the track and floor guide are parallel to within $\pm \frac{1}{8}$ " (3).
- Door scrubs: Check that the door is level on hangers.
- Door moves while in operation: Check hangers are installed correctly.

www.pemko.com

USA:
Ventura, CA 93003
Phone: 800.283.9988

Memphis, TN 38141
Phone: 800.824.3018

Canada:
Vancouver, BC V2T6W3
Phone: 877.535.7888

Toronto, ON L4K4T9
Phone: 877.535.7888