

Architectural Door Accessories

ASSA ABLOY
Opening Solutions

McKinney 80 Concealed Hinge 3D Adjustable

Experience a safer
and more open world

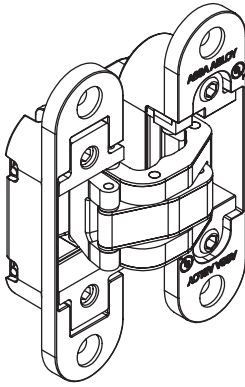

Hinge Arrangement

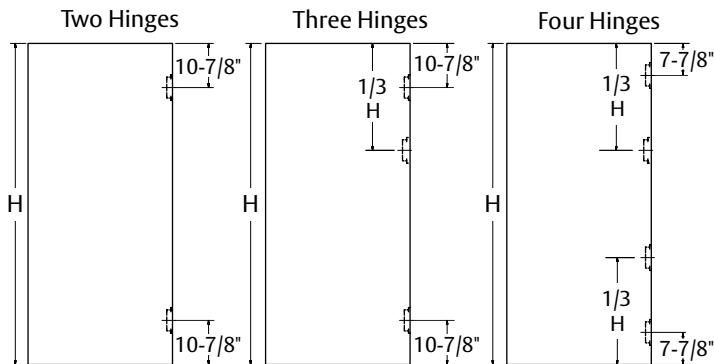

"H" Min. = 80"

Load Capacity

See chart for minimum number of hinges required based on correct adjustment (all hinges carrying load), door width and door weight.

Door height minimum is 80".

Door thickness minimum is 1-3/8".

Note: Hinge spacing does not effect load capacity. The first door should always be checked before preparing more doors, if any. When installing with a door closer, at least 3 hinges are required, and reduce maximum door weight in chart by 30%.

Hinges	Door Width			
	32"	36"	42"	48"
2	185 lb	176 lb	143 lb	132 lb
3	211 lb	198 lb	160 lb	149 lb
4	233 lb	220 lb	171 lb	158 lb

Hinge Dimensions (millimeters)

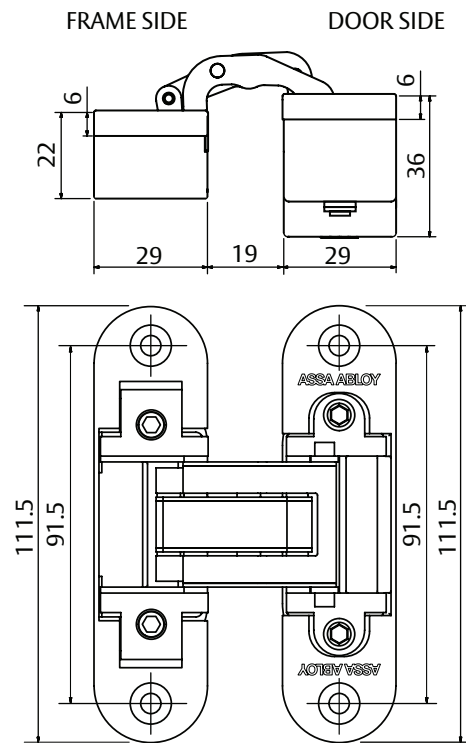

Milling Dimensions (millimeters)

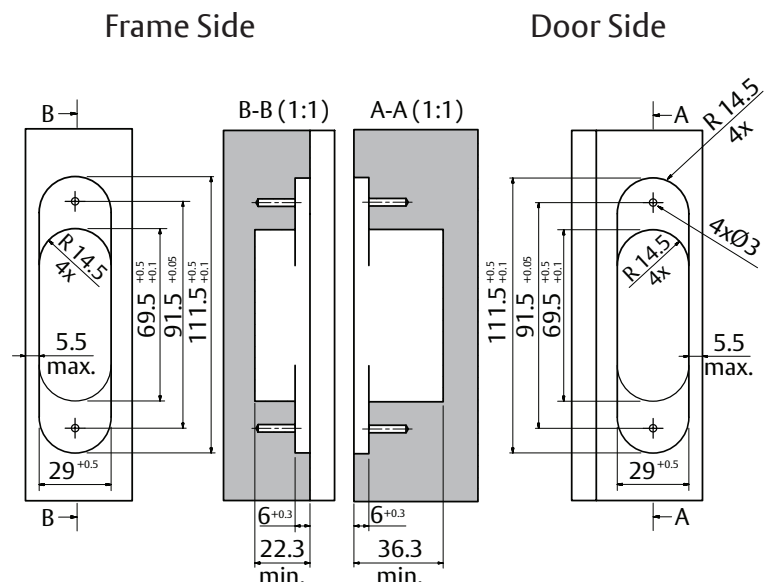

ASSA ABLOY
Opening Solutions

Technical drawing of a door assembly. The drawing shows a side view of a door with a frame. Key dimensions and components are labeled:

- Frame:** The structure surrounding the door.
- Door:** The main panel.
- Dimensions:**
 - Vertical dimensions: 29 (+0.3 / +0.1) for the door height, 6 for the frame thickness, 22 (+0.5 / +0.1) for the frame width, and 36 (+0.5 / +0.1) for the door width.
 - Horizontal dimensions: 5.5 max. for the frame depth, min. 1 max 5 for the door depth, L for the door length, and B for the frame width.
- Labels:** C1, C2, G, and Door.

"G" Thickness of Door	C1 (mm)	C2 (mm)	"L" Width of Door			
			32"	36"	42"	48"
			"B" Minimum Gap (mm)			
1-3/8"	3	3	2	2	2	2
1-3/4"	5.5	10	2	2	2	2
2"	5.5	16.3	3	3	3	3
2-1/4"	5.5	22.7	4	4	3	3

Technical drawing of a door hinge assembly, showing the Frame Leaf and Door Leaf. The Frame Leaf (left) has two mounting points labeled 1a and 1b. The Door Leaf (right) has two mounting points labeled 2. Dimensions A and B are indicated. Arrows show the direction of movement for the door leaf.