

PEMKO
SOFT CLOSE DEVICE FOR
BOX TRACK HARDWARE SYSTEM

Experience a safer
and more open world

WARNING: DO NOT LEAVE DOOR UNATTENDED AT ANY POINT DURING INSTALLATION!

For easy 3D instructions, download the BILT mobile app available on the App Store or Google Play.

Works with Pemko Systems:
H180, SHS80, H200, 280_SWTKIT, SF280_SWTK, RF280SWTK, HBP200

PART NUMBER	DESCRIPTION
SC1411-1	Single Device 88-132 lbs
SC1411-2	Dual Device 88-132 lbs
SC1413-1	Single Device 133-176 lbs
SC1413-2	Dual Device 133-176 lbs
SC1418-1	Single Device 177-200 lbs
SC1418-2	Dual Device 177-200 lbs

Minimum Door Width 28"

Tools Required:

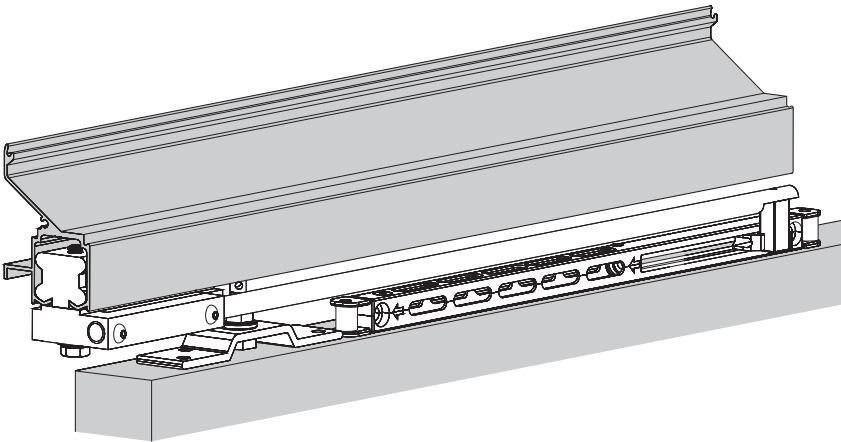
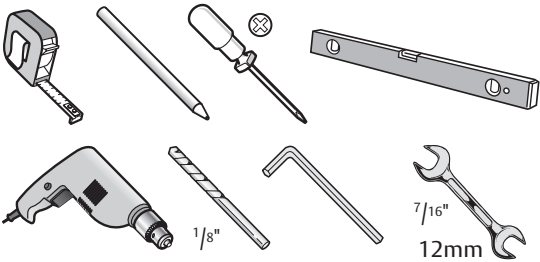

1. Remove Door

- a. Remove fascia and end caps if applicable.
- b. Measure and record the clearance or gap from bottom of track to top edge of door. This will be important later
- c. Remove in track stops.
- d. Remove door from track by sliding door off of one end of track.
- e. Remove hanger from mounting bracket using WRENCH14 (provided) and 12mm wrench (not provided).
- f. Door can also be removed by loosening nuts on hanger using WRENCH14 (provided) and 12mm wrench (not provided).
- g. Unhook door from hangers as shown.

NOTE: Move door past door guide before unhooking door.

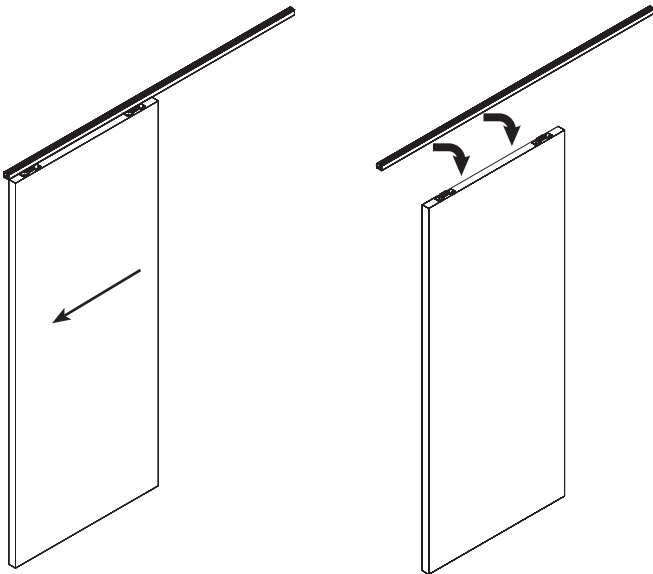

2. Replace Hanger Bolts

(Only for 280_SWTKIT, SF280_SWTK, and RF280SWTK.)

- Remove hanger bolt and replace it with taller hanger bolt provided as shown.

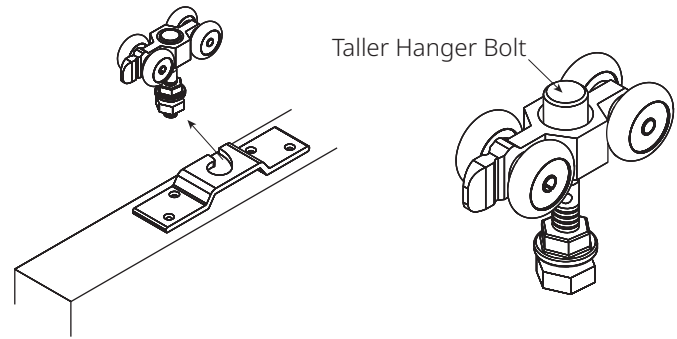

3. Activate Devices

- Slide catch towards center of device as shown.

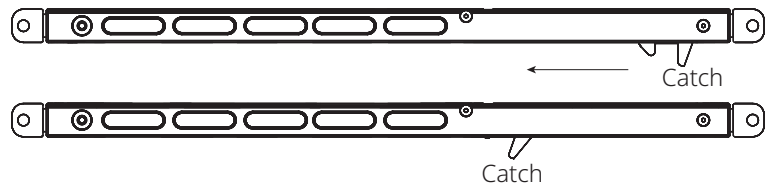

4A. Position Soft Close Damper(s)

- Locate soft close damper(s) on top door edge. Pay special attention to damper orientation as shown. Catches are installed toward center of door.
 - Damper mounted on left side of door must face front of door. Damper on right side of door must face back of door as shown.
- System may come with only one damper.

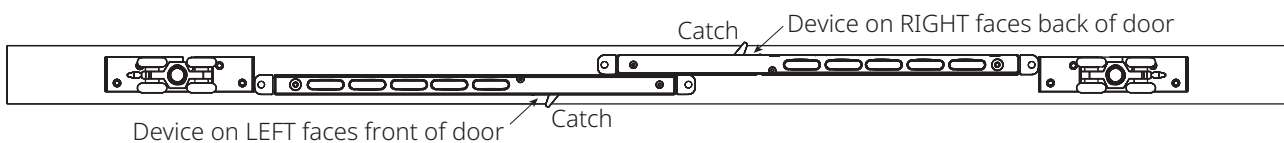

4B. Mark and Pre-drill Holes for Damper(s)

- Pre-drill $\frac{1}{8}$ " x 2" for #10 x 2" wood screws (provided).

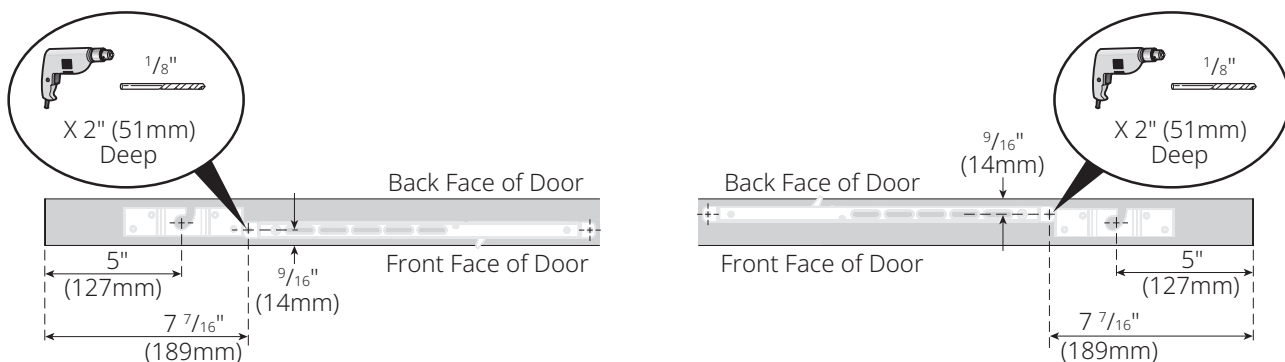

4C. Install Damper(s) with Spacers

- a. Insert spacers (provided) between mounting tabs on dampers as shown.
- b. Attach damper to top door edge using #10 x 2" wood screws.

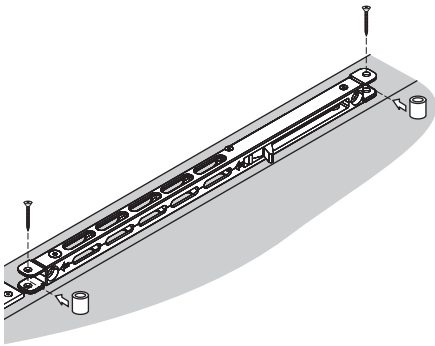

5. Hang Door and Adjust Until Level

- a. Slide door into open end of track or hook door to hangers as shown.
- b. Adjust until level.

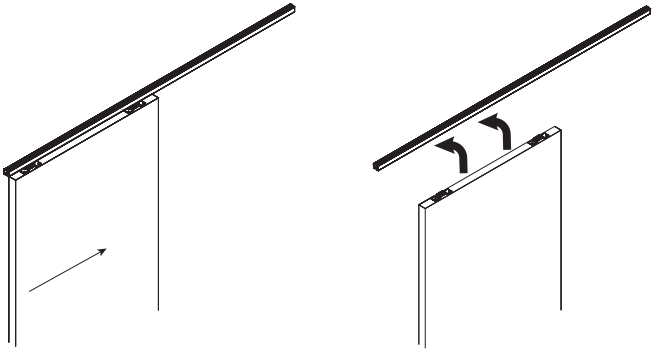
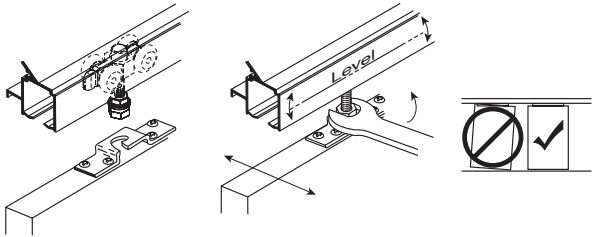

6. Choose Activator Pin

- a. Choose appropriate activator pin by using recorded clearance information you gathered in step one and chart in this step.

CLEARANCE	ACTIVATOR PIN
1" to 1 1/4"	Short Pin
1 5/16" to 1 3/8"	Long Pin

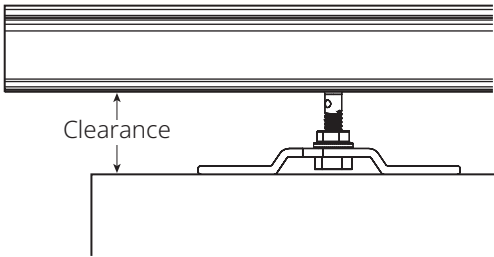

7. Install Activator Pin

- a. Install appropriate activator pin on end of rod as shown using 5/64" hex wrench (provided).

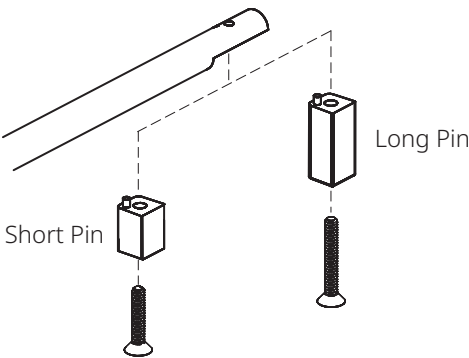

The ASSA ABLOY Group is the global leader in access solutions. Every day, we help billions of people experience a more open world.

ASSA ABLOY Opening Solutions leads the development within door openings and products for access solutions in homes, businesses and institutions. Our offering includes doors, frames, door and window hardware, mechanical and smart locks, access control and service.

8. Install Activator Assembly Into Track

- Install activator assembly into track as shown.
- Be sure that activator pin is pointing towards center of track.
- Ensure bottom base portion of activator is in line with door edge when door is in open/closed position as shown.
- Tighten two hex bolts in bottom base of activator assembly using $\frac{7}{16}$ " wrench (not provided).
- Tighten two screws in bottom base of activator assembly using $\frac{1}{8}$ " hex key (not provided).

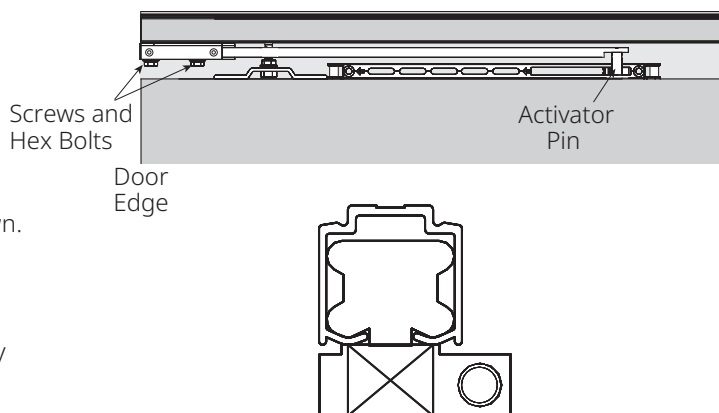

9. Align Activator

- Move door to open/closed position.
- Adjust activator assembly location as needed.
- Ensure proper engagement between activator pin and soft close damper.

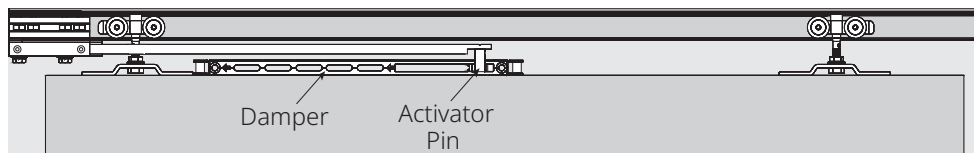

10. Reinstall Fascia and End Caps

- Apply foam tape to fascia 14" in from door edge to edge of foam as shown if applicable.
- Apply second foam tape to wall 14" in from opposite end of track edge to edge of foam as shown if applicable.
- Reinstall fascia and end caps.

