

# Acoustical Door System 2-1/2" STC 55

TESTED AND IN COMPLIANCE WITH ASTM E90, ASTM E413, ASTM E1332, AND ASTM E2235. DOOR SYSTEMS ARE IN COMPLIANCE WITH HMMA 865 AND SDI-126 SPECIFICATIONS. COMPLETE WITH PERIMETER SOUND SEALS, BOTTOM SEALS AND THRESHOLD AS REQUIRED FOR RATING.

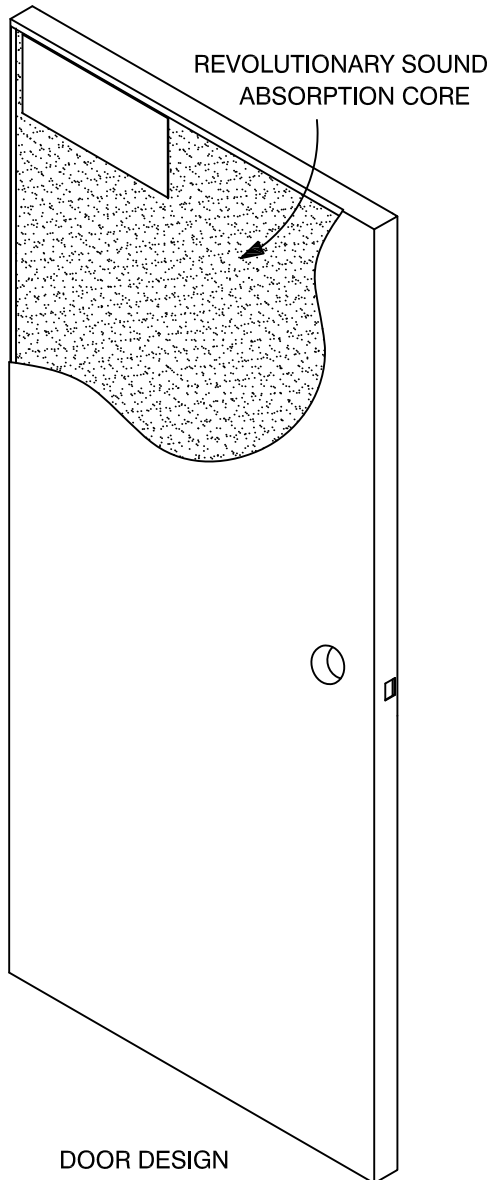

*THE REQUIRED CORE WILL BE PROVIDED TO ACHIEVE THE RATING NEEDED. APPROPRIATE ACOUSTICAL SEAL SET IS PROVIDED WITH EACH STC RATED ASSEMBLY.*

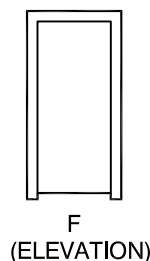
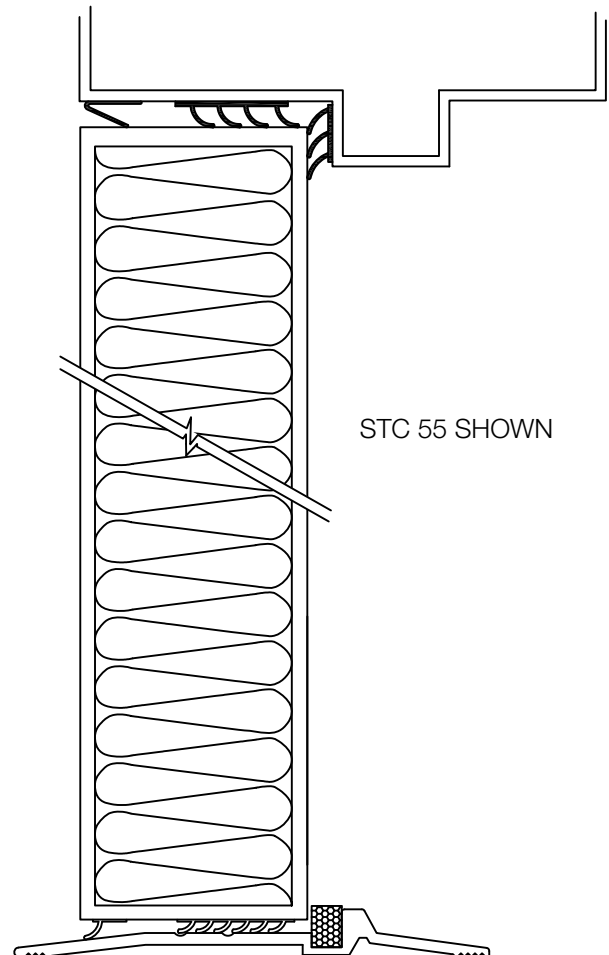

**SUGGESTED USES:**  
CONFERENCE ROOMS, CLINICAL OFFICES, COURTROOMS, LEGAL OFFICES, BROADCAST STUDIOS, BOARDROOMS, LIBRARIES, MUSIC ROOMS, AND PERFORMING ARTS STUDIOS, HOTEL/MOTEL, AND MILITARY/ GOVERNMENT FACILITIES.

# Acoustical Door Systems STC 55

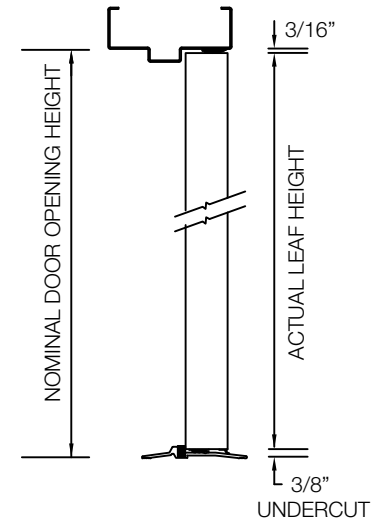
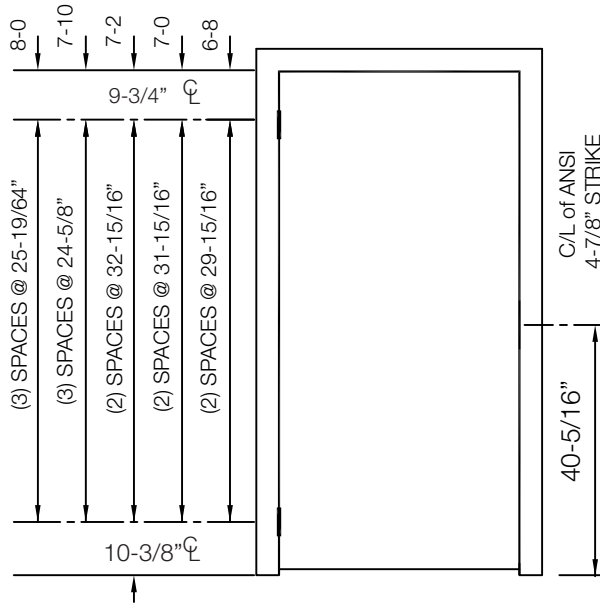

**VERTICAL SECTION**

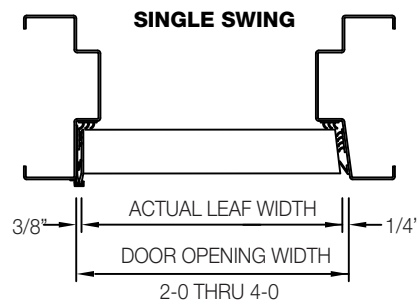

**HORIZONTAL SECTIONS**

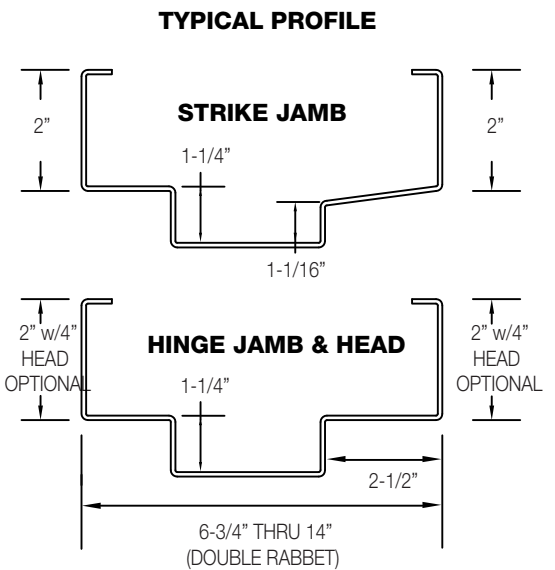

**SOME COMMON MASONRY APPLICATIONS SHOWN BELOW**

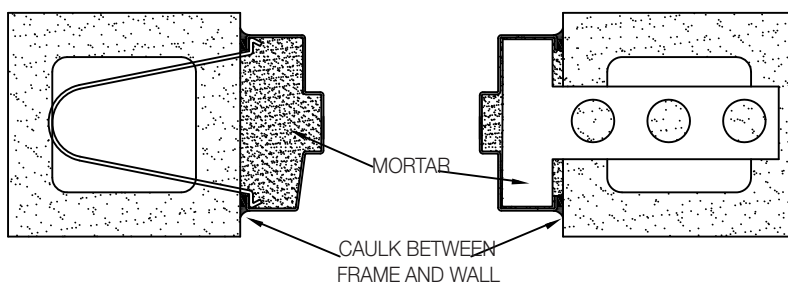

It is important that acoustic door systems be properly installed and sealed into the wall to prevent "flanking noise". Acoustical systems are furnished with detailed instructions.

# Acoustical Door Systems STC 55

MASONRY "T"  
ANCHOR

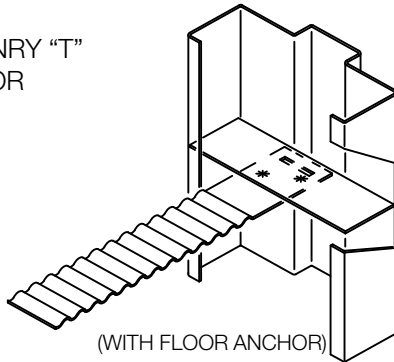

WIRE MASONRY  
ANCHOR

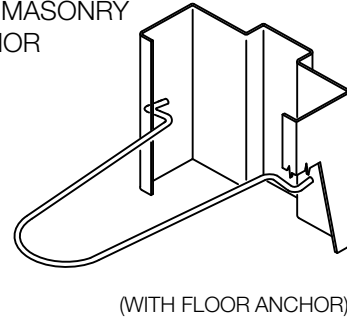

YOKE AND STRAP  
MASONRY ANCHOR  
(ANCHOR FITS  
VARIOUS DEPTHS)

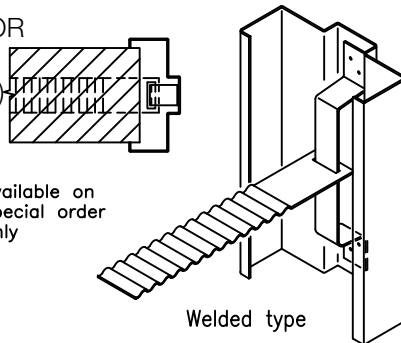

EXISTING OPENING  
ANCHOR  
(ANCHOR FITS  
VARIOUS DEPTHS)

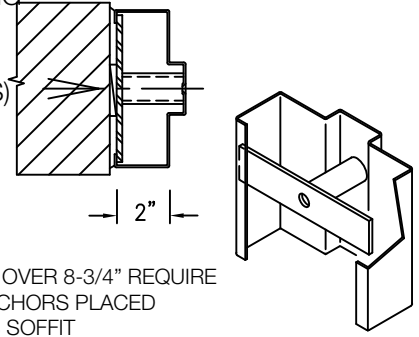

DOOR CONSTRUCTION  
TOP AND BOTTOM

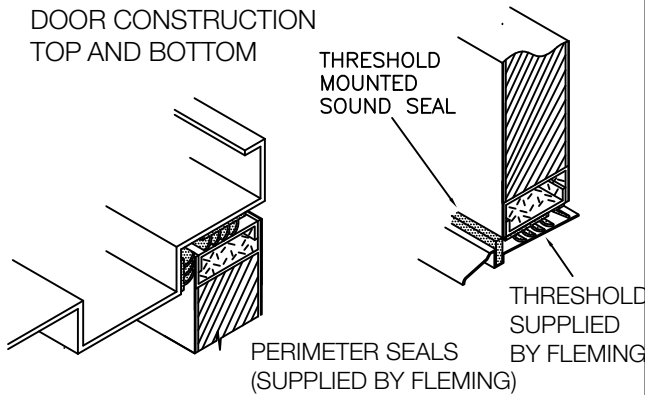

HINGE PREPARATIONS

PEMKO X2.5M  
EXTRA-HEAVY DUTY  
CONTINUOUS HINGE  
(SUPPLIED BY FLEMING)

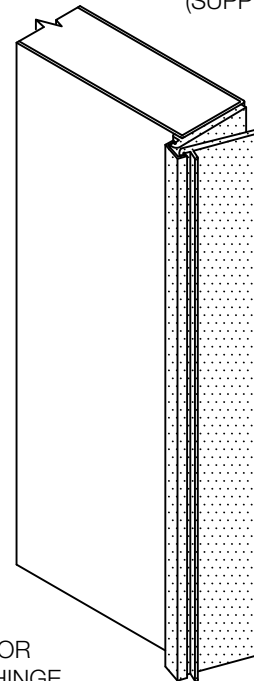

LOCK PREPARATIONS

SARGENT 11 LINE  
CYLINDRICAL ("O" ROSE)  
OR CORBIN RUSSWIN  
CL3100 CYLINDRICAL  
("C" ROSE)  
BACKSET 2-3/4"  
WITH 3/4" LATCH THROW  
ONLY.  
LOCK EDGE IS BEVELED

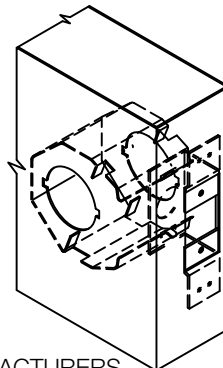

CHECK WITH THE LOCK MANUFACTURERS FOR THE STC 55 LOCK ORDER CODES.

STANDARD SIZES  
NOMINAL DOOR OPENING

WIDTH SINGLE	HEIGHT
2'-0"	6'-8"
2'-6"	7'-0"
2'-8"	7'-2"
3'-0"	7'-10"
3'-4"	8'-0"
3'-10"	
4'-0"	

ACOUSTIC DOOR SYSTEM LABELS

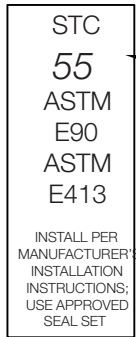

ACTUAL  
STC RATING  
SHOWN HERE

# Acoustical Door Systems STC 55

## PRODUCT SPECIFICATIONS:

2-1/2" Thick acoustical steel door system shall be as provided by FLEMING Door Products. Doors and frames shall conform to the Steel Door Institute guide specification, ANSI A250.8 as applicable. The door skin thickness is 18 gauge.

The doors and frames are commercial quality A40 galvanized steel conforming to ASTM A653 & ASTM A924. Acoustic core and internal construction is manufacturer's proprietary standard as tested in accordance with ASTM E90, E413, E1332, & E2235 to furnish the STC rating specified. Door systems are in compliance with HMMA 865 & SDI-128 specifications. A physical door label is applied to certify the product and identify the specific rating. The label will be applied to the door only and there will not be a label applied to the frames. Frames are double rabbet profile of continuously welded construction and are available for any masonry acoustic wall system application. They are constructed of 16 gauge min. or 14 gauge max. to provide the STC performance specified. Mutes/Silencers are not allowed in these frames. The frames must also be mortar filled to achieve the STC rating.

### Hardware Provisions:

Doors and frames will be reinforced for a Pemko X25MC or X25MD (specify finish) extra heavy-duty continuous hinge (supplied by Fleming). The door lock edge has a standard bevel and is prepared for a Sargent 11 Line or Corbin Russwin CL3100 (ANSI/SDI A250.14) cylindrical lock. Check with Sargent for the STC 55 11 Line lock order code. Check with Corbin Russwin for the STC 55 CL3100 lock order code. Sargent "O" rose should be specified. A 3/4" latch throw is required. The lock jamb preparation is for 4-7/8" high strike (ANSI A250.14).

### Paint:

Doors shall be provided with one coat of oven-cured neutral color prime paint. Primer coat shall conform with ANSI A250.10. Finish coats are also available, for the door only, from a selection of standard colors (optional). Finish coats are electrostatically applied, oven-cured urethane enamel, and shall conform to ANSI A250.3. Finish paint can be provided, upon request, for the door only.

	STC Rating	Lock Type	Under-cut	Max. Fire Rating	Seal Set Description
Single Door	55	Cylindrical	3/8"	-	Pemko Seals:S776, S44, 2008 threshold-Set 7

### Notes:

Industrial standard construction tolerances for squareness of frame installation, plumbness of walls, flatness of floors, flanking, etc. may result in a difference of 3db-5db sound loss in a field test versus lab test. Please note that tolerances for flatness of acoustic doors tend to exceed those of conventional hollow metal. Installation of exit devices and other wide hardware can exaggerate the slight bow in the door created by sound dampening material used to meet the required STC rating. This is not considered a manufacturing defect.