

4400 Series Slide Track Door Closer

Models 4440ST and P4440ST

Low Profile, Pull or Push Side, Non-Hold Open

Installation Instructions

ACCENTRA

ASSA ABLOY

Pull (Hinge) Side

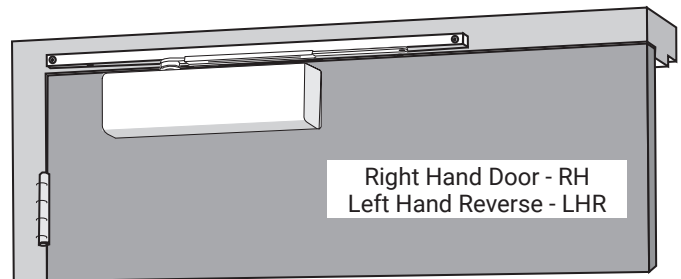
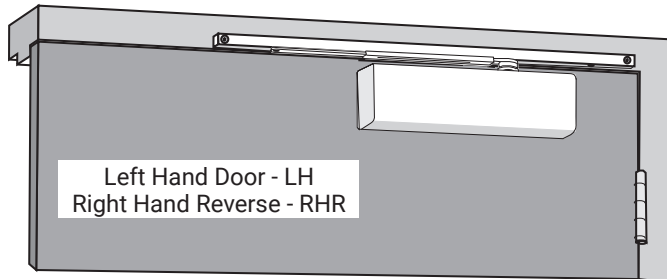

Push (Stop) Side

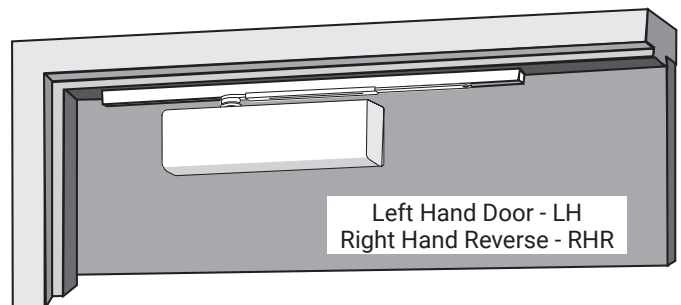
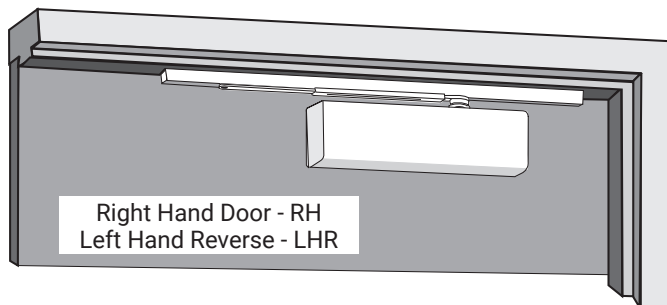

To Determine Hand of Door:

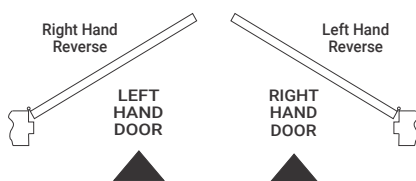

To Identify the Model:

Older models may be stamped "1-6", "1-4" or "2-6". They can be replaced with a newer "1-6" model which has no stamp.

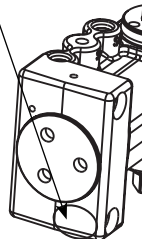

Standard 4400ST = 4 valves
Delayed Action 4400STDL = 5 valves

Tools Needed

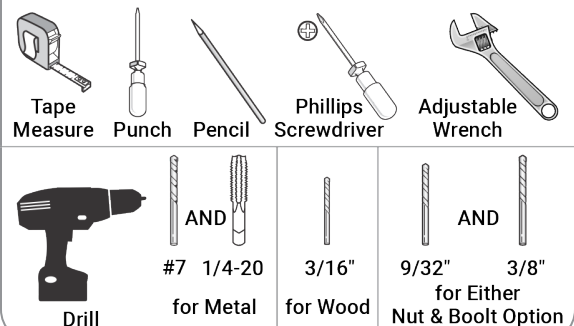

⚠ WARNING

This product can expose you to lead which is known to the state of California to cause cancer and birth defects or other reproductive harm. For more information go to www.P65warnings.ca.gov.

⚠ WARNING

Attention Installer: Any retrofit or other field modification to a fire rated opening can potentially impact the fire rating of the opening, and ASSA ABLOY makes no representations or warranties concerning what such impact may be in any specific situation. When retrofitting any portion of an existing fire-rated opening, or specifying and installing a new fire-rated opening, please consult with a code specialist or local code official (Authority Having Jurisdiction) to ensure compliance with all applicable codes and ratings.

855-557-5078 x 2 • www.accentra-assaabloy.com

Copyright © 1997, 2011, 2024, 2025, ASSA ABLOY Access and Egress Hardware Group, Inc. All rights reserved. Reproduction in whole or in part without the express written permission of ASSA ABLOY Access and Egress Hardware Group, Inc. is prohibited.

80-9344-0551-010 Rev 4 02/25

Experience a safer
and more open world

Approved 2025-02-26

ATTENTION:

An incorrectly installed or improperly adjusted door closer can cause property damage or personal injury. These installation instructions should be followed to avoid the possibility of misapplication or misadjustment.

- For special applications, a separate door and frame preparation template is packed with these instructions. Use these instructions for installation sequence and closer adjustments only.
- 4400 Series closing force is adjustable from 1-6 as outlined in ANSI Standard A156.4. When closer is adjusted to conform to ADA reduced opening force requirements (5 lbs max.) for interior doors, it may not have adequate closing force to reliably close and latch door. Charted power adjustments in instructions are recommended where possible, to ensure proper door control.
- Adjust closing time speed between 3 - 7 seconds from 90° - 0°
- These door closers should NOT be installed on exposed side (weather side) of exterior doors.
- Minimum top rail of door with frame stop for PULL Side mount is 3-1/2" (89mm) without drop plate; 2" (51) with 486JP drop plate. Minimum top rail of door with frame stop for PUSH Side mount is 5-1/4" (133mm) without drop plate; 3-5/8" (92) with 486JP drop plate.
- Doors should be hung on 4-1/2" or 5" wide butt hinges (ball bearing or anti-friction).
- A separate door stop is recommended.
- Always consult door/frame manufacturer for fastener compatibility.
- Door and frame must be properly reinforced.
- Dimensions are given in inches (millimeters).

Included Components

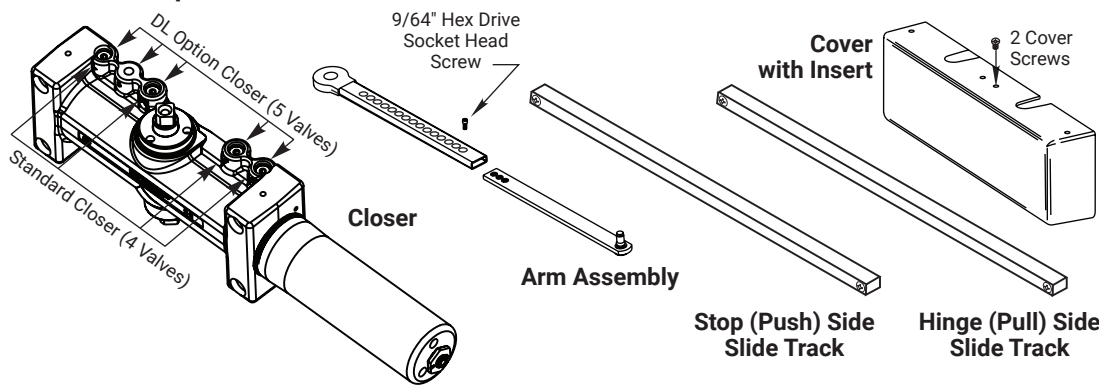

Optional Components

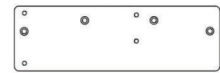

486JP Drop Plate

Mounting Hardware		Door or Frame	Drill
	Track: 1/4-14 x 1-1/2 Flat Head Self Drilling Screw	Wood	3/16" (4.76mm)
		Aluminum or Metal	no drill required
	Track: 1/4-14 x 3 Flat Head Self Drilling Screw	Wood	3/16" (4.76mm)
		Aluminum or Metal	no drill required
	Track: 1/4-20 x 1-1/2 Oval Head Machine Screw	Metal	Drill #7 (.201 dia. or 5.10mm) Tap 1/4-20
	Closer: 1/4-20 x 3 Flat Head Machine Screw		
	Closer or Track: Sleeve Nut and Bolt (SNB) (optional)	Hollow Metal	9/32" (7.00mm) thru 3/8" (9.50mm) door face opposite to closer
		Aluminum or Wood	3/8" (9.50mm) thru
	Closer or Track: Thru Bolt and Grommet Nut (TBGN) (optional)	All	9/32" (7.00mm) thru 3/8" (9.50mm) dia. x 3/8" (9.500mm) deep, door face opposite to closer

Models 4440ST and P4440ST

Low Profile, Pull or Push Side, Non-Hold Open

ACCENTRA
ASSA ABLOY

Pull Side Installation

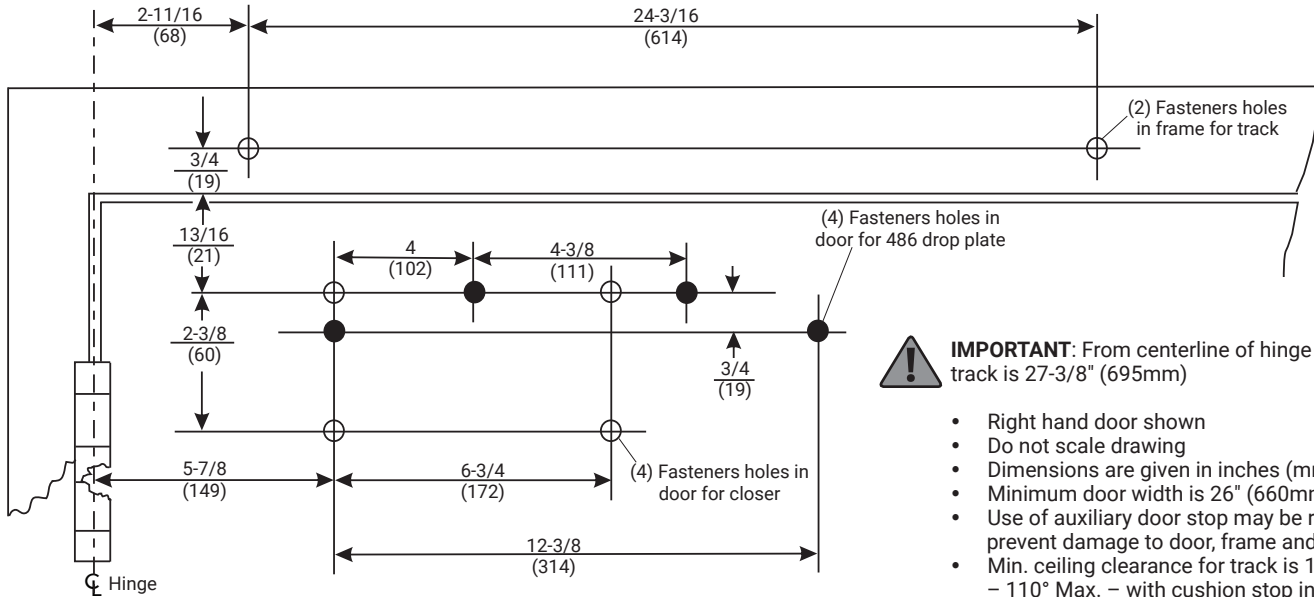

IMPORTANT: From centerline of hinge to end of track is 27-3/8" (695mm)

- Right hand door shown
- Do not scale drawing
- Dimensions are given in inches (mm)
- Minimum door width is 26" (660mm)
- Use of auxiliary door stop may be required to prevent damage to door, frame and hinge.
- Min. ceiling clearance for track is 1-1/8" (27mm)
 - 110° Max. - with cushion stop in track
 - 180° Max. - without cushion stop

• Drop Plate & sex nuts not shown

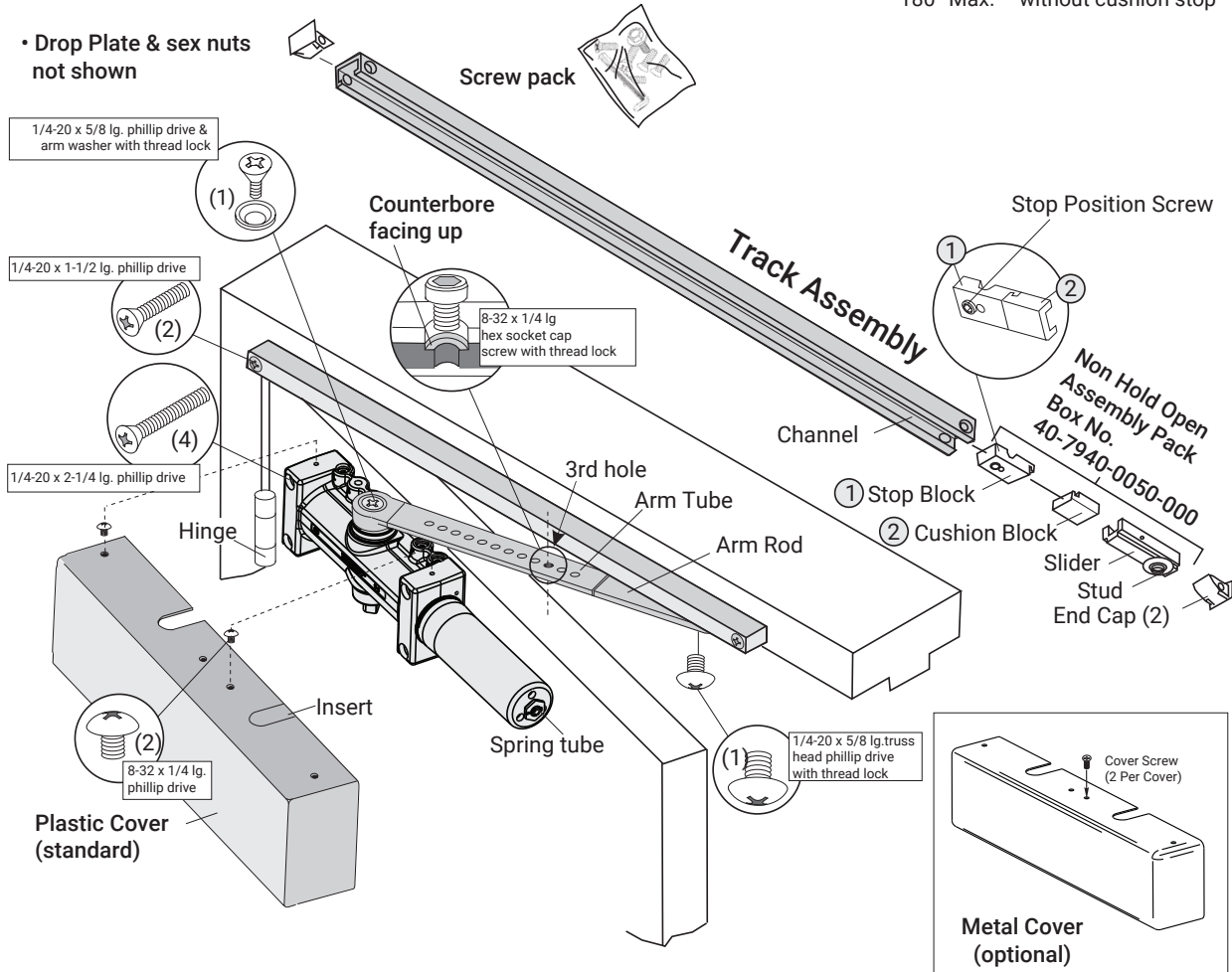

855-557-5078 x 2 • www.accentra-assaabloy.com

Copyright © 1997, 2011, 2024, 2025, ASSA ABLOY Access and Egress Hardware Group, Inc. All rights reserved. Reproduction in whole or in part without the express written permission of ASSA ABLOY Access and Egress Hardware Group, Inc. is prohibited.

80-9344-0551-010 Rev 4 02/25

Experience a safer
and more open world

Approved 2025-02-26³

ACCENTRA

ASSA ABLOY

Models 4440ST and P4440ST

Low Profile, Pull or Push Side, Non-Hold Open

Push Side Installation

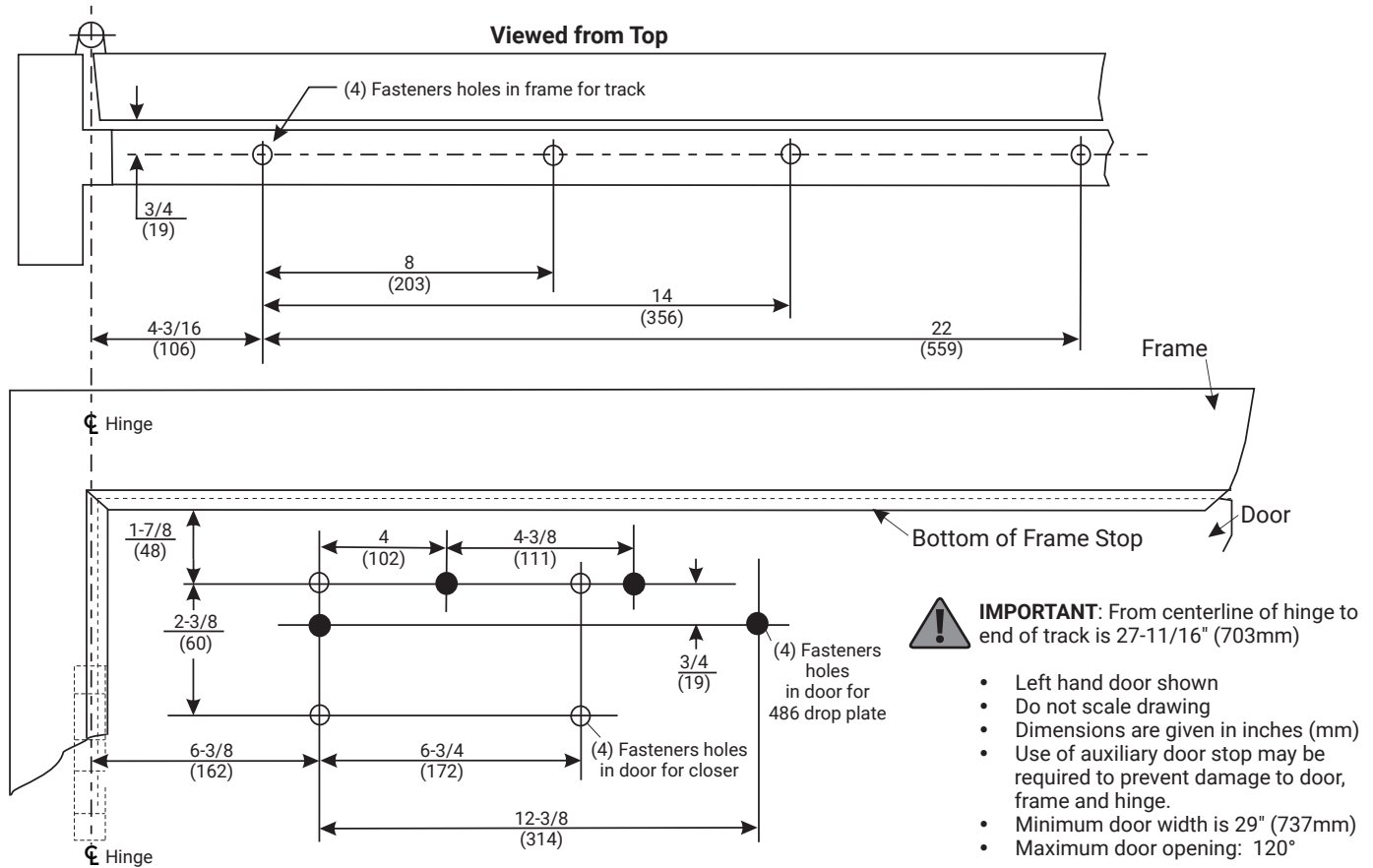

• Drop Plate and sex nuts not shown

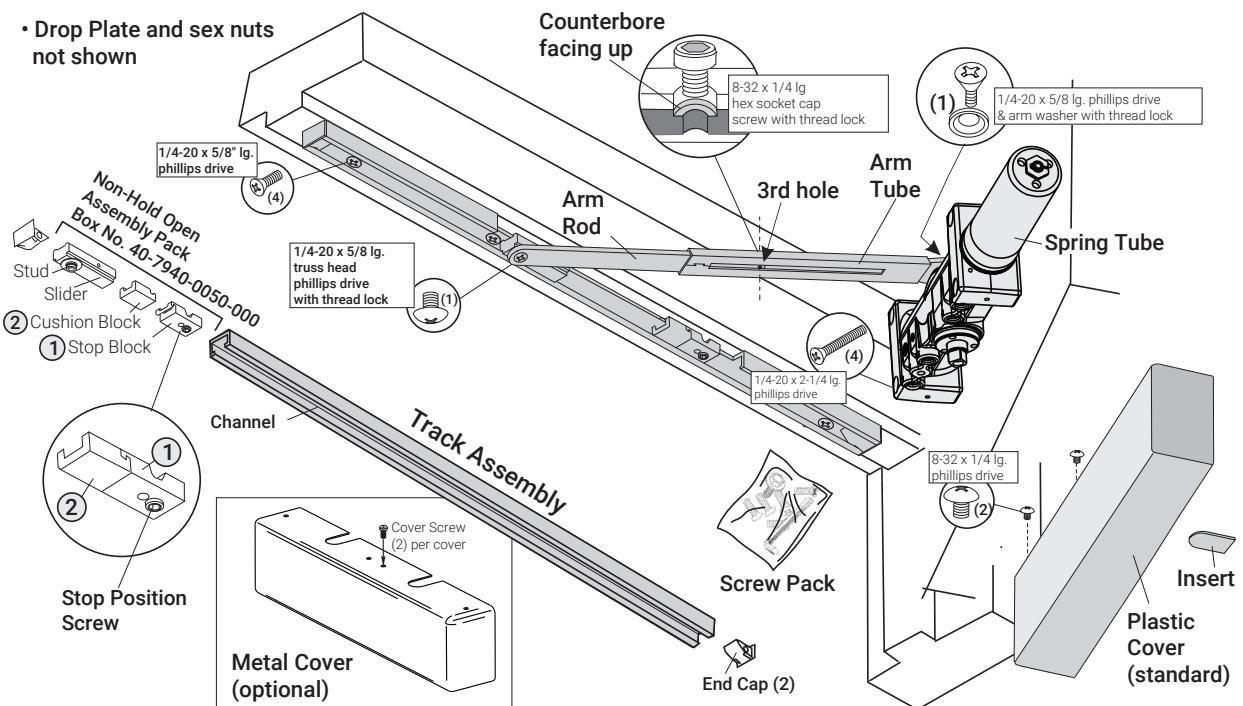

Experience a safer
and more open world

855-557-5078 x 2 • www.accentra-assaabloy.com
Copyright © 1997, 2011, 2024, 2025, ASSA ABLOY Access and Egress Hardware Group, Inc. All rights reserved. Reproduction in whole or in part without the express written permission of ASSA ABLOY Access and Egress Hardware Group, Inc. is prohibited.

80-9344-0551-010 Rev 4 02/25

Approved 2025-02-26⁴

Models 4440ST and P4440ST

Low Profile, Pull or Push Side, Non-Hold Open

ACCENTRA
ASSA ABLOY

PULL or PUSH Side Mounting Instructions

Installation Sequence

1. Determine hand of door and type of installation from illustrations on page 1.
2. Use template dimensions for PULL Side, page 3 or PUSH Side, page 4 to locate fastener holes on door and frame. See "Preparation for Fasteners" chart below.

Frame: Prepare frame for mounting track. Drill and tap holes for 1/4-20 machine screws or #14 wood screws.

Door: Prepare door for mounting closer. Drill and tap (4) holes for 1/4-20 machine screws, #14 wood screws, 3/8 diameter sex-nuts, or through bolts and grommet-nuts.

NOTE: If drop plate is used, prepare holes for 486 drop plate instead of closer. Secure drop plate before mounting closer.

3. Fasten closer to door or drop plate. Position spring tube away from hinge. See arm indexing illustrations for valve positioning (up or down). (Figure 1) Secure mounting screws.
4. Assemble Slide Arm. Insert flat arm rod into arm tube with the counterbore screw hole facing up. Align counterbore with 3rd hole in arm tube and secure with 8-32 x 1/4 long hex socket cap screw. See illustration on PULL, page 3 or PUSH, page 4.
5. Install arm on closer pinion. Position slide arm with counterbore facing up and align with pinion flat as illustrated. (Figure 1) Install onto pinion. Secure with washer and flat head phillips drive arm screw with thread lock.

6. Assemble track by removing slider assembly parts from box #40-7940-0050-000 and inserting into channel in order shown on PULL Side, page 3 or PUSH Side, page 4.

NOTE: Use of a hold open device or assembly will void the UL® listing for this product.

7. Install track to frame. Insert end caps into ends of track and place slide track against frame with open side down, stop and cushion blocks toward hinge. Move slider to opposite end of slide track. Secure slide track with 1/4-20 flat head phillips drive mounting screws.
8. Connect arm to track. Open door approximately 5" (127mm), rotate arm to slider and place end on stud. Push down on arm and tap gently to seat (to prevent stud from turning during assembly). Secure with 1/4-20 x 5/8" long truss (rounded) head phillips drive screw with thread lock.
- CAUTION:** Closer arm is under spring tension and may be difficult to rotate.
9. Install cover as shown on PULL Side, page 3 or PUSH Side, page 4 or make adjustments. (page 6)

Preparation for Fasteners		
Fasteners	Door or Frame	Drill-Sizes
#14 type "A" Sheet Metal Screw Arm: 1-14" (32mm) Closer: 2-3/4" (70mm)	Wood	7/32" (5.56mm)
1/4"-20 Machine Screw	Metal	Drill: #7 (0.201" dia) Tap: 1/4"-20
Sex nuts and bolts	Hollow Metal	9/32" (7mm) through; 3/8" (9.5mm) door face opposite of closer
	Aluminum or Wood	3/8" (9.5mm) through
Through-bolts and grommet-nuts (optional)	All	9/32" (7mm); 3/8" (9.5mm) dia. x 3/8" (9.5mm) deep on door face opposite of closer

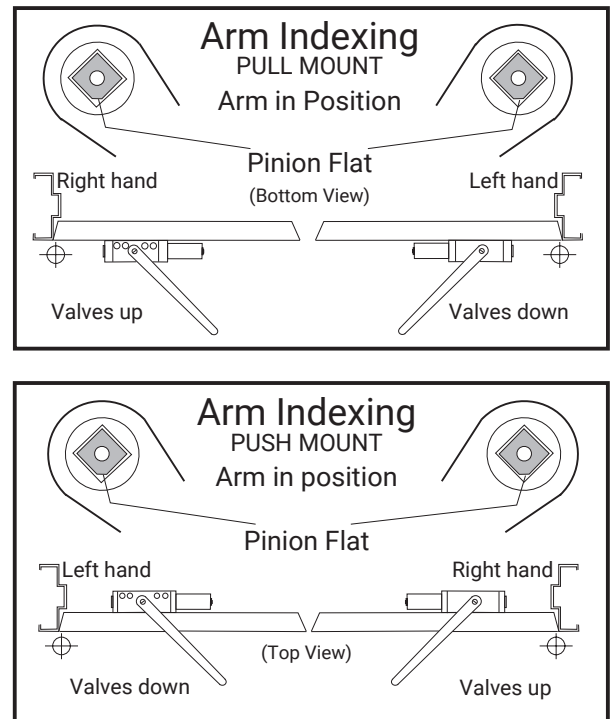

Figure 1

Adjustments

Door Stop Angle (Figure 2)

Open door to desired angle for door to stop. With door held at that location, slide stop block with cushion block against slider. Tighten stop position screw (large set screw) with 3/16" hex wrench (from screw pack) until secure. Release door.

Closing Power (Figure 3)

4440 Models are fully adjustable for proper sizing (Figure 3). To adjust closer power, install closer per instructions with proper pre-load applied to arm then adjust spring power.

NOTE: Power adjustment will not work properly if closer spring is not pre-loaded.

Closing Cycle (hydraulic control) (Figure 4)

Standard Closer Only

- Valve "L" controls door speed in Latch range.
- Valve "S/D" controls door speed in Sweep range.

Delayed Action Closer Only

- Valve "L" controls door speed in Latch range.
- Valve "S" controls door speed in Sweep range.
- Valve "S/D" controls door speed in Delay range.

Opening Cycle (hydraulic control) (Figure 4)

- Valve "B" cushions (slows) door opening in backcheck range.
- Valve "P" allows "backcheck" to begin later in opening cycle.

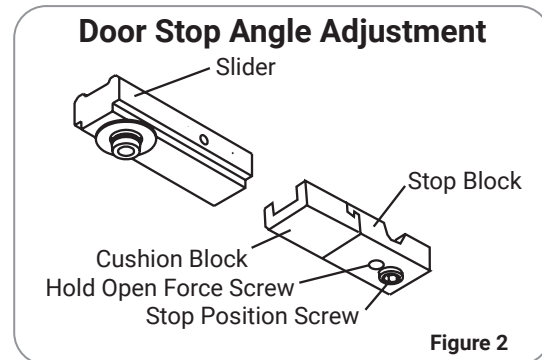

Power Adjustment Chart				
DOOR	Number of Full Clockwise Turns Required			
	MAXIMUM DOOR SIZE			
	28"-32" (71-81cm)	33"-36" (84-91cm)	37"-42" (94-107cm)	43"-48" (109-122cm)
Interior Door	0	2	5	8
Exterior Door	2	5	8	11

NOTE: Maximum of 15 turns (360°) of Power Adjustment Nut.

Figure 3

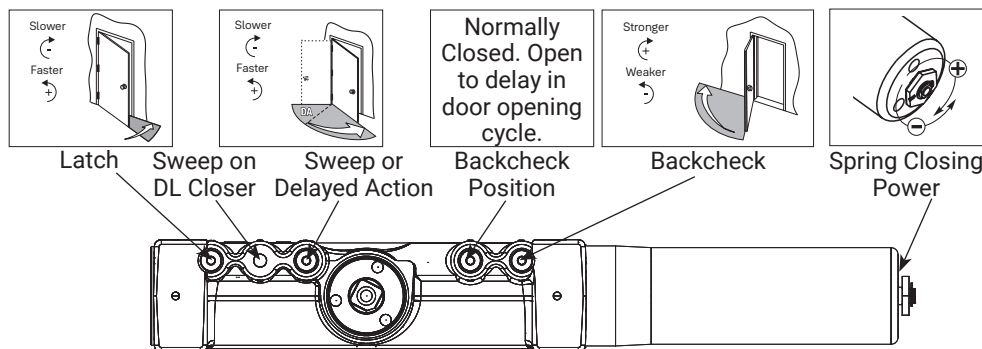

Use provided hex wrench to turn valves.
NEVER force valves out of closer.
NEVER completely close backcheck valve.

Door must be open to adjust spring closing power.
Do not use a power drill. Warranty will be void.

Figure 4