

6130(F) Series

Exit Devices

Installation Instructions

ACCENTRA

ASSA ABLOY

Double Cylinder Latchhead Assembly

1. Install the Mortise Lock and Outside Trim onto the door using the supplied instructions.
2. Using a slotted screwdriver in the slot of the Mortise Double Cylinder Adapter, thread clockwise into the Mortise Lock until the Mortise Double Cylinder Adapter hits the bottom of the opposing lock.
3. Un-thread the Mortise Double Cylinder Adapter counter clockwise one (1) full turn and orient as shown in **Figure 1**.
4. Tighten the Cylinder Locking Screw through the Mortise Lock Front.
5. Mount the Exit Device using the supplied instructions.
6. Assemble the Cylinder, Cylinder Collar and Cylinder Housing to the Exit Device Cover as shown in **Figure 1**. Rotate the Cylinder Housing until it's mounting holes align with the mounting holes for the Cylinder and install the two (2) Cylinder Housing Mounting Screws.
7. Install the Exit Device Cover onto the door over the Exit Device, being sure to align the Cylinder's tailpiece with the slot in the Mortise Double Cylinder Adapter. Align the holes of the Exit Device Cover and install the Device Cover Screws.
8. Test operation of both cylinders to be certain they function properly. Adjust as needed.

Figure 1: Exploded View of 6130(F)

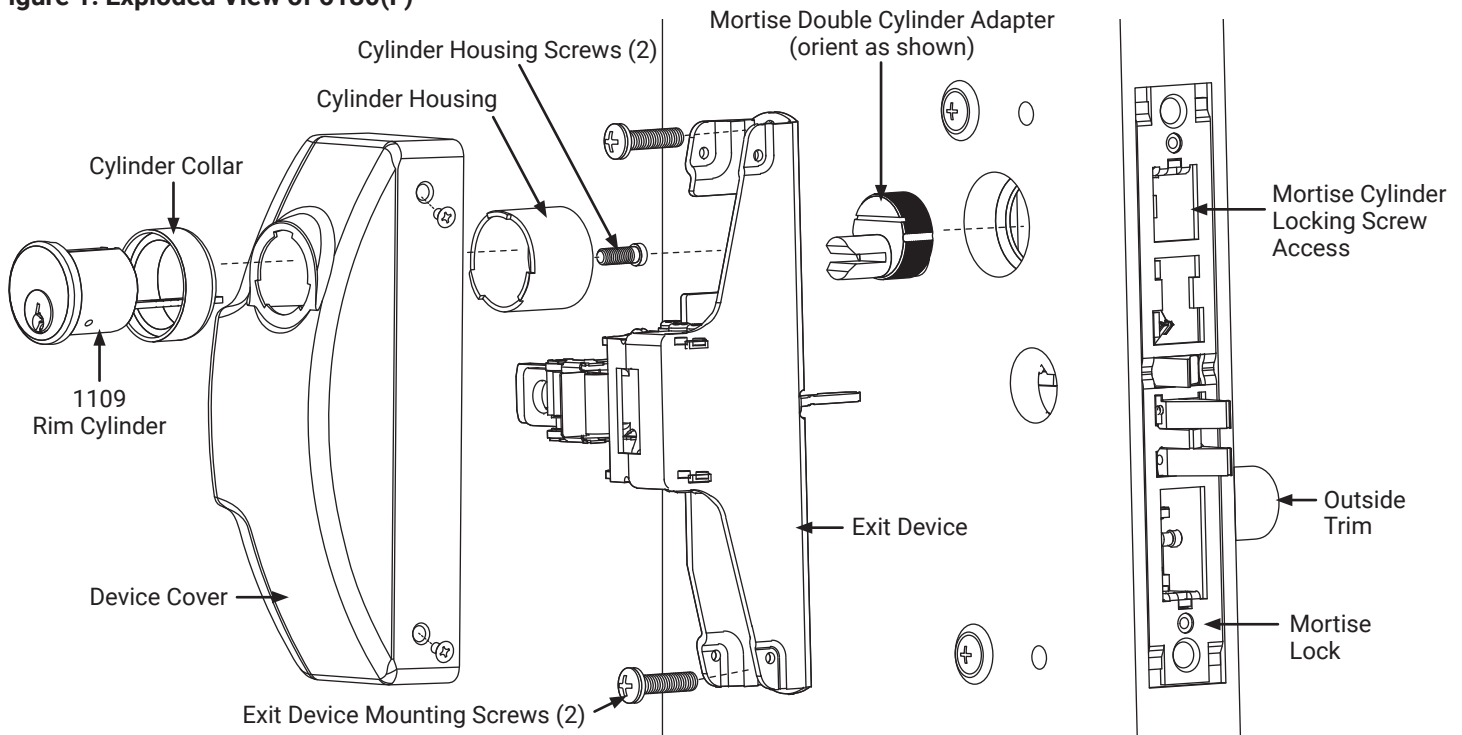

WARNING

This product can expose you to lead which is known to the state of California to cause cancer and birth defects or other reproductive harm. For more information go to www.P65warnings.ca.gov.

WARNING

Attention Installer: Any retrofit or other field modification to a fire rated opening can potentially impact the fire rating of the opening, and ASSA ABLOY makes no representations or warranties concerning what such impact may be in any specific situation. When retrofitting any portion of an existing fire-rated opening, or specifying and installing a new fire-rated opening, please consult with a code specialist or local code official (Authority Having Jurisdiction) to ensure compliance with all applicable codes and ratings.

80-9460-6015-000 07/24

1-855-557-5078 Ext. 2 • www.accentra-assaabloy.com

Copyright © 2015, 2023, 2024, ASSA ABLOY Access and Egress Hardware Group, Inc. All rights reserved. Reproduction in whole or in part without the express written permission of ASSA ABLOY Access and Egress Hardware Group, Inc. is prohibited.

Experience a safer
and more open world

