

Shim Kits

Exit Device

Installation Instructions

ACCENTRA

ASSA ABLOY

Shim Locations

- ① #724, 724WS, 724NS, and 224 Shim Kits for Surface Vertical Rod Exit Devices

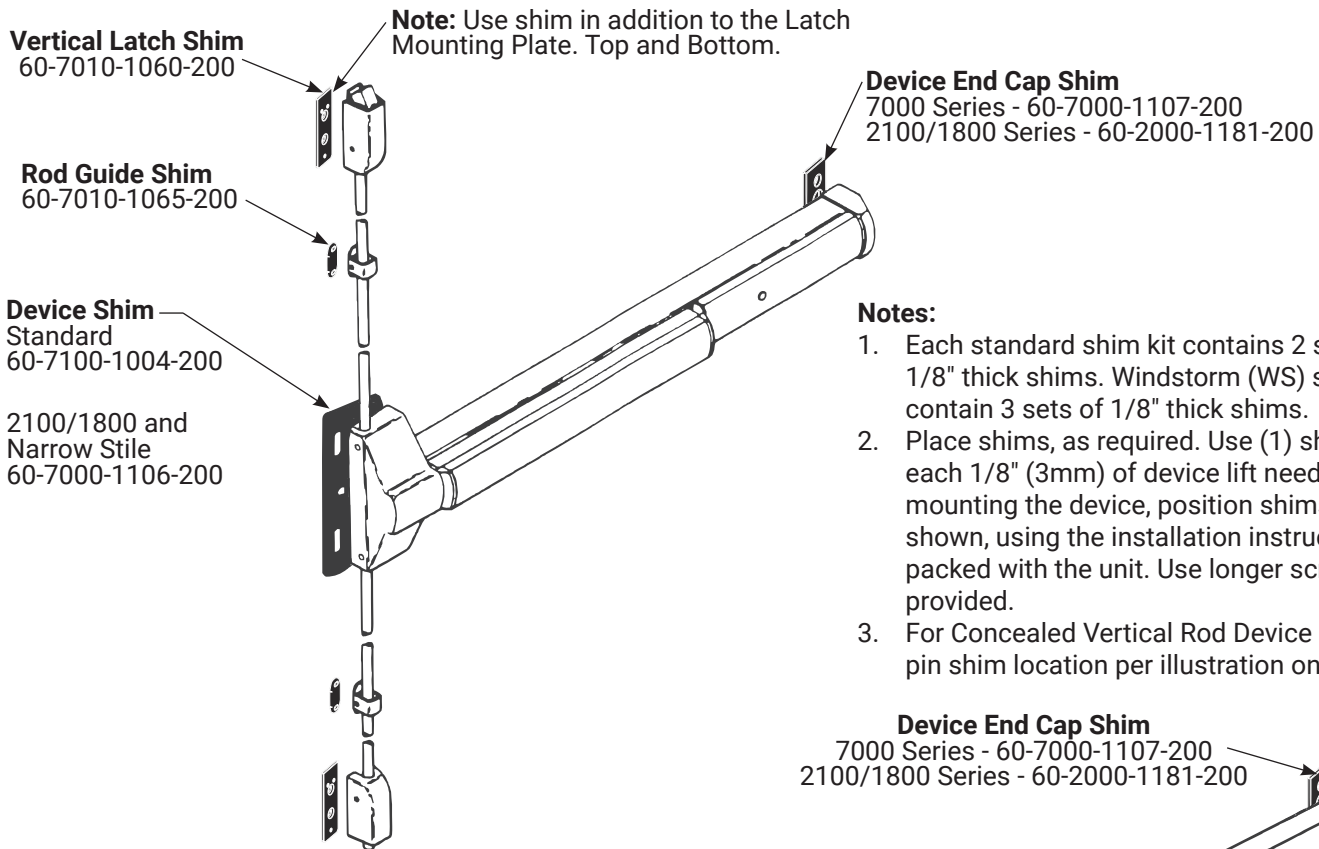

- ② #723, 723WS, 723NS, 723NSWS, and 223 Shim Kits for Rim, Mortise, and CVR Exit Devices

Device Shim
Standard
60-7100-1004-200

2100/1800 and
Narrow Stile
60-7000-1106-200

Device End Cap Shim
7000 Series - 60-7000-1107-200
2100/1800 Series - 60-2000-1181-200

⚠ WARNING

This product can expose you to lead which is known to the state of California to cause cancer and birth defects or other reproductive harm. For more information go to www.P65warnings.ca.gov.

⚠ WARNING

Attention Installer: Any retrofit or other field modification to a fire rated opening can potentially impact the fire rating of the opening, and ASSA ABLOY makes no representations or warranties concerning what such impact may be in any specific situation. When retrofitting any portion of an existing fire-rated opening, or specifying and installing a new fire-rated opening, please consult with a code specialist or local code official (Authority Having Jurisdiction) to ensure compliance with all applicable codes and ratings.

1-855-557-5078 Ext. 2 • www.accentra-assaabloy.com

Copyright © 2001, 2013, 2023, 2024, ASSA ABLOY ACCENTRA™ Access and Egress Hardware Group, Inc. All rights reserved.
Reproduction in whole or in part without the express written permission of ASSA ABLOY Access and Egress Hardware Group, Inc. is

80-9470-0724-000 04/24

Experience a safer
and more open world

Caution: Strike Location Will Vary

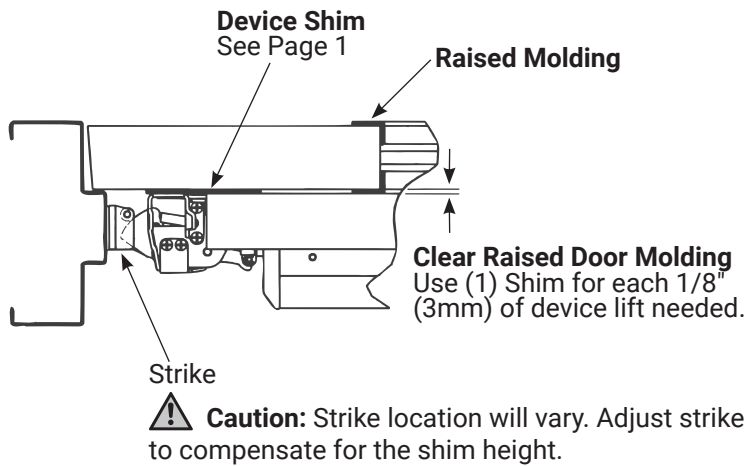

Yoke Pin Shim Location

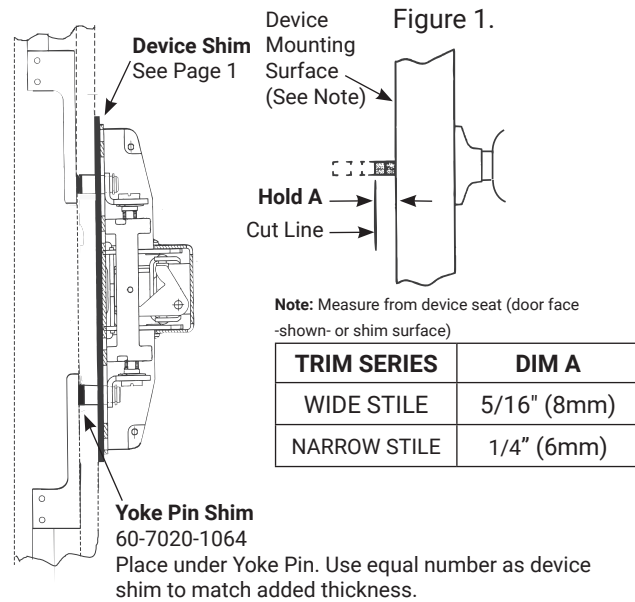

Spindle Assembly

For Night Latch Function
Replace Tailpiece as required (Longer Tailpiece and Retainer Ring provided) to maintain proper length See Figure 1, above.

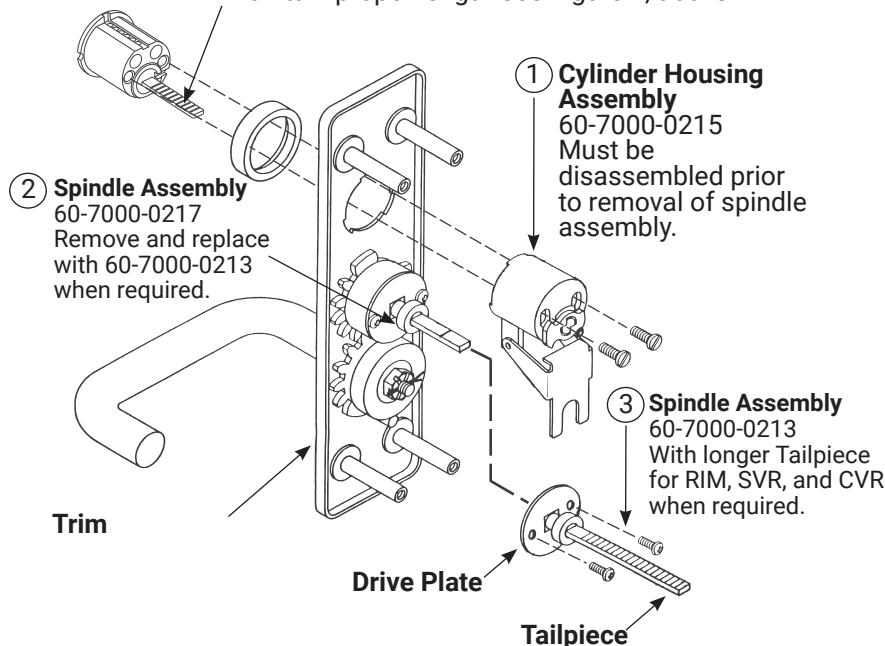

Caution: When removing the spindle assembly from the trim, keep the clutch spring and screws, they are needed for reassembly. When finished, check the lock and unlock function before mounting. Follow detail Figure 1 for sizing the tailpiece to the door

For Thumbpiece Applications:

Thumbpiece applications follow the same procedure as above, but the original smaller drive plate must be used with the new tailpiece included in the kit. To do this remove the cylinder housing assembly and the original spindle assembly from the trim (steps 1 & 2 to left). Remove the retaining ring from both spindle assemblies, switch the tailpieces and reassemble (longer tail-piece to the smaller drive plate) with a retaining ring. Reattach to trim using clutch spring and screws; then reassemble the cylinder housing with the cylinder.

540F or 440F Trim Applications:

For 540F or 440F Trim remove roll pin from Tailpiece assembly (keep pin), remove Tailpiece and replace with optional Tailpiece supplied. Use initial roll pin to reassemble. Size to fit, see Figure 1, above.

Strike

Caution: Strike location will vary. Adjust strike to compensate for the shim height.

Clear Raised Door Molding

Use (1) Shim for each 1/8" (3mm) of device lift needed.