

# 836A, 836B, 838A, & 838B

## Rigid Knob & Lever Handle Handle Dummy Trim

### Installation Instructions

**ACCENTRA**  
**ASSA ABLOY**

#### Sectional Trim

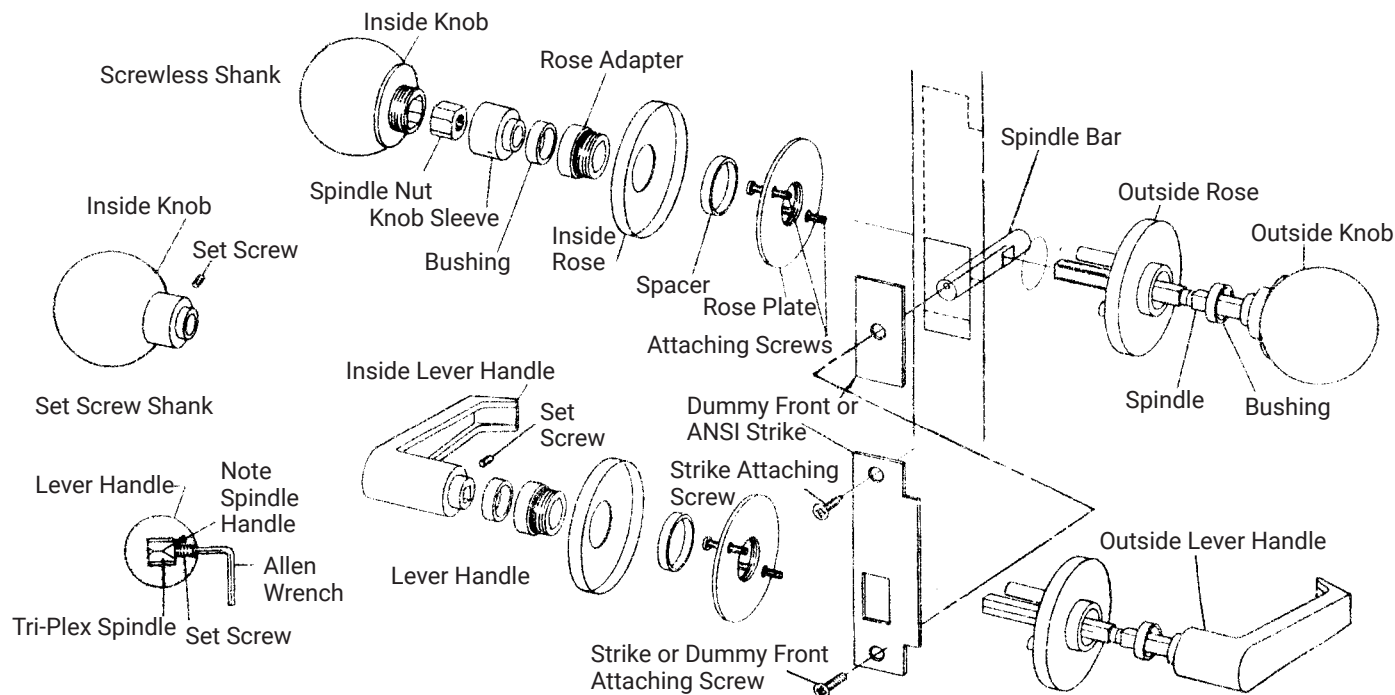

#### 1. Install Spindle Bar

Thread mounting screw into spindle bar several turns. While holding and manipulating bar with screw, insert spindle bar into edge of door. Screw must be upward.

#### 2. Install Roses

- Insert outside rose assembly posts into thru-bolt holes in door. Align inside rose plate with holes on inside surface of door. Insert connecting screws thru inside rose plate into the outside rose assembly posts. Tighten securely.
- Place inside rose over rose plate, screw rose adapter thru rose into rose plate. Use blade portion of Knob & Rose Wrench (see page 4). Insert bushings in both roses.

#### 3A. Install Knobs - Screwless Shank (when used)

- Disassemble knob assembly.
  - Unscrew knob sleeve and remove inside knob from spindle.
  - Unscrew spindle nut and remove sleeve
- Insert outside knob/spindle assembly thru outside rose, door, spindle bar, and inside rose.
- Slip knob sleeve on spindle, placing the boss end into the rose bushing. Screw spindle nut onto spindle. Tighten with wrench portion of Knob & Rose Wrench (see page 4). just enough to take the end play out of spindle.
- Slide the inside knob onto the spindle and over the spindle nut. Mate the knob to the sleeve. Turn the sleeve by hand to draw up knob. Tighten sleeve security with spanner portion of Knob & Rose Wrench (see page 4).

#### WARNING

This product can expose you to lead which is known to the state of California to cause cancer and birth defects or other reproductive harm. For more information go to [www.P65warnings.ca.gov](http://www.P65warnings.ca.gov).

#### WARNING

Attention Installer: Any retrofit or other field modification to a fire rated opening can potentially impact the fire rating of the opening, and ASSA ABLOY makes no representations or warranties concerning what such impact may be in any specific situation. When retrofitting any portion of an existing fire-rated opening, or specifying and installing a new fire-rated opening, please consult with a code specialist or local code official (Authority Having Jurisdiction) to ensure compliance with all applicable codes and ratings.

1-855-557-5078 Ext. 2 • [www.accentra-assaabloy.com](http://www.accentra-assaabloy.com)

80-9086-0005-010 05/24

## **Sectional Trim (continued)**

### **3B. Install Knobs - Set Screw Shank (when used)**

- a. Insert outside knob/spindle assembly thru outside rose, door spindle bar, and inside rose.
- b. Thread inside knob onto spindle and into thimble bushing enough to take the end play out of spindle. Tighten set screw securely with allen wrench.

### **3C. Install Lever handles (when used)**

- a. Insert outside lever handle/spindle assembly thru outside rose, door, spindle bar, and inside rose. Note the position of tri-plex spindle in relation to set screw.
- b. Slide inside lever handle onto spindle. With minimum end play of spindle, tighten set screw securely with allen wrench.

## **4. Install Strike or Dummy Front**

Remove screw from spindle bar and install strike or dummy front.

### Escutcheon Plate Trim (Thru-Bolted)

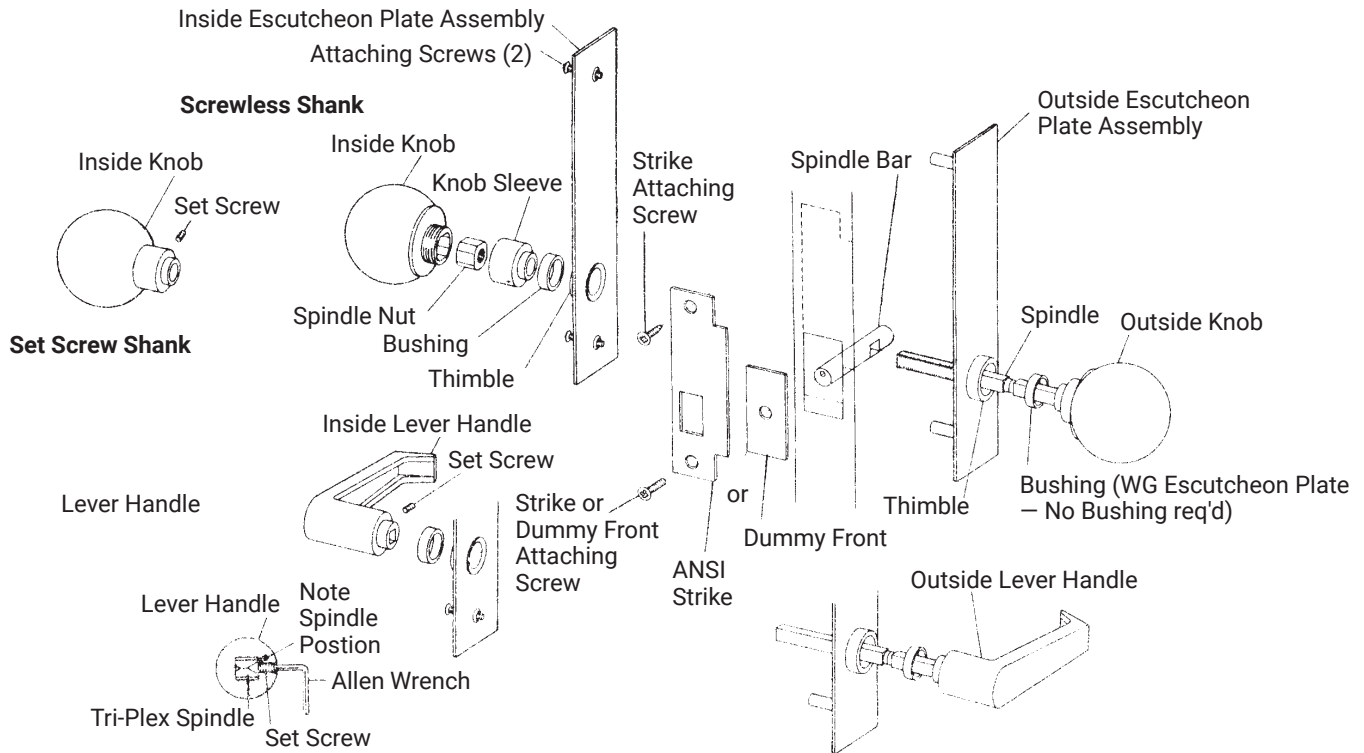

#### 1. Install Spindle Bar

Thread mounting screw into spindle bar several turns. While holding and manipulating bar with screw, insert spindle bar into edge of door. Screw must be upward.

#### 2. Install Escutcheon Plates

Insert outside escutcheon plate posts into thru-bolt holes in door. Align inside escutcheon plate with holes on inside surface of door. Insert two connecting screws thru inside escutcheon plate into the outside escutcheon plate into outside escutcheon plate posts. Tighten screws enough to allow a slight movement in the escutcheon plate. Insert bushings in both escutcheon thimbles.

#### 3A. Install Knobs - Screwless Shank (when used)

- Disassemble knob assembly.
  - Unscrew knob sleeve and remove inside knob from spindle.
  - Unscrew spindle nut and remove sleeve
- Insert outside knob/spindle assembly thru outside escutcheon plate, door, spindle bar, and inside plate.
- Slip knob sleeve on spindle, placing the boss end into the bushing. Screw spindle nut onto spindle. Tighten with wrench portion of Knob & Rose Wrench (see page 4). just enough to take the end play out of spindle.
- Slide the inside knob onto the spindle and over the spindle nut. Mate the knob to the sleeve. Turn the sleeve by hand to draw up knob. Tighten sleeve security with spanner portion of Knob & Rose Wrench (see page 4).

#### 3B. Install Knobs - Set Screw Shank (when used)

- Insert outside knob/spindle assembly thru outside escutcheon plate, door, spindle bar, and inside plate.
- Thread inside knob onto spindle and into thimble bushing enough to take the end play out of spindle. Tighten set screw securely with allen wrench.

#### 3C. Install Lever handles (when used)

- Insert outside lever handle/spindle assembly thru outside escutcheon plate, door spindle bar and inside escutcheon plate. Note the position of tri-plex spindle in relation to set screw.
- Slide inside lever handle onto spindle. With minimum end play of spindle, tighten set screw securely with allen wrench.

#### 4. Install Strike or Dummy Front

Remove screw from spindle bar and install strike or dummy front. Tighten escutcheon plate connecting screws securely.

### Escutcheon Plate Trim (Surface-Mounted)

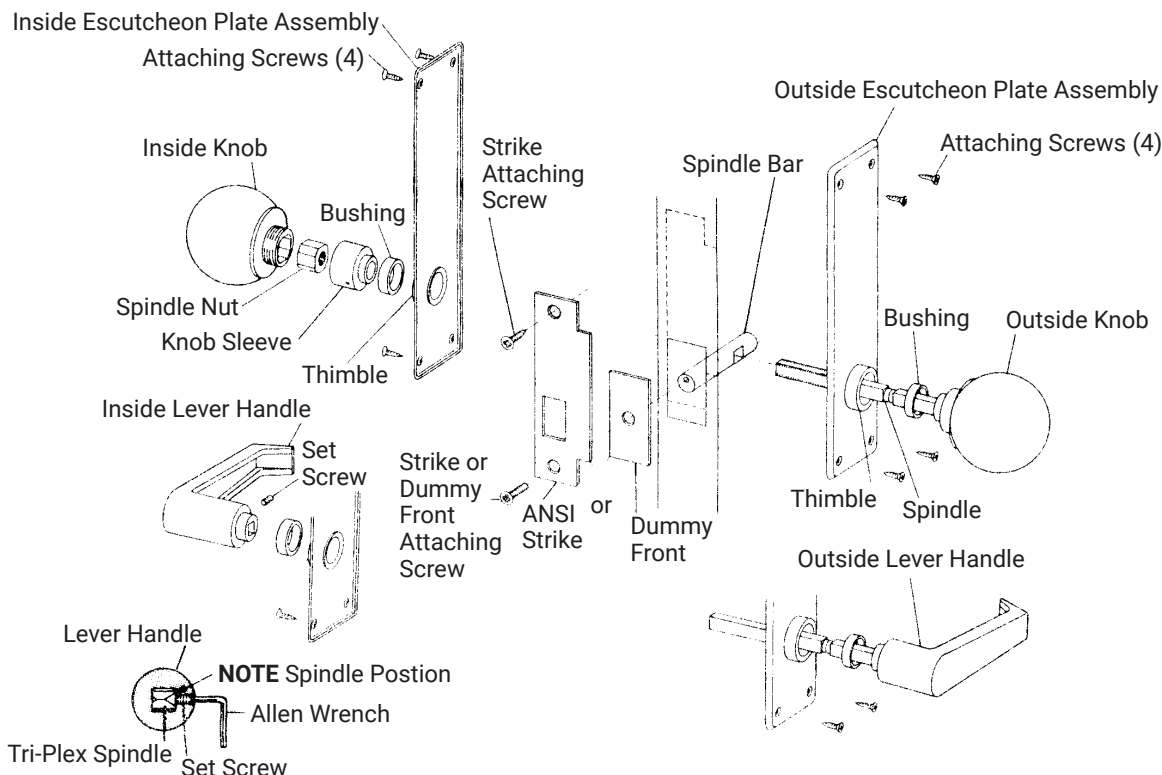

### 1. Install Spindle Bar

Thread mounting screw into spindle bar several turns. While holding and manipulating bar with screw, insert spindle bar into edge of door. Screw must be upward.

### 2. Install Escutcheon Plates

Align inside escutcheon plate with holes on inside surface of door. Insert bushings in both escutcheon thimbles.

### 3A. Install Knobs (when used)

- Disassemble knob assembly.
  - Unscrew knob sleeve and remove inside knob from spindle.
  - Unscrew spindle nut and remove sleeve
- Insert outside knob/spindle assembly thru outside escutcheon, plate, door, spindle bar, and inside plate.
- Slip knob sleeve on spindle, placing the boss end into the bushing. Screw spindle nut onto spindle. Tighten with wrench portion of Knob & Rose Wrench (see this page). just enough to take the end play out of spindle.
- Slide the inside knob onto the spindle and over the spindle nut. Mate the knob to the sleeve. Turn the sleeve by hand to draw up knob. Tighten sleeve security with spanner portion of Knob & Rose Wrench.

### 3B. Install Lever Handles (when used)

- Insert outside lever handle/spindle assembly thru outside escutcheon plate, spindle bar, and inside escutcheon plate. Note position of tri-plex spindle in relation to set screw.
- Slide inside lever handle onto spindle. With minimum end play of spindle, tighten set screw securely with allen wrench.

### 4. Install Strike or Dummy Front

Remove screw from spindle bar and install strike or dummy front.

**Knob & Rose Wrench**  
**No. S-1064**

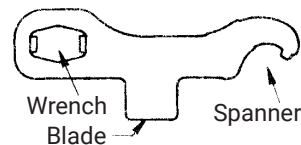

# 836A, 836B, 838A, & 838B

## Rigid Knob & Lever Handle Handle Dummy Trim Installation Instructions

ACCENTRA

ASSA ABLOY

### Single Dummy Trim (Sectional & Escutcheon)

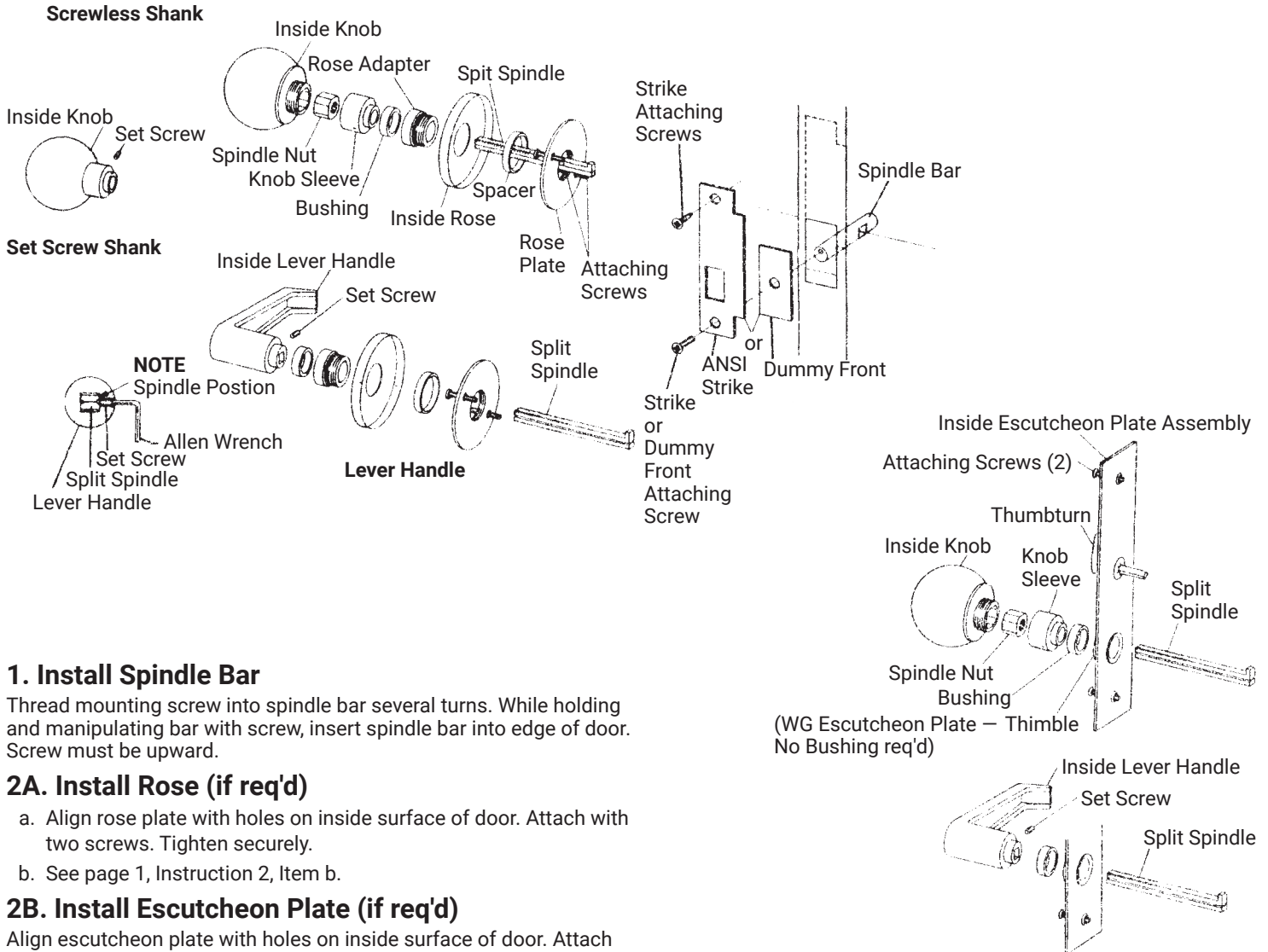

#### 1. Install Spindle Bar

Thread mounting screw into spindle bar several turns. While holding and manipulating bar with screw, insert spindle bar into edge of door. Screw must be upward.

#### 2A. Install Rose (if req'd)

- Align rose plate with holes on inside surface of door. Attach with two screws. Tighten securely.
- See page 1, Instruction 2, Item b.

#### 2B. Install Escutcheon Plate (if req'd)

Align escutcheon plate with holes on inside surface of door. Attach with two screws. Tighten securely.

#### 3A. Install Knob - Screwless Shank (when used)

- Disassemble knob assembly.
  - Unscrew knob sleeve and remove inside knob from spindle.
  - Unscrew spindle nut and remove sleeve from spindle.
  - Remove pin holding spindle halves together.
- Insert hooked half of spindle with hook end up into rose, door, and spindle bar. Insert straight half of spindle under the hooked half. Line up the holes in the spindle and replace pin into the spindle.  
**NOTE:** Threaded portion of halves must be on outside corners of spindle.
- See page 1, Instruction 3A, Items c and b.

#### 3C. Install Lever Handle (when used)

- Remove pin holding spindle halves together. Insert hooked half of spindle with hook end going into door and spindle bar. Note the position of hook end portion is to be perpendicular to set screw in lever handle. Insert straight half of spindle under the hooked half. Line up the holes in the spindle and replace pin into spindle.  
**NOTE:** Threaded portion of halves must be on outside corners of spindle.
- See page 1, Instruction 3C, Item b

#### 4. Install Strike or Dummy Front

Remove screw from spindle bar and install strike or dummy front.



# 836A, 836B, 838A, & 838B

## Rigid Knob & Lever Handle Handle Dummy Trim Installation Instructions

**ACCENTRA**

---

**ASSA ABLOY**

