

Technical drawing of a door lock assembly. The drawing shows a cross-section of the lock mechanism mounted on a door. Key dimensions and labels include:

- Top Label:** Φ Rods & Strikes
- Vertical Dimensions:**
 - Overall height: $1 \frac{1}{8}$ (25)
 - Distance from top of door to lock body: $\frac{7}{8}$ (22)
- Horizontal Dimensions:**
 - Distance between the centers of the two side bolts: $2 \frac{5}{32}$ (20)
 - Distance from the center of the side bolts to the center of the main bolt: $\frac{9}{16}$ (14.3) (Typ.)
 - Overall width: $1 \frac{9}{16}$ (40)
- Labels:**
 - 10-24 Tap (See Note 7)
 - 10-24 Tap (2 Places)
 - Inside Face of Door

1. Do not scale drawing.
2. Dimensions are in inches (mm).
3. LHR door shown. Preparation is typical for both door hands.
4. Minimum door stile width 4-1/2(114).
5. Prepare mounting holes when installing the device.
6. Unreinforced frames require blind rivet nuts (by others) to mount the strike.
7. This hole **MUST** be field located using physical part as template, after installation is complete and device is fully operational.
8. For recommended door reinforcements see template 7400-0000. Unreinforced doors require SNB option to mount the device components.
9. Holes for optional SNB: 9/32 (7.00) dia. inside door face; 3/8 (9.50) dia. outside door face.
10. Provide door stiffeners, as needed to prevent door collapse due to installation with power tools, door use, or abuse.
11. Device mount to hinge stile (not shown) requires hole location and preparation during device installation.
12. For outside trim preparation see appropriate trim template.
13. For electrical devices (suffixes "-B", "-G", "-O", "-P", "-S", MELR) also see template 7477-0001.

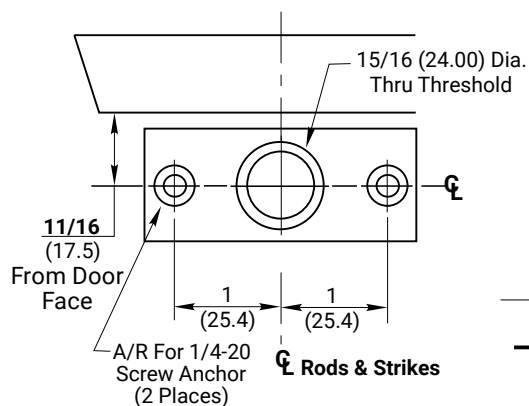

Side View Labels:

- Reinforcement for 791 Strike (See Note 6)
- Lock Edge
- See Note 10
- Inside Face of Door
- Inside Face of Door
- Vertical Reference
- Rods & Strikes
- Horizontal Reference (Device Centerline)
- Bottom of Door
- Finished Floor

Dimensions (Side View):

- 2-3/4 (70)
- 2-1/4 (57)
- 1-5/16 (33.3)
- 16-3/8 (416)
- 1-1/4 (31.8)
- 3-5/8 (92)
- 3-5/8 (92)
- 39-15/16 (1014)
- 1-1/4 (31.8)
- 15 (381)
- 1-5/16 (33.3)
- 1-3/8 (35)
- 1/2 (13)
- 11/16 (17.5)

End View Labels:

- Tap (See Note 9)
- h door hands.
- vice.
- others) to
- part as
- vice is fully
- emplate
- otion to mount
- door face; 3/8
- door collapse
- or abuse.
- es hole
- tion.
- m template.
- P", "S", MELR)
- Dia.
- old

Dimensions (End View):

- 11/16 (17.5)
- 11/16 (17.5)
- 140 (3.50) Dia. This Face (4 Places)
- 1/4-20 Tap (Std.) Or See Note 9 (SNB) -6 Places-

Ⓒ Rods, Deadbolt and Bottom Strike

05/25