

CUT  
SHEET

**PEM KO**  
**ASSA ABLOY**

## PEMKOHINGE® CONTINUOUS GEARED HINGES:

Half Surface: Offset, 3" Bearing Space,  
Continuous Geared HD Hinge

Experience a safer  
and more open world

OS\_HS



LISTED  
DOOR HINGE  
76Y2



AVAILABLE FINISHES:

**C, D, G, SN, BSP, WSP, 10BE**

CLEARANCE: **0 to 1/8"**  
**(0 mm to 3.2 mm)**

WIDTH: **2 7/8" (73 mm)**

CAP WIDTH: **25/32" (19.8 mm)**

HEIGHT: **1 29/32" (48.4 mm)**  
(to flange/frame edge side)

HEIGHT: **29/32" (23 mm)**  
(to top cap/frame edge side)

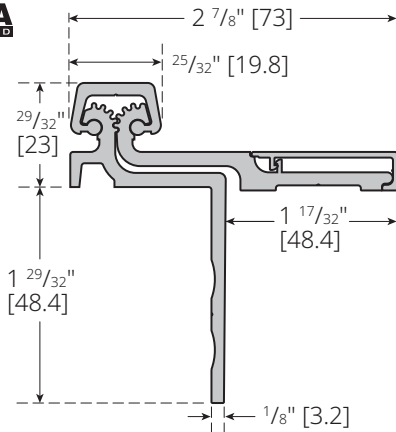

**C** (Clear Anodized)

**G** (Gold Powder Coat)

**BSP** (Black Suede Powder Coat)

**WSP** (White Suede Powder Coat)

**D** (Dark Bronze Anodized)

**SN** (Satin Nickel Powder Coat)

**10BE** (Satin Bronze Powder Coat)

TITLE:

PREPARED FOR:

PREPARED BY:

DATE:

COMMENTS: