

# 10X Line Cylindrical Lever Lock Parts Manual

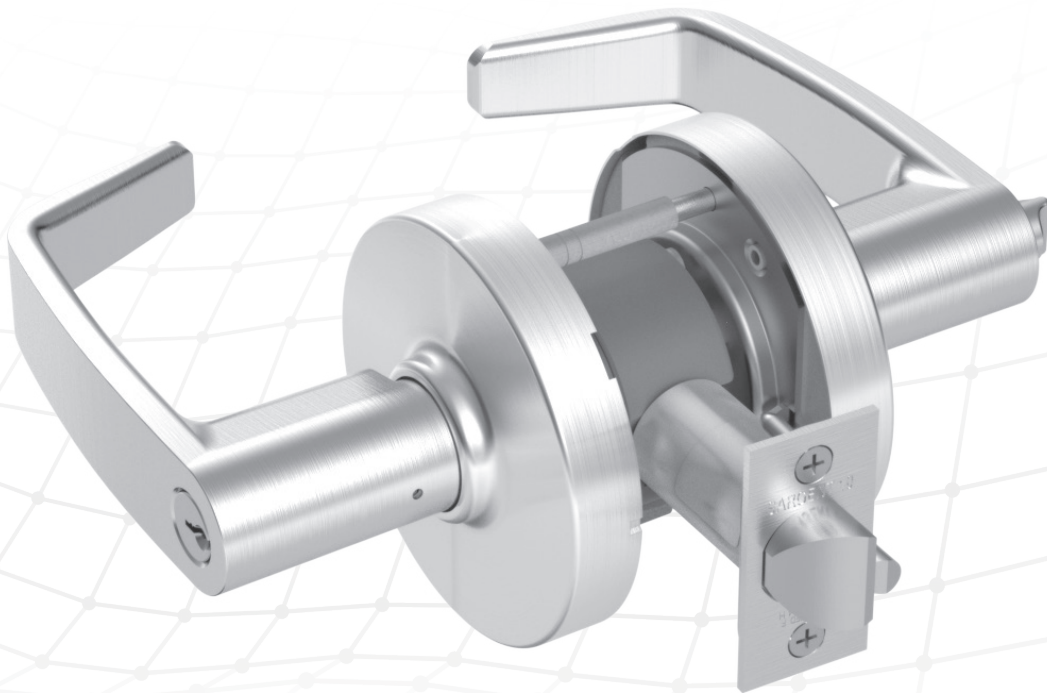

For assistance, contact SARGENT at  
800-727-5477 or [www.sargentlock.com](http://www.sargentlock.com)

Experience a safer  
and more open world

**⚠ WARNING**

This product can expose you to lead which is known to the state of California to cause cancer and birth defects or other reproductive harm. For more information go to [www.P65warnings.ca.gov](http://www.P65warnings.ca.gov).

# TABLE OF CONTENTS

## 10X LINE CYLINDRICAL LEVER LOCKS

**SARGENT®**

**ASSA ABLOY**

<a href="#">Exploded View</a> .....	3
<a href="#">Lockbodies &amp; Mounting Plate</a> .....	4
<a href="#">Spring Housing Assemblies</a> .....	6
<a href="#">Roses &amp; Misc</a> .....	7
<a href="#">Latches</a> .....	8
<a href="#">Strikes</a> .....	9
<a href="#">Cylinders</a> .....	10-12
<a href="#">Standard Levers</a> .....	14
<a href="#">Indicator Lever Assemblies</a> .....	15-16
<a href="#">How to Order Parts</a> .....	17
<a href="#">Finishes</a> .....	17

A8287 02/26

The warranty on SARGENT® products becomes void if the product is modified in any way, regardless of whether the modification causes or contributes to any alleged defect. If a SARGENT product is modified it may no longer meet industry certification and quality control standards applicable to the original product and is no longer a genuine SARGENT product.

Copyright © 2021-2026 Sargent Manufacturing Company, an ASSA ABLOY Group company. All rights reserved. Reproduction in whole or in part without the express written permission of Sargent Manufacturing Company is prohibited.

Experience a safer  
and more open world

**EXPLODED VIEW**  
**10X LINE CYLINDRICAL LEVER LOCKS**

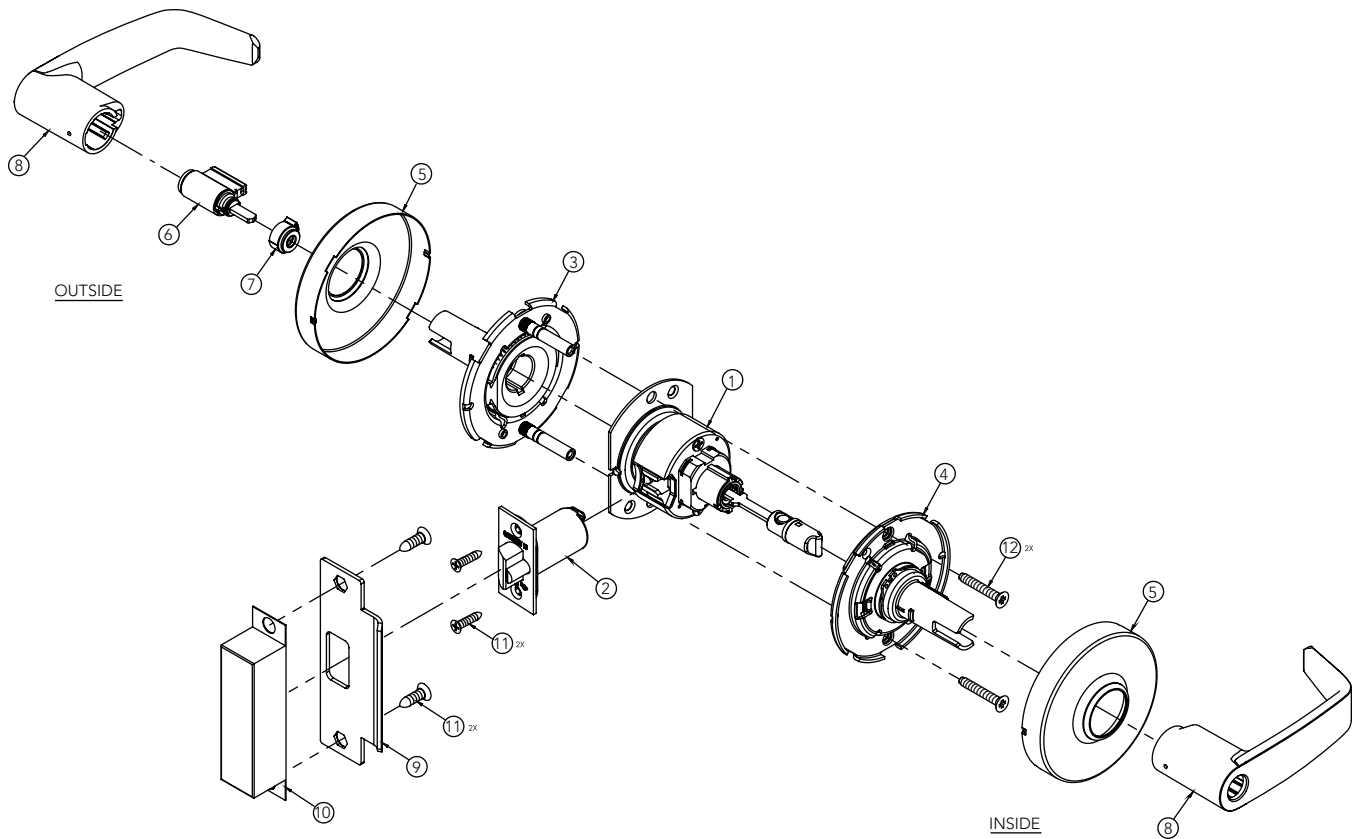

Item	Description	Page #
1	Lockbody with Mounting Plate	4
2	Latch	8
3	Spring Housing Assembly, Outside	6
4	Spring Housing Assembly, Inside	6
5	Rose	7
6	Cylinder	10
7	Cylinder Spacer	13
8	Lever	14
9	Strike	9
10	Strike Box	9
11	Latch & Strike Screws	7
12	Throughbolt Screws	7

Experience a safer  
 and more open world

The warranty on SARGENT® products becomes void if the product is modified in any way, regardless of whether the modification causes or contributes to any alleged defect. If a SARGENT product is modified it may no longer meet industry certification and quality control standards applicable to the original product and is no longer a genuine SARGENT product.

Copyright © 2021-2026 Sargent Manufacturing Company, an ASSA ABLOY Group company. All rights reserved. Reproduction in whole or in part without the express written permission of Sargent Manufacturing Company is prohibited.

# LOCKBODIES

## 10X LINE CYLINDRICAL LEVER LOCKS

# SARGENT®

# ASSA ABLOY

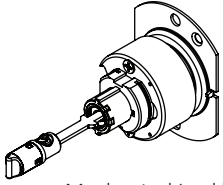

Mechanical Lockbody  
1-3/8" - 2" Door

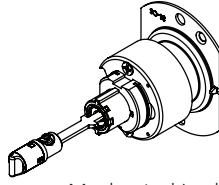

Mechanical Lockbody  
2-1/4" Door

### Mechanical Lockbody (Includes Mounting Plate)

Description	Function	Part Number 1-3/8" - 2" Door		Part Number 2-1/4" Door	
		Std/Rigid Lever	Freewheeling	Std/Rigid Lever	Freewheeling
Storeroom or Closet	10XG04	10-3586	10-3587	10-3668	10-3669
Entrance or Office	10XG05	10-3588*	10-3589*	10-3670*	10-3671*
Communicating Storeroom	10XG07	10-3590	10-3591	10-3672	10-3673
Communicating Classroom	10XG08	10-3592	10-3593	10-3674	10-3675
Exit	10XG13	10-3586	10-3587	10-3668	10-3669
Patio or Privacy	10XG14	10-3618*	10-3619*	10-3702*	10-3703*
Passage	10XU15	10-3596	N/A	10-3678	N/A
Exit or Communicating	10XG15-3	10-3597	N/A	10-3679	N/A
Classroom Security, Apartment, Exit, Privacy	10XG16	10-3598	10-3599	10-3680	10-3681
Utility, Asylum or Institutional	10XG17	10-3600	10-3601	10-3682	10-3683
Entrance or Office	10XG24	10-3594*	10-3595*	10-3676*	10-3677*
Store or Storeroom	10XG26	10-3602	10-3603	10-3684	10-3685
Communicating	10XG30	10-3604	10-3605	10-3686	10-3687
Classroom	10XG37	10-3710	10-3711	10-3712	10-3713
Classroom Security Intruder	10XG38	10-3606	10-3607	10-3688	10-3689
Service Station	10XG44	10-3608*	10-3609*	10-3690*	10-3691*
Hotel, Dormitory or Apartment	10XG50	10-3610*	10-3611*	10-3692*	10-3693*
Corridor/Dormitory (modified)	10XG53	10-3612*	10-3613*	10-3694*	10-3695*
Corridor/Dormitory	10XG54	10-3614*	10-3615*	10-3696*	10-3697*
Barrier Free Storeroom/Public Restroom	10XG60	10-3620	10-3621	10-3698	10-3699
Time Out Lock	10XG64	10-3616*	10-3617*	10-3700*	10-3701*
Privacy/Bathroom	10XU65	10-3618*	10-3619*	10-3702*	10-3703*
Privacy/Bathroom	10XU66	10-3618*	10-3619*	10-3702*	10-3703*
Hospital Privacy	10XU68	10-3618*	10-3619*	10-3702*	10-3703*
Storeroom or Closet with Request to Exit	RX-10XG04	10-2934	10-2935	10-2942	10-2943
Entrance or Office with Request to Exit	RX-10XG05	10-2936*	10-2937*	10-2944*	10-2945*
Passage with Request to Exit	RX-10XU15	10-2938	10-2939	10-2946	10-2947
Classroom with Request to Exit	RX-10XG37	10-2940	10-2941	10-2948	10-2949

\*Includes finished button. Specify Finish.

### Mechanical Lockbody with Red Push Button (Includes Mounting Plate)

Description	Function	Part Number 1-3/8" - 2" Door		Part Number 2-1/4" Door	
		Std/Rigid Lever	Freewheeling	Std/Rigid Lever	Freewheeling
Entrance or Office	10XG05	10-3588	10-3589	10-3670	10-3671
Patio or Privacy	10XG14	10-3618	10-3619	10-3702	10-3703
Entrance or Office	10XG24	10-3594	10-3595	10-3676	10-3677
Service Station	10XG44	10-3608	10-3609	10-3690	10-3691
Hotel, Dormitory or Apartment	10XG50	10-3610	10-3611	10-3692	10-3693
Corridor/Dormitory (modified)	10XG53	10-3612	10-3613	10-3694	10-3695
Corridor/Dormitory	10XG54	10-3614	10-3615	10-3696	10-3697
Privacy/Bathroom	10XU65	10-3618	10-3619	10-3702	10-3703
Privacy/Bathroom	10XU66	10-3618	10-3619	10-3702	10-3703
Hospital Privacy	10XU68	10-3618	10-3619	10-3702	10-3703

The warranty on SARGENT® products becomes void if the product is modified in any way, regardless of whether the modification causes or contributes to any alleged defect. If a SARGENT product is modified it may no longer meet industry certification and quality control standards applicable to the original product and is no longer a genuine SARGENT product.

Copyright © 2021-2026 Sargent Manufacturing Company, an ASSA ABLOY Group company. All rights reserved. Reproduction in whole or in part without the express written permission of Sargent Manufacturing Company is prohibited.

A8287 02/26

**LOCKBODIES (Continued)**  
**10X LINE CYLINDRICAL LEVER LOCKS**

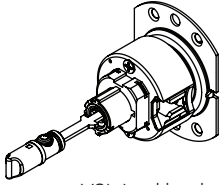

VSL Lockbody  
1-3/8" - 2" Door

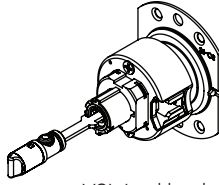

VSL Lockbody  
2-1/4" Door

**Mechanical Lockbody for VSL Indicator Trim (Includes Mounting Plate)\***

Description	Function	Part Number 1-3/8" - 2" Door		Part Number 2-1/4" Door	
		Std/Rigid Lever	Freewheeling	Std/Rigid Lever	Freewheeling
Storeroom or Closet	10XG04	10-2976	10-2977	10-3807	10-3808
Entrance or Office	10XG05	10-2978*	10-2979*	10-3809*	10-3810*
Patio or Privacy	10XG14	10-2986*	10-2987*	10-3817*	10-3818*
Entrance or Office	10XG24	10-2980*	10-2981*	10-3811*	10-3812*
Classroom	10XG37	10-3921	10-3922	10-3923	10-3924
Classroom Security Intruder	10XG38	10-3925	10-3926	10-3927	10-3828
Service Station	10XG44	10-2982*	10-2983*	10-3813*	10-3814*
Keyed Privacy Indicator	10XG51	N/A	10-3962*	N/A	10-3964*
Corridor/Dormitory	10XG53	10-3929*	10-3930*	10-3931*	10-3932*
Corridor/Dormitory	10XG54	10-2984*	10-2985*	10-3815*	10-3816*
Privacy/Bathroom	10XU65	10-2986*	10-2987*	10-3817*	10-3818*
Privacy/Bathroom	10XU66	10-2986*	10-2987*	10-3817*	10-3818*
Hospital Privacy	10XU68	10-2986*	10-2987*	10-3817*	10-3818*

\*Includes finished button, specify finish.

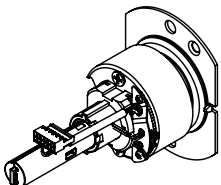

Electrified Lockbody  
1-3/8" - 2" Door

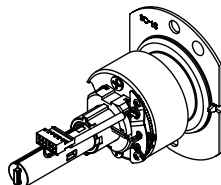

Electrified Lockbody  
2-1/4" Door

**Electrified Lockbody (Includes Mounting Plate) and Lock Harness**

Description	Function	Part Number 1-3/8" - 2" Door		Part Number 2-1/4" Door	
		Std/Rigid Lever	Freewheeling	Std/Rigid Lever	Freewheeling
Electromechanical	10XG70 10XG71	10-3722	10-3763	10-3795	10-3797
Electromechanical with Request to Exit	RX-10XG70 RX-10XG71	10-3723	10-3764	10-3796	10-3798

Experience a safer  
and more open world

The warranty on SARGENT® products becomes void if the product is modified in any way, regardless of whether the modification causes or contributes to any alleged defect. If a SARGENT product is modified it may no longer meet industry certification and quality control standards applicable to the original product and is no longer a genuine SARGENT product.

Copyright © 2021-2026 Sargent Manufacturing Company, an ASSA ABLOY Group company. All rights reserved. Reproduction in whole or in part without the express written permission of Sargent Manufacturing Company is prohibited.

**SPRING HOUSING ASSEMBLIES**  
**10X LINE CYLINDRICAL LEVER LOCKS**

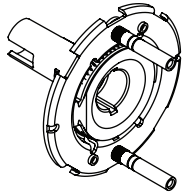

Part No. 10-3858  
 Spring Housing Assembly, Outside

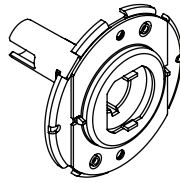

Part No. 10-3859  
 Spring Housing Assembly, Inside

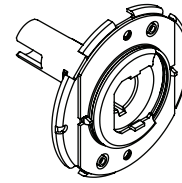

Part No. 10-3870  
 Spring Housing Assembly, Inside

**Outside Spring Housing Assemblies**  
**(1-3/8" to 2-1/4" Door)**

Part Number	Description
10-3858	All Functions except 07, 08, 15-3, 93, 94, VSL Trim
10-3862	All Functions for Keso Cylinders except with VSL Trim
10-3865	All Functions for ASSA ABLOY ACCENTRA® 6-or 7-Pin LFIC or Medeco 32 Series 6-Pin LFIC* except with VSL Trim
10-3861	All Functions with VSL Trim
10-3864	All Functions with VSL Trim for Keso Cylinders
10-3867	All Functions with VSL Trim for ASSA ABLOY ACCENTRA® 6-or 7-Pin LFIC or Medeco 32 Series 6-Pin LFIC*

**Inside Spring Housing Assemblies**  
**(2-1/4" Door)**

Part Number	Description
10-3871	Functions 04, 05, 13, 14,15, 15-3, 24, 37, 44, 50, 53, 54, 60, 64, 65, 68
10-3872	Functions 16, 17, 26, 30, 38
10-3873	Functions 16, 17, 26, 30, 38 for Keso Cylinders
10-3866	Functions 16, 17, 26, 30, 38 for ASSA ABLOY ACCENTRA® 6-or 7-Pin LFIC or Medeco 32 Series 6-Pin LFIC*
10-3875	Functions 70, 71, RX-04, RX-05, RX-15, RX-37
10-3871	All Functions with VSL Trim Except 38
10-3936	38 Function with VSL Trim
10-3937	38 Function with VSL Trim, Keso Cylinders
10-3938	38 Function with VSL Trim, ASSA ABLOY ACCENTRA® 6-Pin LFIC or Medeco 32 Series 6-Pin LFIC**

**Inside Spring Housing Assemblies**  
**(1-3/8" to 2" Door)**

Part Number	Description
10-3859	Functions 04, 05, 13, 14,15, 15-3, 24, 37, 44, 50, 53, 54, 60, 64, 65, 68
10-3860	Functions 16, 17, 26, 30, 38
10-3863	Functions 16, 17, 26, 30, 38 for Keso Cylinders
10-3866	Functions 16, 17, 26, 30, 38 for ASSA ABLOY ACCENTRA® 6-or 7-Pin LFIC or Medeco 32 Series 6-Pin LFIC*
10-3870	Functions 70, 71, RX-04, RX-05, RX-15, RX-37
10-3859	All Functions with VSL Trim except 38
10-3933	38 Function with VSL Trim
10-3934	38 Function with VSL Trim, Keso Cylinders
10-3935	38 Function with VSL Trim, ASSA ABLOY ACCENTRA® 6-Pin LFIC or Medeco 32 6 Pin Series LFIC**

**Dummy Spring Housing Assemblies**

Part Number	Description
10-3868	Outside 93, 94, 94-2
10-3869	Inside 94, 94-2

\*Spring housings shipped prior to April 1, 2026, will not accept ASSA ABLOY ACCENTRA® 7-pin LFIC  
 \*\*38 Function with VSL Trim is not available with 7-pin ASSA ABLOY ACCENTRA® LFIC

A8287 02/26

The warranty on SARGENT® products becomes void if the product is modified in any way, regardless of whether the modification causes or contributes to any alleged defect. If a SARGENT product is modified it may no longer meet industry certification and quality control standards applicable to the original product and is no longer a genuine SARGENT product.

Copyright © 2021-2026 Sargent Manufacturing Company, an ASSA ABLOY Group company. All rights reserved. Reproduction in whole or in part without the express written permission of Sargent Manufacturing Company is prohibited.

**ROSES & MISC.**  
**10X LINE CYLINDRICAL LEVER LOCKS**



**Roses**

Part Number	Description	Function
10-1202*	G Rose/Scalp	All
10-1203*	G Rose/Scalp	Inside 16, 38
10-1200*	L Rose/Scalp	All
10-1201*	L Rose/Scalp	Inside 16, 38
10-1260*	Blank Rose/Plate	07, 08, 15-3
10-1387*	Rose/Scalp (for use with VSL trim only)	All

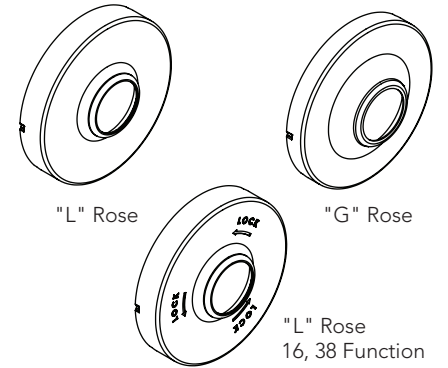

**Mounting Plates**

Part Number	Description
10-1071	Outside Support/Mounting Plate 1-3/8" - 2" Door
10-1276	Outside Support/Mounting Plate 2-1/4" Door
10-3656	Outside Mounting Plate Assembly Functions 15-3, 07, 08

**Screw Packs - Complete**

Part No.	Description
10-1224*	Standard (with 808 ANSI 4-7/8" strike screws)
10-1225*	93 Function
10-1250*	29- Option (with 800 T-strike screws)
10-1226*	36- Option, 6-Lobe Security Head Torx® (with ANSI & T-strike screws)
10-1227*	37- Option, Spanner Head (with ANSI & T-strike screws)
10-3761*	BHW Trim, 6-Lobe Security Head Torx® (with mounting, latch and strike screws)

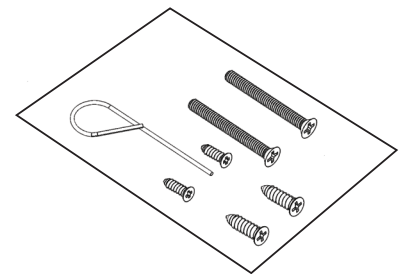

**Miscellaneous**

Part No.	Description
10-3188	1-3/8" Door Adapter Plate Pack (1- option)
10-3667*	Dummy/Blank Front Pack (94-2)
10-0043	Push Pin Tool
10-1587	Emergency Release Key - Privacy/Bathroom Function (66)
10-1504	Plastic door prep tool (through-bolts at 12 & 6 o'clock with 2-3/4" center to center)
14-0057	Emergency Release Key - Privacy/Bathroom Function (65)

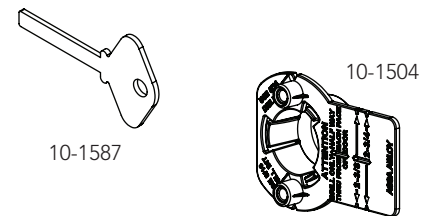

**Miscellaneous (for VSL Trim only)**

Part No.	Description
10-2967	Button Arm Assembly , All Functions with Inside Indicator Except 38
10-1285	Shank Insert 1-3/8" - 1-3/4" Door, All Functions Except 38
10-1286	Shank Insert 2" Door, All Functions Except 38
10-1474	Shank Insert 2-1/4" Door, All Functions Except 38
01-1745	Outside Mounting Plate Screw #8-32 x 3/8" PFHUTS

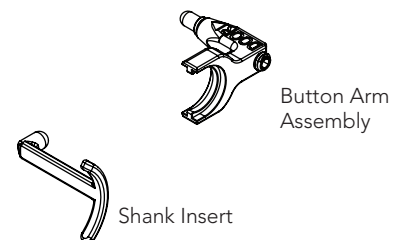

\* Specify Finish

Experience a safer  
and more open world

The warranty on SARGENT® products becomes void if the product is modified in any way, regardless of whether the modification causes or contributes to any alleged defect. If a SARGENT product is modified it may no longer meet industry certification and quality control standards applicable to the original product and is no longer a genuine SARGENT product.

Copyright © 2021-2026 Sargent Manufacturing Company, an ASSA ABLOY Group company. All rights reserved. Reproduction in whole or in part without the express written permission of Sargent Manufacturing Company is prohibited.

# LATCHES

## 10X LINE CYLINDRICAL LEVER LOCKS

**SARGENT®**

**ASSA ABLOY**

### Plain/Unguarded Latch - 10XU15, 10XU65, 10XU68:

Part No.	Front	Front Width	Backset	Throw
10-3187	Square Corner	1" (25mm)	2-3/8" (60mm)	1/2" (13mm)
10-2022	Square Corner	1-1/8" (29mm)	2-3/4" (70mm)	1/2" (13mm)
10-2054	Square Corner	1-1/8" (29mm)	3-3/4" (95mm)	1/2" (13mm)
10-2057	Square Corner	1-1/8" (29mm)	5" (127mm)	1/2" (13mm)

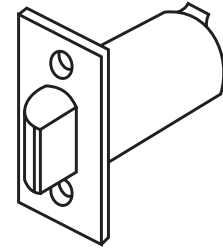

Plain/Unguarded

### Deadlocking/Guarded Latch - All Other Mechanical Functions:

Part No.	Front	Front Width	Backset	Throw
10-3186	Square Corner	1" (25mm)	2-3/8" (60mm)	1/2" (13mm)
10-3192	Square Corner	1-1/8" (29mm)	2-3/4" (70mm)	1/2" (13mm)
10-2053	Square Corner	1-1/8" (29mm)	3-3/4" (95mm)	1/2" (13mm)
10-2058	Square Corner	1-1/8" (29mm)	5" (127mm)	1/2" (13mm)
10-2634*	Square Corner	1-1/8" (29mm)	2-3/4" (70mm)	3/4" (19mm)

\* 04/26D finish only

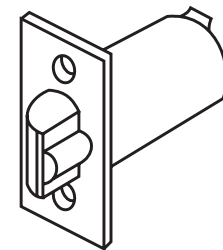

Deadlocking/Guarded

### Deadlocking/Guarded Latch - Electrified Functions:

Part No.	Front	Front Width	Backset	Throw
10-3433	Square Corner	1" (25mm)	2-3/8" (60mm)	1/2" (13mm)
10-3430	Square Corner	1-1/8" (29mm)	2-3/4" (70mm)	1/2" (13mm)
10-3431	Square Corner	1-1/8" (29mm)	3-3/4" (95mm)	1/2" (13mm)
10-3432	Square Corner	1-1/8" (29mm)	5" (127mm)	1/2" (13mm)

When ordering latches separately, specify Part No. x Finish (e.g., 10-3186 x 32D). Screw pack must be ordered separately, see page 7.

**STRIKES**  
**10X LINE CYLINDRICAL LEVER LOCKS**



**4-7/8" Curved Lip Strike (Standard)**

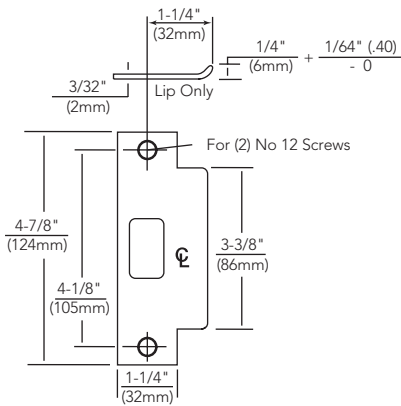

**2-3/4" Curved Lip Strike (29- Option)**

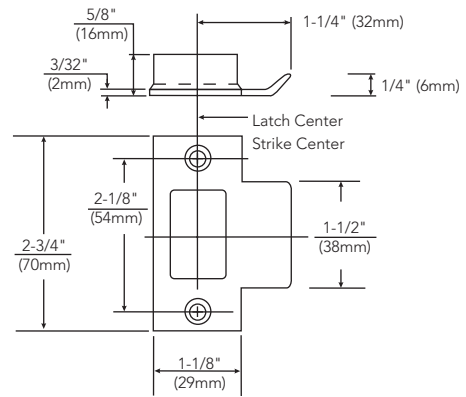

- Brass, bronze or stainless steel
- Conforms to ANSI standard
- Furnished standard with curved lip 1-1/4" (32mm) from center of strike screw holes to end of lip
- Lip lengths
 

7/8" (22mm)	1-5/8" (42mm)	2-5/8" (66mm)
1-1/8" (29mm)	1-7/8" (48mm)	2-7/8" (73mm)
1-1/4" (32mm)	2-1/8" (54mm)	3" (76mm)
1-3/8" (35mm)	2-3/8" (60mm)	
- 77-1141 Wrought strike box available separately
- To order strike separately, specify 808 strike x finish x lip length

- Brass, bronze or stainless steel
- Furnished standard with 1-1/4" (32mm) curved lip from center of strike screw holes to end of lip
- Lip lengths
 

1" (25mm)	1-3/4" (44mm)
1-1/4" (32mm) standard	2" (51mm)
1-1/2" (38mm)	3" (76mm)
- Plastic strike box AM-0044 included when 29- ordered with lockset
- To order strike separately, specify 800 strike x finish x lip length

Screw pack must be ordered separately, see page 7.

**ANSI Wrought Strike Box**

- Used with ANSI 4-7/8" (124mm) strike (#808)
- To order with lock, specify option WBS
- To order separately, specify 77-1141

Part No.	Description
77-1141	4-7/8" ANSI strike box



Experience a safer  
 and more open world

The warranty on SARGENT® products becomes void if the product is modified in any way, regardless of whether the modification causes or contributes to any alleged defect. If a SARGENT product is modified it may no longer meet industry certification and quality control standards applicable to the original product and is no longer a genuine SARGENT product.

Copyright © 2021-2026 Sargent Manufacturing Company, an ASSA ABLOY Group company. All rights reserved. Reproduction in whole or in part without the express written permission of Sargent Manufacturing Company is prohibited.

**CYLINDERS AND TAILPIECE PACKS**  
**10X LINE CYLINDRICAL LEVER LOCKS**



Brass, 6-pin  
 2 nickel silver keys  
 Finishes: 04, 15, BSP

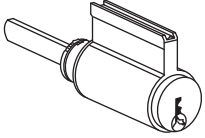

**Fixed Core Cylinders for Mechanical Functions**

Description	Cylinder	Door Thickness	Tailpiece Pack	Tailpiece ID Code*	
Conventional, Signature, XC Degree® and competitor keyway	C10X-1 (Std.)	DG2-C10X-1	1-3/8" - 2"	10-3629	—
	10-C10X-1	DG3-C10X-1			
	11-C10X-1	SC-C10X-1			
	DG1-C10X-1	SE-C10X-1	2-1/4"	10-3630	214
	31-C10X-1	DG2-31-C10X-1			
	10-31-C10X-1	DG3-31-C10X-1			
Keso	F1-82-C10X-1		1-3/8" - 2"	10-3637	—
	F1-82-31-C10X-1		2-1/4"	10-3638	214
Hotel function	C10X-2		1-3/8" - 2-1/4"	N/A	—

\*Cylinder type should be verified before ordering tailpiece pack.

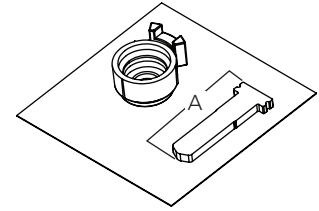

10-3629 (A=1.150")  
 10-3630 (A=1.313")

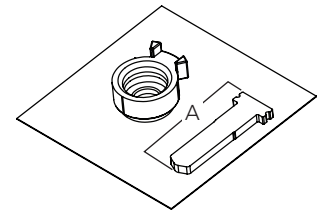

10-3637 (A=1.150")  
 10-3638 (A=1.313")

**Fixed Core Cylinders for Electrified Functions**

Description	Cylinder	Door Thickness	Tailpiece Pack	Tailpiece ID Code*	
Conventional, Signature, XC Degree® and competitor keyway	C10X-1E (Std.)	DG2-C10X-1E	1-3/8" - 2"	10-3791	EM
	10-C10X-1E	DG3-C10X-1E			
	11-C10X-1E	SC-C10X-1E			
	DG1-C10X-1E	SE-C10X-1E	2-1/4"	10-3792	214E
	31-C10X-1E	DG2-31-C10X-1E			
	10-31-C10X-1E	DG3-31-C10X-1E			
Keso	F1-82-C10X-1E		1-3/8" - 2"	10-3793	EM
	F1-82-31-C10X-1E		2-1/4"	10-3794	214E

\*Cylinder type should be verified before ordering tailpiece pack.

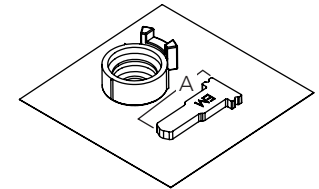

10-3791 (A=0.922")  
 10-3792 (A=1.085")

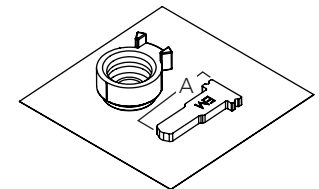

10-3793 (A=0.922")  
 10-3794 (A=1.085")

A8287 02/26

The warranty on SARGENT® products becomes void if the product is modified in any way, regardless of whether the modification causes or contributes to any alleged defect. If a SARGENT product is modified it may no longer meet industry certification and quality control standards applicable to the original product and is no longer a genuine SARGENT product.

Copyright © 2021-2026 Sargent Manufacturing Company, an ASSA ABLOY Group company. All rights reserved. Reproduction in whole or in part without the express written permission of Sargent Manufacturing Company is prohibited.

**CYLINDERS AND TAILPIECE PACKS**  
**10X LINE CYLINDRICAL LEVER LOCKS**



**Large Format Interchangeable Core (LFIC) Mechanical and Electrified Functions**

Brass, 6-pin  
 2 nickel silver keys  
 Finishes: 04, 15, BSP

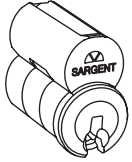

Description	Core Model Number	Door Thickness	Mechanical Functions		Electrified Functions	
			Tailpiece Pack	Tailpiece ID Code*	Tailpiece Pack	Tailpiece ID Code*
LFIC conventional and Signature	6300 10-6300 DG1-6300	1-3/8" - 2"	10-3631	LFIC	10-3773	EM LFIC
		2-1/4"	10-3632	LF2	10-3774	EM LF2
LFIC XC	11-6300	1-3/8" - 2"	10-3635	11LF	10-3777	EM 11F
		2-1/4"	10-3636	11L2	10-3778	EM 11L2

\*Cylinder type should be verified before ordering tailpiece pack.

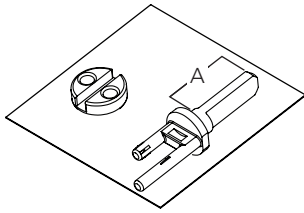

10-3631 (A=0.826")  
 10-3632 (A=0.989")

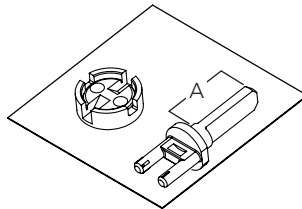

10-3635 (A=0.826")  
 10-3636 (A=0.989")

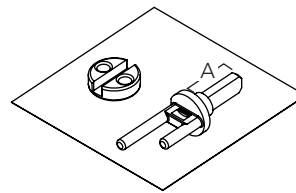

10-3773 (A=0.635")  
 10-3774 (A=0.798")

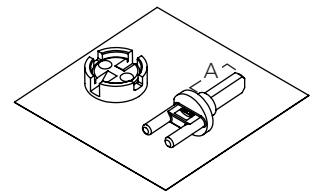

10-3777 (A=0.635")  
 10-3778 (A=0.798")

**Small Format Interchangeable Core (SFIC) for Mechanical and Electrified Functions**

Brass, 6 or 7 pin  
 Finishes 04, 15

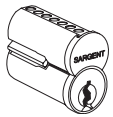

Description	Core Model Number	Door Thickness	Mechanical Functions		Electrified Functions	
			Tailpiece Pack	Tailpiece ID Code*	Tailpiece Pack	Tailpiece ID Code*
6-Pin SFIC	7300B	1-3/8" - 2"	10-3633	SFIC	10-3775	EM SFIC
7-Pin SFIC	7P-7300B	2-1/4"	10-3634	SF2	10-3776	EM SF2
XC	11-7P-7300B	1-3/8" - 2"	10-3641	11SF	10-3779	EM 11SF
		2-1/4"	10-3642	11L2	10-3780	EM 11S2

\*Cylinder type should be verified before ordering tailpiece pack.

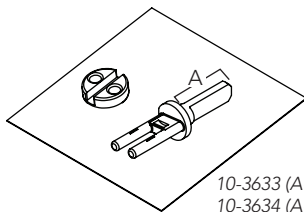

10-3633 (A=0.826")  
 10-3634 (A=0.989")

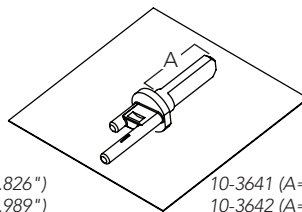

10-3641 (A=0.826")  
 10-3642 (A=0.989")

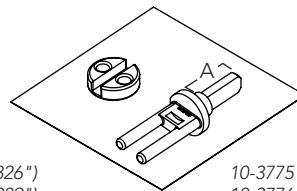

10-3775 (A=0.635")  
 10-3776 (A=0.798")

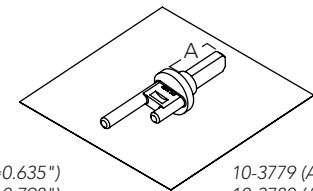

10-3779 (A=0.635")  
 10-3780 (A=0.798")

Experience a safer  
 and more open world

The warranty on SARGENT® products becomes void if the product is modified in any way, regardless of whether the modification causes or contributes to any alleged defect. If a SARGENT product is modified it may no longer meet industry certification and quality control standards applicable to the original product and is no longer a genuine SARGENT product.

Copyright © 2021-2026 Sargent Manufacturing Company, an ASSA ABLOY Group company. All rights reserved. Reproduction in whole or in part without the express written permission of Sargent Manufacturing Company is prohibited.

**CYLINDERS AND TAILPIECE PACKS**  
**10X LINE CYLINDRICAL LEVER LOCKS**



**Compatibility with Competitive Cylinders/Cores\***

Manufacturer	Cylinder Type	Door Thickness	Mechanical Functions		Electrified Functions		Option Code with Lock	Description
			Tailpiece Pack	Tailpiece ID Code**	Tailpiece Pack	Tailpiece ID Code**		
<b>Fixed Core</b>								
Schlage®	Fixed Core 6 Pin	1-3/8" - 2"	10-3625	SX	10-3781	SXE	30-	For Schlage® 6 pin conventional cylinders (21-002, 23-001 or 23-013) or Schlage Primus cylinders (20-548, 20-550, 20-748 or 20-750). Option code with lock includes tailpiece.
		2-1/4"	10-3626	SXL	10-3782	SXLE		
ASSA ABLOY ACCENTRA®	Fixed Core 6 Pin	1-3/8" - 2"	10-3639	X6	10-3783	X6E	YC-	For ASSA ABLOY ACCENTRA® 6 pin conventional cylinders (1803-46L/1803-46LL). Option code with lock includes tailpiece.
		2-1/4"	10-3640	X6L	10-3784	X6LE		
ASSA ABLOY ACCENTRA®	Fixed Core 7 Pin	1-3/8" - 2"	10-3664	X7	10-3785	X7E	YC-7P-	For ASSA ABLOY ACCENTRA® 7 pin conventional cylinders (1803A-46L/1803A-46LL). Option code with lock includes tailpiece.
		2-1/4"	10-3665	X7L	10-3786	X7LE		
<b>Interchangeable Core</b>								
All	SFIC 6 or 7 Pin	1-3/8" - 2"	10-3633	SFIC	10-3775	EM SFIC	70-, 72-, 73-	For all SFIC 6 and 7 pin cores. Option code with lock includes special lever and tailpiece.
		2-1/4"	10-3634	SF2	10-3776	EM SF2		
Schlage®	LFIC 6 Pin	1-3/8" - 2"	10-3627	—	10-3789	EM	SF-	For Schlage® 6 pin large format interchangeable cores. Option code with lock includes special lever and tailpiece.
		2-1/4"	10-3628	—	10-3790	31EM		
ASSA ABLOY AACCENTRA®	LFIC 6 Pin	1-3/8" - 2"	10-1191	YR	10-3787	EM	YRC-	For ASSA ABLOY ACCENTRA® 6-and 7- pin large format interchangeable cores. Option code with lock includes special lever and tailpiece.
		2-1/4"	10-1192	YR214	10-3788	EM214		
	LFIC 7 Pin	1-3/8" - 2"	10-4147	YR7	10-4225	EM7	YRC-7P-	
		2-1/4"	10-4148	YR7214	10-4226	EM7214		
Medeco	LFIC 6 Pin	1-3/8" - 2"	10-4149	MR	10-4227	MEM	MRC-	For Medeco 32 Series 6 pin large format interchangeable cores. Option code with lock includes special lever and tailpiece.
		2-1/4"	10-4150	MR214	10-4228	MEM214		

\*Cylinder/core not included unless defined by option code.  
 \*\*Cylinder type should be verified before ordering tailpiece pack.

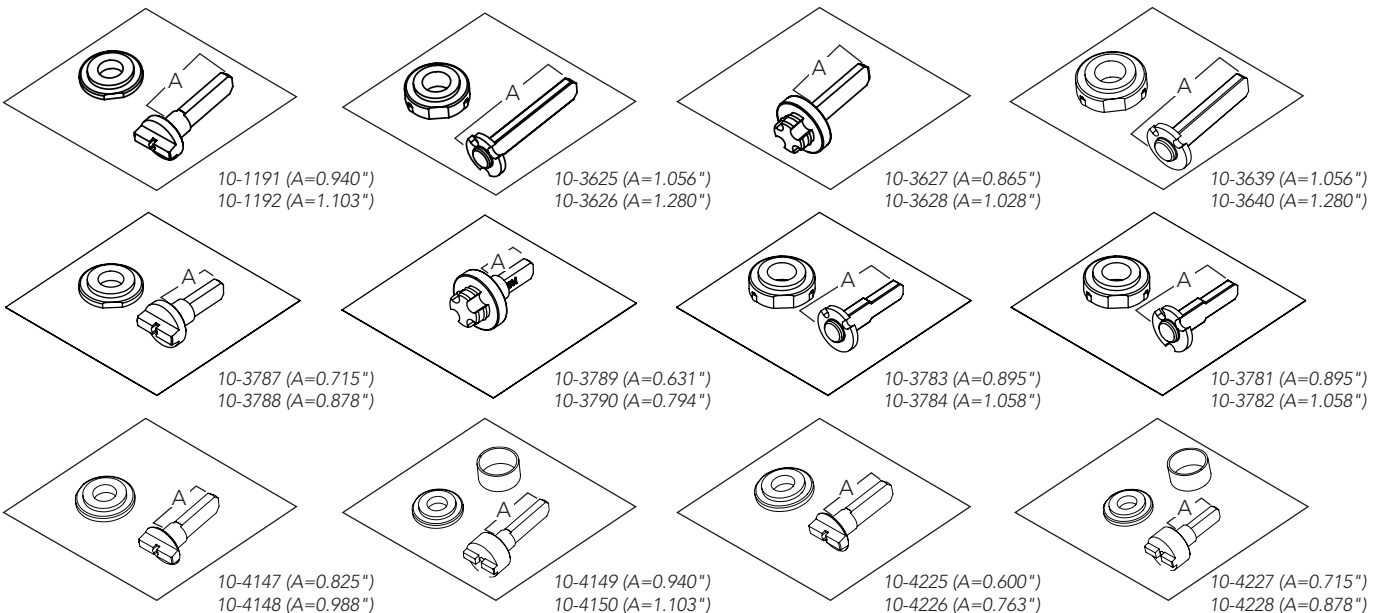

A8287 02/26

The warranty on SARGENT® products becomes void if the product is modified in any way, regardless of whether the modification causes or contributes to any alleged defect. If a SARGENT product is modified it may no longer meet industry certification and quality control standards applicable to the original product and is no longer a genuine SARGENT product.

**MISCELLANEOUS CYLINDER PARTS**  
**10X LINE CYLINDRICAL LEVER LOCKS**

Part #	Description
10-1278	Spacer Only - Fixed Core Cylinder
10-1112	Spacer Only - Keso
10-1115	Spacer Only - LFIC/SFIC
10-1252	Hotel Adjustment Tool
10-0042	Lockout Key (50 Function)
C10X-3	Emergency Release Cylinder - Privacy/ Bathroom Function (65), 1-3/8" - 2" Doors
31-C10X-3	Emergency Release Cylinder - Privacy/Bathroom Function (65), 2-1/4" Doors

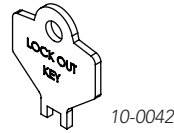
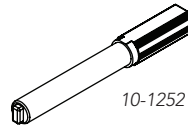

**Identifying Tailpieces**

10X Line cylinder tailpieces include stampings to help identify them. Refer to tailpiece ID code as noted on previous pages. Cylinder type should be verified before ordering tailpiece pack.

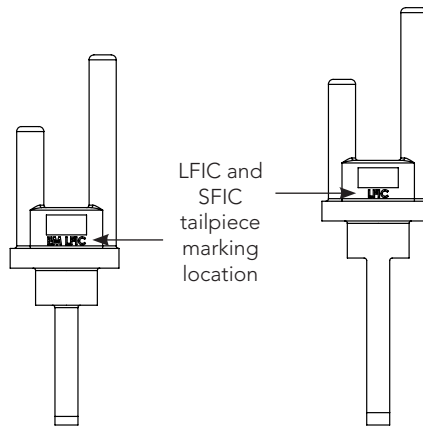
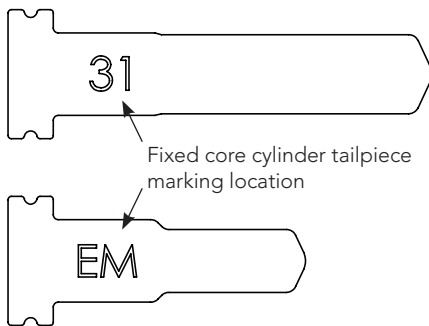

**Levers - Solid Cast Zinc**

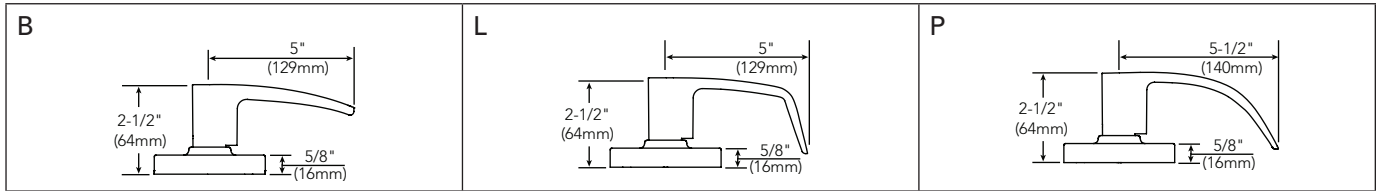

**Decorative Levers**

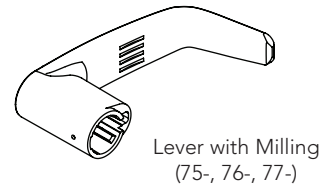
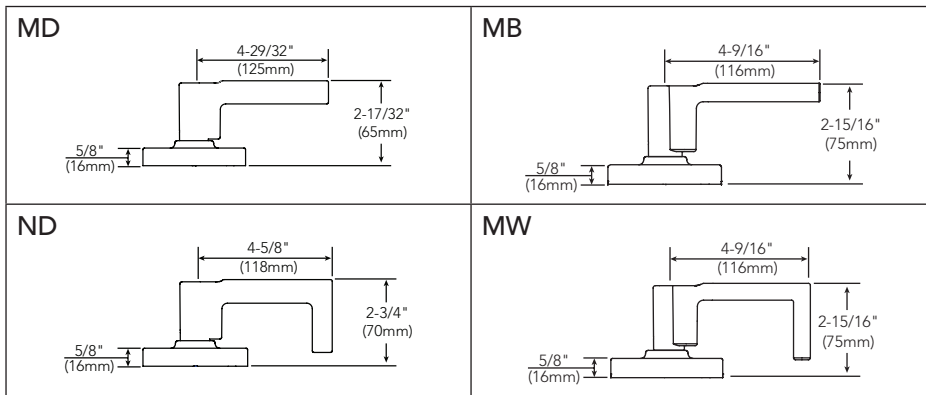

**Levers for Doors 1-3/8" to 2-1/4" (Specify finish)**

Application	B	L	P	MB	MD	MW	ND
Passage/plain	10-1121	10-1128	10-1137	10-1263	10-1240	10-1268	10-1245
Push/turn button, emergency release (65), fixed core cylinder (SARGENT® 6-pin)	10-1120	10-1127	10-1136	10-1264	10-1241	10-1269	10-1246
Thumbturn cylinder (68) includes cylinder	10-2424	10-2425	10-2427	10-2428	10-2429	10-2431	10-2432
Fixed core cylinder (Corbin Russwin 6/7-pin, Schlage® 6-pin, ASSA ABLOY ACCENTRA® 6/7-pin)	10-1122	10-1129	10-1138	10-1265	10-1242	10-1270	10-1247
LFIC (SARGENT® 60-, 63-, 64-)	10-1123	10-1130	10-1139	10-1266	10-1243	10-1271	10-1248
LFIC (Schlage® 6-pin SF-)	10-1125	10-1132	10-1141	N/A	N/A	N/A	N/A
LFIC (ASSA ABLOY ACCENTRA® 6-pin YRC-)	N/A	10-1134	10-1143	N/A	N/A	N/A	N/A
LFIC (ASSA ABLOY ACCENTRA® 7-pin YRC-7P-)	N/A	10-1831	10-1833	N/A	N/A	N/A	N/A
LFIC (Medeco 32 Series 6-pin MRC-)	N/A	10-1832	10-1834	N/A	N/A	N/A	N/A
SFIC 6/7-pin (70-, 72-, 73-)	10-1124	10-1131	10-1140	10-1267	10-1244	10-1272	10-1249
KESO cylinder (SARGENT® 82-)	10-1126	10-1133	10-1142	N/A	N/A	N/A	N/A

**Levers with Milling for Doors 1-3/8" to 2-1/4" (Specify finish)**

Application	B	L	P	MB	MD	MW	ND
Passage/plain	10-1146	10-1153	10-1162	N/A	N/A	N/A	N/A
Push/turn button, emergency release (65), fixed core cylinder (SARGENT® 6-pin)	10-1145	10-1152	10-1161	N/A	N/A	N/A	N/A
Thumbturn cylinder (68) includes cylinder	10-2434	10-2435	10-2437	N/A	N/A	N/A	N/A
Fixed core cylinder (Corbin Russwin 6/7-pin, Schlage® 6-pin, ASSA ABLOY ACCENTRA® 6/7-pin)	10-1147	10-1154	10-1163	N/A	N/A	N/A	N/A
LFIC (SARGENT® 60-, 63-, 64-)	10-1148	10-1155	10-1164	N/A	N/A	N/A	N/A
LFIC (Schlage® 6-pin SF-)	10-1150	10-1157	10-1166	N/A	N/A	N/A	N/A
LFIC (ASSA ABLOY ACCENTRA® 6-pin YRC-)	N/A	10-1159	10-1168	N/A	N/A	N/A	N/A
LFIC (ASSA ABLOY ACCENTRA® 7-pin YRC-7P-)	N/A	10-1835	10-1837	N/A	N/A	N/A	N/A
LFIC (Medeco 32 Series 6-pin MRC-)	N/A	10-1836	10-1838	N/A	N/A	N/A	N/A
SFIC 6/7-pin (70-, 72-, 73-)	10-1149	10-1156	10-1165	N/A	N/A	N/A	N/A
KESO cylinder (SARGENT® 82-)	10-1151	10-1158	10-1167	N/A	N/A	N/A	N/A

A8287 02/26

The warranty on SARGENT® products becomes void if the product is modified in any way, regardless of whether the modification causes or contributes to any alleged defect. If a SARGENT product is modified it may no longer meet industry certification and quality control standards applicable to the original product and is no longer a genuine SARGENT product.

Copyright © 2021-2026 Sargent Manufacturing Company, an ASSA ABLOY Group company. All rights reserved. Reproduction in whole or in part without the express written permission of Sargent Manufacturing Company is prohibited.

**VSL INDICATOR LEVER ASSEMBLIES**  
**10X LINE CYLINDRICAL LEVER LOCKS**



**Red/Green Indicator Lever Assemblies With Padlock Icons for Doors 1-3/8" - 2-1/4" (Specify finish)**

Application	VSL		
	Inside	Inside 38 Function Only*	Outside
Passage/Plain	10-3834		10-3819
Emergency key hole			10-3838
Push/turn button, emergency release (65) or fixed core cylinder (SARGENT 6-pin)	10-3835	10-3880	10-2440
Fixed core cylinder (Corbin Russwin 6/7-pin, ASSA ABLOY ACCENTRA® 6/7-pin, Schlage® 6-pin)		10-3884	10-3823
LFIC (SARGENT 60-, 63-, 64-)		10-3881	10-3820
LFIC (Schlage® 6-pin SF-)		10-3885	10-3824
LFIC (ASSA ABLOY ACCENTRA® 6-pin YRC-)		10-3886	10-3825
LFIC (ASSA ABLOY ACCENTRA® 7-pin YRC-7P-)		N/A	10-4157
LFIC (Medeco 32 Series 6-pin MRC-)		10-4165	10-4158
SFIC 6/7-pin (70-, 72-, 73-)		10-3882	10-3821
KESO cylinder (SARGENT 82-)		10-3883	10-3822

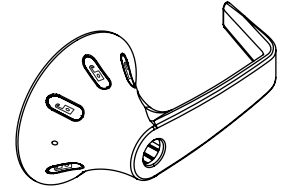

VSL Lever Assembly

**Red/White Indicator Lever Assemblies With Padlock Icons for Doors 1-3/8" - 2-1/4" (Specify finish)**

Application	VSL		
	Inside	Inside 38 Function Only*	Outside
Passage/Plain	10-3836		10-3826
Emergency key hole			10-3839
Push/turn button, emergency release (65) or fixed core cylinder (SARGENT 6-pin)	10-3837	10-3888	10-3827
Fixed core cylinder (Corbin Russwin 6/7-pin, ASSA ABLOY ACCENTRA® 6/7-pin, Schlage® 6-pin)		10-3892	10-3831
LFIC (SARGENT 60-, 63-, 64-)		10-3889	10-3828
LFIC (Schlage® 6-pin SF-)		10-3893	10-3832
LFIC (ASSA ABLOY ACCENTRA® 6-pin YRC-)		10-3894	10-3833
LFIC (ASSA ABLOY ACCENTRA® 7-pin YRC-7P-)		N/A	10-4159
LFIC (Medeco 32 Series 6-pin MRC-)		10-4166	10-4160
SFIC 6/7-pin (70-, 72-, 73-)		10-3890	10-3829
KESO cylinder (SARGENT 82-)		10-3891	10-3830

\*Inside levers for 38 function include "Lock" engraving on lever

Experience a safer  
and more open world

The warranty on SARGENT® products becomes void if the product is modified in any way, regardless of whether the modification causes or contributes to any alleged defect. If a SARGENT product is modified it may no longer meet industry certification and quality control standards applicable to the original product and is no longer a genuine SARGENT product.

Copyright © 2021-2026 Sargent Manufacturing Company, an ASSA ABLOY Group company. All rights reserved. Reproduction in whole or in part without the express written permission of Sargent Manufacturing Company is prohibited.

**VSL INDICATOR LEVER ASSEMBLIES**  
**10X LINE CYLINDRICAL LEVER LOCKS**



**Red/Green Indicator Lever Assemblies No Padlock Icons for Doors 1-3/8" - 2-1/4" (Specify finish)**

Application	VSLL		
	Inside	Inside 38 Function Only*	Outside
Passage/Plain	10-3972		10-3968
Emergency key hole			10-3970
Push/turn button, emergency release (65) or fixed core cylinder (SARGENT 6-pin)	10-3959	10-3974	10-3945
Fixed core cylinder (Corbin Russwin 6/7-pin, ASSA ABLOY ACCENTRA® 6/7-pin, Schlage® 6-pin)		10-3978	10-3949
LFIC (SARGENT 60-, 63-, 64-)		10-3975	10-3946
LFIC (Schlage® 6-pin SF-)		10-3979	10-3950
LFIC (ASSA ABLOY ACCENTRA® 6-pin YRC-)		10-3980	10-3951
LFIC (ASSA ABLOY ACCENTRA® 7-pin YRC-7P-)		N/A	10-4161
LFIC (Medeco 32 Series 6-pin MRC-)		10-4167	10-4162
SFIC 6/7-pin (70-, 72-, 73-)		10-3976	10-3947
KESO cylinder (SARGENT 82-)		10-3977	10-3948

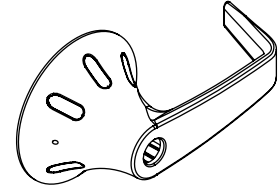

VSLL Lever Assembly

**Red/White Indicator Lever Assemblies With Padlock Icons for Doors 1-3/8" - 2-1/4" (Specify finish)**

Application	VSLL		
	Inside	Inside 38 Function Only*	Outside
Passage/Plain	10-3973		10-3969
Emergency key hole			10-3971
Push/turn button, emergency release (65) or fixed core cylinder (SARGENT 6-pin)	10-3960	10-3981	10-3952
Fixed core cylinder (Corbin Russwin 6/7-pin, ASSA ABLOY ACCENTRA® 6/7-pin, Schlage® 6-pin)		10-3985	10-3956
LFIC (SARGENT 60-, 63-, 64-)		10-3982	10-3953
LFIC (Schlage® 6-pin SF-)		10-3986	10-3957
LFIC (ASSA ABLOY ACCENTRA® 6-pin YRC-)		10-3987	10-3958
LFIC (ASSA ABLOY ACCENTRA® 7-pin YRC-7P-)		N/A	10-4163
LFIC (Medeco 32 Series 6-pin MRC-)		10-4168	10-4164
SFIC 6/7-pin (70-, 72-, 73-)		10-3983	10-3954
KESO cylinder (SARGENT 82-)		10-3984	10-3955

\*Inside levers for 38 function include "Lock" engraving on lever

A8287 02/26

**HOW TO ORDER PARTS/FINISHES**  
**10X LINE CYLINDRICAL LEVER LOCKS**



**How to Order Parts**

1. In order to simplify the ordering procedure and maintain regulatory compliance, parts are only available as listed
2. To order parts, provide the appropriate quantity, part number, finish, hand (when required) and description as directed and illustrated below.

For example, use the following configuration to order:

- A) ten lockbodies in satin chrome
- B) one passage/plain L lever in bright brass

	Quantity	Part Number	Finish	Hand	Description
A	10	10-3588	26D	—	Entrance Function Lockbody
B	1	10-1128	03	—	Passage/Plain L Lever

For assistance, contact your authorized SARGENT distributor, sales agency or visit our website at [www.sargentlock.com](http://www.sargentlock.com).

**Finishes**

SARGENT #	Descriptions	ANSI/BHMA
03	Polished brass, clear coated	605
04	Satin brass, clear coated	606
09	Polished bronze, clear coated	611
10	Satin bronze, clear coated	612
10B	Oxidized bronze, oil rubbed	613
10BE	Dark Oxidized Satin Bronze - equivalent	613E
10BL	Oxidized satin, bronze, clear coated	613L
14	Polished nickel, clear coated	618
15	Satin nickel, clear coated	619
20D	Statuary dark bronze, clear coated	624
26	Polished chrome	625
26D	Satin chrome	626
32D	Satin stainless steel (BHW only)	630
BSP	Black suede powder coat	BSP
WSP	White suede powder coat	WSP

Lock Finish	Cylinder/Core*
03, 04, 09, 10, 10B, 10BE, 10BL, 20D	04
14, 15, 26, 26D, 32D, WSP	15
BSP	BSP

\*Finish when cylinder provided with lock, exceptions may apply.  
 15 finish provided for cylinders/cores where BSP not available.

The ASSA ABLOY Group is the global leader in access solutions. Every day, we help billions of people experience a more open world.

ASSA ABLOY Opening Solutions leads the development within door openings and products for access solutions in homes, businesses and institutions. Our offering includes doors, frames, door and window hardware, mechanical and smart locks, access control and service.



SARGENT Manufacturing Company  
100 Sargent Drive  
New Haven, CT 06511 USA  
800-727-5477  
[www.sargentlock.com](http://www.sargentlock.com)

Founded in the early 1800s, SARGENT® is a market leader in locksets, cylinders, door closers, exit devices, electro-mechanical products and access control systems for new construction, renovation, and replacement applications. The company's customer base includes commercial construction, institutional, and industrial markets.

Copyright © 2021-2026, SARGENT Manufacturing Company. All rights reserved. Reproduction in whole or in part without the express written permission of SARGENT Manufacturing Company is prohibited. Patent pending and/or patent [www.assaabloydss.com/patents](http://www.assaabloydss.com/patents).