

Intelligent Key Cabinet

medeco
ASSA ABLOY

Mechanical iFob Configuration

Experience a safer
and more open world

The Intelligent Key Cabinet (IKC) from Medeco is a robust, flexible, electronically controlled key management system that increases accountability and reduces the risk of misplaced keys.

Only authorized users can gain access to the cabinet via the Biometric Fingerprint reader or PIN code pad, or a combination of both. An optional access card reader is also available. The IKC electronically keeps a record of key removals and returns - by whom and when. Not only does the IKC improve employee efficiency and lower operating costs, it provides a record of who checked out keys, when they took them, and sends alerts for unreturned keys.

The Mechanical iFob Configuration uses exclusive iFob tracking technology to enhance accountability, analytics, and asset control for mechanical keys and other assets. The iFob is a nickel-plated brass device with a unique electronic ID.

Security

- Customizable groups allow for controlled access.
- Unauthorized key removal triggers notifications.

Software:

- Easy-to-use web-interface shows what keys are in, what keys are out, and to whom they are issued.
- Complete reporting reduces lost keys.
- Multi-system networking.
- Authorized administrators can access the system from any PC-based web browser.

Benefits:

- **Accountability:** No more wondering who has keys. Complete audit trail and reporting by user and key activity means fewer lost keys, lower expenses, and improved security.
- **Analytics:** Identify potential problems in access and return patterns before they escalate. Complete reporting suite provides multiple reporting options to provide real-time data.
- **Security:** Keep keys onsite and secure. Only authorized users are able to access the assets in the IKC using Biometric Fingerprint, PIN, and/or Prox Card authentication (optional).
- **Convenience:** Allow employees to retrieve keys quickly without waiting for a manager. Quick, easy-to-use web-based software shows what keys are out, and to whom they are issued.
- **Productivity:** Eliminates the need for an Administrator or Manager to distribute keys to employees. The employees are empowered with access to retrieve their own keys when and where they are needed.
- **Scalability:** The IKC system can grow as business needs grow with up to 7 add-on cabinets for every main cabinet.



Features:

- Available in 3 cabinet sizes. Cabinet storage capacities are 32, 64, 96, 128, 160, 192, 224, 256, and 288.
- Heavy-gauged steel enclosure
- Built-in LCD screen for access and programming at the cabinet
- Multi-factor authentication includes options for biometric fingerprint reader, smart card reader, and PIN.
- SMS and email alert messages
- Camera for security photo capture
- Multi-system networking
- High-security Medeco mechanical lock for manual override
- Main and Add-On cabinets can be configured with same technology or different
- Can be mounted to wall; stand available for purchase



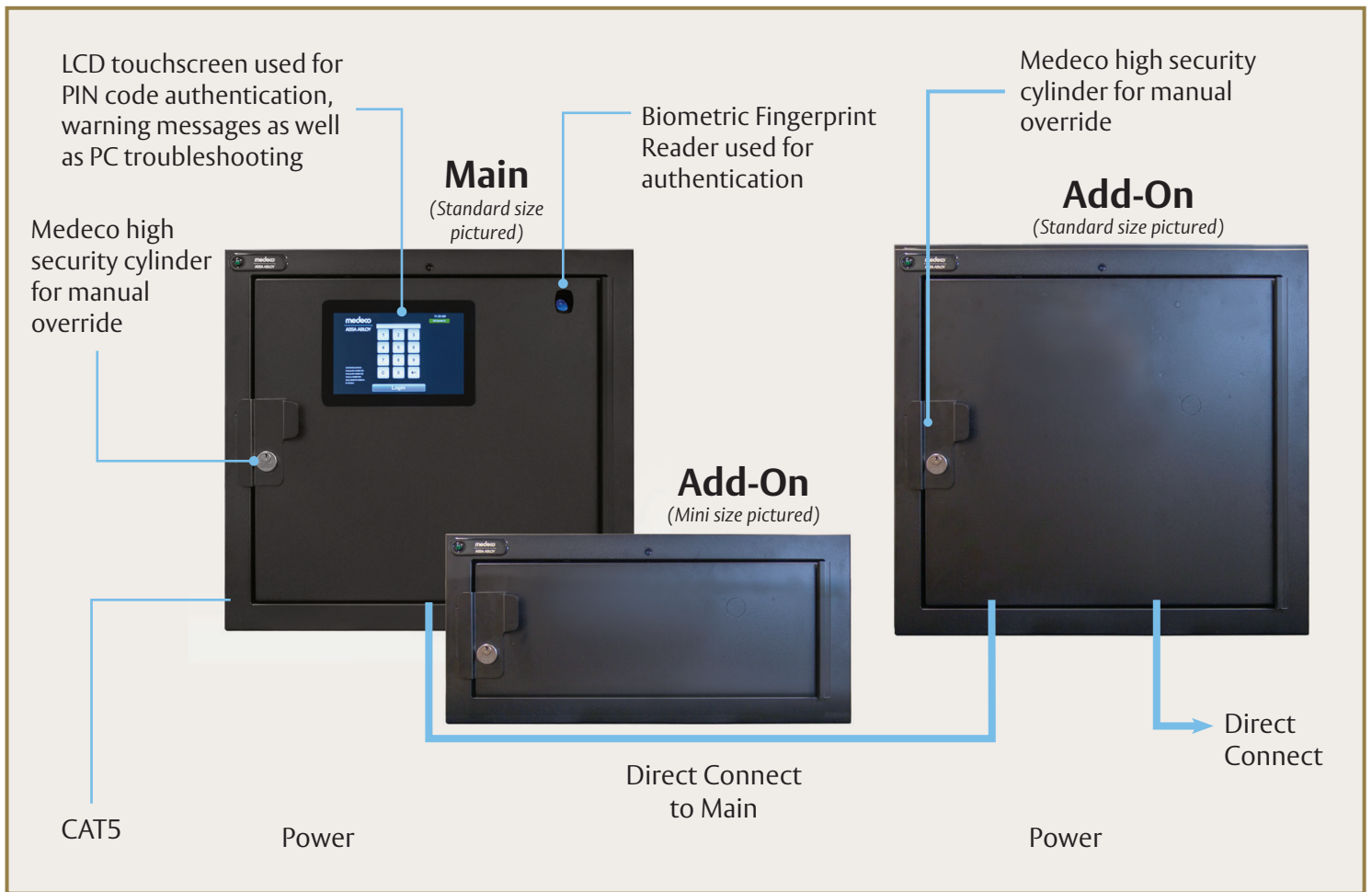

How to Order Example:

EA-100248-MD1 = 32 Port iFob Main Cabinet, Input Device, with Stand

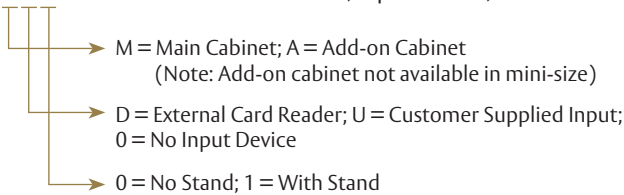

Cabinet Size	Part Number	Ports	Type
Mini	EA-100236-XXX	32	iFob
Standard	EA-100248-XXX	32	iFob
Standard	EA-100249-XXX	64	iFob
Standard	EA-100250-XXX	32/32	XT/iFob Combo
Standard	EA-100259-XXX	96	iFob
Standard	EA-100260-XXX	128	iFob
Large	EA-100261-XXX	160	iFob
Large	EA-100262-XXX	192	iFob
Large	EA-100263-XXX	224	iFob
Large	EA-100264-XXX	256	iFob
Large	EA-100265-XXX	288	iFob

XXX = configuration and option package.
See complete part number example.

Mini-Cabinet:

- 32 Ports
- 27" W x 14.72" H x 12" D
- Can be stand-alone or connected to Add-On cabinets

Standard Cabinet:

- 32, 64, 96, or 128 Ports
- 27" W x 25.25" H x 12" D
- Can be stand alone or connected to Add-On cabinet

Large Cabinet:

- 160, 192, 224, 256, or 288 Ports
- 27" W x 46" H x 11" D
- Weight: 290 pounds
- Available as iFob Main or Add-On Cabinet
- May require wall reinforcement for mounting

Add-On Cabinet:

- 32 or 64 Ports
- 27" W x 25.25" H x 12" D
- 32 port can be expanded to 64 ports, sold separately

Visit www.medeco.com/ikc or call Medeco Customer Service at 1-877-633-3261 for additional information.