

All-N-One Cam Lock Kit

medeco
ASSA ABLOY

Experience a safer
and more open world

For easy installation, read all instructions before beginning

1. Drill 3/4" hole in wood doors. Use double-D punch for metal doors.
 2. Install spur washer with flats vertical or horizontal depending on desired key pull position; Firmly apply spur washer into hole from front or rear surface depending on material thickness and preference. Spur washer not needed if double-O hole is provided.
 3. Insert lock into hole.
 4. Apply 3/4" nut onto lock and tighten securely.
 5. Apply 90° or 180° cam stop for desired rotation. Cam stops can be flipped for clockwise or counter-clockwise rotation.
 6. Affix cam for selected locking position.
 7. Use straight or bent cam for correct fit. Bent cam can be used with bend facing inward or outward.
 8. Fasten cam with lock washer and small nut.
- Lock can be positioned with locked-position key pull at 3 o'clock or 6 o'clock
 - Cams can be mounted at 12, 3, 6, or 9 o'clock
 - Rotation can be either clockwise or counter-clockwise depending on cam stop (flip to change)
 - 90° cam stop = 1 key pull ... 180° cam stop = 2 key pulls

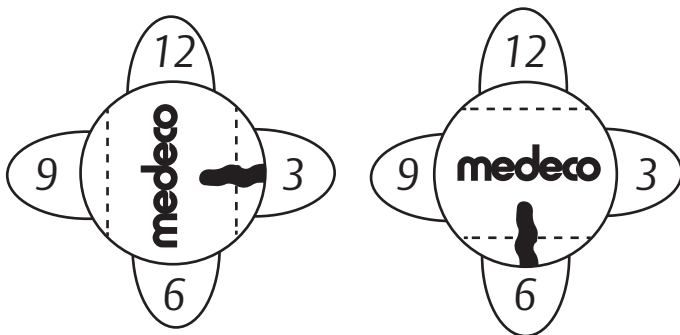
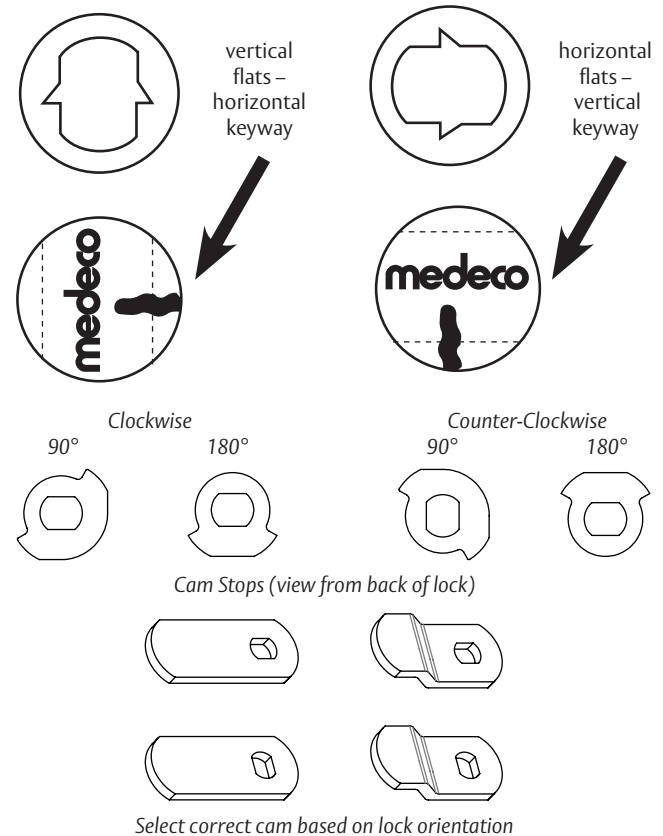

Medeco® recommends that all cylinders be lubed with Fluid Film® once every 3 months or anytime the key is difficult to insert or turn.

