

PEMKO
METAL DOORS SLIDING HARDWARE

Experience a safer
and more open world

Door Leaf Capacity – Up to 250 lbs

Overhead Mount

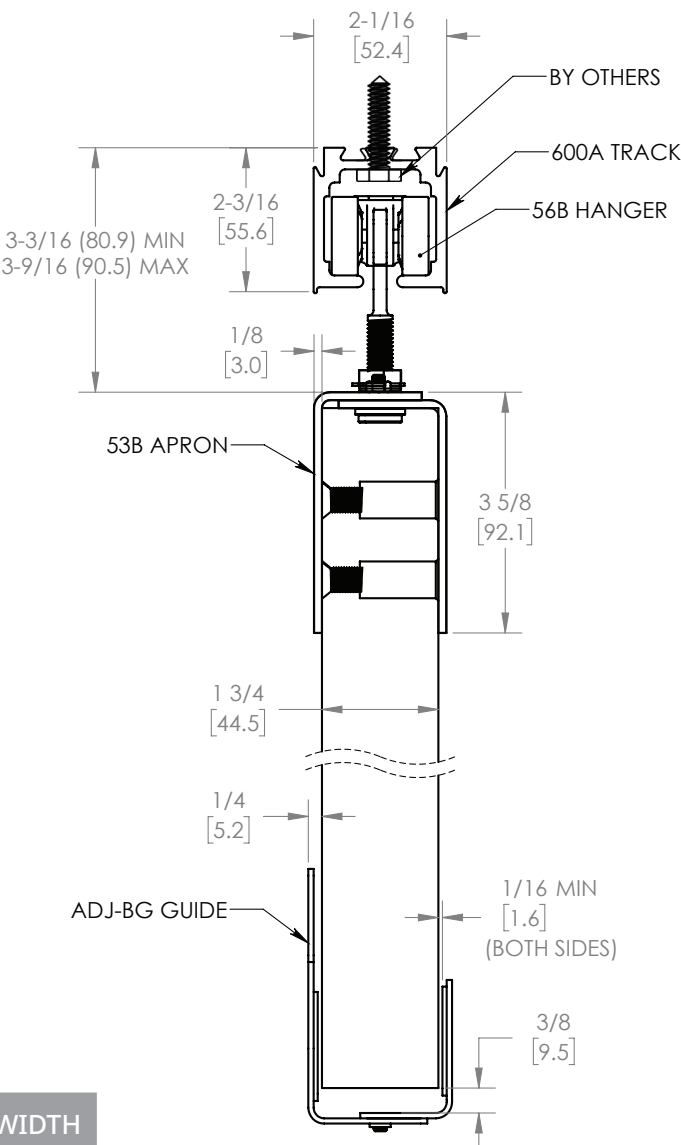
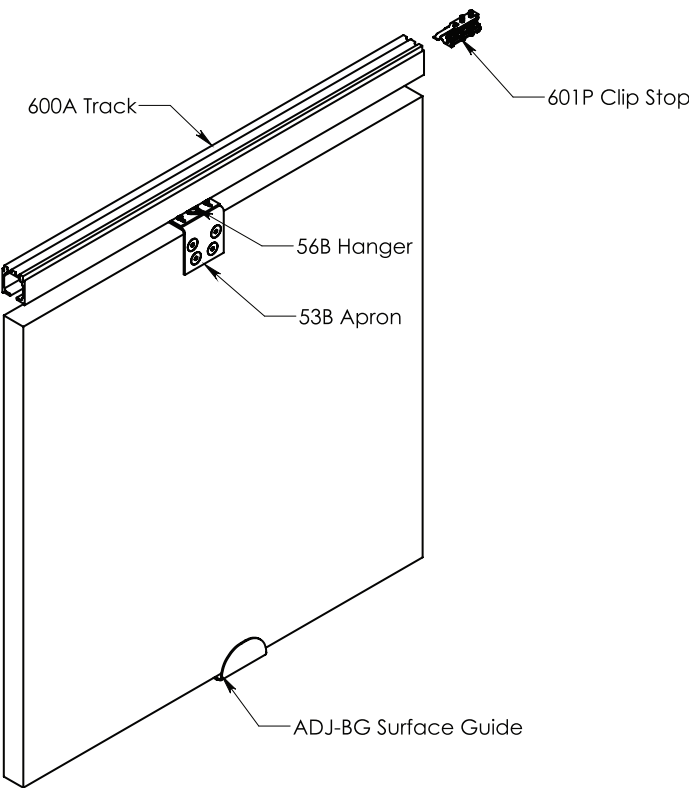

PART NUMBER	MATERIAL	TRACK LENGTH	DOOR WIDTH
TBS250A - OH/6	Aluminum	72"	36"
TBS250A - OH/8	Aluminum	96"	48"
TBS250A - OH/10	Aluminum	120"	60"
TBS250A - OH/12	Aluminum	144"	72"

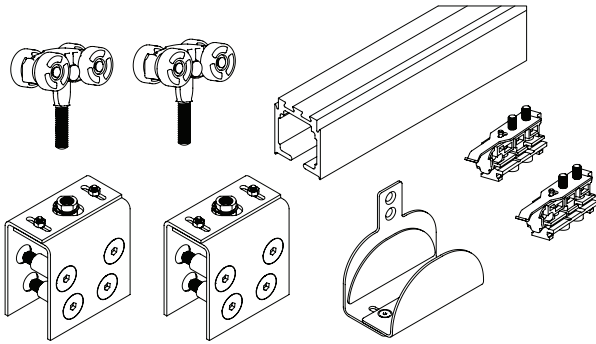

TBS250A-OH Kit Includes:

- 1 ea. 600A Mill Finished Aluminum Track
- 2 ea. 56B Hangers: Gray Nylon Body, Zinc Coated Steel Pendant Bolt, Steel Ball Bearing Nylon Wheels
- 2 ea. 53B Apron with Through Bolts and Machine screws
- 2 ea. 601P Nylon In-Track Clip Stop
- 1 ea. ADJ-BG Surface Guide

1. Secure Track

Secure track at each end. Bolts should be no more than 2' (61m) from each end and centered on track. Ensure track is plumb and level.

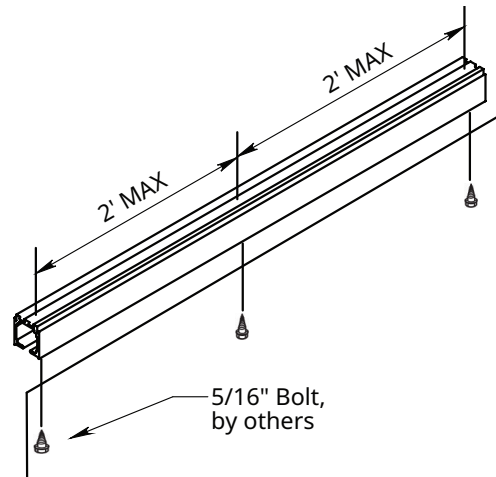

2. Mark Centerline for Door Guide

Attach a plumb line to hanger. Remove one end bracket. Place hanger inside track. Using plumb line, mark the centerline of door guide.

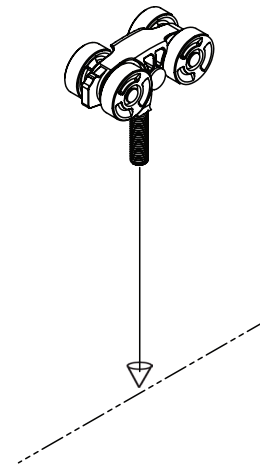

3. Fit Door Guide to Floor/Wall

a. Wall Mounting

Adjust width of door guide to be door thickness + 2 x 1/8". Tighten set screws at the above set width. Mount the guide with screws provided. (Use plastic anchors if you are not mounting to solid structure. E.g., Sheet rock without stud)

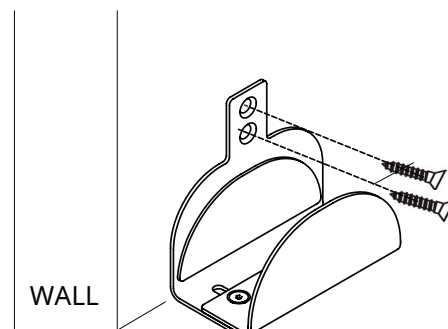

b. Floor Mounting

Remove set screws from the guide. Adjust width of door guide to be door thickness + 2 x 1/8". Mark hole locations on floor and drill pilot holes. Mount the guide with anchors and screws provided on the floor at the above width.

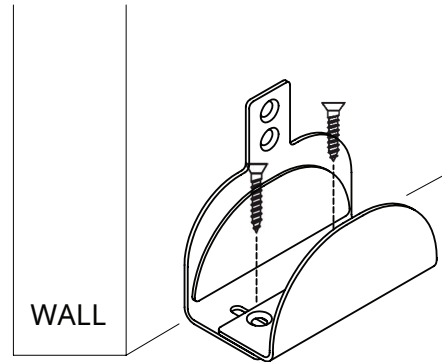

4. Prepare Door for 53B/APRON

- a. Loosen the set screws on top of Apron. Adjust Apron width so that it wraps around door thickness.
- b. Place Apron such that each Apron edge is 6 inches from edge of door.
- c. If the door does not have a channel on top, mark location of locknut on top, drill $\varnothing 7/8"$ hole.
- d. Place Apron back on the door so that it sits flush on top of the door.
- e. Mark hole for both screws and through bolts.
- f. Drill $\varnothing 9/16"$ holes through the door.
- g. Put the Apron back on, tighten set screws with 3/8" wrench, assemble the machine screw and barrel nut and tighten them. Do not overtighten to avoid dimpling the door.

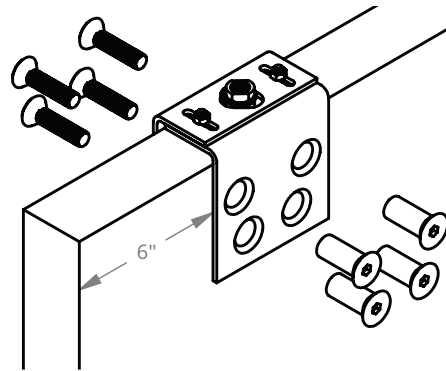

5. Attach Hangers to Apron

Screw pennant bolt of Hanger into nut in Apron. Make sure the hanger body is in such a way that the Tail Clip is pointed to the nearest door edge.

This tail clip is secured into 601P clip stops in track to hold door in fully open/closed positions.

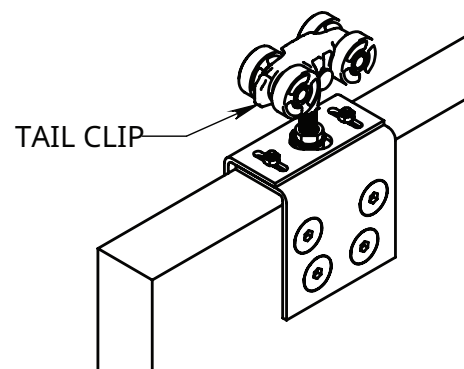

The ASSA ABLOY Group is the global leader in access solutions. Every day, we help billions of people experience a more open world.

ASSA ABLOY Opening Solutions leads the development within door openings and products for access solutions in homes, businesses and institutions. Our offering includes doors, frames, door and window hardware, mechanical and smart locks, access control and service.

6. Hang Door

Slowly guide complete door unit into track using installed floor guide.

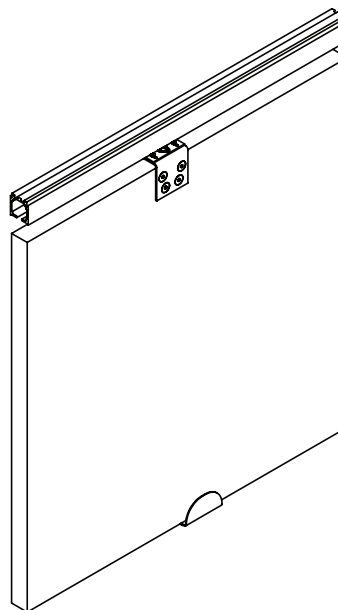

7. Position and Secure Clip Stops

