

ASSA ABLOY Model AS41P - Acoustical Door System

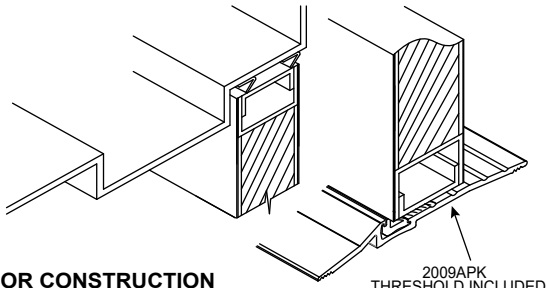

**DOOR CONSTRUCTION
TOP AND BOTTOM**

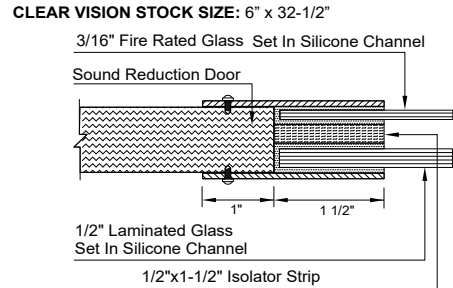

DG20 DOOR VISION (fire rated - Glass factory installed)

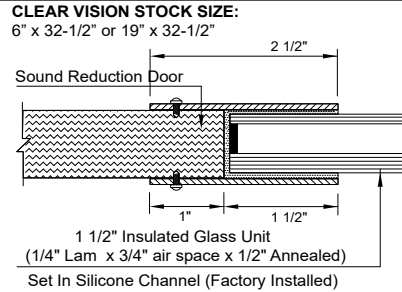

IGU20 DOOR VISION (non fire rated Glass Factory Installed)

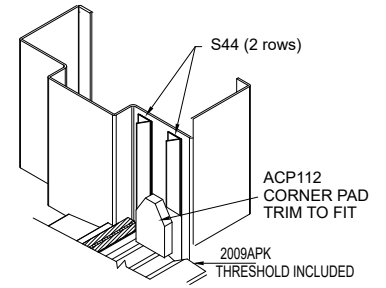

HINGE / STRIKE JAMB

**MODEL AS41P UTILIZES "S" PROFILE FRAME
(Seal set 6 for single) (Seal set 4 for pair)**

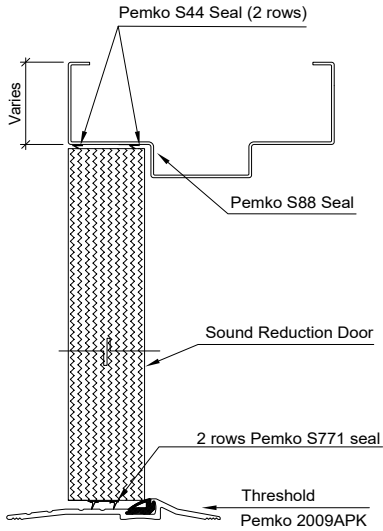

VERTICAL SECTION

SPECIFICATIONS

- 1) All exposed surfaces of door and frame to receive one coat of rust inhibitive prime paint complying with ASTM A250.10.
- 2) An aluminum threshold is included.
- 3) Bottom seals require a flush level sealing surface. The threshold must be level and may require shimming to compensate for an uneven floor. This will prevent any sound leaks at this location.
- 4) Assembly is equipped with metal sound door, frame, seals and threshold. Product is also crated for shipment.
- 5) Door Thickness is 1 3/4". Door weight is 8.4 pounds per square foot. Be aware that the frame must be securely tied to the framing from the sub floor to the structure above.
- 6) Doors are to be formed of no less than 16 Gauge steel face sheets with welded smooth edge at the vertical edges and finished smooth. (14 or 12 gauge also available).
- 7) Frames are to be formed of no less than 14 Gauge sheet steel with corners mitered, continuously welded and ground smooth. (12 gauge also available).
- 8) Doors and frames are formed from commercial quality cold rolled steel with optional zinc coating conforming to ASTM A653 & ASTM A924. Acoustical core and internal construction are manufacturer's proprietary standards as tested in accordance with ASTM E90, E413, E1332, & E2235.
- 9) Frames must be fully grouted. RockWool Delta-10 mineral wool is an acceptable alternative.
- 10) Please be aware industry standard construction tolerances for squareness of frame installation, plumbness of walls, flatness of floors, etc. may result in a difference of 3db-5db sound loss in a field test vs. lab results.
- 11) Alternate seal sets may be supplied based on function of hardware.
- 12) Plastic laminate veneer option available upon request.
- 13) Fire Rated up to 180 minutes.

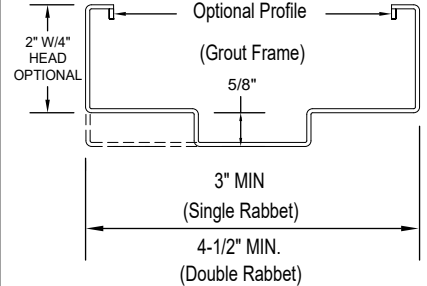

SOUND FRAME PROFILE

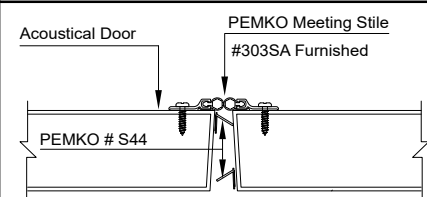
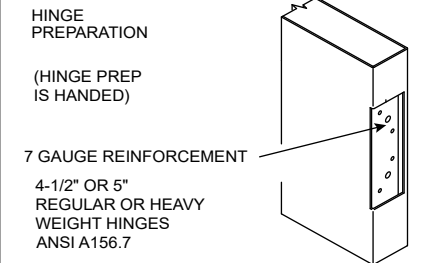

2ALa ASTRAGAL (Both leaf active)

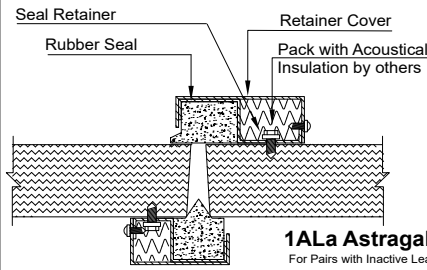

1ALa Astragal
For Pairs with Inactive Leaf

**Up to STC 41 (Flush Singles)
1 3/4" Acoustical Door System
Tech. Data**

Experience a safer and more open world

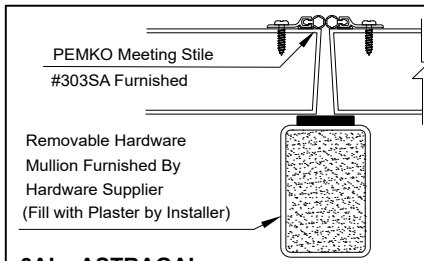
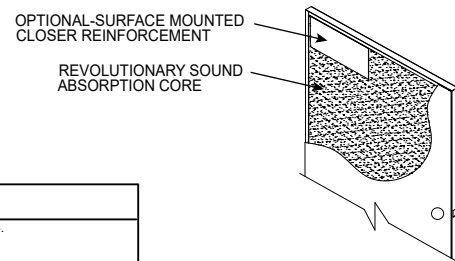

3ALa ASTRAGAL

FINISH:	STANDARD PRIMER PAINT, TESTED IN CONFORMANCE WITH ANSI A250.10
ACOUSTICAL PERFORMANCE	TESTED AND IN COMPLIANCE WITH ASTM E90, ASTM E413, ASTM E1332, & ASTM E2235. DOOR SYSTEMS ARE IN COMPLIANCE WITH HMMMA 865 & SDI-128 SPECIFICATIONS. COMPLETE WITH PERIMETER SOUND SEALS, BOTTOM SEALS AND THRESHOLD AS REQUIRED FOR RATING.