

ASSA ABLOY Model AS55P - Acoustical Door System

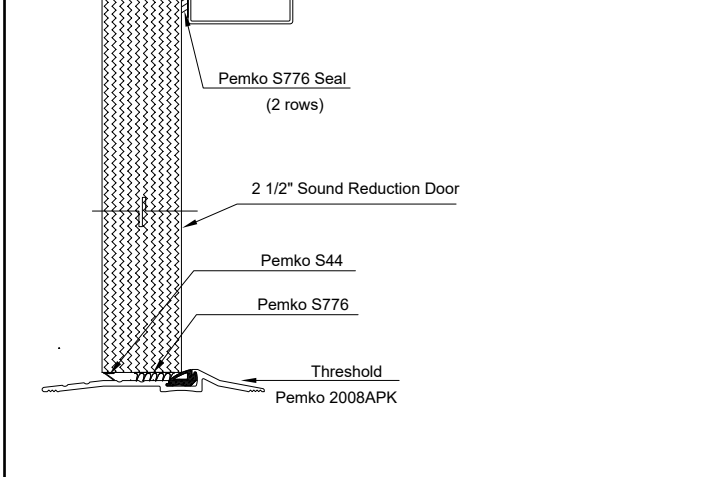

SPECIFICATIONS

- 1) All exposed surfaces of door and frame to receive one coat of rust inhibitive prime paint complying with ASTM A250.10.
- 2) An aluminum threshold is included.
- 3) Bottom seals require a flush level sealing surface. The threshold must be level and may require shimming to compensate for an uneven floor. This will prevent any sound leaks at this location.
- 4) Assembly is equipped with metal sound door, frame, seals and threshold. Product is also crated for shipment.
- 5) Door Thickness is 2 1/2". Door weight is 10.7 Lbs. / square ft. Be aware that the frame must be securely tied to the framing from the sub floor to the structure above.
- 6) Doors are to be formed of no less than 16 Gauge steel face sheets with welded smooth edge at the vertical edges and finished smooth.
- 7) Frames are to be formed of no less than 16 Gauge sheet steel with corners mitered, welded and ground smooth (continuous welds optional).
- 8) Doors and frames are formed from commercial quality cold rolled steel with optional zinc coating conforming to ASTM A653 & ASTM A924. Acoustical core and internal construction are manufacturer's proprietary standards as tested in accordance with ASTM E90, E413, E1332, & E2235.
- 9) Frames must be fully grouted.
- 10) Please be aware industry standard construction tolerances for squareness of frame installation, plumbness of walls, flatness of floors, etc. may result in a difference of 3db-5db sound loss in a field test vs. lab results.
- 11) Visions not available in this configuration.

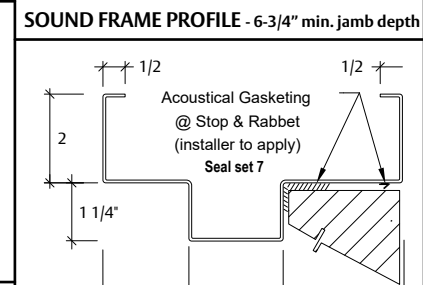
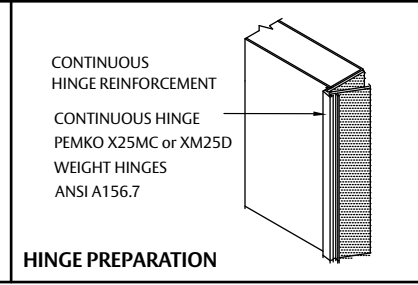
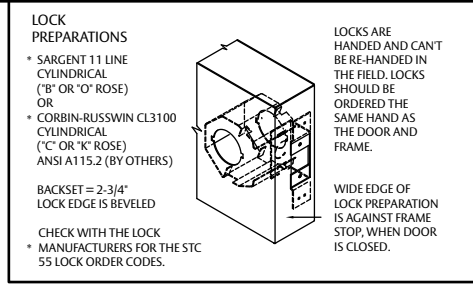
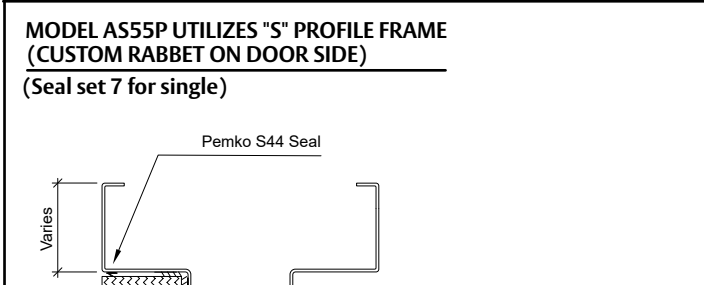
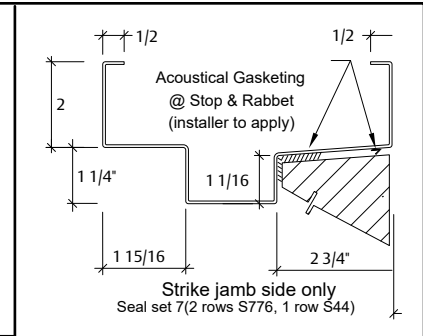
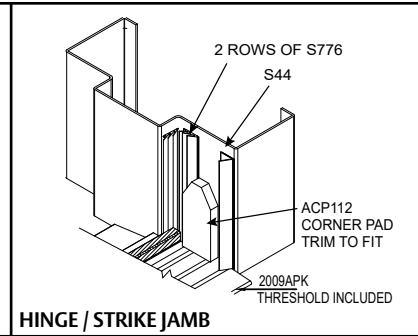
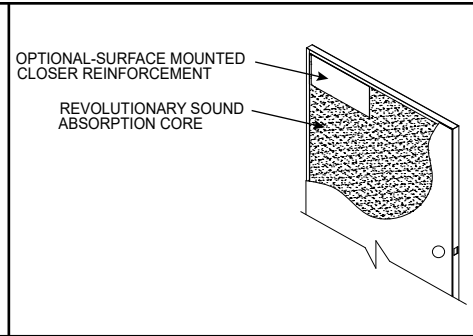
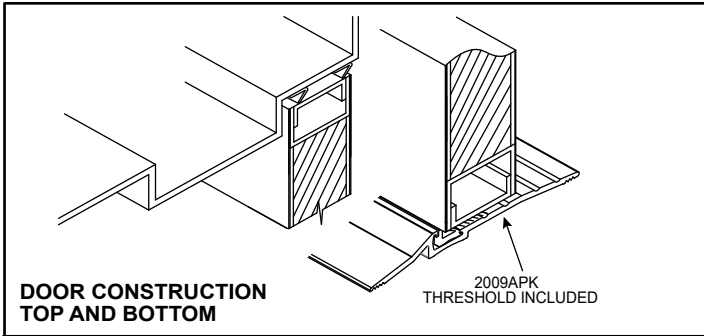
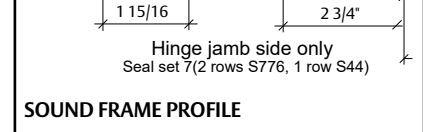

SOUND FRAME PROFILE

- 4'0" x 8'0" is maximum opening size, in a single frame configuration
- 6-3/4" minimum jamb width
- Flush only, no visions
- Fire ratings not available
- Pairs not available
- Lock Preparations: Sargent: 10X Line Cylindrical ("O" Rose) or Corbin Russwin: CLX3300 Cylindrical ("C" Rose) ANSI A115.2. Continuous hinge only option and is included.
- Perimeter sound seals, threshold, and door bottom included.

STC 55 (Flush Singles) 2 1/2 inch Acoustical Door System Tech. Data

Experience a safer and more open world

FINISH:	STANDARD PRIMER PAINT; TESTED IN CONFORMANCE WITH ANSI A250.10
ACOUSTICAL PERFORMANCE	TESTED AND IN COMPLIANCE WITH ASTM E90, ASTM E413, ASTM E1332, & ASTM E2235. DOOR SYSTEMS ARE IN COMPLIANCE WITH HMMMA 865 & SDI-128 SPECIFICATIONS. COMPLETE WITH PERIMETER SOUND SEALS, BOTTOM SEALS AND THRESHOLD AS REQUIRED FOR RATING.