

# Installation Instructions



ASSA ABLOY

## Active Indicator with Cylinder Retrofit Kit

### PED Series Exit Devices

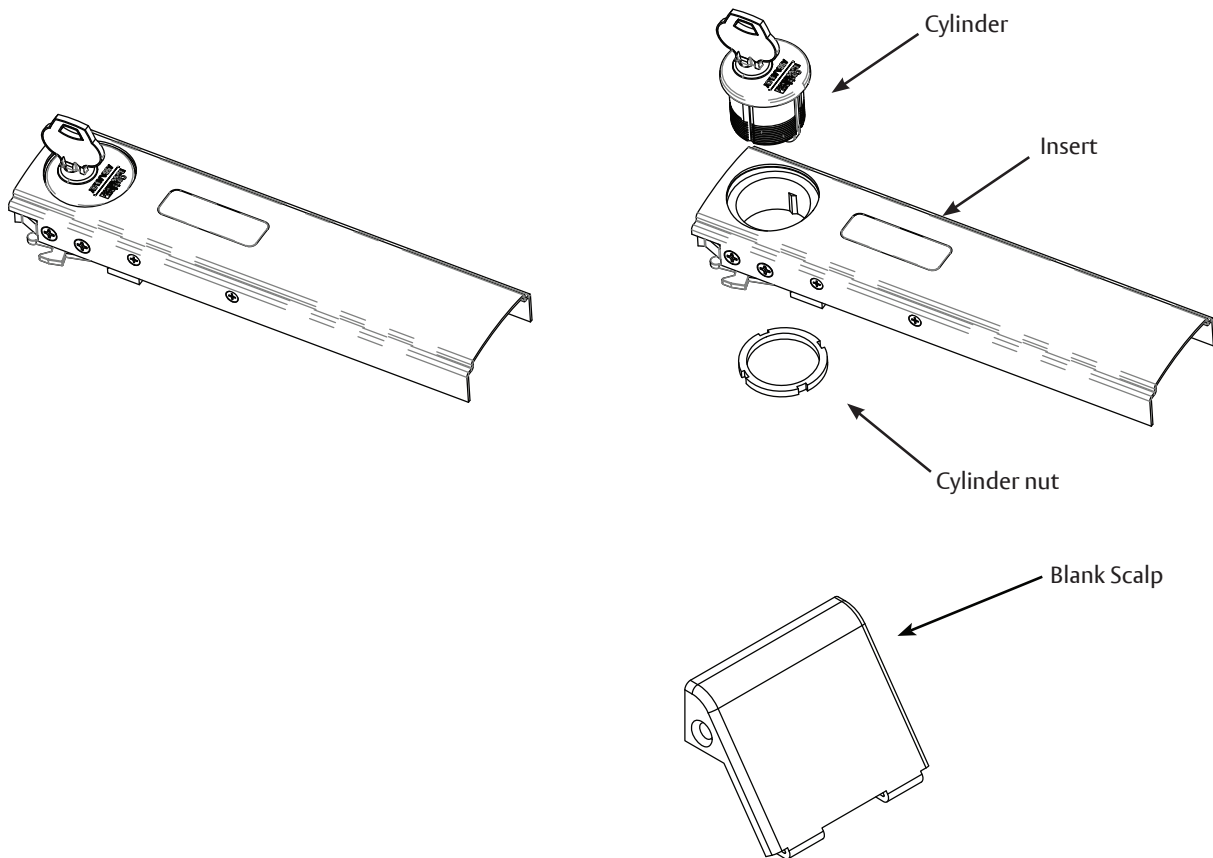

Active Indicator Retrofit Kit components shown

#### **WARNING**

This product can expose you to lead which is known to the state of California to cause cancer and birth defects or other reproductive harm. For more information go to [www.P65warnings.ca.gov](http://www.P65warnings.ca.gov).

#### **WARNING**

Attention Installer: Improper installation may result in damage to the product and void the factory warranty.

For installation assistance contact Corbin Russwin  
1-800-543-3658 • [techsupport.corbinrusswin@assaabloy.com](mailto:techsupport.corbinrusswin@assaabloy.com)

Copyright © 2023, 2024, ASSA ABLOY Access and Egress Hardware Group, Inc. All rights reserved. Reproduction in whole or in part without the express written permission of ASSA ABLOY Access and Egress Hardware Group, Inc. is prohibited.

FM803 06/24

Experience a safer  
and more open world

# Active Indicator with Cylinder Retrofit Kit



ASSA ABLOY

## PE80 Series Exit Devices

### Installation Instructions

1

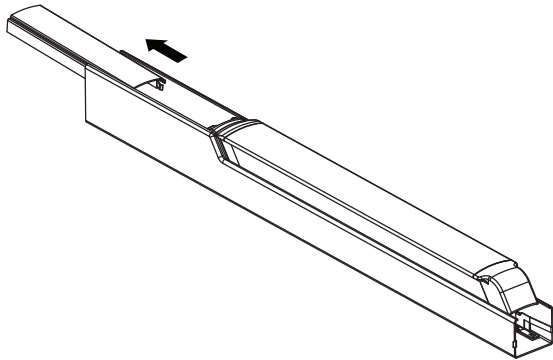

Remove insert from the rail.

2

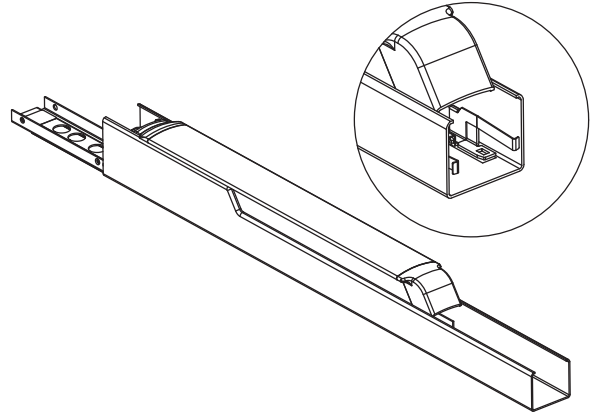

Squeeze the two clips in the front and slide the carrier / push assembly back to release it from the end of the mount.

3

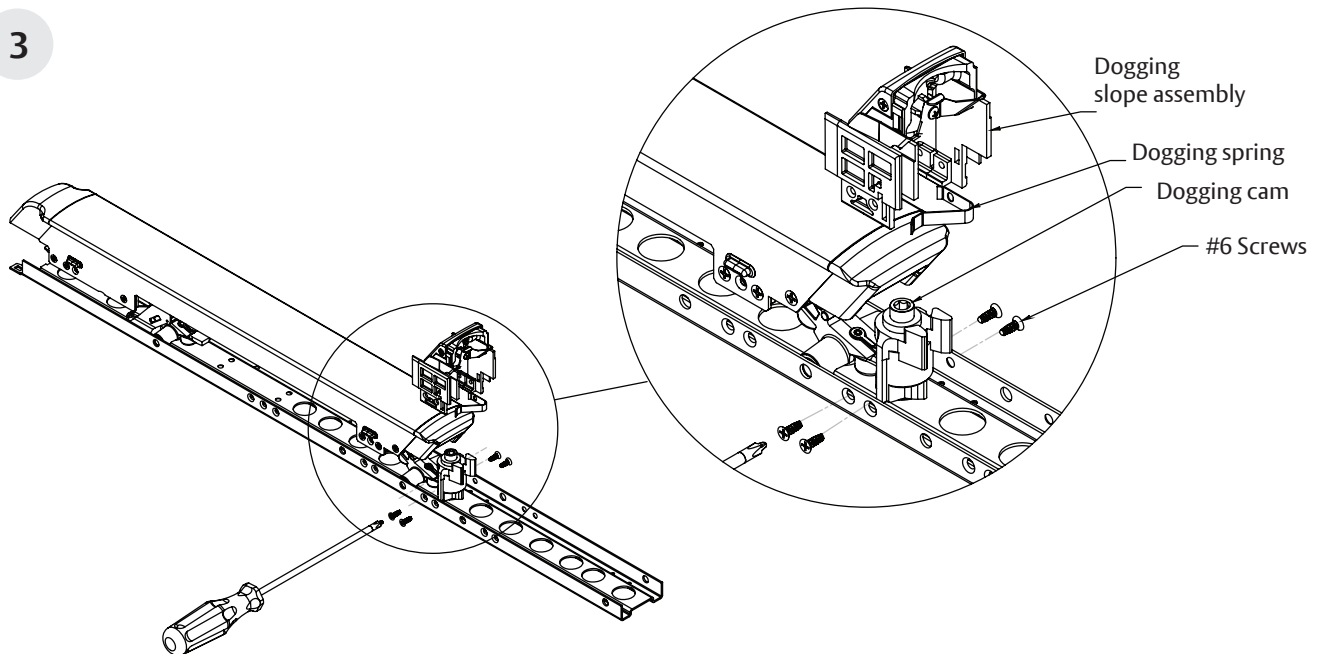

Remove four #6 screws to remove dogging slope assembly.

For installation assistance contact Corbin Russwin  
1-800-543-3658 • [techsupport.corbinrusswin@assaabloy.com](mailto:techsupport.corbinrusswin@assaabloy.com)

Copyright © 2023, 2024, ASSA ABLOY Access and Egress Hardware Group, Inc. All rights reserved.  
Reproduction in whole or in part without the express written permission of ASSA ABLOY Access  
and Egress Hardware Group, Inc. is prohibited.

FM803 06/24

# Active Indicator with Cylinder Retrofit Kit



ASSA ABLOY

## PE80 Series Exit Devices

### Installation Instructions

4

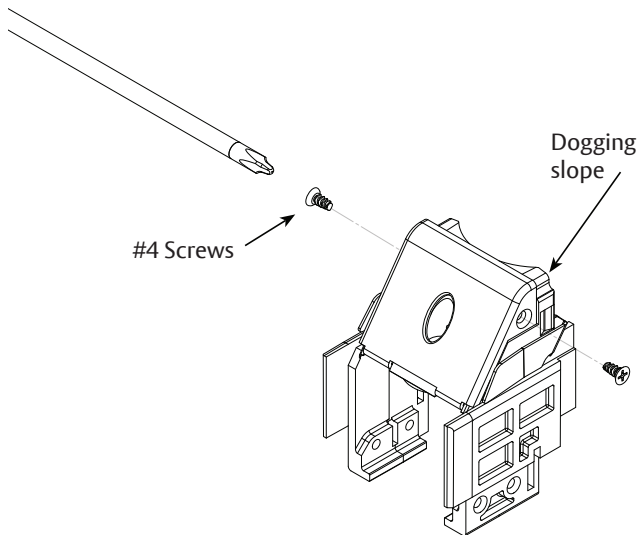

5

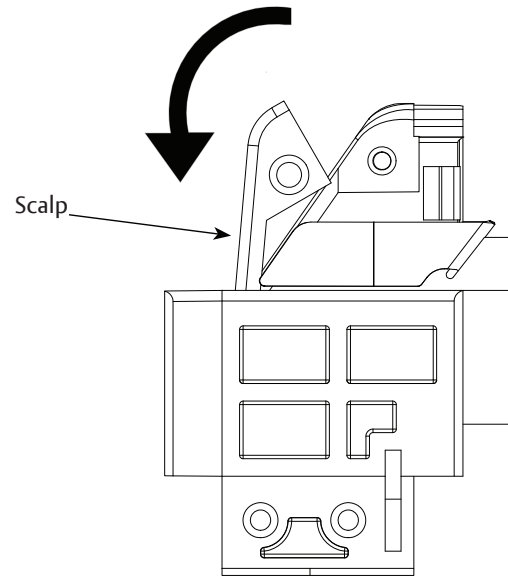

6

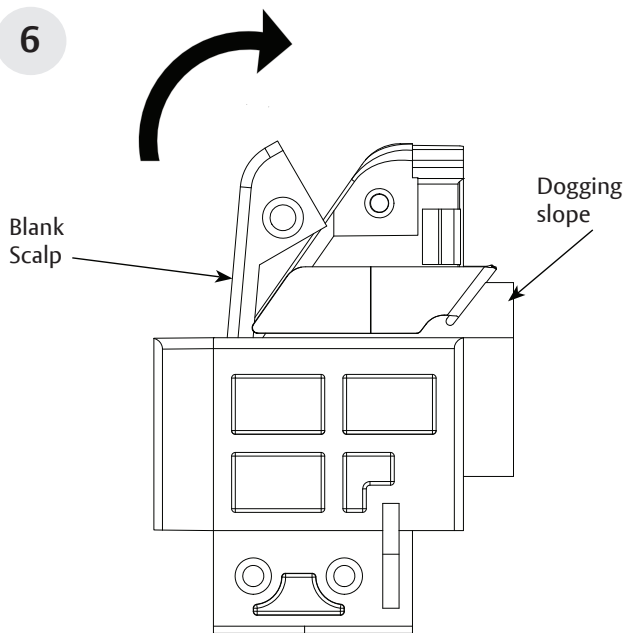

7

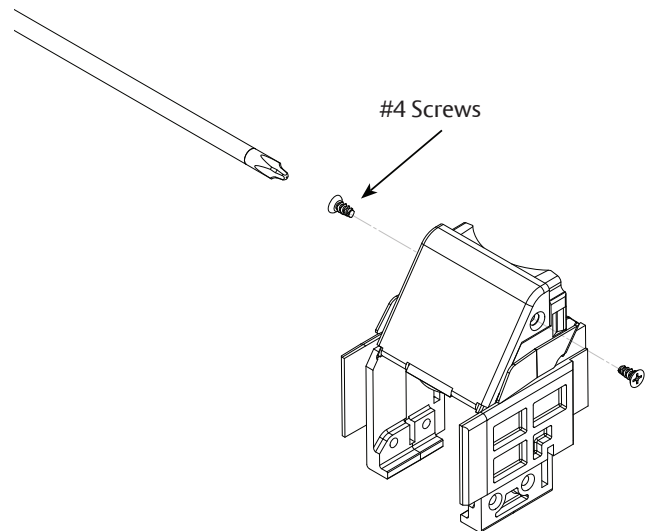

For installation assistance contact Corbin Russwin  
1-800-543-3658 • [techsupport.corbinrusswin@assaabloy.com](mailto:techsupport.corbinrusswin@assaabloy.com)

Copyright © 2023, 2024, ASSA ABLOY Access and Egress Hardware Group, Inc. All rights reserved.  
Reproduction in whole or in part without the express written permission of ASSA ABLOY Access  
and Egress Hardware Group, Inc. is prohibited.

FM803 06/24

# Active Indicator with Cylinder Retrofit Kit

## PE80 Series Exit Devices

### Installation Instructions



ASSA ABLOY

8

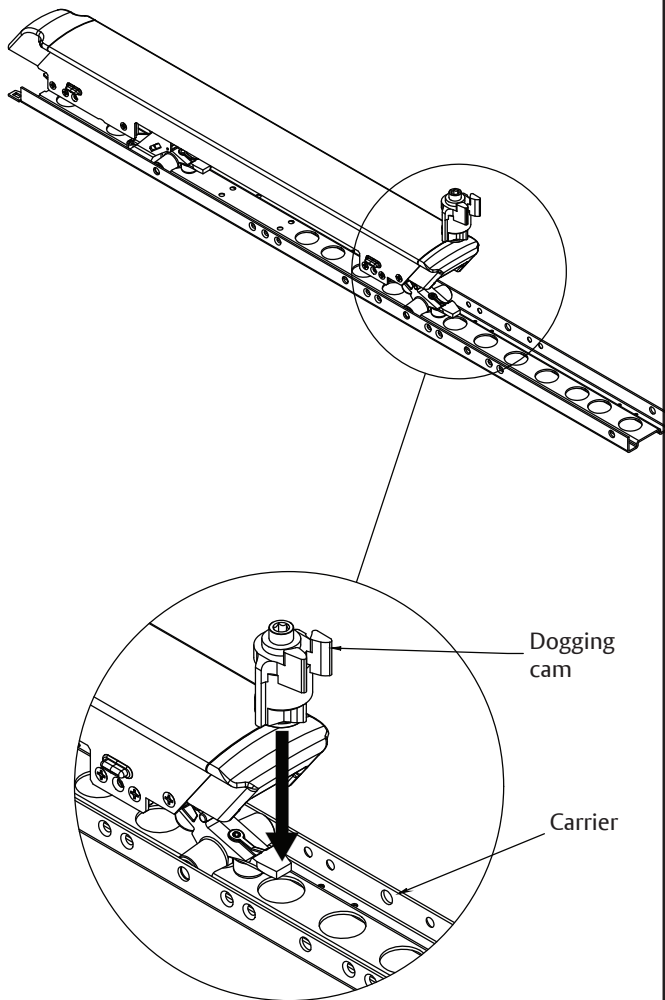

Place dogging cam in carrier hole.

9

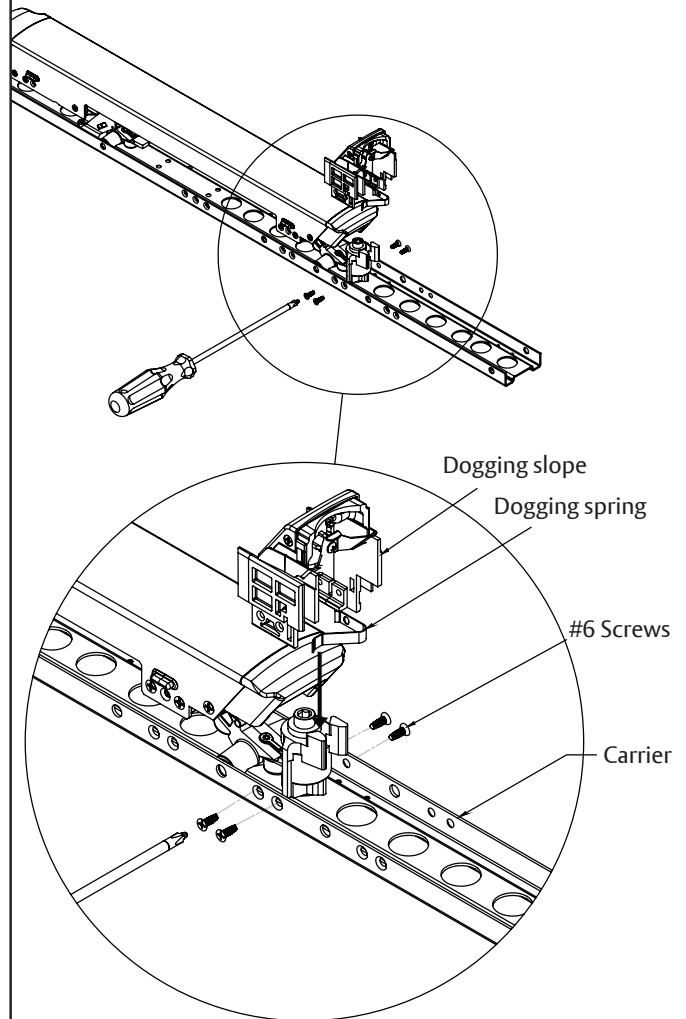

Place dogging spring outside of dogging slope.  
Insert both on the carrier. Install four #6 screws.

For installation assistance contact Corbin Russwin  
1-800-543-3658 • techsupport.corbinrusswin@assaabloy.com

Copyright © 2023, 2024, ASSA ABLOY Access and Egress Hardware Group, Inc. All rights reserved.  
Reproduction in whole or in part without the express written permission of ASSA ABLOY Access  
and Egress Hardware Group, Inc. is prohibited.

FM803 06/24

# Active Indicator with Cylinder Retrofit Kit



ASSA ABLOY

## PE80 Series Exit Devices

### Installation Instructions

10

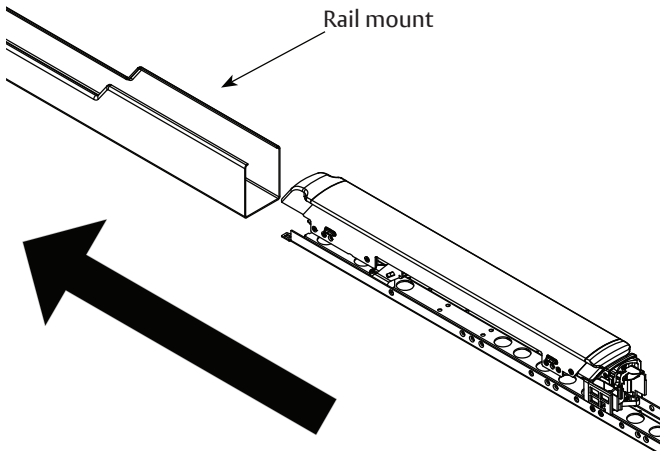

Slide active indicator insert into rail mount. If the cylinder is supplied, see step 14 for cylinder installation.

11

Some items hidden for clarity.

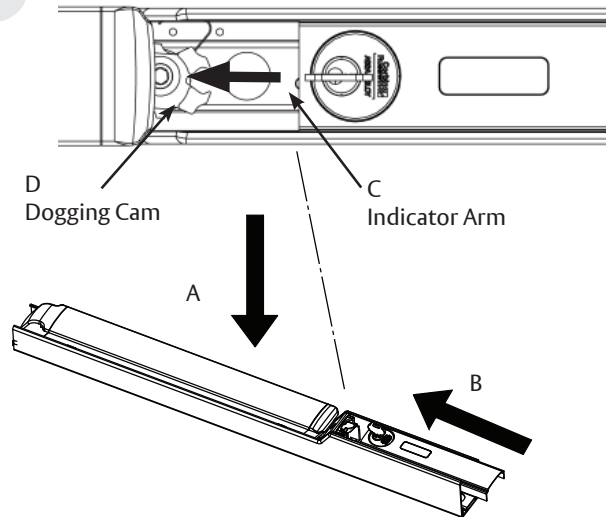

Connect by (A) compressing the bar, and (B) sliding insert in. Align into position (C) & (D) so that both interconnect centrally. Push insert to snap onto dogging slope.

12

Some items hidden for clarity.

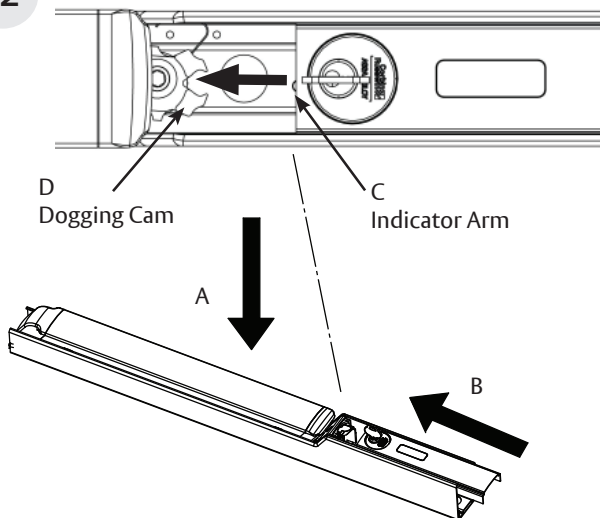

If Dogging Cam (D) and Cylinder Cam (C) are not properly aligned, remove insert and carrier from mount and go back to step 11.

13

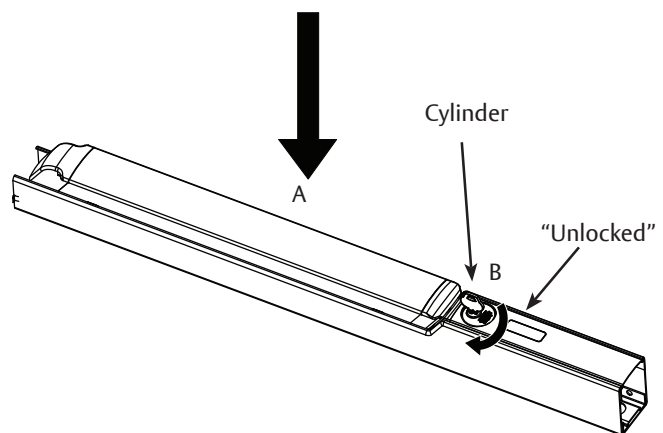

Test the function by (A) compressing the bar, and (B) turning the key in the cylinder clockwise to engage dogging. The bar should stay compressed. "Unlocked" should display.

For installation assistance contact Corbin Russwin  
1-800-543-3658 • techsupport.corbinrusswin@assaabloy.com

Copyright © 2023, 2024, ASSA ABLOY Access and Egress Hardware Group, Inc. All rights reserved. Reproduction in whole or in part without the express written permission of ASSA ABLOY Access and Egress Hardware Group, Inc. is prohibited.

FM803 06/24

14

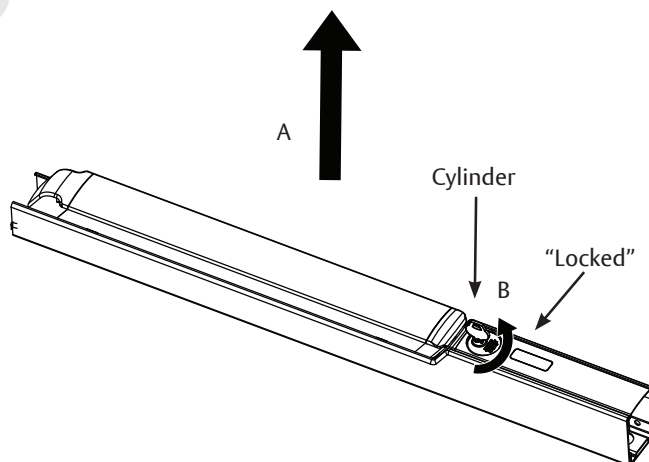

Test the function by (B) turning the key counter clockwise to release dogging. (A) The bar should return to the uncompressed position on its own. "Locked" should display.

15

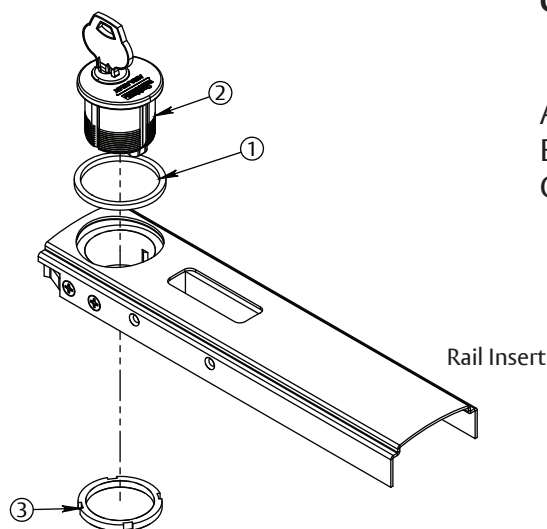

### Cylinder Installation

- A. Install Cylinder Collar (Item 1) as required.
- B. Install Cylinder (Item 2); Note orientation.
- C. Thread on Cylinder Nut from bottom (Item 3).