

The ASSA ABLOY Group is the global leader in access solutions. Every day we help people feel safe, secure and experience a more open world.

NEW Split Frame Design

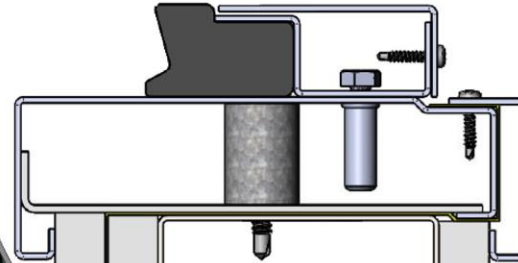

Ceco Door eBook

EMI-RFI/STC Shielding Assembly with Split Frame and Adjustable Seals

About This eBook...

This eBook is intended to provide an overview of the EMI-RFI/STC Shielding Assembly with Split Frame and Adjustable Seals.

To advance to the next slide, click the Green Arrow at the bottom right of the page.

To advance to a different section, click on the desired box at the bottom of the page.



What is an EMI-RFI
Assembly?

Common
Applications

Testing and
Performance

Assembly Construction

Door and Frame

Shielding
Materials

Quoting and
Ordering

Value Proposition

Tools & Resources



What are Adjustable EMI-RFI/STC Shielding Assemblies?

- Electromagnetic Interference (EMI) and Radio Frequency Interference (RFI) reduces electronic signal integrity and strength which can cause poor performance in sensitive communication systems and devices.
- The EMI-RFI/STC Shielding Assembly reduces the possibility of electronic and radio interference by blocking unwanted electromagnetic waves or radiation from interfering with other circuits or devices.
- A conductive enclosure used to block electromagnetic waves and radiation is known as a “Faraday Cage”.
- EMI-RFI/STC Shielding Assemblies help ensure sensitive and confidential information is secure and contained when in shielded rooms or facilities.



What is an EMI-RFI
Assembly?

Common
Applications

Testing and
Performance

Assembly Construction

Door and Frame

Shielding
Materials

Quoting and
Ordering

Value Proposition

Tools & Resources



Public

Common Applications

- Data Centers
- Government / Military Security Centers (SCIF)
- Healthcare Facilities
- Business Offices
- Test Labs
- Emergency Call Centers
- Sensitive Electronic Installations
- Computer Data Processing Security Centers
- Financial Centers
- RFID Scanning Areas



What is an EMI-RFI
Assembly?

Common
Applications

Testing and
Performance

Assembly Construction

Door and Frame

Shielding
Materials

Quoting and
Ordering

Value Proposition

Tools & Resources



Public

Test Methods, Standards and Performance

- Meets or exceeds commonly specified shielding effectiveness ratings in accordance with IEEE-299 such as 60 dB at 10 GHz. Customer must define standard/specification desired, relevant frequencies, and required shielding effectiveness to ensure assembly will meet specified requirements.
- Electromagnetic Interference (EMI) and Radio Frequency Interference (RFI) shielding effectiveness
- Tests were conducted from 9 kHz to 18 GHz per the IEEE 299 standard.
- Intelligence Community Directive (ICD) 705 (Sensitive Compartmented Information Facilities), SCIF (Group 3 and 4 - ICD 705)
- May be used in specific Transient Electromagnetic Pulse Emanation (TEMPEST) standard applications dependent on project requirements which limits electric or electromagnetic radiation

Opening	Lock Type	STC Rating
Singles	Mortise or Cylindrical	Up to STC 50 / SCIF Group 3 and 4 (ICD-705)
Singles	Lockmasters (SCIF)	Up to STC 50 / SCIF Group 3 and 4 (ICD-705)
Pairs	Exit Device	Up to STC 50 / SCIF Group 3 and 4 (ICD-705)



EMI-RFI Shielding Protection Frequencies – IEEE 299

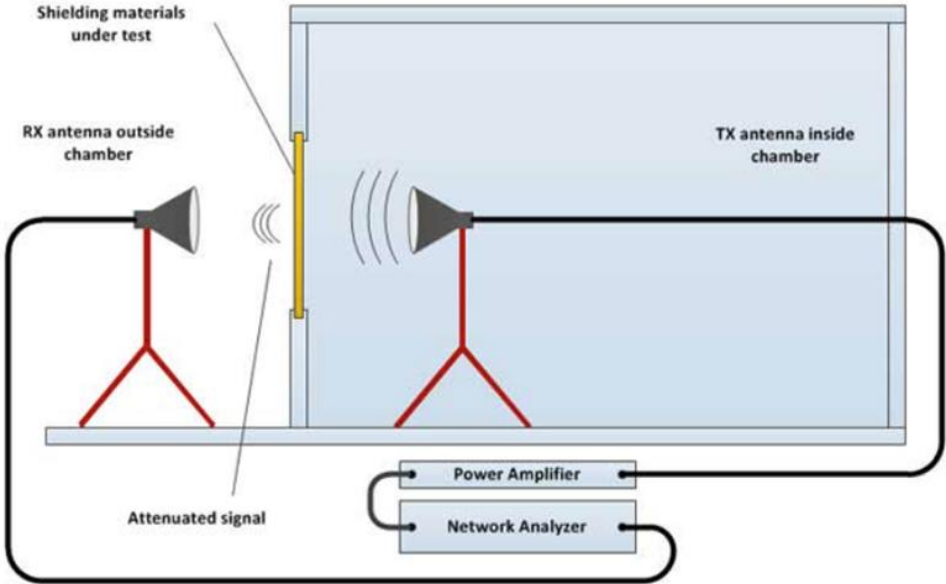
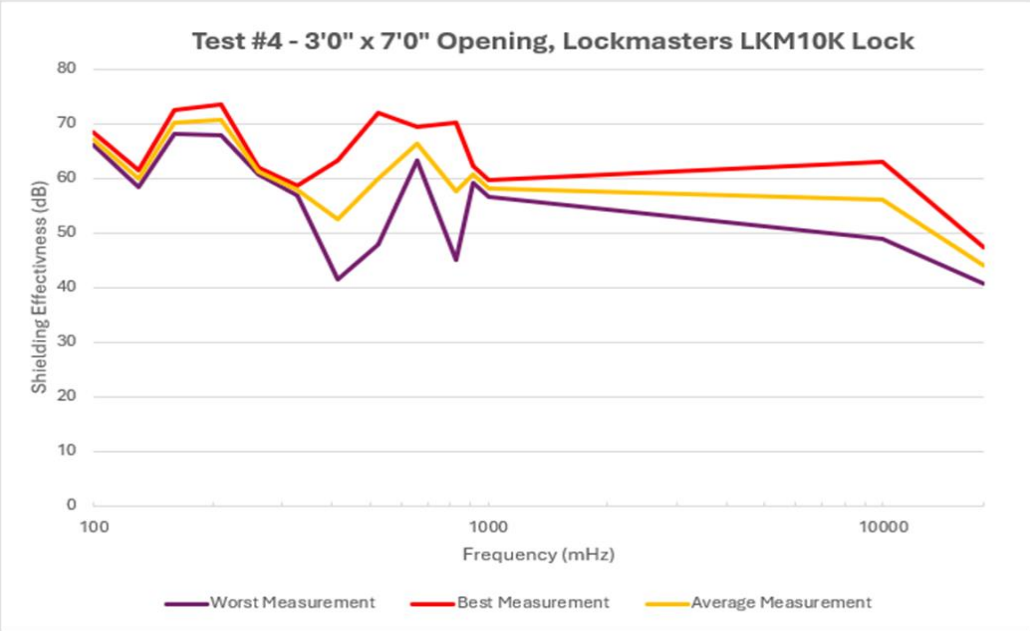

Required Fields:

- Magnetic Field (low frequency): 9 kHz - 16 MHz
- Electric Field (resonant frequency): 20 MHz - 300 MHz
- Plane Wave/Microwave (high frequency): 300 MHz - 18 GHz
- Owner specified dB Shielding Requirements and Frequencies



Adjustable EMI-RFI/STC Shielding protection in compliance with ICD-705 (Group 3 and 4), IEEE 299, TEMPEST requirements

Shielding Protection	Sound Protection	Fire Rated
9 kHz - 18 GHz	STC 50	90 Minute

EMI-RFI/STC Shielding Assembly Construction



- Prime painted EMI-RFI Shielded stainless steel door and split frame
- Locking hardware by others

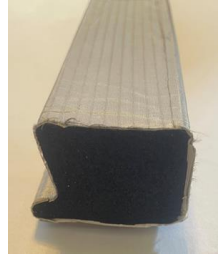

- Adjustable EMI-RFI/STC shielded seals



- Adjustable EMI-RFI/STC shielded door bottom

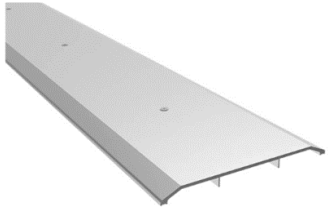

- Aluminum threshold (options for stainless steel)



- McKinney Cam-Lift Hinges



- EMI-RFI copper shielding tape

Note: Use copper tape to fill in any voids or gaps in the shielding mating areas of the wall and frame.



- EMI-RFI shielding conductive caulk

What is an EMI-RFI Assembly?

Common Applications

Testing and Performance

Assembly Construction

Door and Frame

Shielding Materials

Quoting and Ordering

Value Proposition

Tools & Resources



Door Construction



- 1- 3/4" thick door flush only
- 16, 14 or 12 Gauge
- 304 or 316 stainless steel construction prime painted
- #4 and XL blend finishes available
- Fire Rated Assembly - 90 minutes
- Welded seamless edges
- 15 Pounds per square foot
- Singles: 2'0" x 6'8" to 4'0" x 10'0"
- Pairs: 4'0" x 6'8" to 8'0" x 10'0" with fixed or removable hardware mullion
- Reinforced for Cylindrical, Mortise, Exit Device or Lockmaster (SCIF) locking hardware with cam-lift hinges
- Pre-Configured SCIF assemblies (Group 3 and 4) are available in 3'0" x 7'0" sizes and reinforced for Lockmaster hardware

What is an EMI-RFI Assembly?

Common Applications

Testing and Performance

Assembly Construction

Door and Frame

Shielding Materials

Quoting and Ordering

Value Proposition

Tools & Resources



Frame Construction and Anchoring

- Split frame design
- 14 or 12 Gauge
- 304 or 316 stainless steel construction prime painted
- #4 and XL blend finishes available
- 4-7/8"– 14" jamb depths with applied stop and adjustable EMI-RFI/STC compression seals
- Factory welded corners
- Stainless Steel fixed or removable hardware mullion (by others) for pairs
- 4" face head available
- Anchoring options including wood stud, metal stud, existing opening, masonry wire, and masonry T anchors
- Pre-Configured SCIF assemblies (Group 3 and 4) are available in 3'0" x 7'0" sizes with frame depths of 7.25", 7.625" and 9.625"

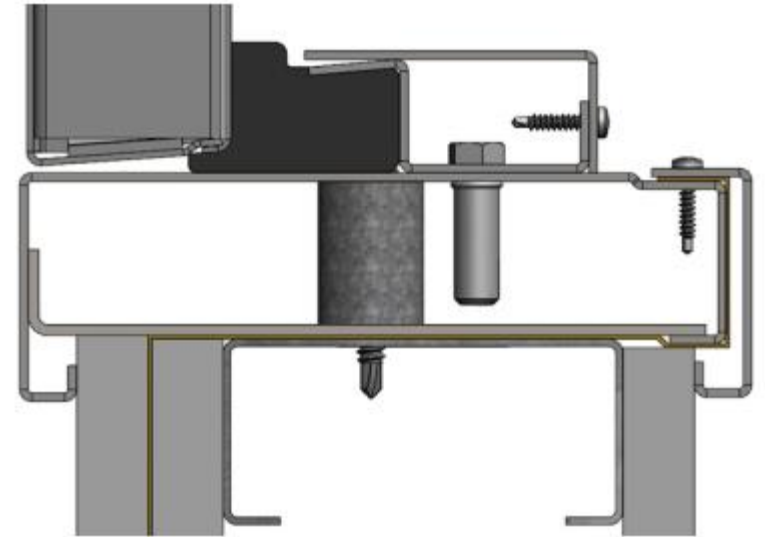

What is an EMI-RFI Assembly?

Common Applications

Testing and Performance

Assembly Construction

Door and Frame

Shielding Materials

Quoting and Ordering

Value Proposition

Tools & Resources



EMI-RFI/STC Shielding Materials

- Each assembly is equipped with adjustable EMI-RFI/STC seals, copper conductive tape, conductive shielding materials and threshold.
- Using the EMI-RFI/STC shielding materials properly during installation for grounding the door, frame, wall, ceiling and floor is critical to maintain proper level of EMI-RFI/STC protection and shielding effectiveness.
- See “Tool’s” section for installation instructions including animation of frame assembly



What is an EMI-RFI
Assembly?

Common
Applications

Testing and
Performance

Assembly Construction

Door and Frame

Shielding
Materials

Quoting and
Ordering

Value Proposition

Tools & Resources



Quoting and Ordering

- To request a quote for the Adjustable EMI-RFI/STC Shielding Assembly use the Quick Quote Form (QQF) for a 24 turnaround.
- Pre-Configured flush 3'0" x 7'0" SCIF or Custom QQFs are available
- Once quoted and ready to order submit a purchase order to:
 - specialtyorders.ceco@assaabloy.com
- See "Tool's" section to access the QQF

Ceco Door Quick Quote Form Rev. 11-02-24

ASSA ABLOY EMI-RFI/STC Shielding Assemblies with Split Frame and Adjustable Seals

ATTENTION: Form must be downloaded and saved to your files before you fill out and submit.

Account #: _____ Job Name: _____ Page: _____ of _____ Government Regulations (choose one) _____

Customer: _____ Job Location: Address: _____ This Quote Is: _____

Contact Person: _____ City: _____ State: _____ Zip: _____

Bid Date: _____

Qty.	Int./Ext.	Single or Pair	Nominal Opening Size (Inches)	Door and Frame Material	Door Gauge	Finish	STC Rating	Fire Rating	Door Elevation	Lock the Door	Frame Gauge	Frame Header	Jamb Depth	Comments:
		Single	36 x 84	Stainless Steel 304	16 Ga.	Factory Primed		90 Min.	Flush	Lockmaster Devices	14 Ga.	2"		

NOTE: 3-Sided frames only; pairs will include mullion

General Notes

- Assembly is equipped with EMI-RFI/STC stainless steel shielding door, EMI-RFI stainless steel frame, seals, conductive sealing materials, threshold, and cam-lift hinges. Please reference installation procedures.
- If door and frame finishing is done on site (by others), the edge of the frame rabbet where the EMI-RFI seals are attached, and door face perimeter of 1" on the push side must remain unfinished.
- Door and frame shall be carefully crated to protect finish on door and frame. Seals will ship with the door in opening specific package(s).
- Frame needs to be grouted or packed full with minimum 10lb density mineral wool.

EMI-RFI Shielding Assemblies meets or exceeds commonly specified shielding effectiveness ratings in accordance with IEEE-299 such as 60 dB at 10 GHz. Customer must define standard/specification desired, relevant frequencies, and required shielding effectiveness to ensure assembly will meet specified requirements.

Opening	Lock	STC Construction
Singles	Lockmasters (SCF)	Up to 50 STC operable

Links

View detailed technical information on the Pre-Configured Specialty Quick Cut Sheet for EMI-RFI/STC Shielded Products

[EMI-RFI/STC Shielded Installation Instructions](#)

[Pre-Configured EMI-RFI/STC Shielded Assembly Split Frame with Adjustable Seal Quick Cut Sheet](#)

[PASASCRF STC 45](#)

[PASASCRF STC 50](#)

Specialty Tool Box

Find links to Specialty Quote Forms, Order Forms, and Cut Sheets on the Specialty Tool Box Promotional Sheet

Forms must be filled in completely for expedited proposal. Missing information will cause delays.

Must save form, then **Submit**

Email completed form to: specialtypricing.ceco@assaabloy.com
Copy your DSS Pricing Administrator

Ceco Door
9155 Telecom Drive | Milan, TN 38358
Specialty Number: (218) 828-6256 ext. 3311
www.cecodoor.com - Specialty Products

Experience a safer and more open world
Ceco is a brand associated with AADC, Inc., an ASSA ABLOY Group company. Copyright © 2024 AADC, Inc. All rights reserved. Reproduction in whole or in part without the express written permission of AADC, Inc. is prohibited.

What is an EMI-RFI Assembly?

Common Applications

Testing and Performance

Assembly Construction

Door and Frame

Shielding Materials

Quoting and Ordering

Value Proposition

Tools & Resources



Value Proposition

- Shields/Reduces electronic, magnetic and radio interference by blocking unwanted electromagnetic waves or radiation from interfering with other circuits or devices in healthcare, commercial or government applications.
- Split frame design for new and retrofit applications including adjustable seal system for EMI-RFI and STC protection.
- Pre-Configured SCIF models for Group 3 (STC 45) and 4 (STC 50) applications 3'0" x 7'0" single openings.
- Ensures sensitive and confidential information is secure and contained when in shielded rooms, Government/Military sites, data centers, and healthcare facilities.
- Meets or exceeds commonly specified shielding effectiveness ratings in accordance with IEEE-299 such as 60 dB at 10 GHz. Customer must define standard/specification desired, relevant frequencies, and required shielding effectiveness to ensure assembly will meet specified requirements.
- May be used in specific Intelligence Community Directive (ICD) 705 (Sensitive Compartmented Information Facilities), SCIF (Group 3 and 4)
- May be used in specific Transient Electromagnetic Pulse Emanation (TEMPEST) standard applications dependent on project requirements which limits electric or electromagnetic radiation.
- Assembly includes door, split frame, adjustable EMI-RFI/STC perimeter seals, adjustable door bottom, copper conductive tape, conductive shielding caulk, cam-lift Hinges and aluminum threshold.

What is an EMI-RFI
Assembly?

Common
Applications

Testing and
Performance

Assembly Construction

Door and Frame

Shielding
Materials

Quoting and
Ordering

Value Proposition

Tools & Resources



Tools

- [Video](#)
- [Fast Facts](#)
- [Announcement](#)
- [Promotional Sheet](#)
- [Infographic](#)
- [Installation Instructions](#)
- [Frequently Asked Questions](#)
- [Tech Data Manual](#)
- Quick Cut Sheets
 - [Pre-Configured SCIF STC 45](#)
 - [Pre-Configured SCIF STC 50](#)
 - [Custom](#)
- Quick Quote Forms
 - [Pre-Configured SCIF STC 45 & 50](#)
 - [Custom](#)

Resources

Technical Support and Assistance

- Specialtyproducts.Techsupport@assaabloy.com

Quotes

- Specialtypricing.ceco@assaabloy.com

Orders

- Specialtyorders.ceco@assaabloy.com



What is an EMI-RFI
Assembly?

Common
Applications

Testing and
Performance

Assembly Construction

Door and Frame

Shielding
Materials

Quoting and
Ordering

Value Proposition

Tools & Resources



Public



Thank you
assaabloydss.com

Experience a safer and more open world

Public