

Soft-closing damper for suspended sliding doors Hermann/SC

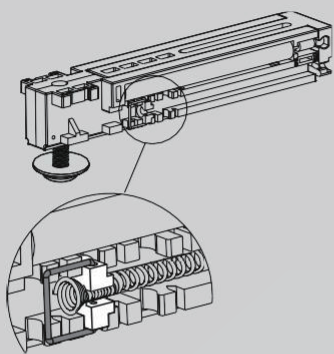

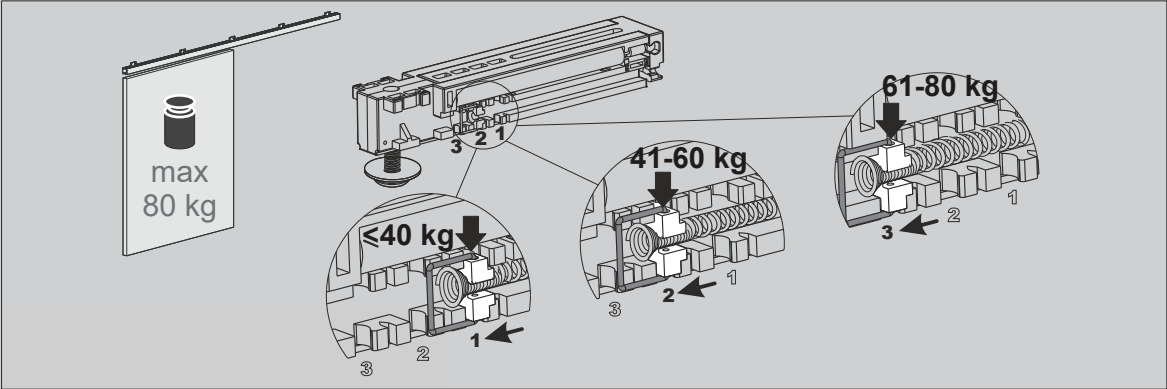

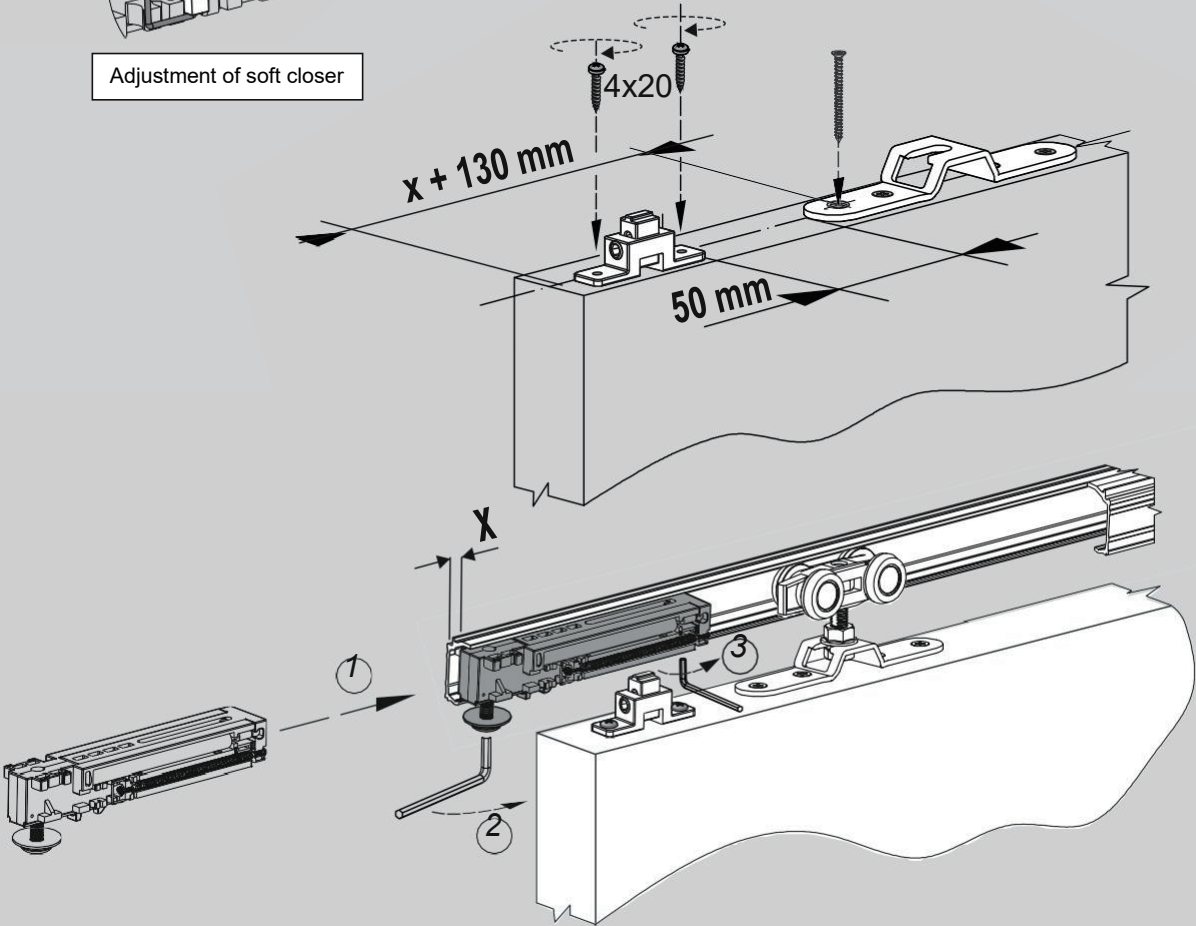

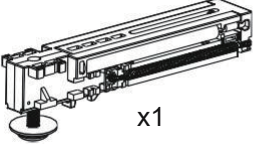

ATTENTION!
When the door is pulled too slow
the soft closer's spring tension
should be increased

ATTENTION!
When the door is pulled too fast
the soft closer's spring tension
should be reduced



COMPONENTS

40kg-80kg			
 x1	 x1	 Ø 4 x 20 x2	 4mm  2,5mm  2mm

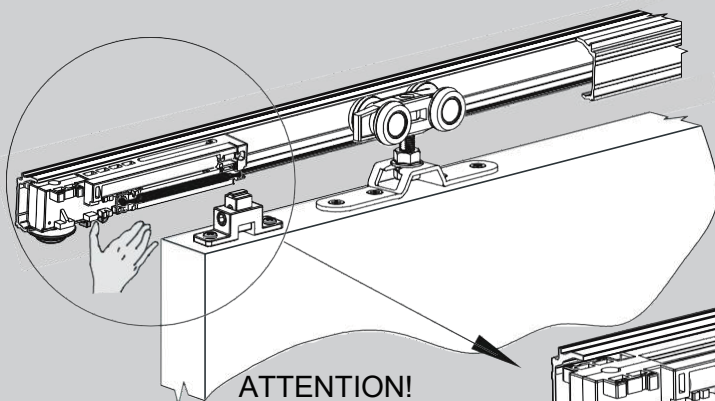

ATTENTION!
Before inserting the
door, pull the soft
closer catch

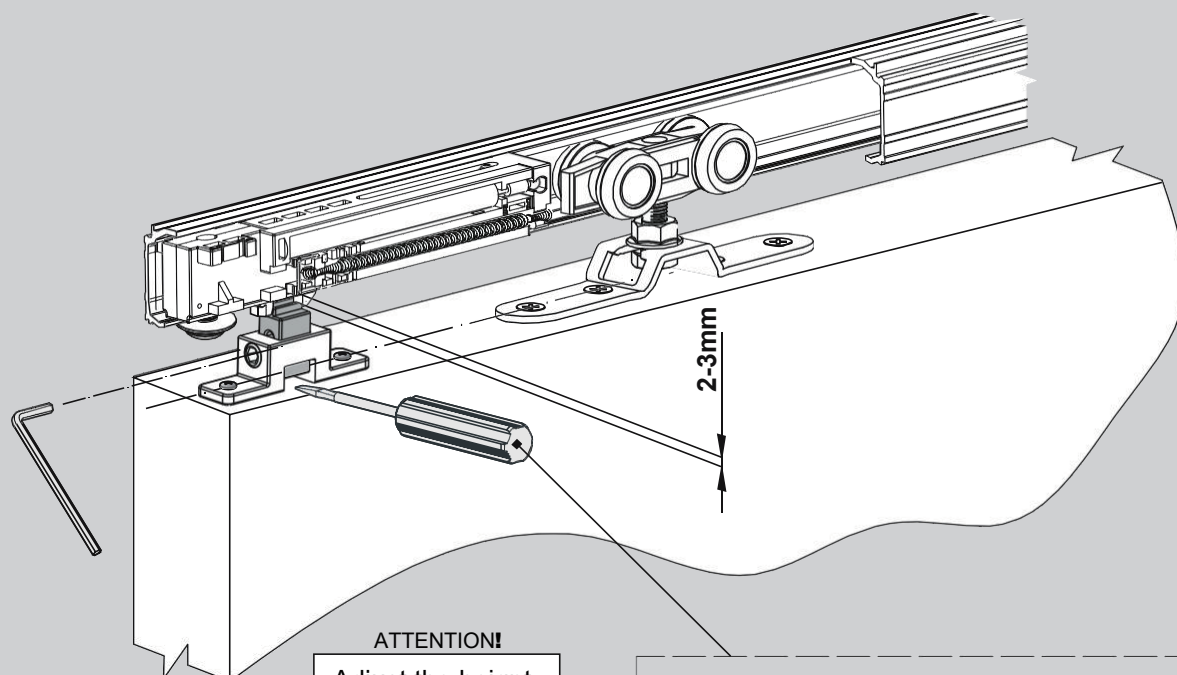
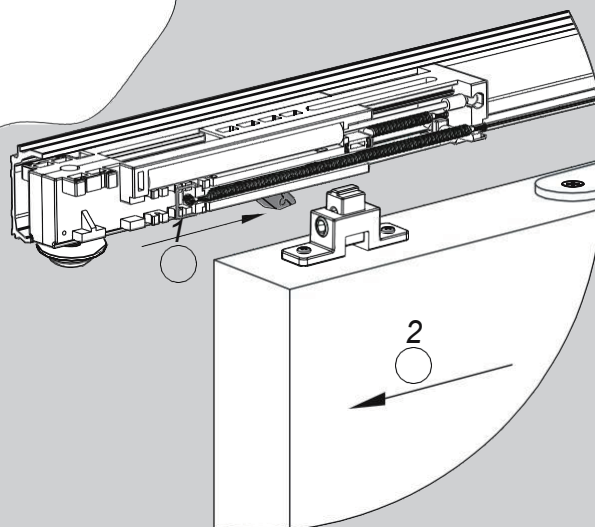

ATTENTION!
Adjust the height
of actuator after
installation.

