

WARNING: Far away from fire!

ENG These instructions are important Read these instructions before use and keep them for future reference. Your child's safety may be affected if you do not follow these instructions. The product must be assembled by an adult only. The product has been tested and complies with EN 1888:1-2018, EN 1888-2-2018 Producer: Abenti: Unit 13 Dawson Road, Milton Keynes, MK1 1LJ, UK

1. Please read this instructions carefully before you use this baby stroller and keep it well for reference. It may bring harm to children if you do not follow instructions
2. Never leave your child unattended. It may be dangerous to leave your unattended
3. Ensure that all the locking devices are engaged before use
4. To avoid injury ensure that your child is kept away when unfolding and folding this product.
5. Do not let your child play with this product.
6. Use a harness as soon as your child can sit unaided.
7. This seat unit is just suitable for baby from 0-36 months.
8. Always use the restraint system.
9. Check that the pram body or seat unit attachment devices are correctly engaged before use.
10. This product is not suitable for running or skating
11. The maximum load of baby stroller is 22KGS, The maximum load of basket is 3KG, Please don't make them overload
12. The backrest must be reclined to the lowest position when stroller is used by baby under 6 month
13. Don't add a mattress thicker than 25MM
14. The parking device shall be engaged when placing and removing the children.
15. Any load attached to the handle and/or on the back of the backrest and/or on the sides of the vehicle will affect the stability of the vehicle.
16. This vehicle is intended for use by one child only.
17. Only replacement parts supplied or recommended by the manufacturer/distributor shall be used.
18. Don't use this stroller on uneven road or near stove.
19. Avoid to use or keep the stroller in wet, cold or high temperature, and far away fire or strong heat
20. Avoid serious injury from falling or sliding out, Secure the child in the harness at all the times

Instruction Manual Abenti - Arezzo

Important-keep these instructions for future reference

Producer: Abenti: Unit 13 Dawson Road, Milton Keynes, MK1 1LJ

Instruction Manual

Abenti - Arezzo

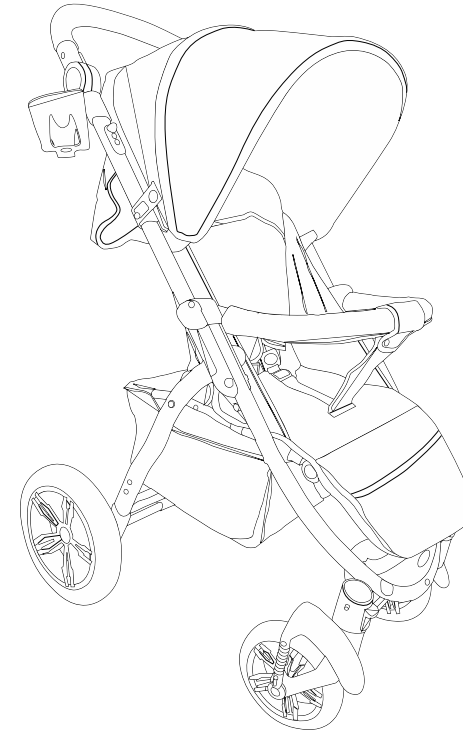

**Important-keep these instructions
for future reference**

Producer: **Abenti: Unit 13 Dawson Road,
Milton Keynes, MK1 1LJ, UK
help@abenti.co.uk**

Maintenance Common sense:

To avoid risk of injury to your baby, please check and maintain the stroller periodically, if fold or unfold not smoothly, check carefully and operate as the instructions specified to avoid unwanted damage. When installing and using, must make sure all parts are completely. Clean woven fabric with brush other than washing. Do not store this stroller or use it in areas exposed to high or low temperature or humidity. Do not use this stroller overload

Parts:

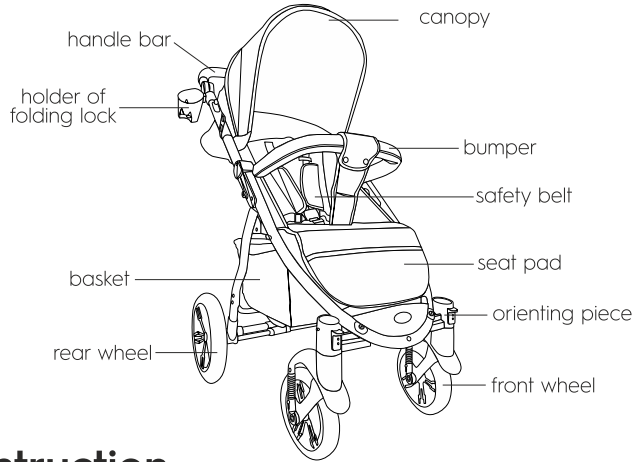

Use instruction

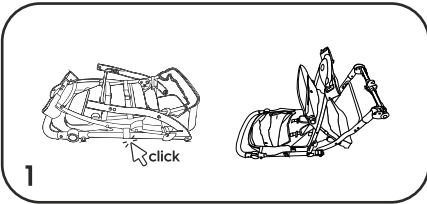

1. Open stroller

Press down the folding lock, and lift up the handle bar by other hand till „click“. The stroller is opened as pic B.

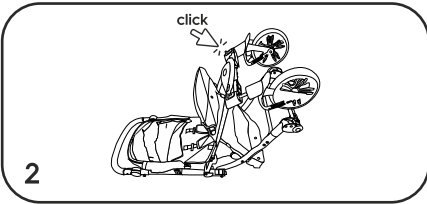

2. Assemble the front wheels

Insert the front wheel set into the wheel houser till „click“ to assemble it and do contrarily to disassemble it.

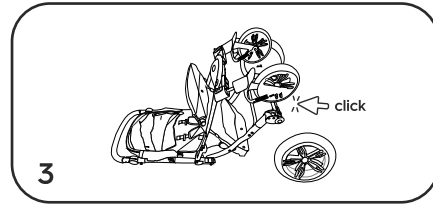

3. Assemble the rear wheels

Insert the rear leg tubes into the holes of the brake set till "click", put the wheel onto the end of the tube, fix the wheel by bolt and put the cover onto the wheel. Do the same to the other side.

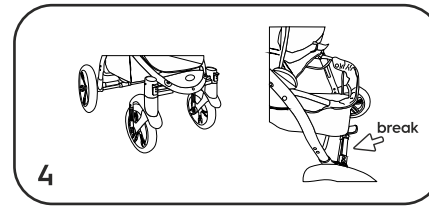

4. Fix front wheels and brake the rear wheels.

Put the orienting piece frontward then lift it up to fix the front wheel for walking straight and press it down to be swivel. Press down the brake tube to park the stroller and put it upward to release it.

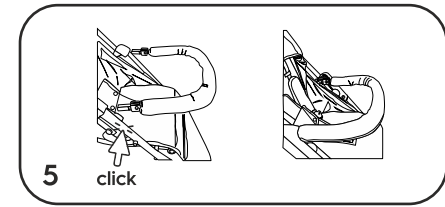

5. Assemble the bumper

Insert the both sides of the bumper into the hole on the stroller till "click" to assemble the bumper. Draw it out while pressing the buttons on both sides of the stroller.

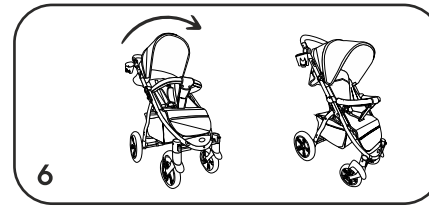

6. Open canopy.

Pull the front of the canopy forward to open it.

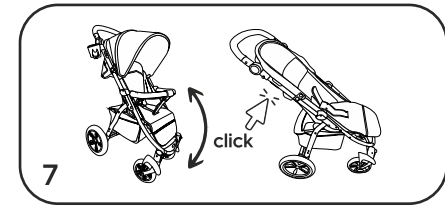

7. Footrest & backrest adjustment

Footrest adjustment: Press the buttons on both sides of the footrest and lift it up or down to the position you want till "click", then release the button. Backrest adjustment; Pull up the pole on the back and adjust the position as you want, then release the pole.

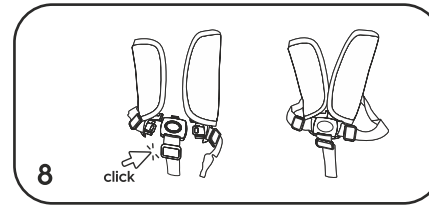

8. The use of safety clasp

Fasten the safety belt: Bring clip together and plug them into the buckle until you hear a "click". Loosen the safety belt: Press the button on the buckle and then pull all the clips out

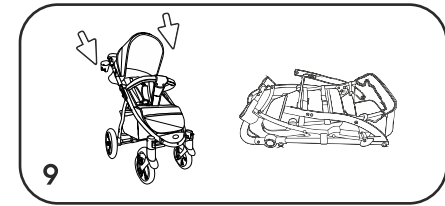

9. Folding

Pull up the folding buttons on both sides of the handle bar, then put the handle forward and down till the auto-lock „click“.