

S5-50/90, S6-65/66/70/75/80/90, 6S-800 /1000/1200 TD/
TO. (Volvo ZTO 1006), 6AS-800/1000TO

Posterior - Neumático
Rear - Pneumatic



Descripción Description

Toma de fuerza reforzada de doble salida, relaciones internas iguales en ambas salidas 1:1,60 o 1:1,95. Montaje en el registro frontal de 4 taladros de la caja de cambios.

Heavy duty Power Take-off, twin output, with same ratios in both outputs 1:1.60 or 1:1.95. Mounting on rear 4 bolts-window of the Gearbox.

Datos Principales (Ambas salidas) Main Data (Both Outputs)

Relación Interna Internal Ratio	160%	195%
Par máximo Max. Torque (Nm)	500	400
Potencia (1000 r.p.m.) Power (HP) 1000 r.p.m	70 C.V // 53 kW	57 C.V // 42 kW
Lado de montaje Mounting position		Posterior Rear
Sentido de giro Rotation direction	Bomba Pump	Derecho ClockWise
	Plato Flange	Izquierdo Anti ClockWise
Peso Weight (Kg)		18
Par máx. cont. (ambas salidas trabajando conjuntamente) Max. Cont. Torque (both outputs working together)		500 Nm
Relación motor - Toma de Fuerza Engine to PTO ratio	ANEXO ATTACHMENT	

Códigos y Combinaciones Part Numbers and Combinations

Tipos de salida Output types	Salida Superior Upper Output	Plato Flange	Plato Flange	Bomba Pump (DIN 5462)	Bomba Pump (DIN 5462)
	Salida Inferior Bottom Output	Plato Flange	Bomba Pump (DIN 5462)	Plato Flange	Bomba Pump (DIN 5462)
160%		1034052	1034051	1034050	1034053*
195%		1035852	1035851	1035850	1035853*

* Peso máximo conjunto de las dos bombas: 20 Kg

* Max. combined weight of the two pumps: 20 Kg

S5-50/90, S6-65/66/70/75/80/90, 6S-800 /1000/1200 TD/
TO. (Volvo ZTO 1006), 6AS-800/1000TO

Posterior - Neumático
Rear - Pneumatic

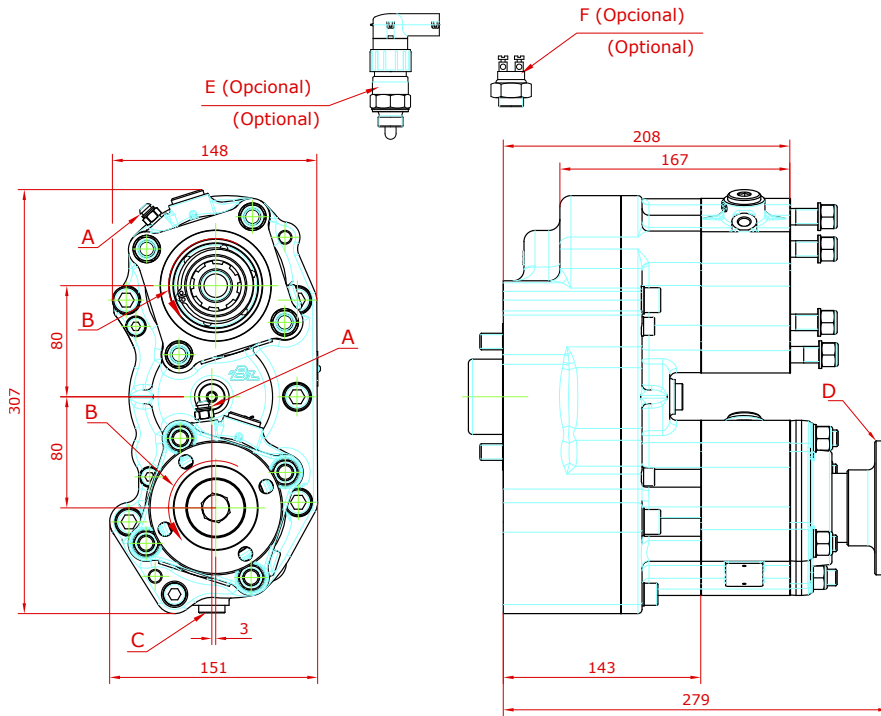

Notas Notes

A	Tomas de aire, rosca 1/8" GAS.	A	Air connection, thread 1/8" BSP
B	Sentido de giro	B	Rotation
C	Tapón de drenaje del aceite	C	Oil drain plug
D	Brida de transmisión	D	Flange drive
E	Interruptores de contacto (9024999)	E	Passing contact switches. P/N 9024999
F	Interruptores neumáticos (100070018)	F	Pressure switches. P/N 100070018

Tipos de Salida Output Types

Adaptador Plato / Flange Adapter

FLANGE TYPE	Part Number	
SAE:	1100	7015504
	1300	7015604
	1400	7015804
DIN:	90	7015704
	100	7015704

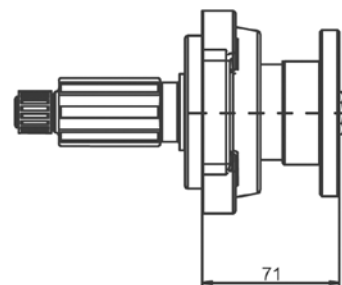
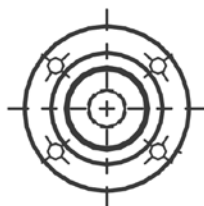

S5-50/90, S6-65/66/70/75/80/90, 6S-800 /1000/1200 TD/
TO. (Volvo ZTO 1006), 6AS-800/1000TO

Posterior - Neumático
Rear - Pneumatic

Anexo I Attachment I

	CAJA GEARBOX	RELACIÓN 1:1,6 RATIO 1:1,6	
S5-50	/ 5.30	1: 1,045	
	/ 5.50	1: 0,984	
	/ 6.20	1: 0,872	
	/ 6.61	1: 0,816	
	/ 6.61+GV80	Larga High	1: 1,019
	/ 5.30	Normal	1: 0,816
	/ 8.02	1: 0,675	
	/ 8.02+GV80/6.20	Larga High	1: 0,872
		Normal	1: 0,674
S5-90GP	/ 13.0	1: 1,600	
	/ A	1: 1,424	
S6-65	/ 6.37	1: 1,040	
	/ 6.70	1: 0,992	
	/ 7.0+GV70/7.67	Larga High	1: 0,730
		Normal	1: 0,584
	/ 7.40	1: 0,899	
	/ 7.52	1: 0,888	
	/ 9.00	1: 0,739	
	/ 7.97+GV80/6.70	Larga High	1: 0,992
		Normal	1: 0,840
		/ 9.00+GV80/6.70	Larga High
		Normal	1: 0,739
	/ 9.00+GV80/7.52	Larga High	1: 0,886
		Normal	1: 0,739
S6-66	/ 7.36-1.0	1: 0,835	
	/ 9.06-1.0	1: 0,666	
S6-70	/ 6.8	1: 0,822	
	/ 6.8+GV70/5.71	Larga High	1: 0,979
		Normal	1: 0,822
	/ 7.36	1: 0,765	
	/ 7.92	1: 0,706	
	/ 9.03	1: 0,619	
	/ 9.59	1: 0,584	
S6-75	/ 6.70+GV80/7.52	Normal	1: 0,992
		Corta Low	1: 0,886
S6-80	/ 5.03	1: 1,248	
	/ 5.66	1: 1,184	

	CAJA GEARBOX	RELACIÓN 1:1,6 RATIO 1:1,6	
S6-80	/ 5.66+GV80/7.52	Larga High	1: 1,181
		Normal	1: 0,890
	/ 6.10	1: 1,101	
	/ 6.7	1: 0,992	
	/ 6.7+GV80/5.30	Larga High	1: 1,259
		Normal	1: 0,992
	/ 6.90	1: 0,824	
	/ 7.35	1: 0,883	
	/ 7.41	1: 0,901	
	/ 7.53	1: 0,888	
	/ 7.67	1: 0,864	
	/ 7.67+GV80/6.7	Larga High	1: 0,995
		Normal	1: 0,869
	/ 7.90	1: 0,840	
	/ 9.00	1: 0,736	
S6-90	/ 9.00+GV80/5.30	Larga High	1: 1,259
		Normal	1: 0,739
	/ 9.00+GV80/7.48	Larga High	1: 0,899
		Normal	1: 0,739
	/ 9.00+GV80/7.52	Larga High	1: 0,886
		Normal	1: 0,739
	/ 5.67	1: 1,200	
	/ 5.74	1: 1,184	
	/ 6.37	1: 1,184	
	/ 6.98	1: 0,979	
	/ 7.03	1: 0,965	
	/ 7.03+GV90/5.67	Larga High	1: 1,200
		Normal	1: 0,965
	/ 7.03+GV90/5.74	Larga High	1: 1,176
		Normal	1: 0,960
/ 7.40	1: 0,920		
/ 9.01	1: 0,752		
/ 9.01+GV90/7.40	Larga High	1: 0,917	
	Normal	1: 0,754	
	6S800TO/6.58-0.78 (VOLVO ZTO 1006)	1: 0,848	
	6S1000TO/6.75 - 0.78		
	6S1200TD/7.72 - 1.00	1: 0,864	
	6S1200TO/6.75 - 0.83	1: 0,992	
	6AS1000TO/6.75 - 0.78		
	6AS800TO/6.58 - 0.78	1: 0,848	
	6S1005TO/6.75 - 0.78		

S5-50/90, S6-65/66/70/75/80/90, 6S-800 /1000/1200 TD/
TO. (Volvo ZTO 1006), 6AS-800/1000TO

Posterior - Neumático

Rear - Pneumatic

Anexo II Attachment II

	CAJA GEARBOX	RELACIÓN 1:1,95 RATIO 1:1,95	
S5-50	/ 5.30	1: 1,273	
	/ 5.50	1: 1,199	
	/ 6.20	1: 1,063	
	/ 6.61	1: 0,995	
	/ 6.61+GV80	Larga High	1: 1,242
	/ 5.30	Normal	1: 0,995
	/ 8.02	1: 0,823	
	/ 8.02+GV80/6.20	Larga High	1: 1,063
		Normal	1: 0,821
S5-90GP	/ 13.0	1: 1,950	
	/ A	1: 1,736	
S6-65	/ 6.37	1: 1,268	
	/ 6.70	1: 1,209	
	/ 7.0+GV70/7.67	Larga High	1: 0,889
		Normal	1: 0,712
	/ 7.40	1: 1,096	
	/ 7.52	1: 1,082	
	/ 9.00	1: 0,901	
	/ 7.97+GV80/6.70	Larga High	1: 1,209
		Normal	1: 1,024
	/ 9.00+GV80/6.70	Larga High	1: 1,209
		Normal	1: 0,901
		/ 9.00+GV80/7.52	Larga High
		Normal	1: 0,901
S6-66	/ 7.36-1.0	1: 1,018	
	/ 9.06-1.0	1: 0,811	
S6-70	/ 6.8	1: 1,002	
	/ 6.8+GV70/5.71	Larga High	1: 1,193
		Normal	1: 1,002
	/ 7.36	1: 0,932	
	/ 7.92	1: 0,860	
	/ 9.03	1: 0,755	
	/ 9.59	1: 0,712	
S6-75	/ 6.70+GV80/7.52	Normal	1: 1,209
		Corta Low	1: 1,080
S6-80	/ 5.03	1: 1,521	
	/ 5.66	1: 1,443	

	CAJA GEARBOX	RELACIÓN 1:1,95 RATIO 1:1,95	
S6-80	/ 5.66+GV80/7.52	Larga High	1: 1,439
		Normal	1: 1,084
	/ 6.10	1: 1,342	
	/ 6.7	1: 1,209	
	/ 6.7+GV80/5.30	Larga High	1: 1,535
		Normal	1: 1,209
	/ 6.90	1: 1,004	
	/ 7.35	1: 1,076	
	/ 7.41	1: 1,098	
	/ 7.53	1: 1,082	
	/ 7.67	1: 1,053	
	/ 7.67+GV80/6.7	Larga High	1: 1,213
		Normal	1: 1,059
	/ 7.90	1: 1,024	
	/ 9.00	1: 0,897	
		/ 9.00+GV80/5.30	Larga High
		Normal	1: 0,901
	/ 9.00+GV80/7.48	Larga High	1: 1,096
		Normal	1: 0,901
	/ 9.00+GV80/7.52	Larga High	1: 1,080
		Normal	1: 0,901
S6-90	/5.67	1: 1,463	
	/5.74	1: 1,443	
	/6.37	1: 1,193	
	/6.98	1: 1,176	
	/7.03	1: 1,176	
	/ 7.03+GV90/5.67	Larga High	1: 1,463
		Normal	1: 1,176
	/ 7.03+GV90/5.74	Larga High	1: 1,433
		Normal	1: 1,170
	/7.40	1: 1,121	
	/ 9.01	1: 0,917	
		/ 9.01+GV90/7.40	Larga High
		Normal	1: 0,918
	6S800TO/6.58-0.78 (VOLVO ZTO 1006)	1: 1,034	
	6S1000TO/6.75 - 0.78		
	6S1200TD/7.72 - 1.00	1: 1,053	
	6S1200TO/6.75 - 0.83	1: 1,209	
	6AS1000TO/6.75 - 0.78		
	6AS800TO/6.58 - 0.78	1,034	
	6S1005TO/6.75 - 0.78		