

CAN-AM ON-ROAD KIT - Adjustable Driver Backrest

Product: **Can-Am On-Road**
Project no: **487803209**
Instruction Sheet P/N: **487803209**
Revision no:
Revision date:
Item covered: **Adjustable Driver Backrest**

The following symbols may be used in this document:

WARNING

Indicates a hazardous situation which, if not avoided, could result in death or serious injury.

 CAUTION: Indicates a hazard situation which, if not avoided, could result in minor or moderate injury.

NOTICE Indicates an instruction which, if not followed, could severely damage vehicle components or other property.

WARNING

- This kit is designed for specific applicable models only (authorized BRP dealers will confirm model(s)). It is not recommended for units other than the one (those) for which it was sold.

- Should removal of a locking device (e.g. lock tabs, self-locking fasteners, etc.) be required when undergoing disassembly/ assembly, always replace with a new one.

- Torque wrench tightening specifications must strictly be adhered to.

- Always wear EYE PROTECTION AND APPROPRIATE GLOVES when using power tools.

- Unless otherwise specified, engine must be OFF when performing any operation on the vehicle.

- Always be aware of parts that can move, such as wheels, transmission components, etc.

WARNING

Some important safety information and/or operating instructions dedicated to the end user might be included in this instruction sheet. Make sure to give the kit part number as well as the instruction sheet included with this kit to the customer. Verify that the customer has access to all the information required for proper use of the accessory.

NOTE: USE TIGHTENING TORQUES IN THE FOLLOWING TABLE IF NOT OTHERWISE SPECIFIED.

GRADE

	5.8	8.8	10.9	12.9
M4	$1.8 \pm 0.2 \text{ N}\cdot\text{m}$ (16 \pm 2 lbf•in)	$2.8 \pm 0.2 \text{ N}\cdot\text{m}$ (25 \pm 2 lbf•in)	$3.8 \pm 0.2 \text{ N}\cdot\text{m}$ (34 \pm 2 lbf•in)	$4.5 \pm 0.5 \text{ N}\cdot\text{m}$ (40 \pm 4 lbf•in)
M5	$3.3 \pm 0.2 \text{ N}\cdot\text{m}$ (29 \pm 2 lbf•in)	$5 \pm 0.5 \text{ N}\cdot\text{m}$ (44 \pm 4 lbf•in)	$7.8 \pm 0.7 \text{ N}\cdot\text{m}$ (69 \pm 6 lbf•in)	$9 \pm 1 \text{ N}\cdot\text{m}$ (80 \pm 9 lbf•in)
M6	$7.5 \pm 1 \text{ N}\cdot\text{m}$ (66 \pm 9 lbf•in)	$10 \pm 2 \text{ N}\cdot\text{m}$ (89 \pm 18 lbf•in)	$12.8 \pm 2.2 \text{ N}\cdot\text{m}$ (113 \pm 19 lbf•in)	$16 \pm 2 \text{ N}\cdot\text{m}$ (142 \pm 18 lbf•in)
M8	$15.3 \pm 1.7 \text{ N}\cdot\text{m}$ (135 \pm 15 lbf•in)	$24.5 \pm 3.5 \text{ N}\cdot\text{m}$ (18 \pm 3 lbf•ft)	$31.5 \pm 3.5 \text{ N}\cdot\text{m}$ (23 \pm 3 lbf•ft)	$40 \pm 5 \text{ N}\cdot\text{m}$ (30 \pm 4 lbf•ft)

M10	29 ± 3 N•m (21 ± 2 lbf•ft)	48 ± 6 N•m (35 ± 4 lbf•ft)	61 ± 9 N•m (45 ± 7 lbf•ft)	73 ± 7 N•m (54 ± 5 lbf•ft)
M12	52 ± 6 N•m (38 ± 4 lbf•ft)	85 ± 10 N•m (63 ± 7 lbf•ft)	105 ± 15 N•m (77 ± 11 lbf•ft)	128 ± 17 N•m (94 ± 13 lbf•ft)
M14	85 ± 10 N•m (63 ± 7 lbf•ft)	135 ± 15 N•m (100 ± 11 lbf•ft)	170 ± 20 N•m (125 ± 15 lbf•ft)	200 ± 25 N•m (148 ± 18 lbf•ft)
M16	126 ± 14 N•m (93 ± 10 lbf•ft)	205 ± 25 N•m (151 ± 18 lbf•ft)	255 ± 30 N•m (188 ± 22 lbf•ft)	305 ± 35 N•m (225 ± 26 lbf•ft)
M18	170 ± 20 N•m (125 ± 15 lbf•ft)	273 ± 32 N•m (201 ± 24 lbf•ft)	330 ± 25 N•m (243 ± 18 lbf•ft)	413 ± 47 N•m (305 ± 35 lbf•ft)

The illustrations in this document show typical construction of the different assemblies and may not reproduce the full detail or exact shape of the parts; however, they represent parts that have the same or similar function.

Installation time is approximately 0.5 hour.
parts to be installed

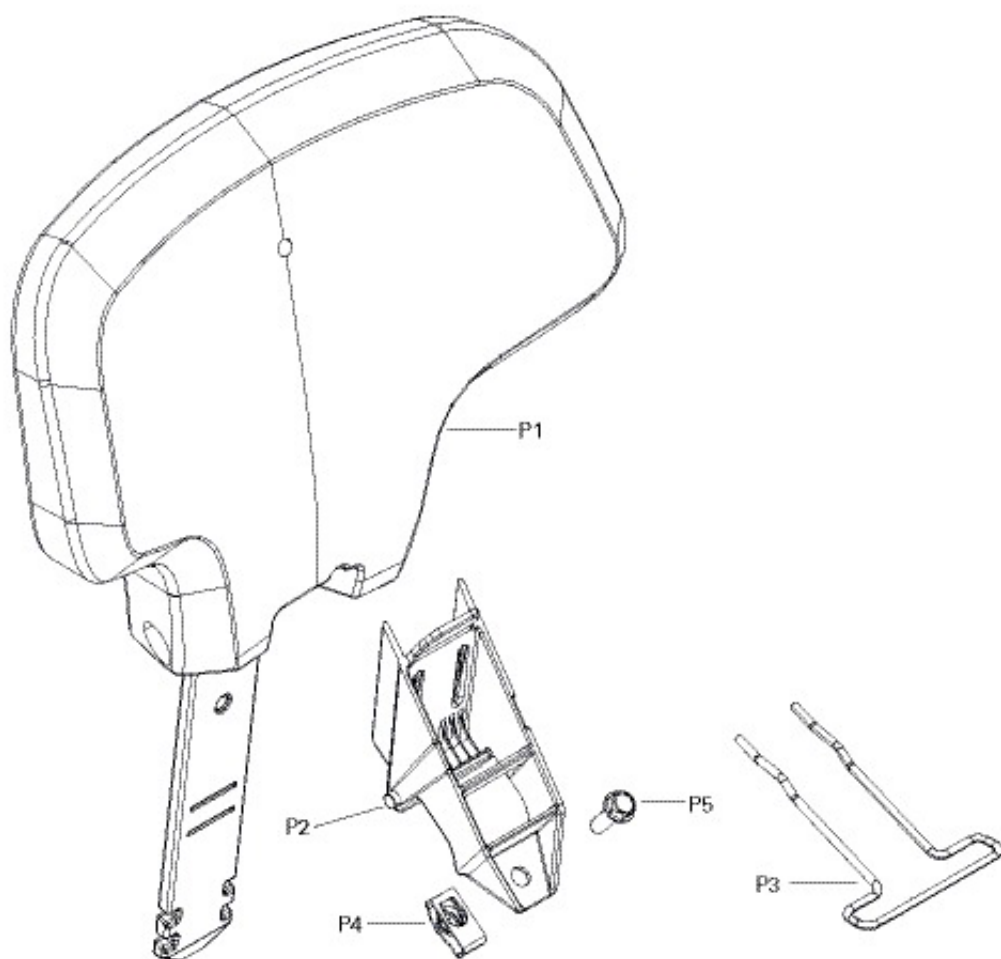

ITEM	DESCRIPTION	Part number	QTY
P1	Removable Driver Backrest	Not available separately	1
P2	Slider	708001678	1
P3	Latch Rod	708003188	1
P4	M6 X 1 Panel Nut	250000048	1
P5	M6 X 20 Flanged Hex. Screw	210262050	1

instructions

Vehicle Preparation

Lift driver seat and remove passenger seat. Refer to SHOP MANUAL.

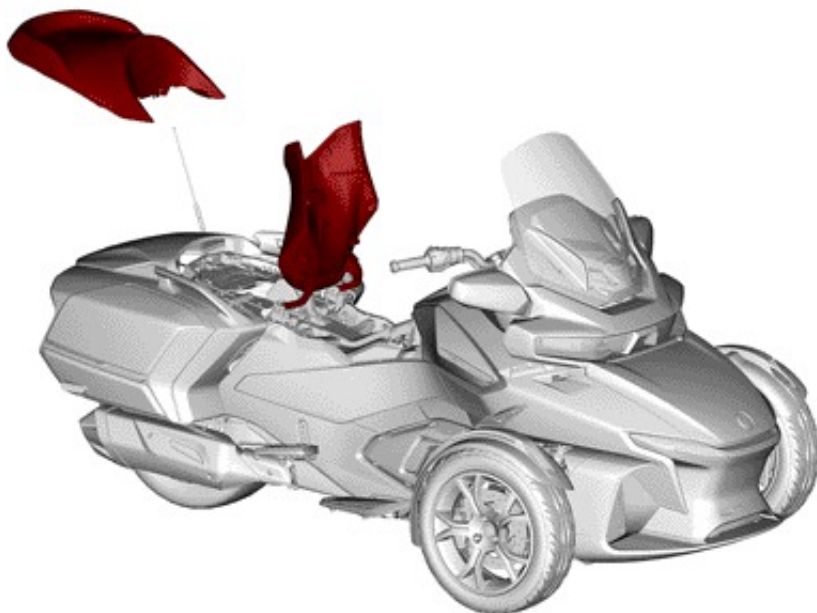

Part Installation

1. Install latch rod [P3] and panel nut [P4].

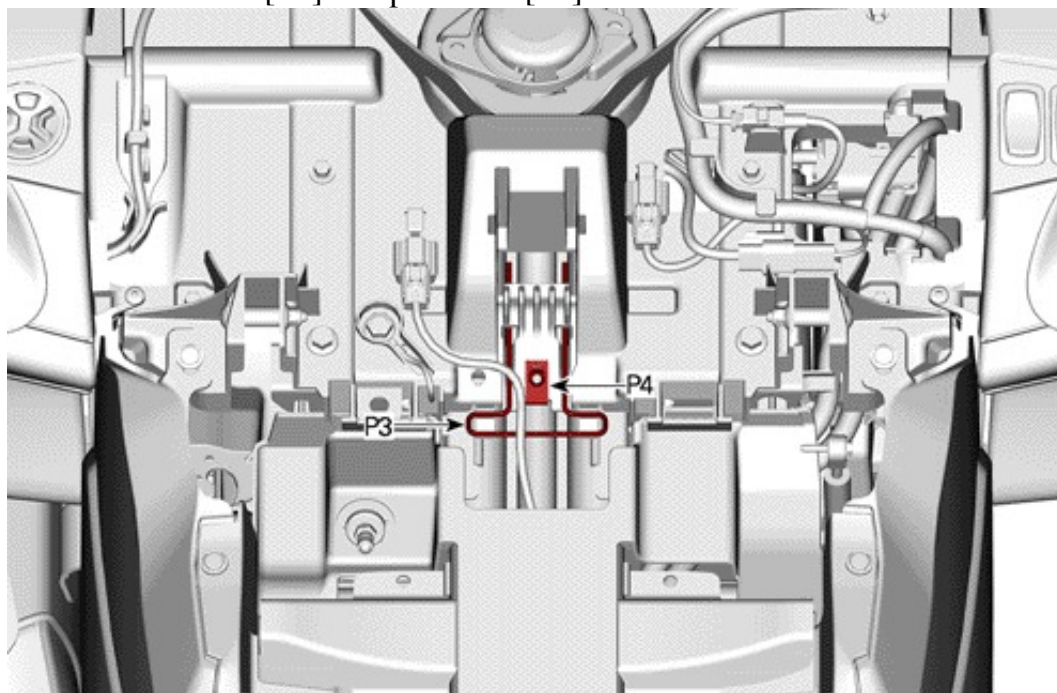

Driver seat hidden for clarity

2. Install slider [P2].

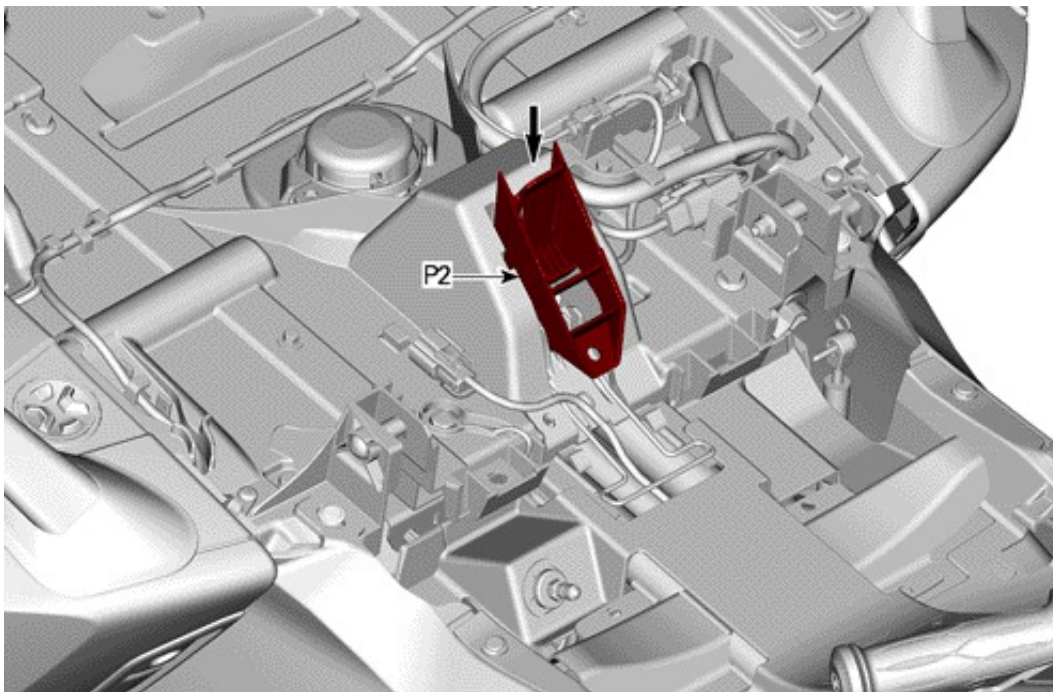

3. Secure slider with M6 X 20 flanged hex. screw [P5]. Tighten to specification.

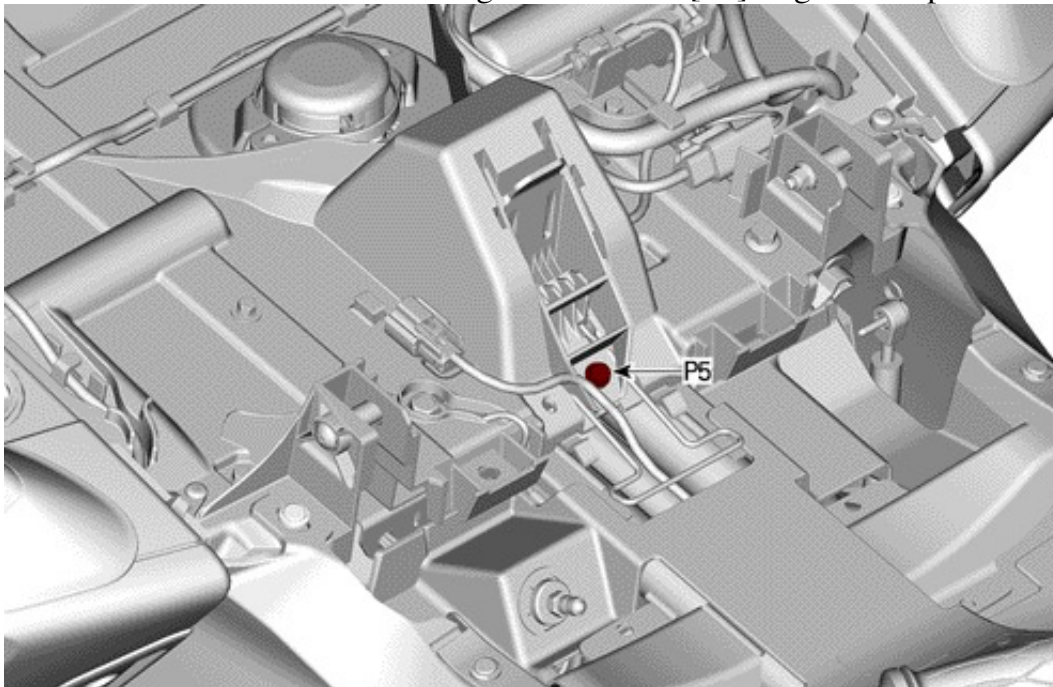

tightening torque

M6 X 20 Flanged Hex. Screw [P5]

$4.5 \pm 0.5 \text{ N}\cdot\text{m}$ ($40 \pm 4 \text{ lbf}\cdot\text{in}$)

4. Install passenger seat and lower backrest [P1] in slot.

NOTE: The backrest has two height positions. Make sure the backrest is properly positioned in one of the two positions.

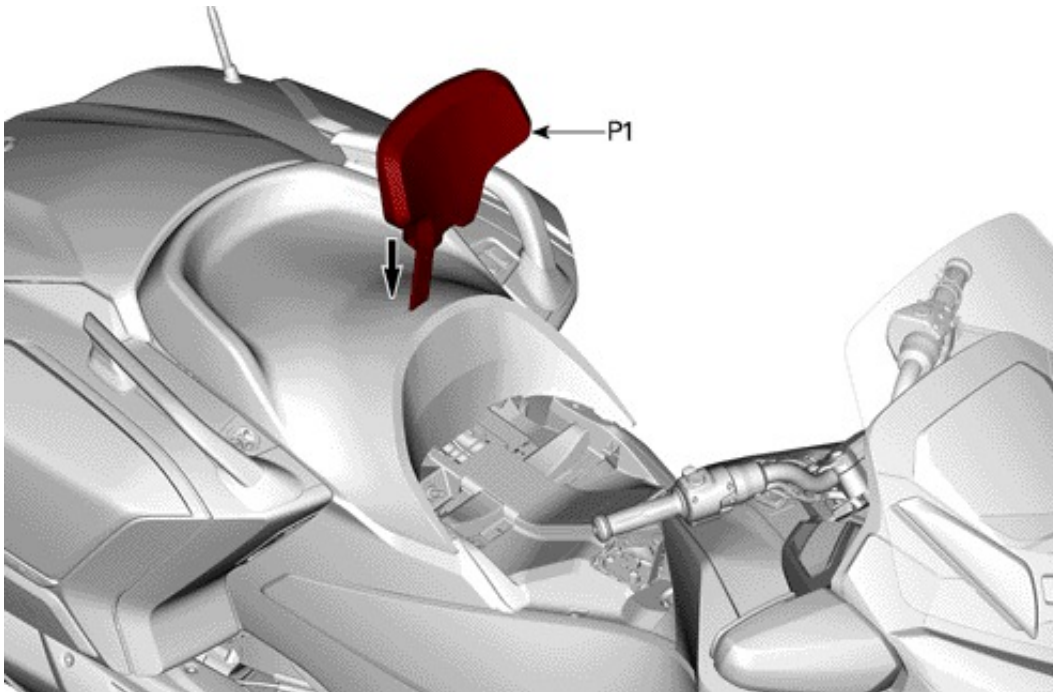

5. Push latch rod [P3] to secure backrest in place.

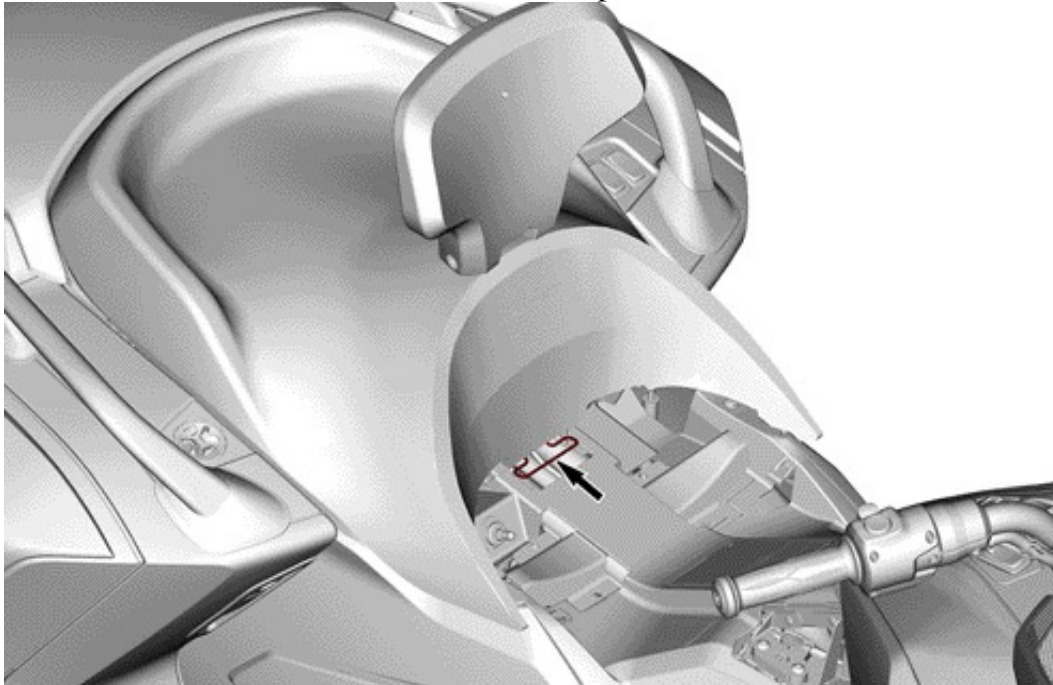

Backrest Adjustment

Tilt forward the backrest and turn adjustment screw to adjust the backrest angle in the desired position.

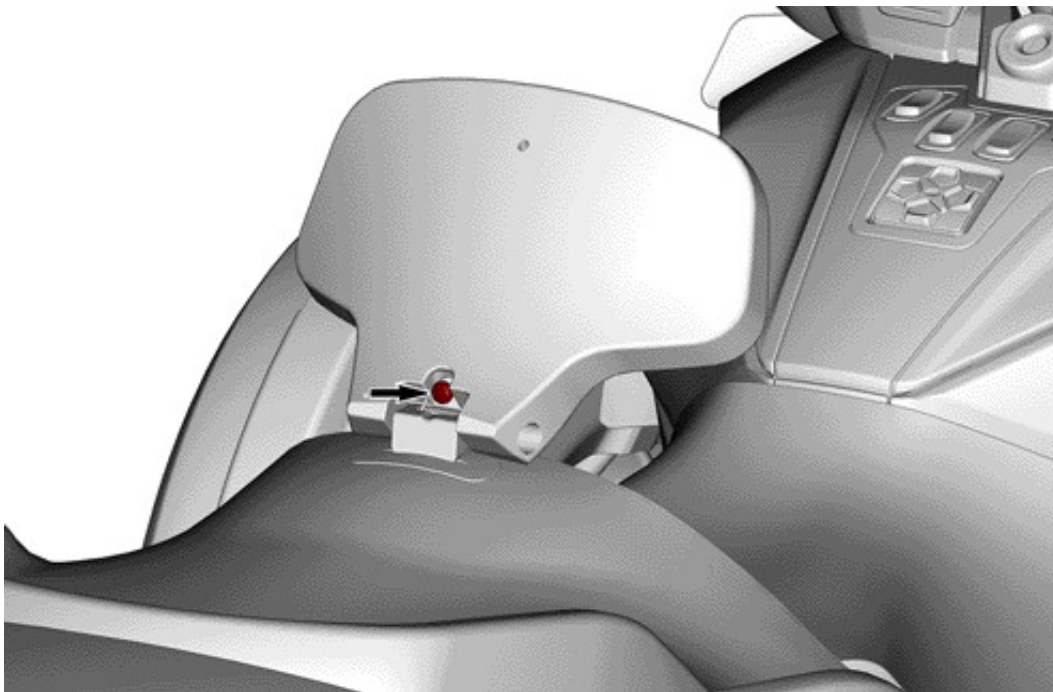

Backrest Removal

Lift the driver's seat and pull latch rod forward to unlock the backrest.
Lift backrest and push back the latch rod.

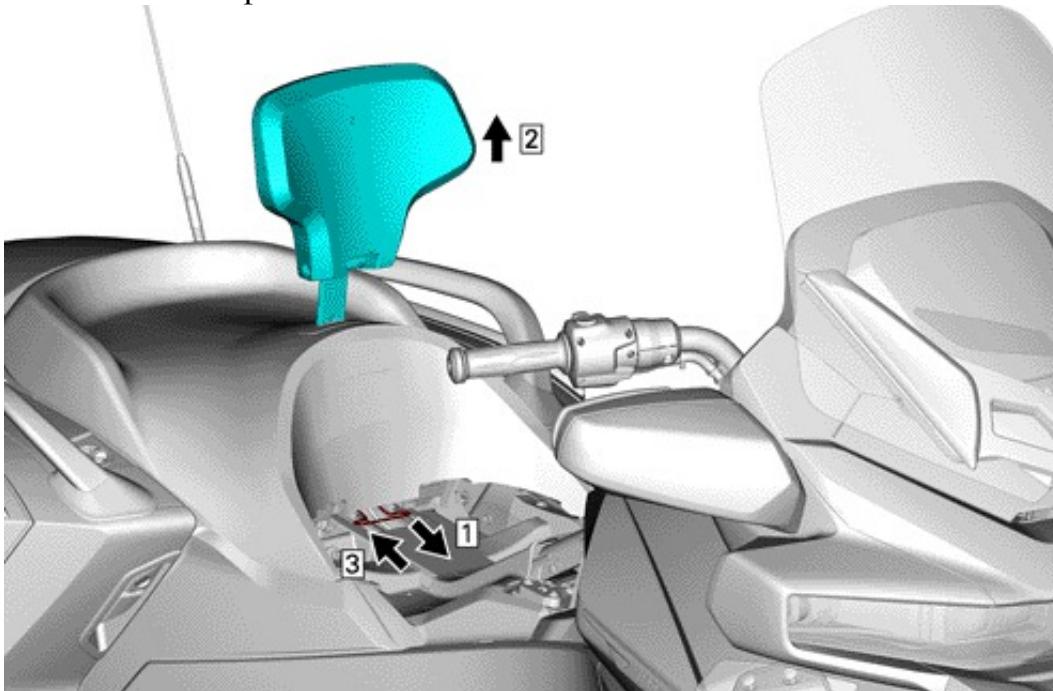

Step 1: Pull latch rod forward to unlock

Step 2: Lift backrest

Step 3: Push back the latch rod