

**Product consists of watch strap, buckle, pin**



Slowly insert one end of the strap into the connection of the watch core, then press your finger in the direction of the arrow with a little force, and slowly slide the strap to install it on the watch core



**Install the other end of the strap in the same way, and make sure it is not loose after installation**

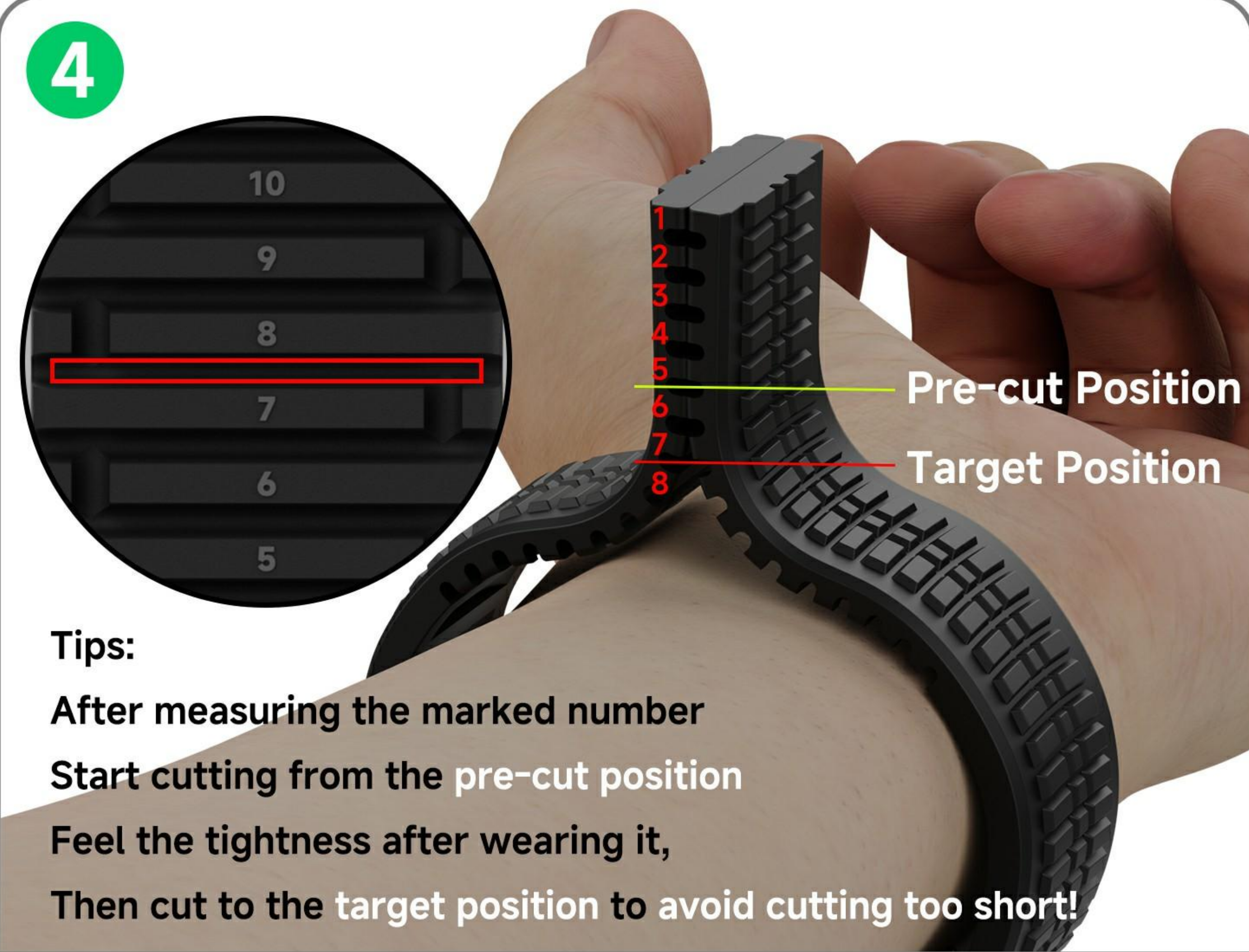

Pinch the end of the strap with your fingers to keep the straps overlapped, select the first part that is not overlapped, As target cutting position

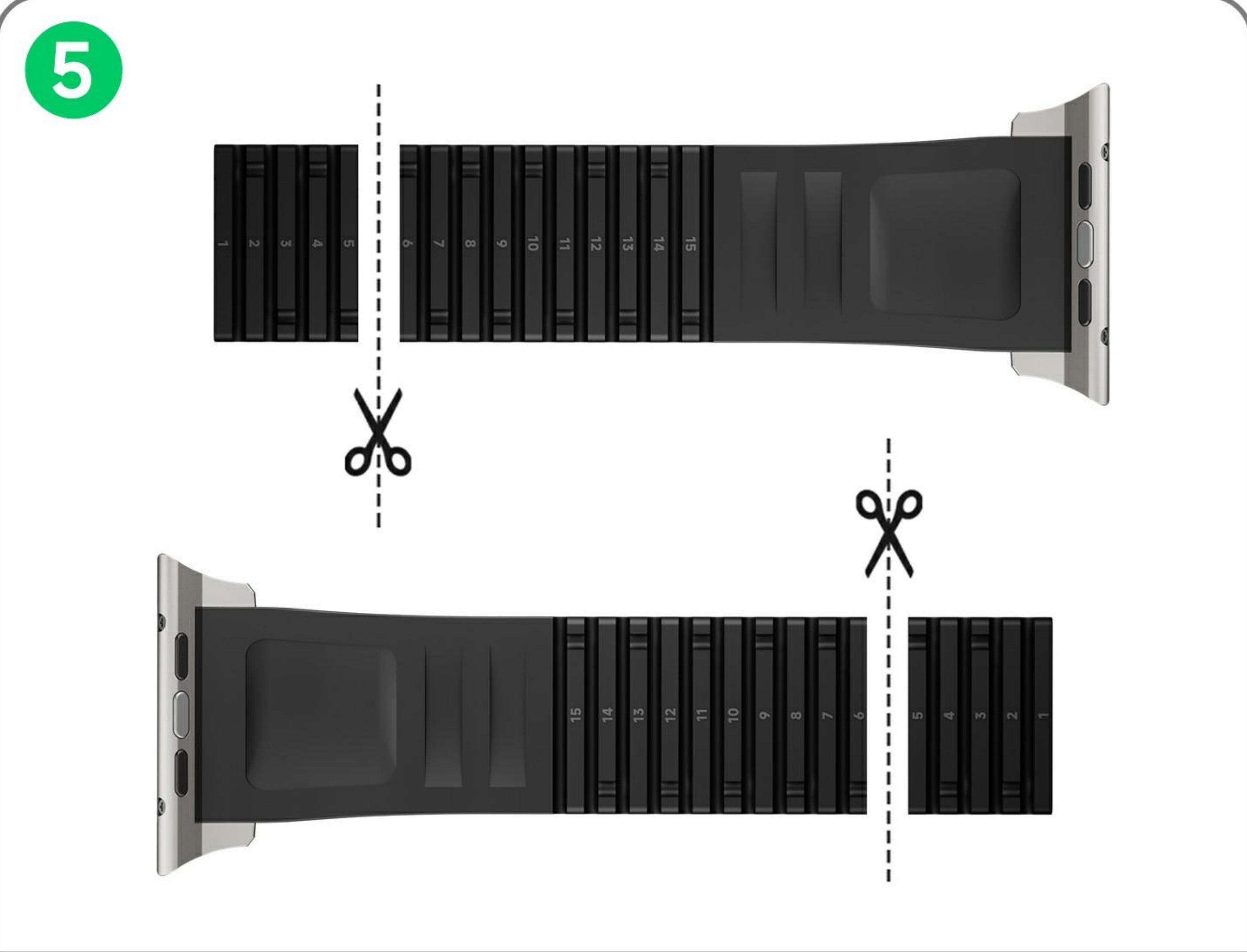

**Use a utility knife or scissors to cut both straps at the pre-cut position**

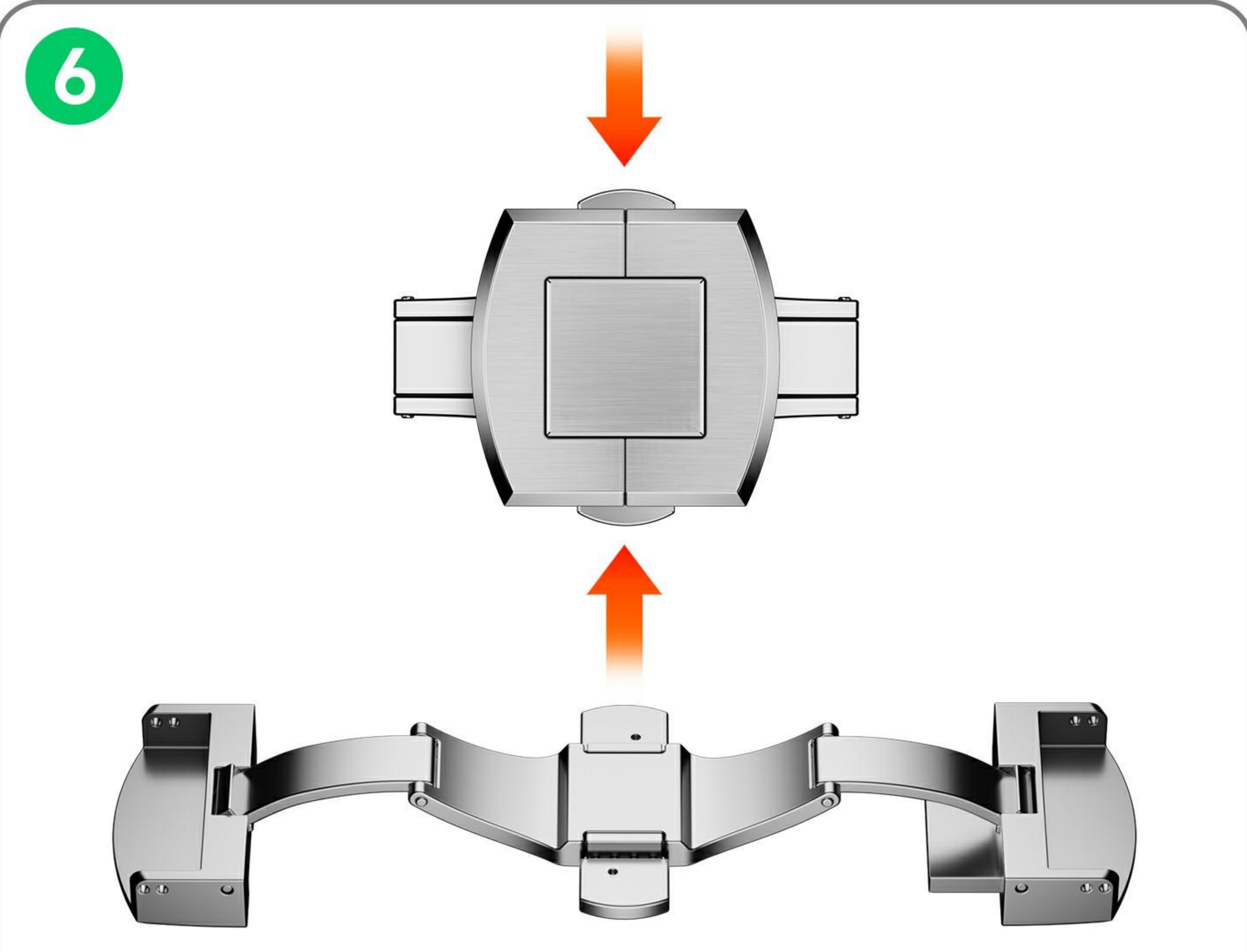

**Press the direction of the arrow to unfold the buckle**

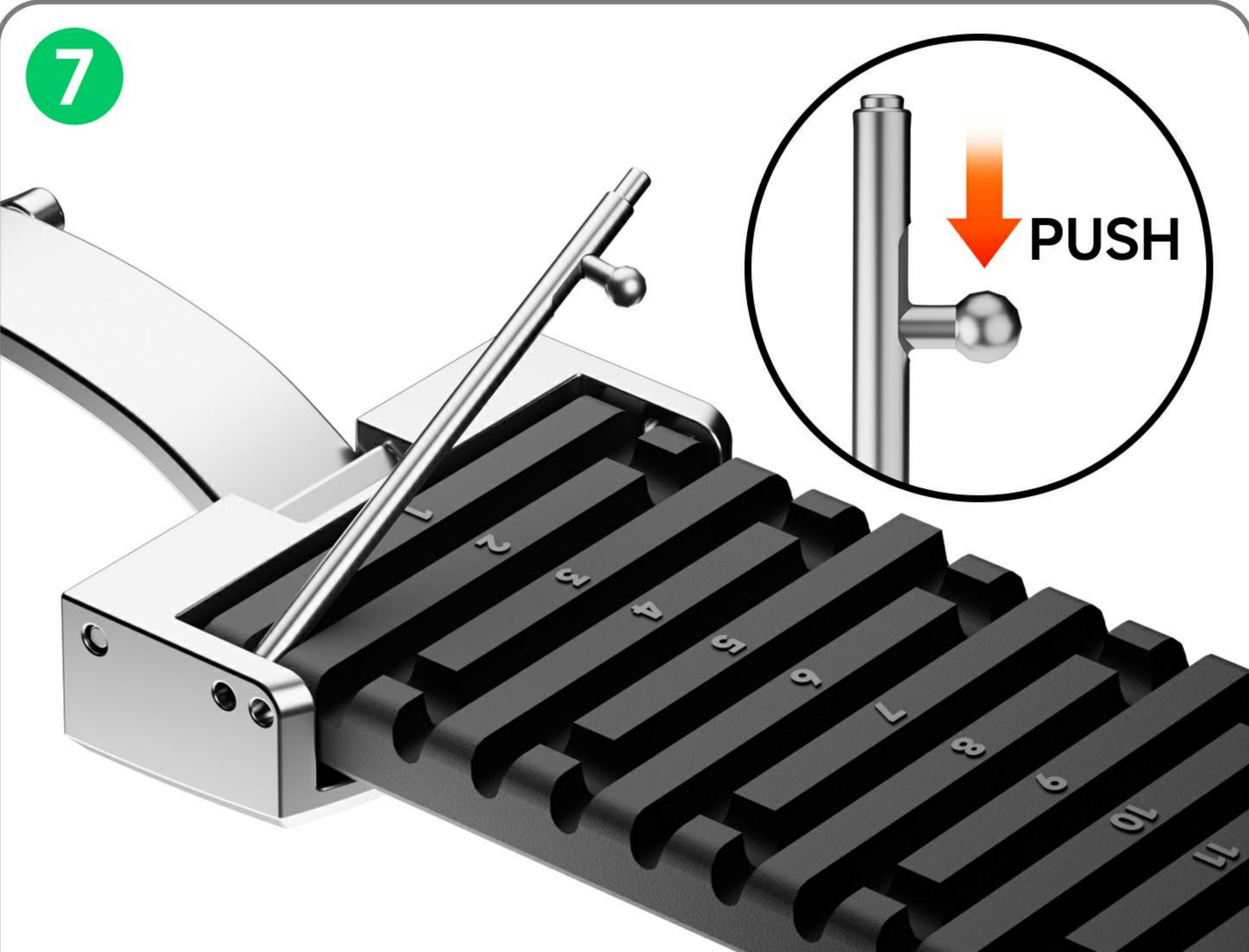

As shown in the picture, first insert one end of the pin into the watch buckle Then press the switch to install

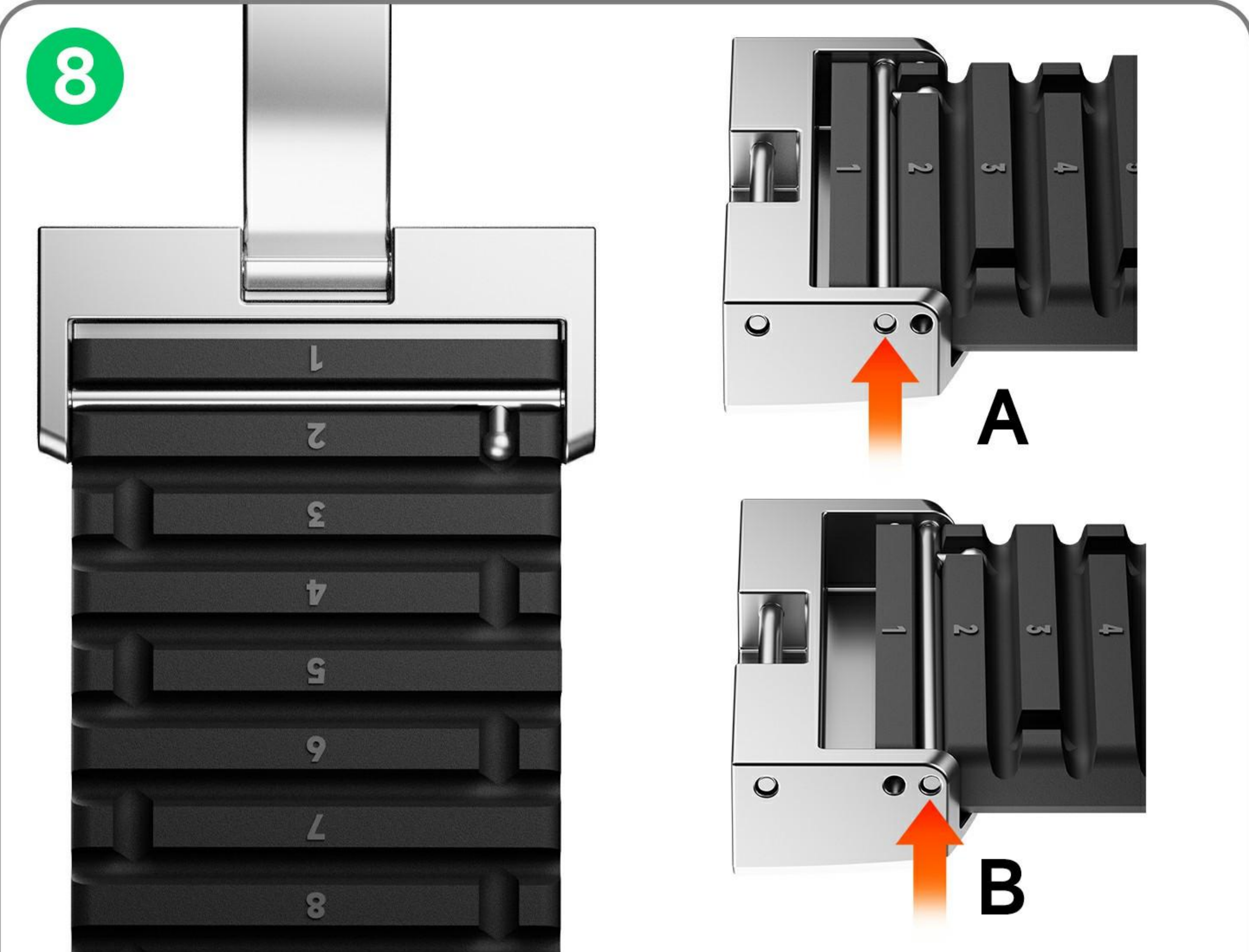

After installation, as shown in the figure, adjust position A/B to select the tightness of the strap for comfort



Put the strap on the right position on your wrist, first fold B in the direction of the arrow, then fold A in the direction of the arrow



**Wearing Display**