



# pureal

USER MANUAL

## Water Purifier

- Compact & Slim design
- Easy filter replacement system
- Optimum filter solution
- Exchangeable tap
- No electricity & No noise
- Removable tray

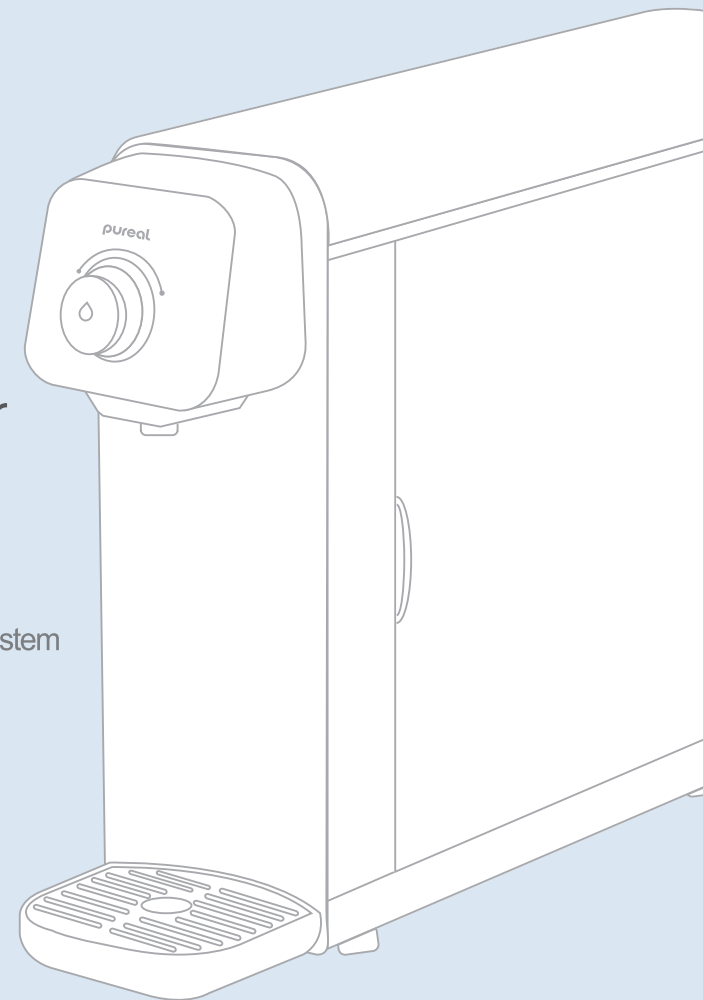

[www.pureal.co.kr](http://www.pureal.co.kr)



### 115mm Compact & Slim design

Can be harmonized with any place by Luxury & Slim design



### Easy filter replacement system

Everyone can replace filters by easy & quick filter replacement system



### Optimum filter solution

High quality filter system with best performance



### Changeable tap

Sanitary parts by self-wash of changeable tap



### No electricity needed & No noise

No worry about electricity bill and noise

## ● Introduction

- Safety Precaution ----- 04
- Safety Warning ----- 06
- The names of each part ----- 07

## ● Installation

- Water flow diagram ----- 08
- Check before installation ----- 09
- How to install ----- 10
- Check before use ----- 11
- How to clean ----- 12
- How to clean, How to replace filters ----- 13
- Subject of recommendation / Filter composition ----- 14

## ● What to know

- Check before reporting the failure, ----- 15
- Product standard

## Safety Precaution

**pureal**

In order to protect the users safety, please read carefully and follow the below instructions & signs to prevent accidents and avoid dangers.



**Caution** If not followed correctly, the user may sustain minor injury or lose properties.



**Warning** If not followed correctly, the user may sustain a serious injury or may lose properties.



**Danger** If not followed correctly, the user may sustain a serious injury or may die.

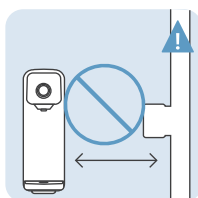

Do not install close to place where combustible gas can leak or electric heating instrument.

Gas may leak around the water purifier and explosion or fire may occur.

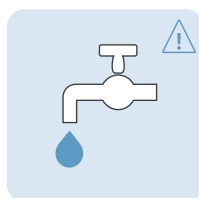

Use only tap water for inlet. Do not use ground water, rain water, river, and sea water.

It can cause to shorten product life and breakdown.

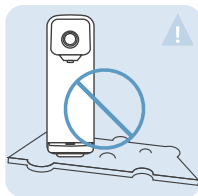

Do not install on uneven or inclined floor and do not put on sitting cushion, carpet, pallet and floor pad. It can cause not only damage and noise, but also injury to the user.

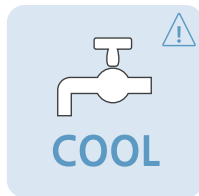

Use cold water tap.

The hot water can cause damage to the water filter and the product.



Do not install or place at the area with below zero temperatures.

It can cause product damage by ice formation inside of product.



Install in clean area.

For preventing water pollution.

## Safety Precaution

**pureal**

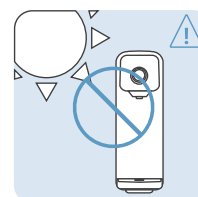

Avoid place with high temperature and direct sunlight area when installing.

It can cause product discoloration.



Clean the product periodically.

For preventing product damage and noise.

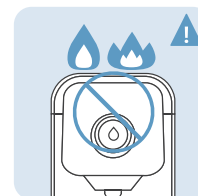

Do not place electric heating instrument, electric heater and inflammable substance near the product.

It may cause fire or accident.

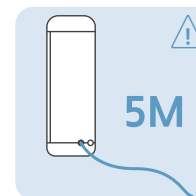

Do not let the length of the water supply hose be more than 5m to the water supply valve.

It can cause low product performance.

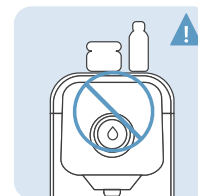

Do not put metalloid, chemical and water bottle on the product.

It can cause product damage.

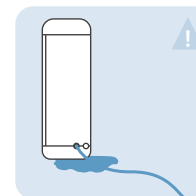

Check water leak at the tube and connecting area of in & outlet.

It can cause property damage by water leak.



Do not let water get inside of the water purifier.

It can cause product damage.

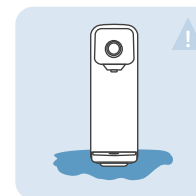

In case of water leak, please turn off the tap water valve and contact to + 82 32 678 5114.

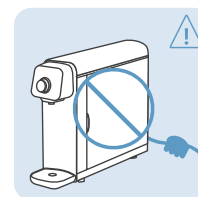

Do not pull out hose while you move product to other place.

It can cause product damage and water leak.

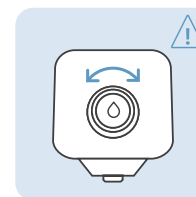

Do not let children touch the lever often.

It can cause product damage and water leak.

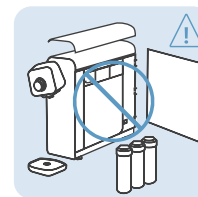

Do not disassemble and modify the product except designated engineer.

In case of product problems, please contact your local agent.

## Safety Warning

**pureal**



**Caution** If not followed correctly, the user may sustain minor injury or lose properties.



**Warning** If not followed correctly, the user may sustain a serious injury or may lose properties.



**Danger** If not followed correctly, the user may sustain a serious injury or may die.

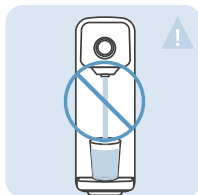

Do not let water get inside of the water purifier.  
It can cause product damage.

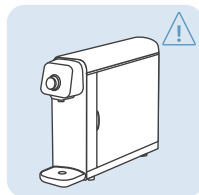

Keep the door closed during product usage.  
Foreign substance or insect can come inside of product body and it can cause breakdown.

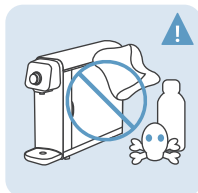

When cleaning the product, do not use benzene, thinner, alcohol and other chemical substance.  
Product exterior can be damaged.



**5 mins**

Flush (Make water purifier run) more than 5 mins after long time no use.

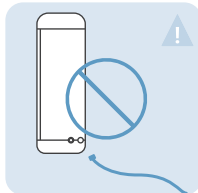

Do not remove hose when water purifier is running.  
It can cause product damage or water leak by hose disconnection.

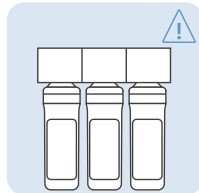

Replace filters regularly according to the replacement period.  
(If do not change the filter in time, it can cause bad water smell from outlet and filter performance degradation. Please refer P 13 for filter replacement.)

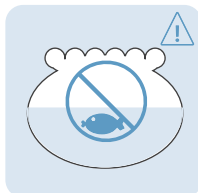

Do not use purified water for fish in aquarium.  
Purified water can NOT be suitable for fish and cause death.



Use PICOGRAM standard filter only.  
If the filter from other company or nonstandard product is used, it may cause breakdown, bad smell, changed water taste, water leak and not purify well.

## The names of each part

**pureal**

### Parts name

#### Front

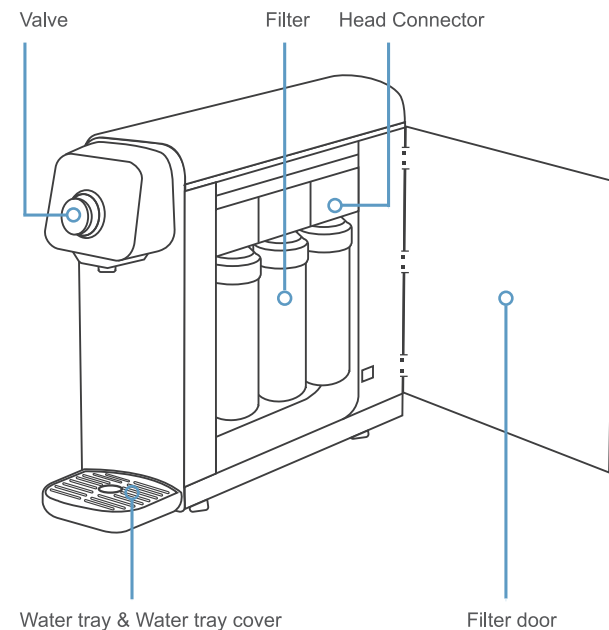

#### Back

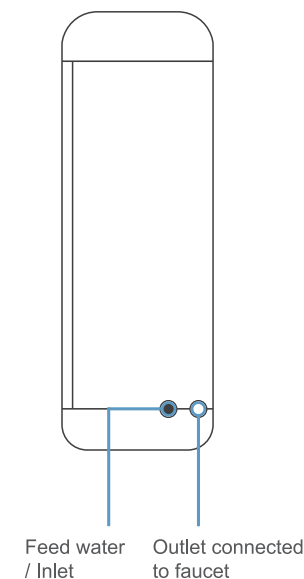

### Parts list

#### USER MANUAL

## Flow diagram

**pureal**

### Water flow diagram

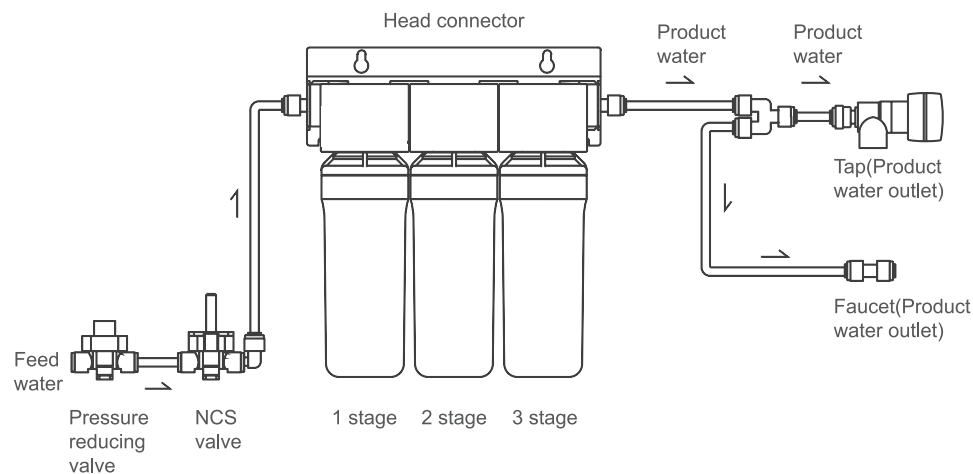

### Tubing connection

- Use cold water tap.

The hot water connection may cause damage to the water filter and the product.

## Check points before installation

**pureal**

### Installation place



**Caution** If not followed correctly, the user may sustain minor injury or lose properties.



**Warning** If not followed correctly, the user may sustain a serious injury or may lose properties.



**Danger** If not followed correctly, the user may sustain a serious injury or may die.

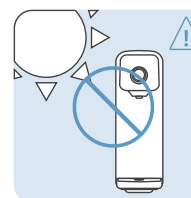

Avoid place with high temperature and direct sunlight area during installation.

It can cause product discoloration.

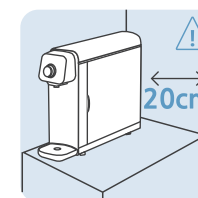

The back and sides of the product needs more than 20cm spaces apart from the wall for convenience of filter replacement. And do make distance between tap water and inlet of product NO more than 5m to connect water hose.

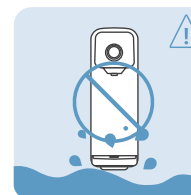

Avoid place with moist, dust and place where water may splash directly to water purifier.

It can cause breakdown.

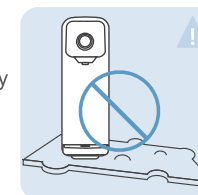

Do not install on uneven or inclined floor.

It can cause breakdown.

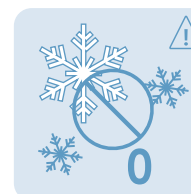

Do not install or put on the area with below zero temperatures.

It can cause product damage by ice formation inside the product.



Install in clean area.

For preventing water pollution.

## Water flow diagram

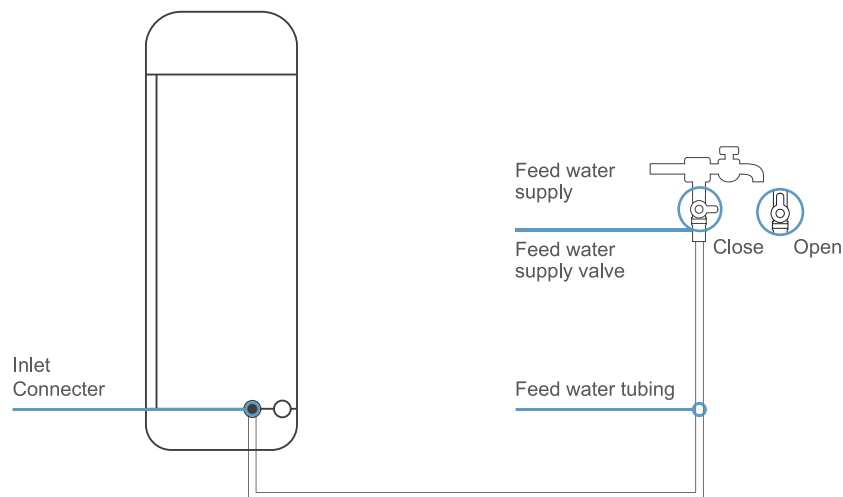

## Installation

- 01 Install Tap water valve at cold tap water supply.  
valve should be closed before installation.  
It can cause water filter and product damage with hot water connection.
- 02 Connect hose from Tap water valve to inlet of water purifier.
- 03 Open the Tap water valve.
- 04 Close the filter door.
- 05 After the installation, make sure the hose's joint and Tap water valve do not leak.

※ Use only tap water. Do not use underground water or others

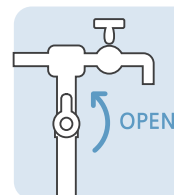

Open the Tap water valve before using.

Check tap water still running first and then open the Tap water valve.

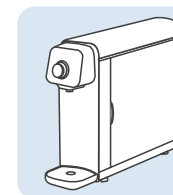

Check the door is keep closing.

If the door opens, the water will not pass into the water purifier.



Flush (make water purifier run) more than 5 mins after long time no use.



Caution : Close the tap water valve in case of long time no usage.

- Turn Water lever to clockwise.



- Turn Water lever to counterclockwise.

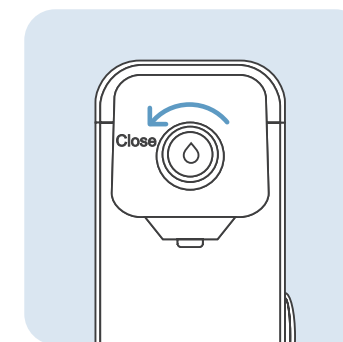

## How to clean Water purifier body

**pureal**

01 Close the Feed water valve.

02 Use neutral detergent to clean the body and Use a soft & dry cloth to clean lastly.

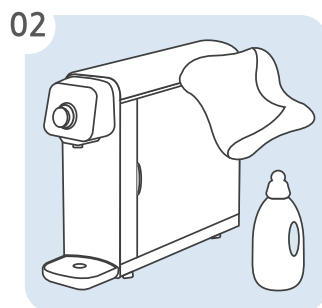
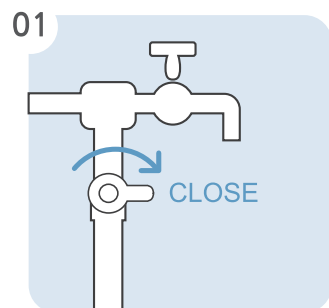

## How to clean water tray

**pureal**

01 Pull out the tray and disassemble.

02 Pull out tray cover and disassemble.

03 Throw away water and clean the tray by soft cloth.

04 Assemble the tray and tray cover by opposite way of above.

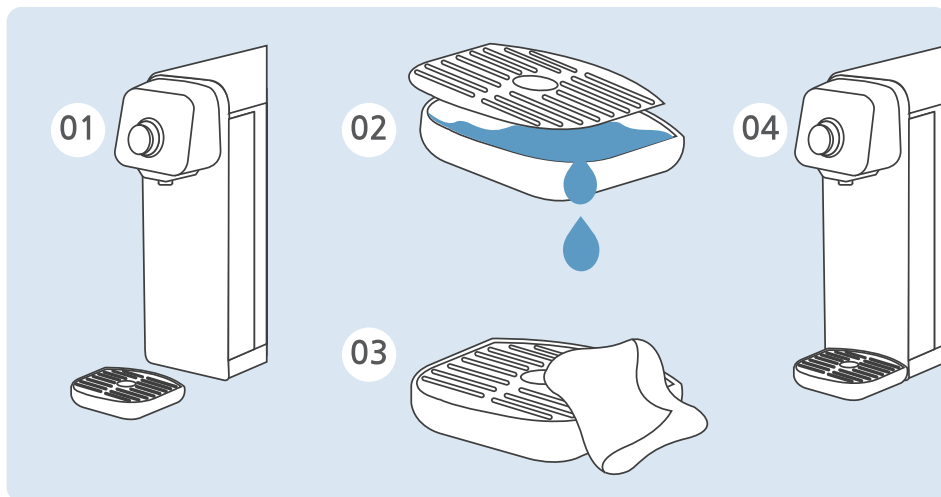

## How to clean the tap

**pureal**

01 Turn Water tap by turning it clockwise.

02 Clean the tap.

03 Put it back by turning it counterclockwise.

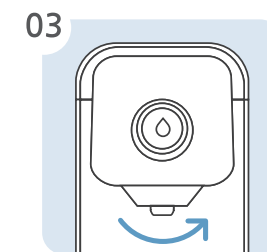
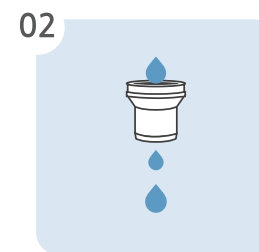
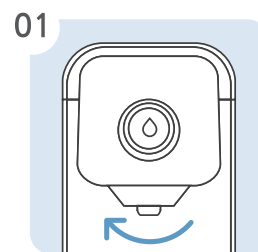

## Filter Replacement

**pureal**

01 Open the filter door.

When door opens, it will automatically shutoff water flow.  
Damage may occur when attempting to open the door more than 90°.

02 Please remove remained water in the machine by turning the lever to clockwise. Then close the lever to counterclockwise.

If remained water in the machine is not removed, the 'pop' sound can be occurred during filter replacement.

03 Lift the filter and turn it to the left for filter removing.

When disassembling filter, some water can be out from filter. It is not water leak.

04 Place the new filter to the connector and turn it to the right for new filter connecting.

05 Mark replacement date on each filter.

It's easy to manage filter life time.

06 Make water purifier keep running for 5 mins to stabilize new filter.

Black-colored water may come out due to activated carbon powder or initial activated-carbon. Cloudy water may come out due to water bubble. Thus, running 5 mins of the water purifier necessary for new filter stabilization.

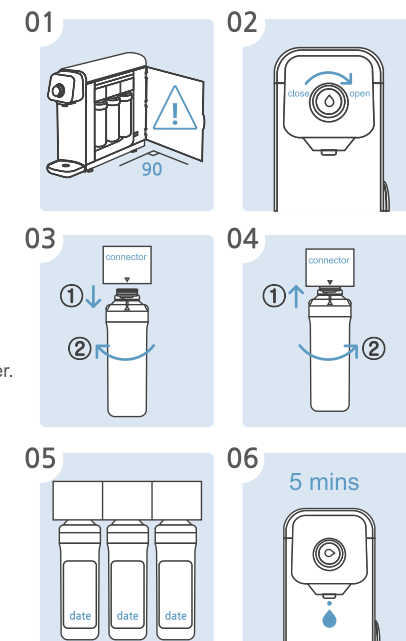

### Recommendation

- Effective purification capacity

It is calculated based on Chloroform removal rate of filter.

- Filter replacement period

It is calculated based on 10L use a day. If the amount of daily water using is higher than 10L, the period can be shorter than standard.

### Filter composition

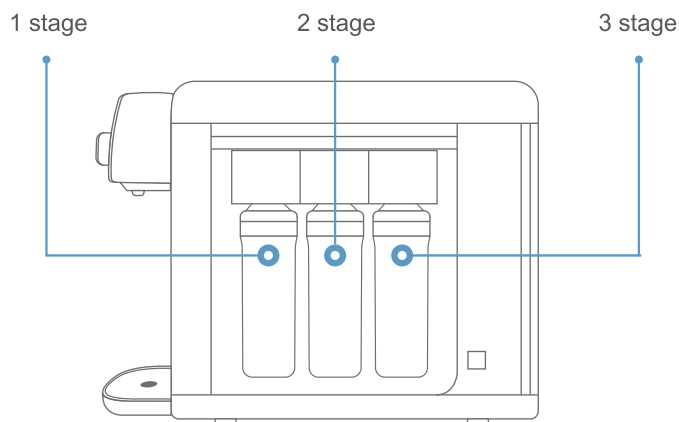

- If not use standard filter or over replacement period, it can cause performance deterioration.
- Filter life time depends on tap water quality.

If not followed by these instructions the product may not work properly. In case of product malfunction, please check below chart. Please contact us if you still have same problem.

Symptom	Check- up	Solution
The taste of water is strange.	-Is the water- purifier used for too long ? -Is not it the time for changing filter?	-Make water purifier keep running for 10 mins. -Replace to new filter. (Use standard filter)
Water is not coming.	-Is tap water supply is well?	-Open Tap water valve. -Check the hose is not folded. -Check the tap water is working properly.
The amount of filtered water reduced suddenly.	-Is not it the time for changing filter? -Is the Tap water valve closed?	-Replace to new filter. (Use standard filter) -Open the Tap water valve.
Water Purifier has big strange sound. (Noise)	-The floor under water purifier is flat? -Water purifier has touched with any other things? -It has noisy sound after water come out from cock?	-Install water purifier on flatted floor. Do not make any other things are touched with water purifier. -This water purifier is tankless model. So when water is used, the water comes through the water purifier from the tap instantly and it can make some sound. (It is normal)
There are some substances inside of purified water.	-Is not it the time for changing filter?	-Replace to new filter. (Use standard filter)
There is water leak.	-The place where the water purifier installed is moist?	-There may have condensation between cold area inside of water purifier and outside humidity. It is normal.

Product name	PUREAL WATER PURIFIER
Manufacturer	PICOGRAM CO.,LTD. / KOREA
Installation place	House / Office
Weight	4 kg
Size	W115 × D436 × H341 mm
Working pressure	0.7 ~ 7 f /
Temperature	4 ~ 38