

PANEL CONNECTING FITTINGS

System includes four types of connecting fittings for use with special buttons to connect panels in parallel or at 90°

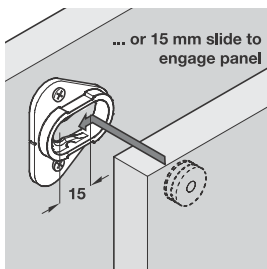
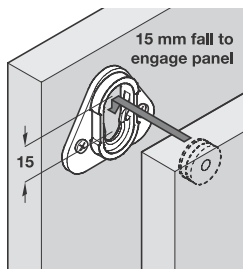
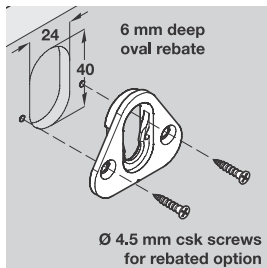
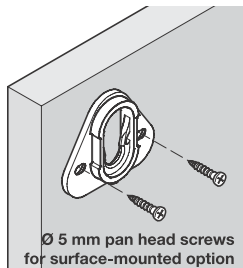
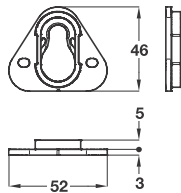

- > Connects parallel panels and is ideal for applications where strength and security is paramount
- > Engage the buttons in the connector and slide the panel down by 15 mm until Button-fix™ goes 'click', can also be configured sideways
- > When surface mounted an 8 mm gap is created between the two attaching panels.
- > Alternatively, you can rebate connector to reduce the gap between the two attaching panels to only 3 mm
- > Glass filled nylon
- > Order qty: Multiples of 100 pcs

TYP 1

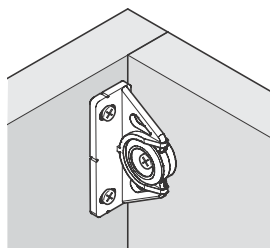
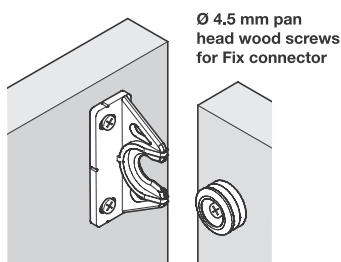
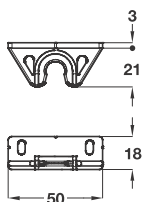

- > Connects panels at 90° with a simple push/pull fit ideal for applications where the emphasis is more on ease of fit and less on strength
- > Does not require a 15 mm drop down engagement
- > Nylon
- > Order qty: Multiples of 100 pcs

Cat. No.

Typ 2



separately, shown
below

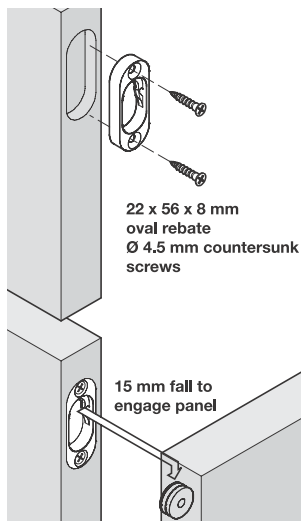

- > For applications where panel to panel contact is required and fits a simple oval rebate
- > Can be rebated into the edge of a panel of at least 28 mm thick, in particular hollow core panels or the face of a panel of at least 18 mm thick
- > Allows you to fit panels together with no gap inbetween, when fixing panels at least 18 mm thick (we recommend Euro screws for fixing into panels 18 - 22 mm)
- > Suitable for secret fixing of drawer fronts or connecting work surfaces to carcasses, exhibition stands and peg rails
- > Glass filled nylon
- > Order qty: Multiples of 100 pcs

Cat. No.

Typ 3

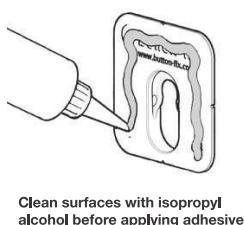

- > For applications where screw fixing to the panel is not possible and bonding is the preferred option
- > Suitable for decorative wall cladding using solid surface materials, compact laminate sheets less than 12 mm thick, honeycomb core panels, metal panels, glass panels or reconstituted stone and boat interiors, point of sales displays, white boards and interior signage
- > As well as surface mounting the fixing may be rebated for additional strength and ease of alignment
- > Glass filled nylon
- > Order qty: Multiples of 100 pcs

Cat. No.

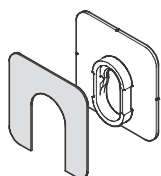

Self-adhesive Fix-pad option

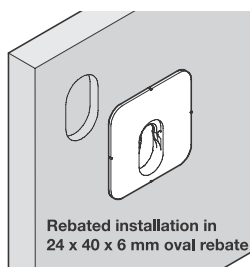

- > Should ideally be used when the Button-fix™ type 1 bonded is rebated to avoid creep under loading
- > For use when time for installation is limited
- > Order qty: Multiples of 100 pcs

Cat. No.

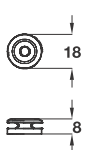

- > To be used in conjunction with any of the Fixes
- > The choice of button is determined by the type of screw and thickness of panel being used
- > Glass filled nylon
- > Order qty: Multiples of 100 pcs

Finish

For use with

Cat. No.

żółty

pomarańczowy

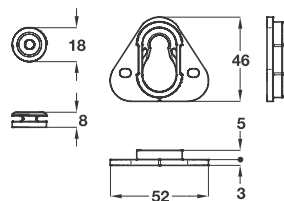

- > Set consists of:
 - 1x Type 1 Fix for parallel panels
 - 1x button for countersunk wood screw
- > Glass filled nylon
- > Order qty: Multiples of 100 sets

Cat. No.

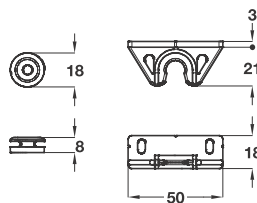

- > Set consists of:
 - 1x Type 2 Fix, for panel connecting at 90°
 - 1x button for countersunk wood screw
- > Nylon Fix and glass filled nylon button
- > Order qty: Multiples of 100 sets

Cat. No.

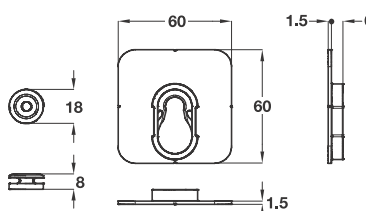

- > Set consists of:
 - 1x Type 1 bonded Fix, for fixing panels where screw fixing is not an option
 - 1x button for countersunk wood screw
- > Glass filled nylon
- > Order qty: Multiples of 100 sets

Cat. No.

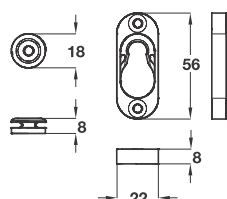

- > Set consists of:
 - 1x Type 1 flush Fix, for flush fixing parallel panels
 - 1x button for countersunk wood screw
- > Glass filled nylon
- > Order qty: Multiples of 100 sets

Cat. No.



Overall Ø: 18 mm

- > To be used in conjunction with Button-fix™ type 1, Button-fix™ type 1 bonded, and/or Button-fix™ type 1 flush
- > Quickly and accurately align the Button-fix™ installation without measuring
- > The marker will leave indents in the mating panel surface which can be used as a guide
- > Red nylon/stainless steel
- > Order qty: 1 pc

Cat. No.



Length x width: 50 x 25 mm

- > To be used in conjunction with Button-fix™ type 2
- > Quickly and accurately align the Button-fix™ installation without measuring
- > The marker will leave indents in the mating panel surface which can be used as a guide
- > Red glass filled nylon/stainless steel
- > Order qty: 1 pc

Cat. No.

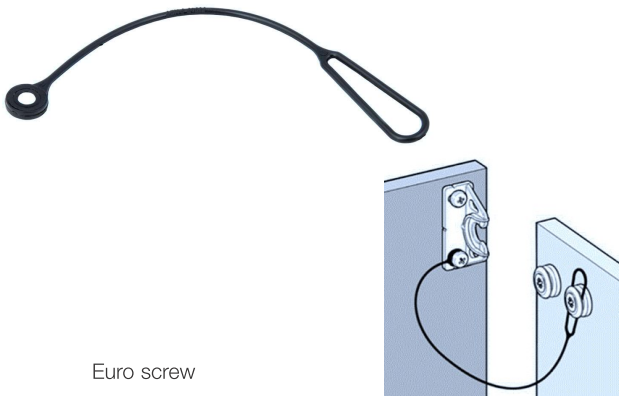

Euro screw

- > In situations where safety is an issue, a safety cord may be installed on the type 2 Fix
- > An additional button is used to capture the loop on the safety cord, installed adjacent to the fixing button
- > To remove the panel completely, the loop on the safety cord needs to be manually eased off the button
- > On a vertical panel install two safety cords, one to each fixing in the corners
- > Black plastic
- > Order qty: 1 pc

Cat. No.



Height x width x thickness: 190 x 260 x 8 mm

- > Designed to help rebate Button-fix™ type 1, type 1 bonded and type 1 flush
- > To be used with a metric 12 mm cutter and a 30 mm guide brush
- > Supplied with:
 - 1x Steel plate that attaches magnetically. Creates an oval rebate to suit the type 1 and type 1 bonded Fixes. The Square plates can be orientated vertically or horizontally in the acrylic frame
 - 1x Steel plate that attaches magnetically. Creates an oval rebate to suit type 1 flush. The square plates can be orientated vertically or horizontally in the acrylic frame
 - 1x Full instructions
- > Order qty: 1 pc



Cat. No.