

# **FX 10C**

HELMET BLUETOOTH INTERCOM

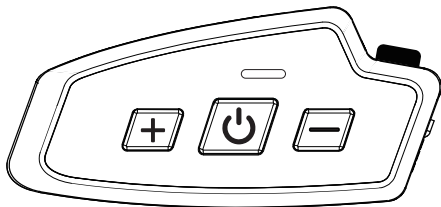

## **Manual**



## CONTENTS

1. Package Contents	2
2. Charging	3
3. Installation Instructions	4
4. General Operation Instructions	8
5. Device Pairing	11
6. FODSPORTS Bluetooth Mesh Intercom	13
7. Technical Specifications	29
8. Maintenance and Care	30
9. After-Sale Service	31

## 1. Package Contents

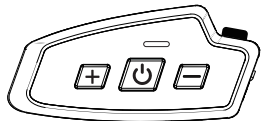

FX 10C

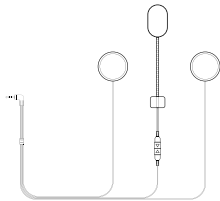

Speaker & Hard Tube  
Microphone



Button Microphone

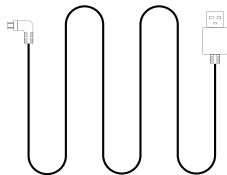

USB Cable

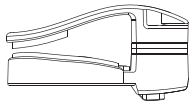

Clip Mounting Bracket

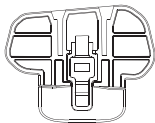

3M  
Tape Bracket

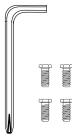

wrench&screw

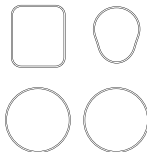

Velcro

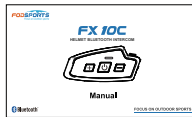

User Manual

## 2.Charging:

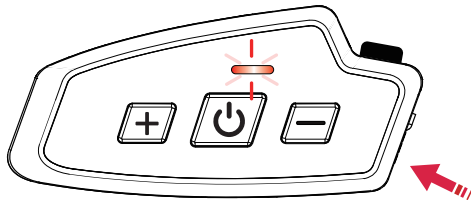

Power cable insert hole(socket)

2.1.When charging, the red light flashes, and when it is full, the blue light turns on.(As shown below).

Please charge before using for the first time.

2.2 Please use a qualified charger 5V/1A±0.5A.

2.3 Please keep charging at least once every 2 months if the product is not used for a long time.

### 3. Installation Instructions

3.1.1 Insert the Clip Mounting Bracket between the internal padding and external shell of the helmet.

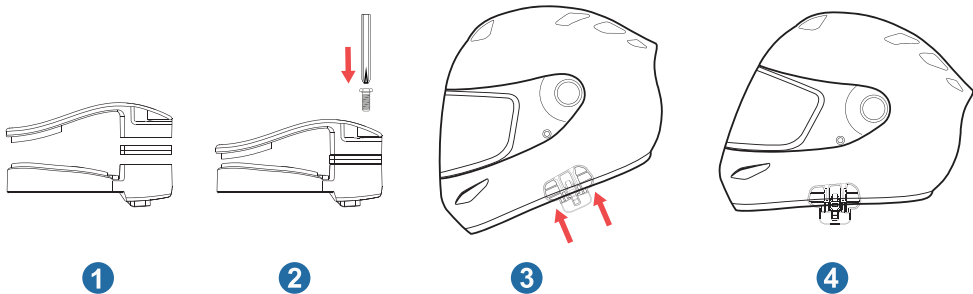

3.1.2 If there are any problems with mounting the bracket, you may use the 3M tape bracket. Peel off the protective backing sheet of the 3M tape and adhere the bracket onto the helmet. Press for 15 seconds and glue dry for 24 hours.

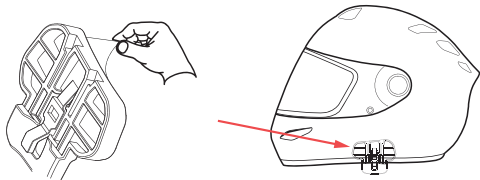

Note: Even though the 3M Tape mounting is provided for convenience, FODSPORTS recommends using the bracket mounting. The 3M Tape mounting is offered as an option that you may use at your own risk and responsibility, FODSPORTS does not assume any responsibility for use of it.

3.2 Locate an area in the nose section just to the left of center to mount the button microphone for full helmets. Place the button microphone to the velcro pad and connect it to the connector of the headset.

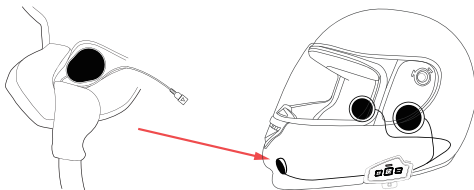

If you are installing into an open face helmet, please adjust the direction of the microphone so that the triangular mark on the microphone is pointing towards your mouth.

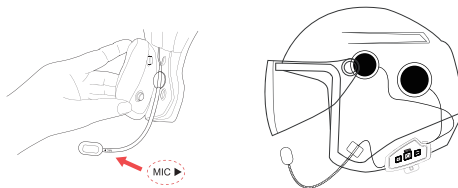

3.3 Place the speakers into the cheek pads. Push the speakers and microphone firmly against the Velcro pads.

3.4 Press the wires into the gap between the helmet liner and shell.

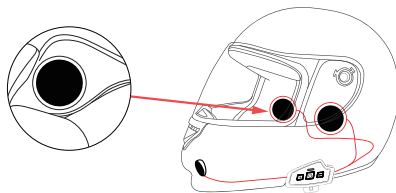



Note: The speaker with shorter wire is for the left ear and the speaker with the longer one is for the right ear, to enhance the FM radio reception as well.

3.5 Mount the FX 10C main unit on the bracket. Slide the main unit down onto the bracket until it clicks firmly into the bottom portion of the bracket.

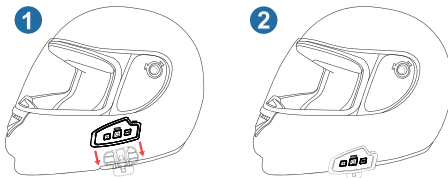

3.6 To remove the host of the FX 10C from the bracket, just push it up from the bracket.

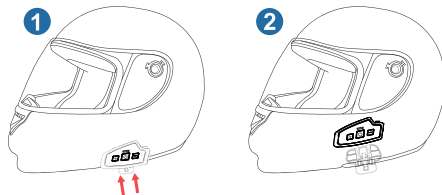

## 4. General Operation Instructions

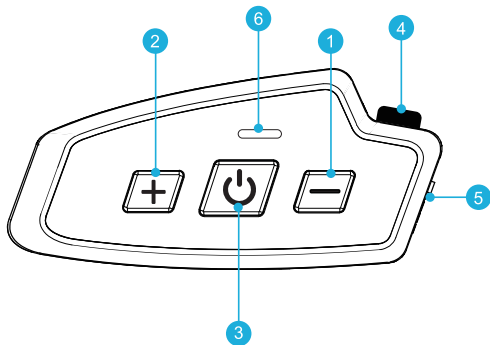

- 1. Volume-
- 2. Volume+
- 3. Power button
- 4. Mesh button
- 5. Earphone port(charing)
- 6. LED Indicator

### Switch On/Off

Switch On: Press and hold the "Power button" for about 3 seconds to switch on. The light will flash blue only.

Switch Off: Press and hold the "Power button" for about 3 seconds to switch off. The blue light will turn red then off.

## Power Detect & Notification Function

FX 10C has power detect Function, Press and hold the "Power button" and "Mesh button" for about 3 seconds to switch on., recorded voice message will tell you:

Battery 100%

Battery 80%

Battery 50%

Battery 25%

Battery Low

## Low Battery Alert

When the main battery unit falls below 20% charge the light will flash red and there will be a tone alert every five minutes until the condition is remedied.

## Cellphone

**Answer incoming call:** The unit will automatically answer the incoming phone call after 12 seconds. Or press the "Power button" to answer the incoming phone call immediately.

**Reject incoming call:** Double-click "Power button".

**End active phone call:** Short press the "Power button" to end a phone call.

**Volume Up:** (Long press) Short press "Volume+ button".

**Volume Down:** (Long press) Short press "Volume- button".

**Switch manual/automatic answering calls:** While in standby, press and hold the "Volume+ button" for 5 seconds. (Default: answer incoming calls automatically)

**Note:** In some cases (e.g. high-power RF radio influence or metal blocking), the headset might disconnect from the mobile phone. Please short press the "Power button" to reconnect.

## Voice Command

When in standby mode, double click the "Power button" to activate Siri or S-Voice. You will hear a beep sound, and then there will be a voice prompt from the mobile phone. Simply speak the name from your phone list to dial.

## Music Function

**Play:** Short press "Power button" .

**Pause:** Short press "Power button" .

**Play Previous:** Double click "Volume- button".

**Play Next:** Double click "Volume+ button".

**Volume Up:** (Long press) Short press "Volume+ button".

**Volume Down:** (Long press) Short press "Volume- button".

**Note:** When in music mode from phone, you will need to adjust the volume on phone as well to get louder volume.

## Music Sharing

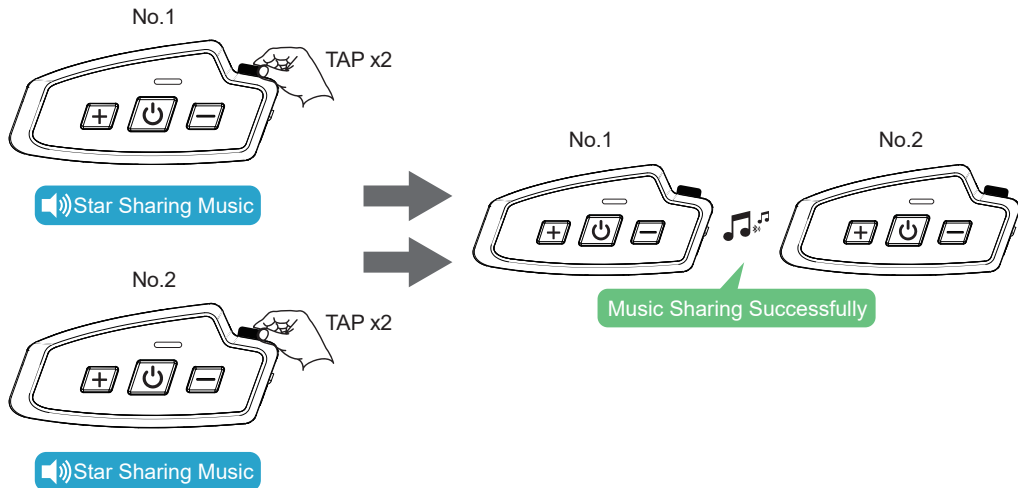

\*Start Sharing Music

**For example:** (No.1) share music with (No.2).

**Step 1:** (No.1) and (No.2) establish intercom connection(refer to 5.2).

**Step 2:** (No.1)long press “Power button” and “Volume-button” for 3seconds to enter Pairing Mode.

**Step 3:** (No.1) connect with phone(refer to 5.3).

**Step 4:** Turn on Music player on your phone and play songs.

**Step 5:** Short press “Mesh button” twice , voice notice“Start Sharing Music”.

**Step 6:** Now,(No.2) can enjoy the music shared by (No.1).

\*Stop Sharing Music

Pause music firstly, long press volume + button about 3 seconds,voice notice“Stop Sharing Music”

\*About Music Sharing

> Music sharing function is used only between two FX 10C devices.

> Short press the “Power button” to play / pause music sharing.

> If the operation of sharing music fails, you need to clear the pairing memory of unit No.1 and unit No.2, and try again.

## Music Function

**Play:** Short press "Power button" .

**Pause:** Short press "Power button" .

**Play Previous:** Double click "Volume- button".

**Play Next:** Double click"Volume- button".

**Volume Up:** (Long press) Short press "Volume+ button".

**Volume Down:** (Long press) Short press "Volume- button".

## FM Function

**FM ON:** Long press "Volume+ button" and "Volume- button" for 3 seconds.

**FM OFF:** Long press "Volume+ button" and "Volume- button" for 3 seconds.

**Volume Up:** (Long press) Short press "Volume+ button".

**Volume Down:** (Long press) Short press "Volume- button".

**Search channels:** Double-click "Volume+ button" / "Volume- button".

## Intercom Function

**Switch Intercom On:** Long press "Power button" for 2 seconds.

**Switch Intercom Off:** Long press "Power button" for 2 seconds.

**Volume Up:** (Long press) Short press "Volume+ button".

**Volume Down:** (Long press) Short press "Volume- button".

## Memory Clear(Reset)

To clear the previous pairing, When in standby mode, long press "Power button" and "Mesh button" for 7 seconds.

## Switch prompt tone

Switch prompt tone( English/Japanese ): While in standby, press and hold the "Volume - " button for 5 seconds.

## Background sound function

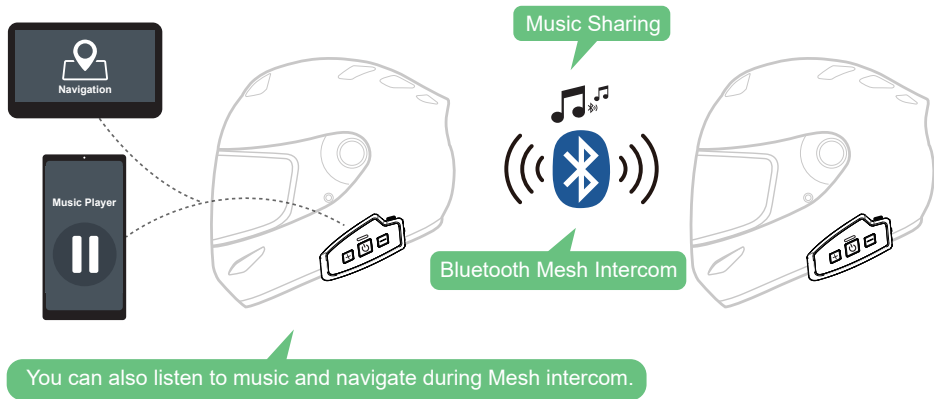

With the FODSPORTS Bluetooth Mesh intercom mode, you can listen to music and navigation while intercom, and You can also intercom while sharing music



**Play Music:** Short press "Power button" .

**Pause Music:** Short press "Power button" .

**Play Previous Song:** Double click "Volume- button".

**Play Next Song:** Double click "Volume+ button".

**Music Volume Adjustment:** Hold "Volume- button"/"Volume+ button" 2 Seconds.

**Start Mesh Intercom:** Short press "Mesh button" .

**End Mesh Intercom:** Short press "Mesh button" .

**Mesh Intercom Volume Adjustment:** Short press "Volume- button"/"Volume+ button" once.

## 5.Device Pairing

### 5.1 Pairing Modes

#### 5.1.1 Passive pairing mode



State:Stand by

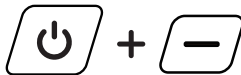

Hold down for 3 seconds

When device is on, long press “Power button” and “Volume-” to enter Pairing Mode, red and blue lights flash quickly, voice notice “ pairing ”. Pairing mode for connection to Bluetooth devices such as mobile phones and Bluetooth GPS.

### 5.1.2 Active search mode



When device is on,,long press “Power button” and “Volume-” to enter Pairing Mode, red and blue lights flash quickly , then short press “Power button” to enter Search Mode , blue lights flash slowly, voice message says “ Searching ”. Search mode only use for intercom function connection between FX 10C devices.

### 5.2 (No.1) FX 10C connect with (No.2) FX 10C



(No.1) FX 10C is on positive search mode(refer to 5.1.2), (No.2) FX 10C is on passive search mode (refer to 5.1.1),(No.1) and (No.2) FX 10C change from flashing red and blue lights alternately to function and intercom buttons flashing blue lights at the same time,connect successfully. Then you can long press "Power button" for 2seconds to intercom.

### 5.3 Pairing With Cellphone

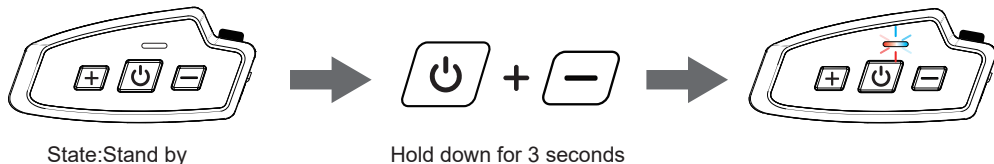

**STEP1.**When device is on,long press Function button,red and blue light flash quickly, entering passive pairing mode.(refer to 5.1.1)

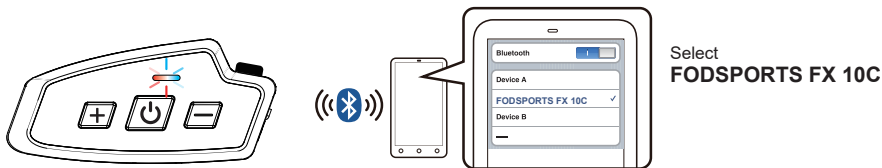

**STEP2.**Turn on cellphone Bluetooth,Select“ FODSPORTS FX 10C”,the pairing is complete.Voice message will notice “Device Connected”.

## 6.FODSPORTS Bluetooth Mesh Intercom

**STEP1.** Power on all the FX 10C

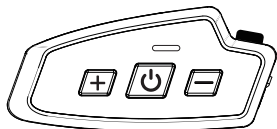

State:OFF



Hold down for 2 seconds

**STEP2.** Mesh Channel Settings

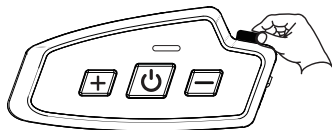

Hold down for 2 seconds

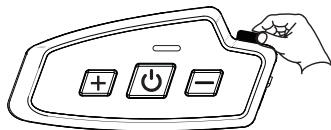

TAP x1

Enter Mesh Channel: short press the Mesh button to adjust the Mesh channel from 1-10.

### STEP3. Save Mesh Channel Settings

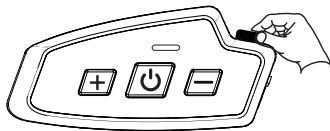

Hold down for 2 seconds

Save Mesh Channel Settings: Long press the Mesh button 2 seconds to save. Confirm that all devices select the same channel.

### STEP4. Mesh Intercom



Start Mesh Intercom: Short press "Mesh button" .



End Mesh Intercom: Short press "Mesh button" .

**\*Reset Mesh Channel : (default channel 4)\***

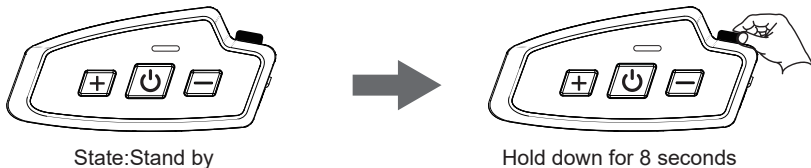

**Reset Mesh Channel:** When device is on, long press the Mesh button 8 seconds to reset mesh channel (default channel 4)

**NOTE:** Confirm that all devices to restore the default channel 4.

## 7. Technical Specifications

**Bluetooth Support:** HSP,HFP,A2DP,AVRCP, AGHSP

**Battery:** lithium battery, 800mAh , 3.7v

**Dimensions:** 94mm \*44mm \* 25mm

**Weight:** 50G, 100G(Include Headphone & Mic Kits)

**Frequency Range:** 2.4G-2.485G

**Operating temperature:** -20℃-50℃

**Certification:** CE FCC ROHS BQB TELEC

**USB Adapter standard charge voltage:** DC 5V±0.2V

**USB Adapter standard charge circuit:** DC 1A±0.5A

**Charging time:** 2-3 hours

**\*The FX 10C operates in the following order of priority:**

1. Phone call (highest)

2. FODSPORTS Bluetooth Mesh Intercom

3. Intercom

4. Music, FM radio (lowest)

5. A lower-priority Function is always interrupted by a higher-priority Function. For example, stereo music is interrupted by an Intercom call, and Intercom conversation is interrupted by an incoming mobile phone call.



## **8.Maintenance and Care**

The FX 10C should be treated with care and the following suggestions will help maintain your Warranty.

1. Do not use or store the device in dusty or dirty environments. Moving parts and electronic components can be damaged.
2. Do not store the device in high heat areas. High temperatures can shorten the life of electronic devices, damage batteries, and warp or melt certain plastics.
3. Do not store the device in cold temperature areas. When the device returns to its normal temperature moisture can form inside the device and damage electronic circuit boards.
4. Do not attempt to open the FX 10C case.
5. Do not drop or knock the device. Rough handling can break internal circuit boards and fine mechanics.
6. Do not use harsh chemicals, cleaning solvents, or strong detergents to clean the device.
7. Do not paint the device. Paint can clog the moving parts and prevent proper operation. These suggestions apply equally to the headset main unit, speaker-microphone clamp unit, and power charger.

## **9.After-Sale Service**

For any quality problem or missing accessories, especially pairing problem between 2 or more FX 10C headsets, please feel free to contact us at email: [winzon.cs@outlook.com](mailto:winzon.cs@outlook.com). We're always here ready to help, will reply to you in 24 hours.



# Warranty Card

Purchase Date: \_\_\_\_\_

Dealer/Retailer: \_\_\_\_\_

Item No.: \_\_\_\_\_

Customer Name: \_\_\_\_\_

Customer Tel: \_\_\_\_\_

Customer E-mail: \_\_\_\_\_



## Product Failure Description:

(Please be sure to fill in your related information so that we can better serve you in time)







## User Manual Download



<https://community.fodsports.com/support/fx-10c-user-manual/>

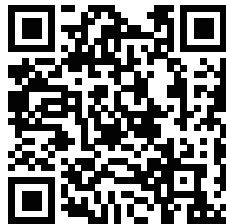

fodsports.com

20221206V1.1

