



Renault Master Opel Movano Nissan NV400

M/Y: X62, ≥'10

FRONT WHEEL DRIVE

P/N SET: 1511922200



© 2016

All rights reserved. No part of this publication may be reproduced, stored in a retrieval system, or transmitted in any form or by any means, electronic, mechanical, photocopying, recording or otherwise, without the publisher's prior consent. That does also count for the schemes and drawings.

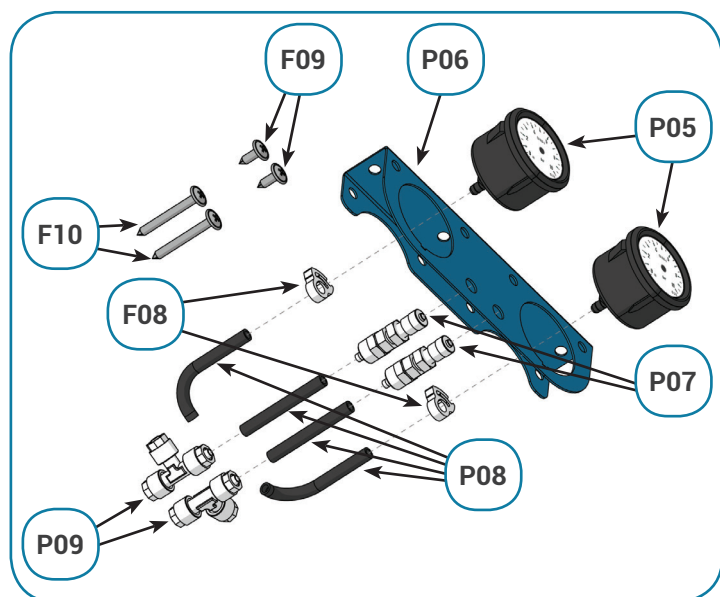
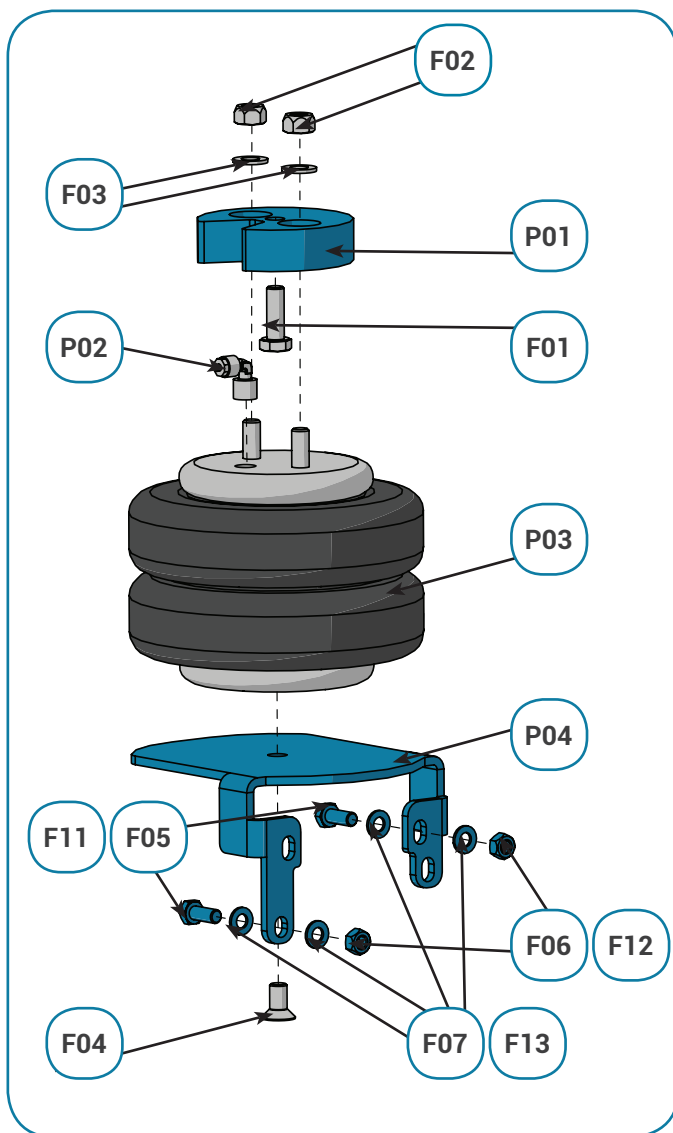

ID	Qty	Description	P/N	Torque
F01	2	Bolt M10x30 (8.8)	0010110030AA	
F02	4	Lock nut M10 (8.8)	0011010001AA	20 Nm
F03	4	Washer M10 (8.8)	0011210000A	
F04	2	Countersunk screw M10x20 (8.8)	0010510020AA	20 Nm
F05	2	Bolt M8x25 (8.8)	0010108025AA	
F06	2	Lock nut M8 (8.8)	0011008001AA	20 Nm
F07	4	Washer M8 (8.8)	0011208000A	
F08	2	Hose clamp	0030225106	
F09	2	Plate screw 4,2x13	0012742130	
F10	2	Plate screw 4,2x38	0012742380	
F11	2	Bolt M6x20 (8.8)	0010106020AA	
F12	2	Lock flange nut M6 (8.8)	0011106001AB	8 Nm
F13	2	Washer M6 ø20x1.25 (8.8)	0011306020A	
P01	2	Upper bellows support	1512040001	
P02	2	Air coupling	0020906012	
P03	2	Air spring	1512030003	
P04	2	Lower bellows support	1512050002	
P05	2	Pressure gauge	0021700003	
P06	1	Mounting bracket	1515370000	
P07	2	Inflation valve	0020906005	
P08	16 m	Air tube	1052255077	
P09	2	Air coupling	0020906003	

Fitting instructions and information



3 - 4 Hours

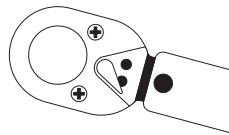

Tighten with torque



Warning



Okay



Not okay

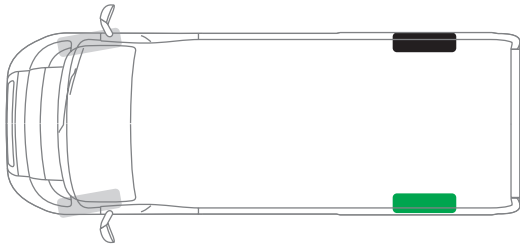

Colour markings
Green - left (rear)
Black - right (rear)

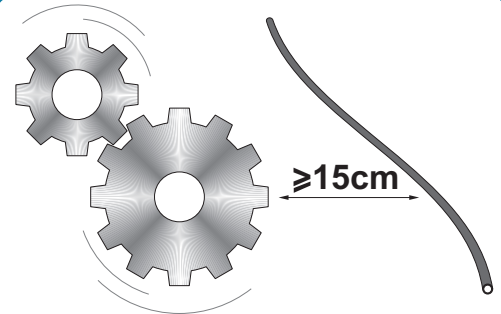

Attach the air tubes with a minimum distance of 15 cm to moving parts.

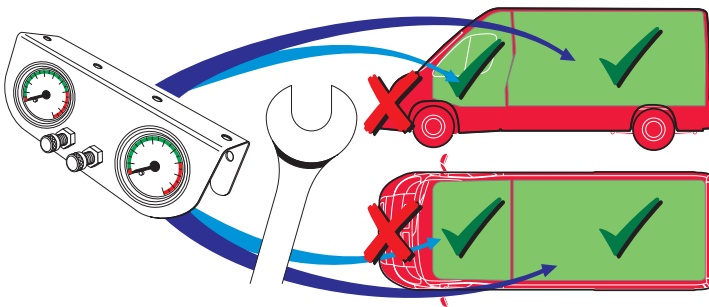

Consult with the customer as to where they want the control panel fitted.



Attach the air tubes with a minimum distance of 15 cm to hot parts.



Direction of travel.



Attach the air tubes with a minimum bending diameter of 8 cm.

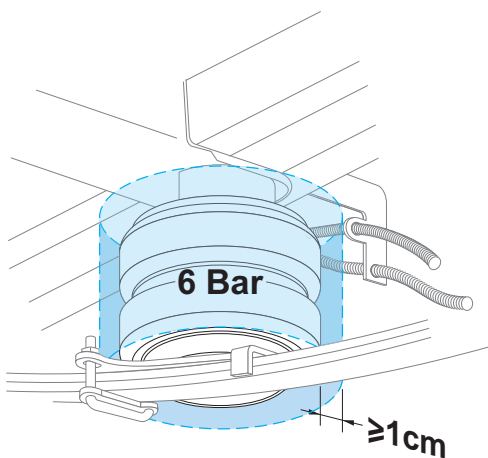

Check that the air springs always have at least a 1 cm all-round clearance at maximum pressure ($p_{max} = 6 \text{ bar}$).

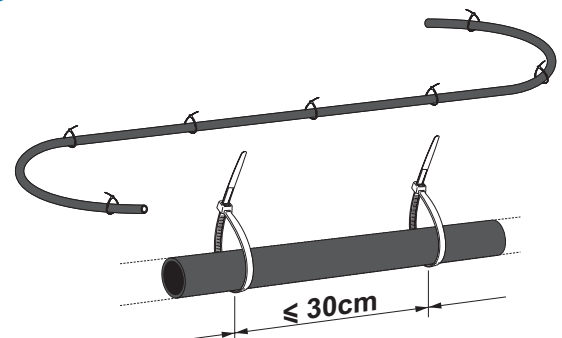

Secure pipes with a sufficient number of tie-wraps.

Kit installation

1

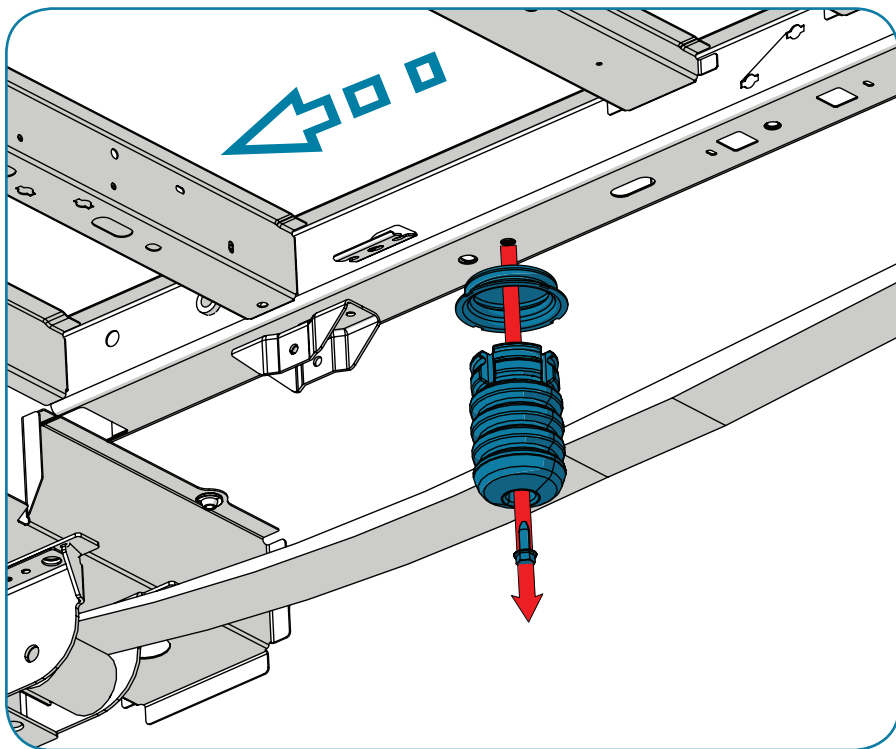

2

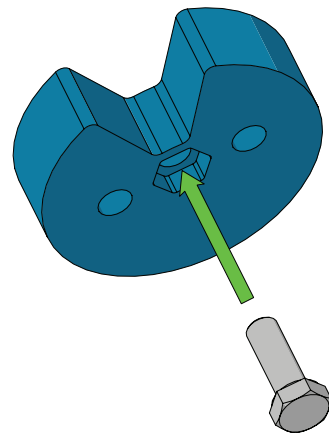

3

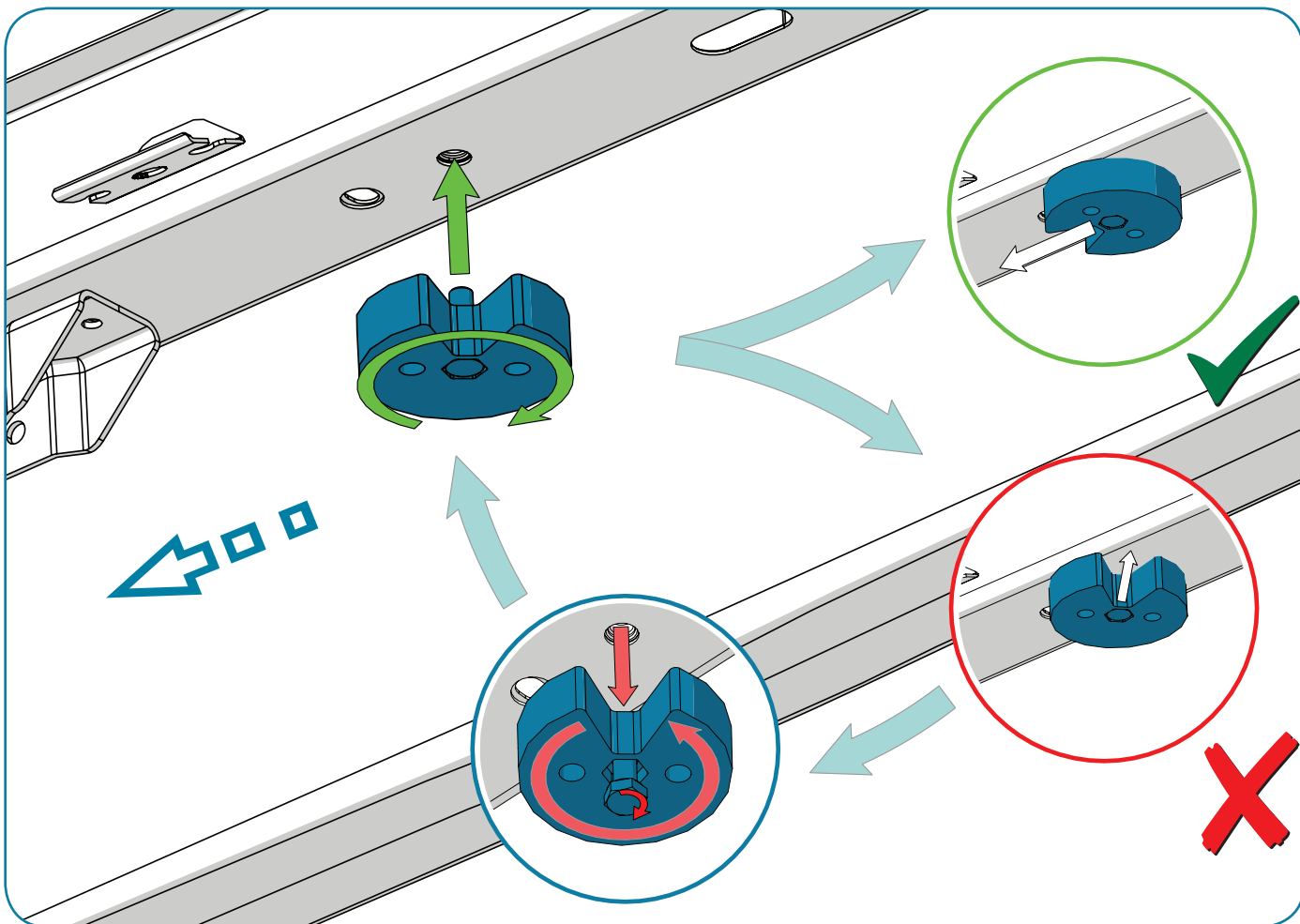

4

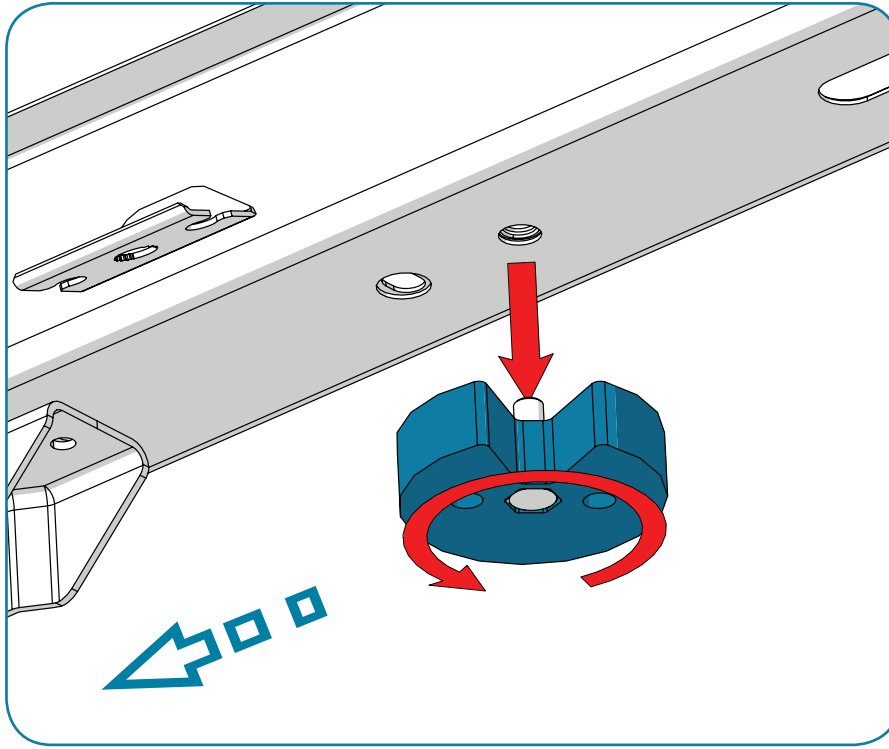

5

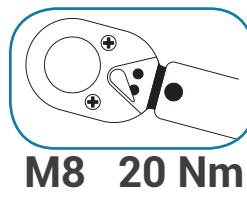
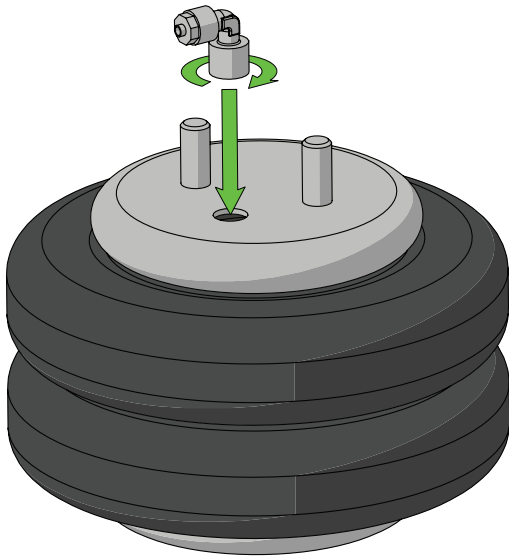

6

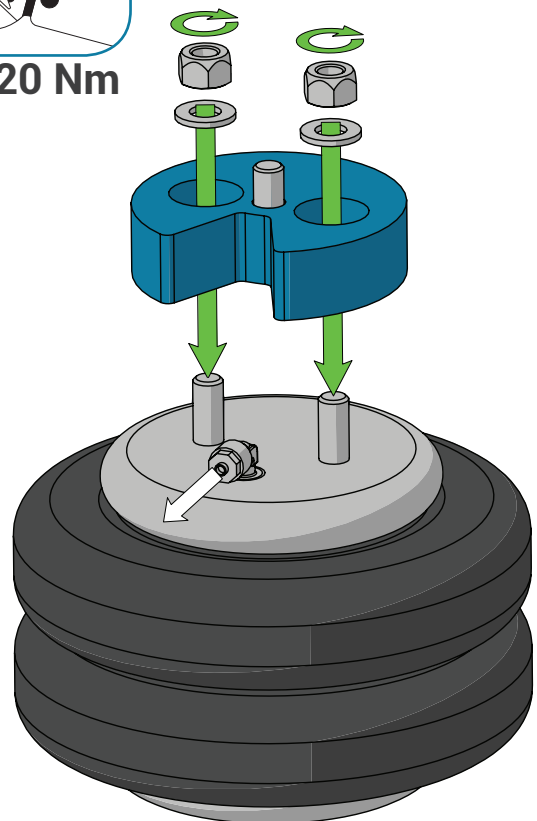

7

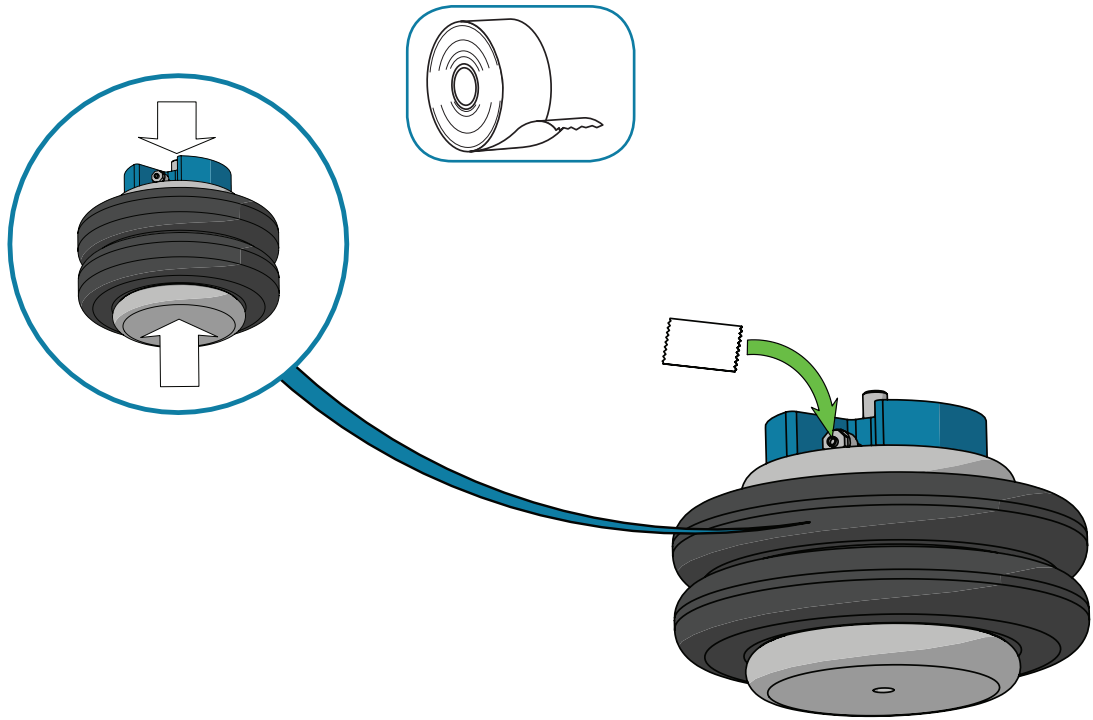

8

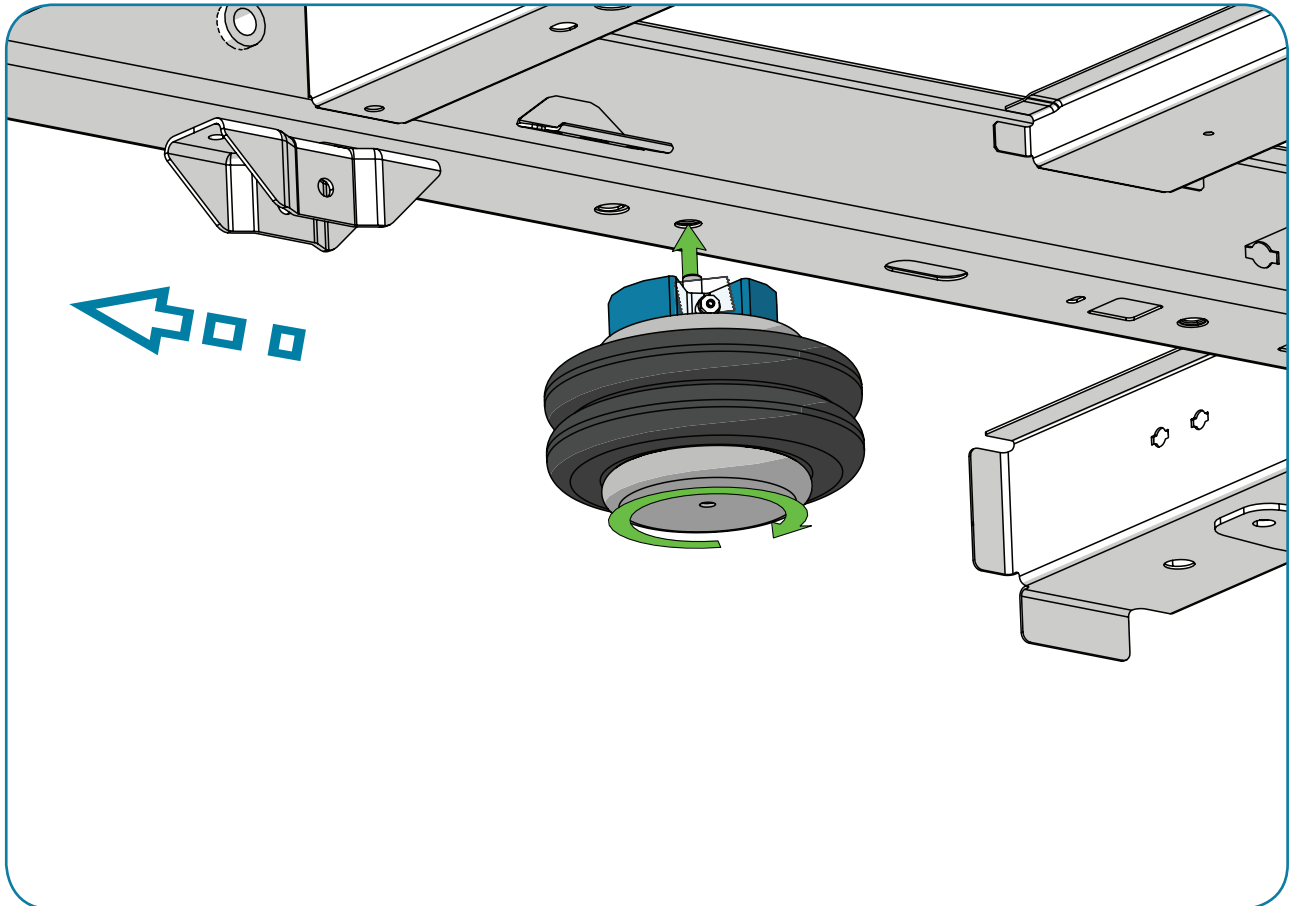

9

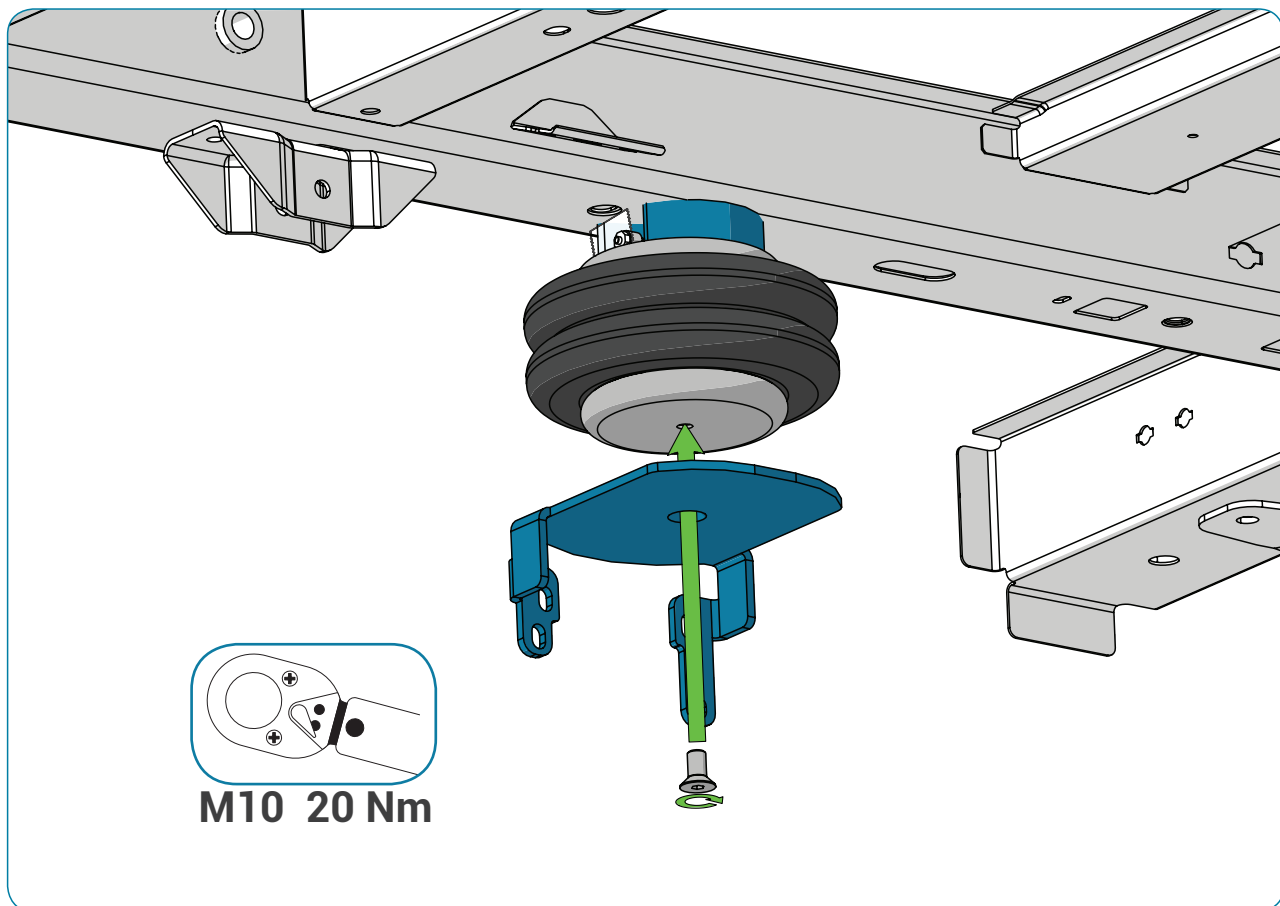

10

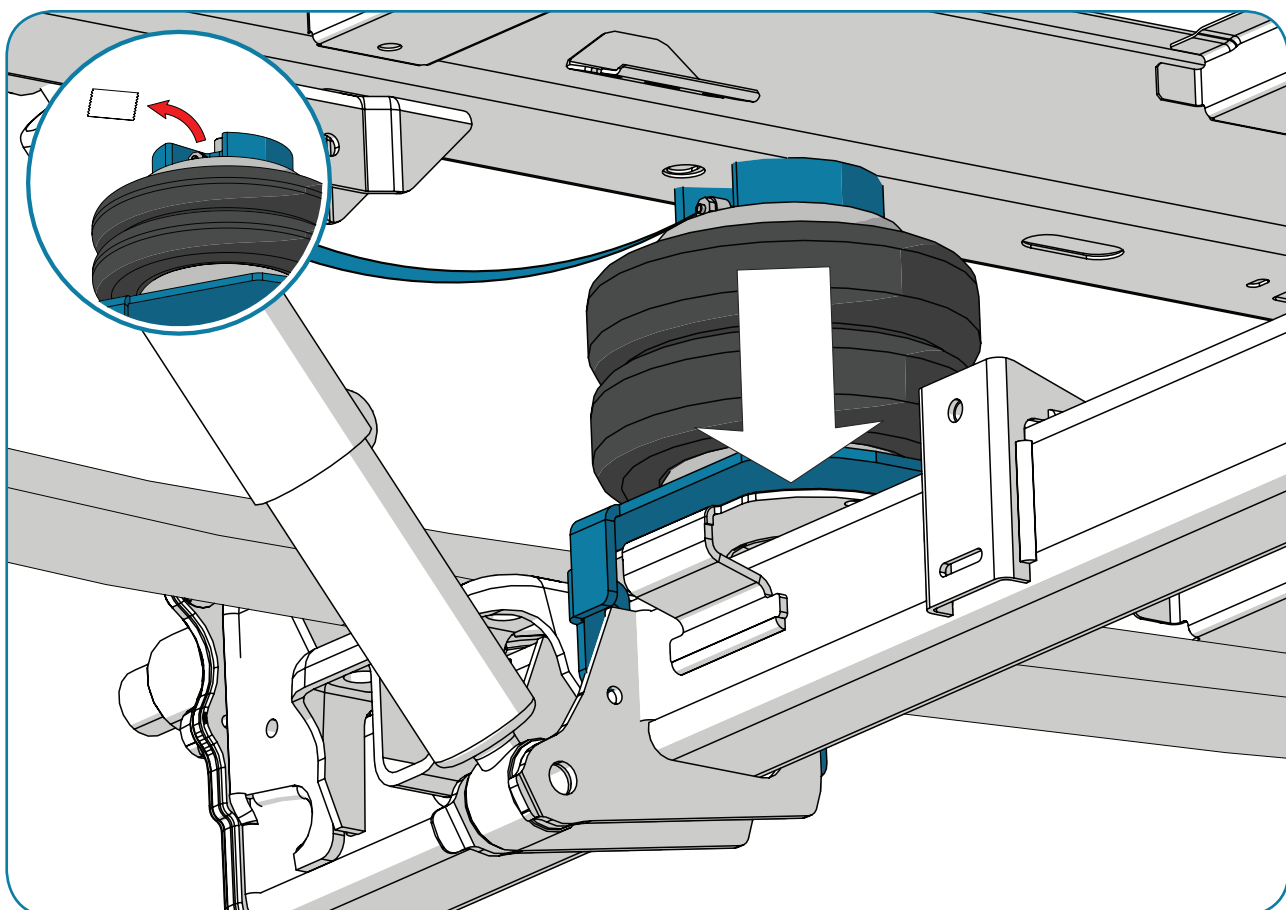

11

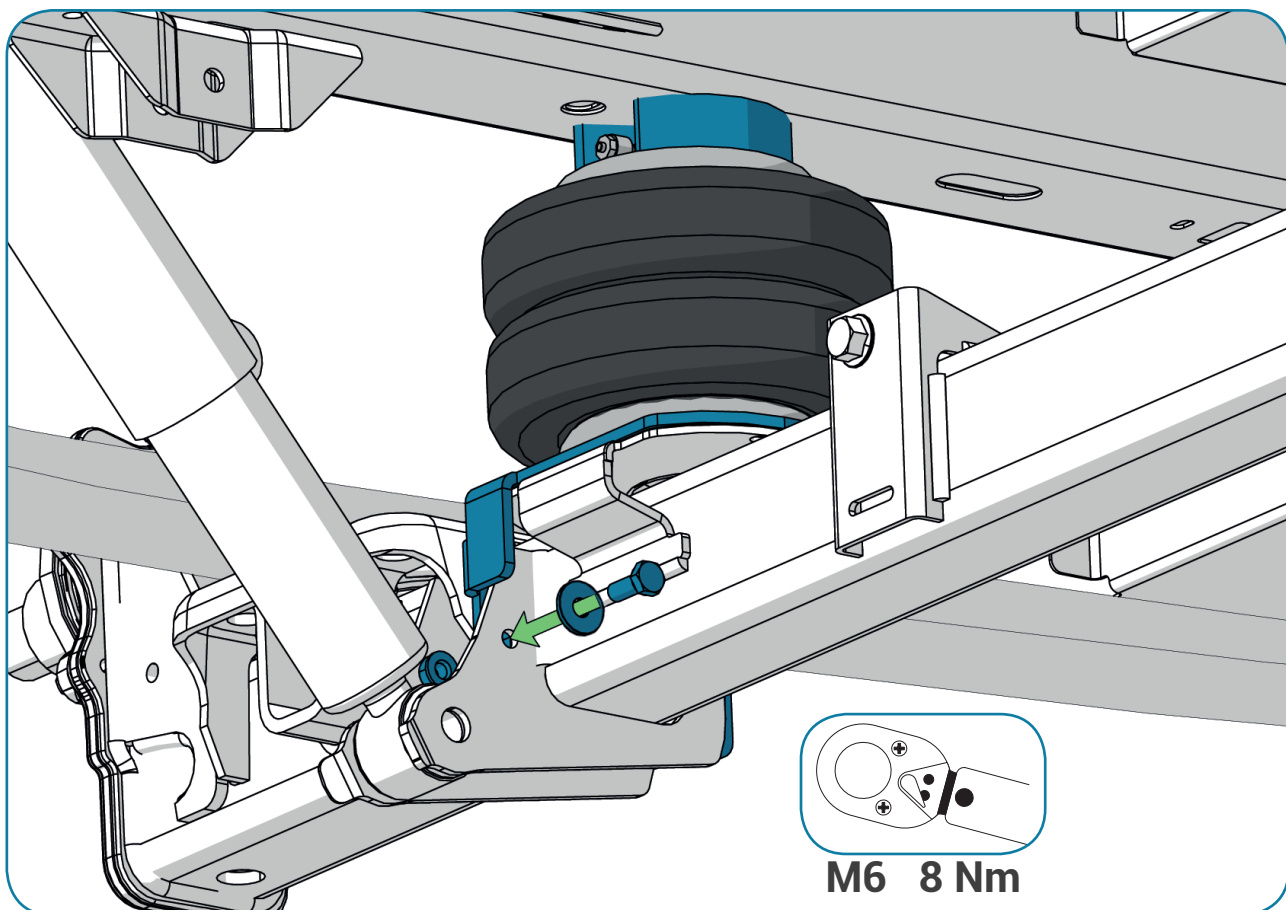

12

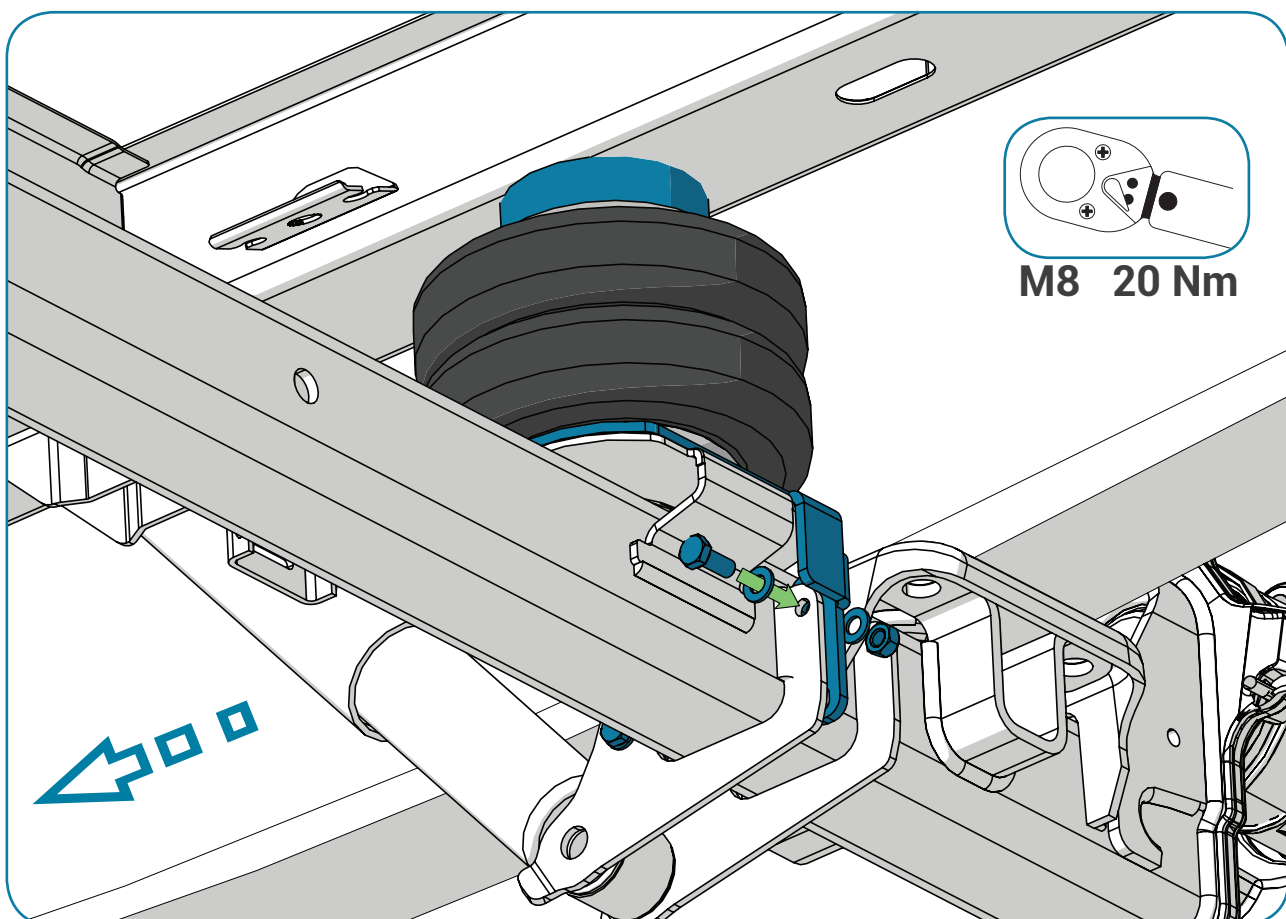

13

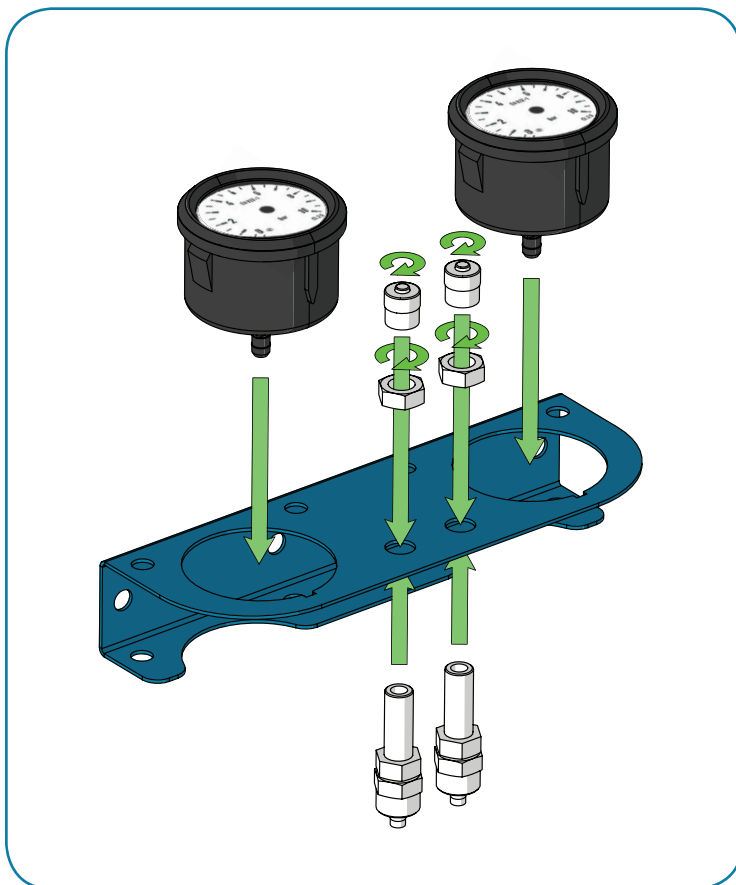

14

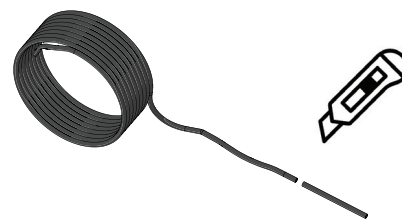

15

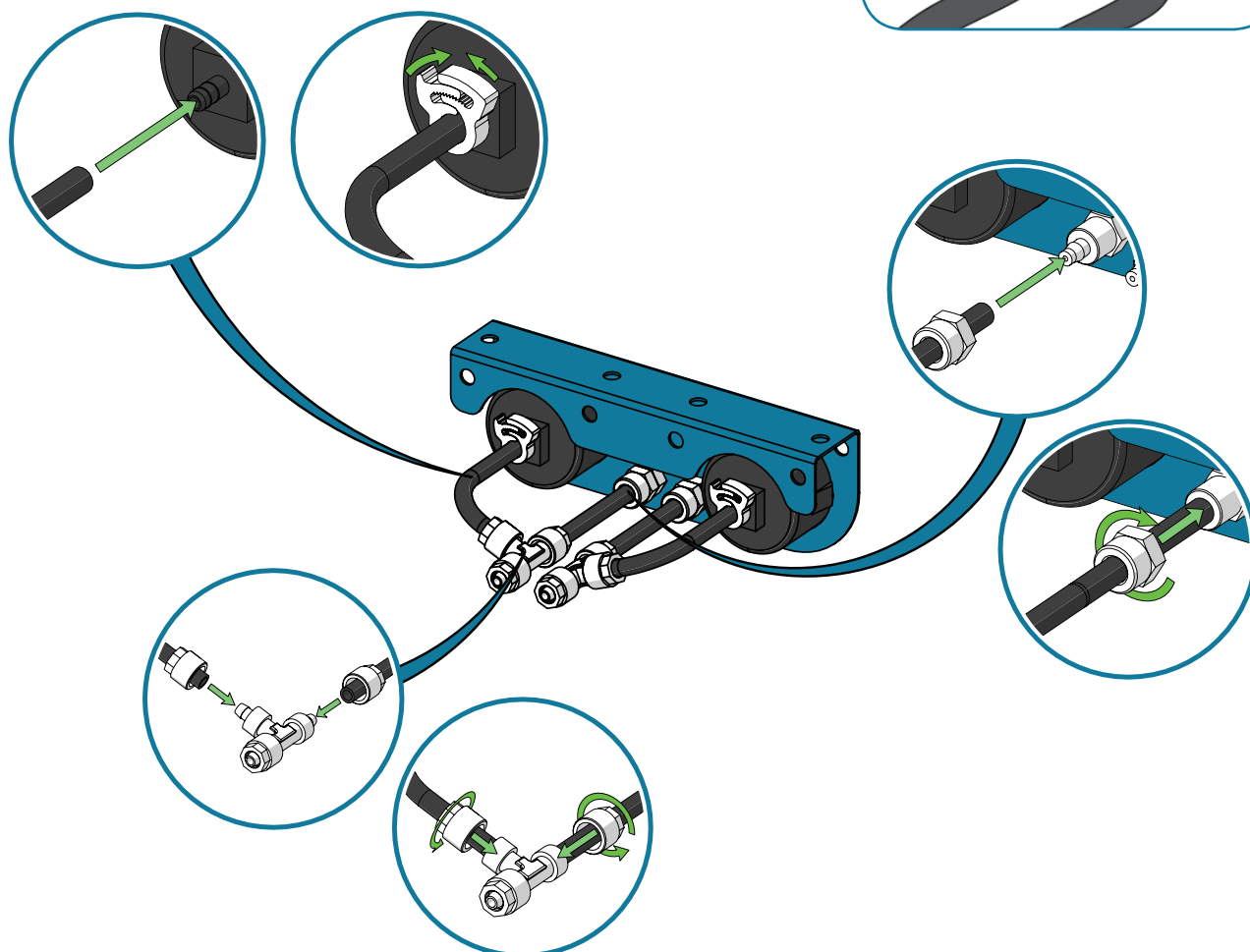

16

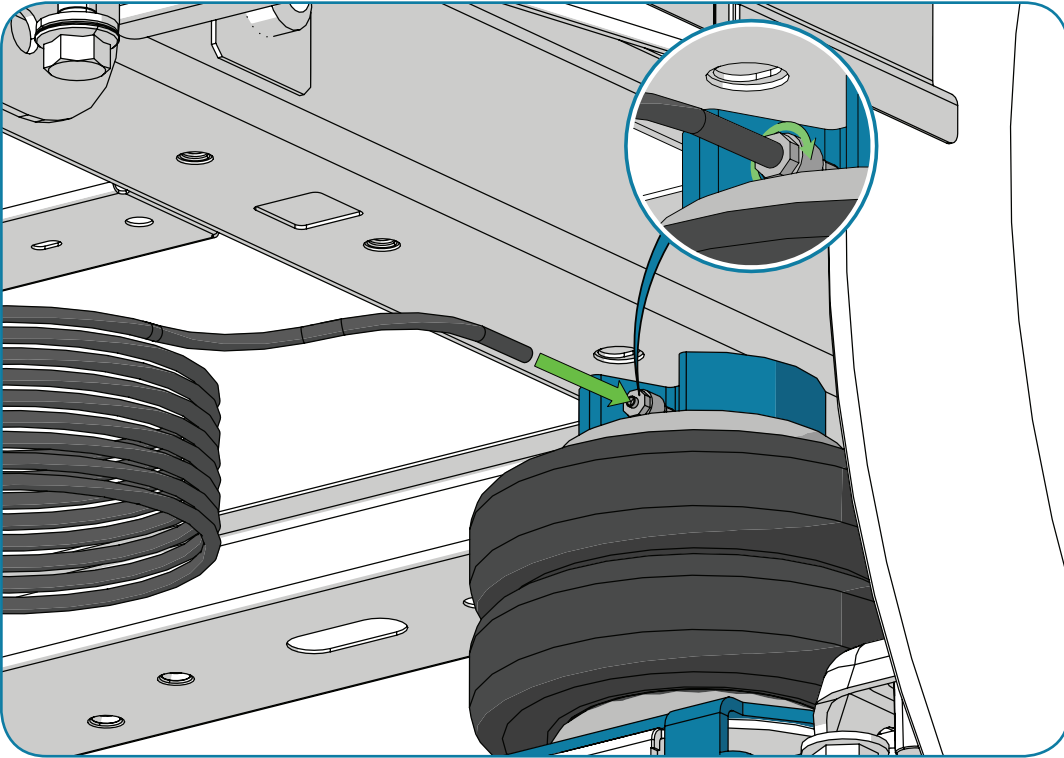

17

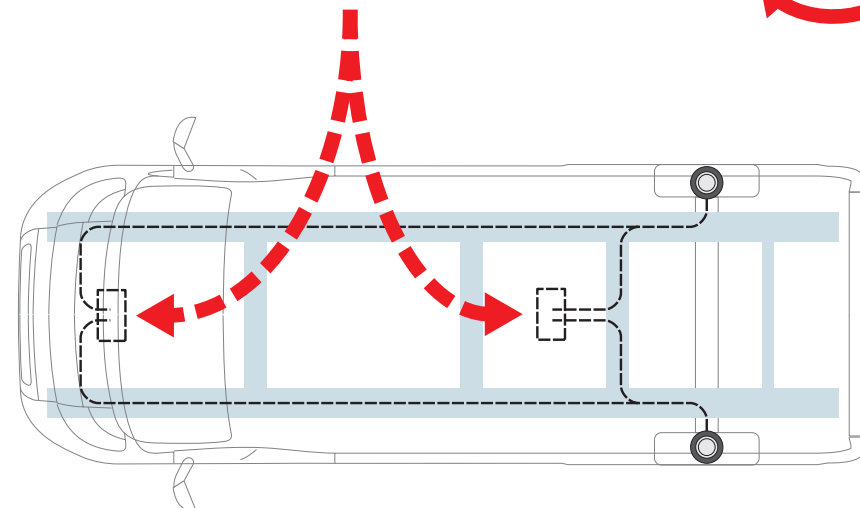
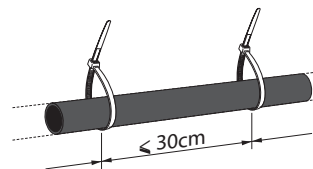
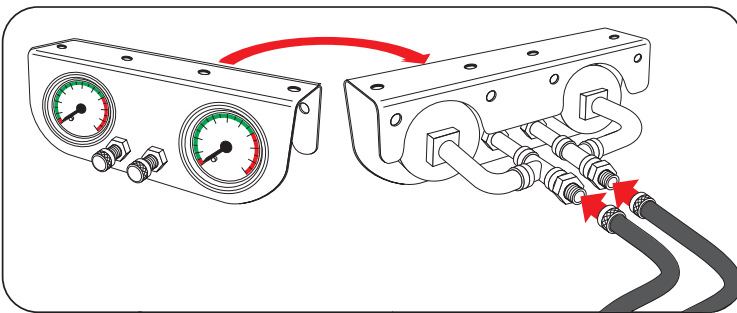

18

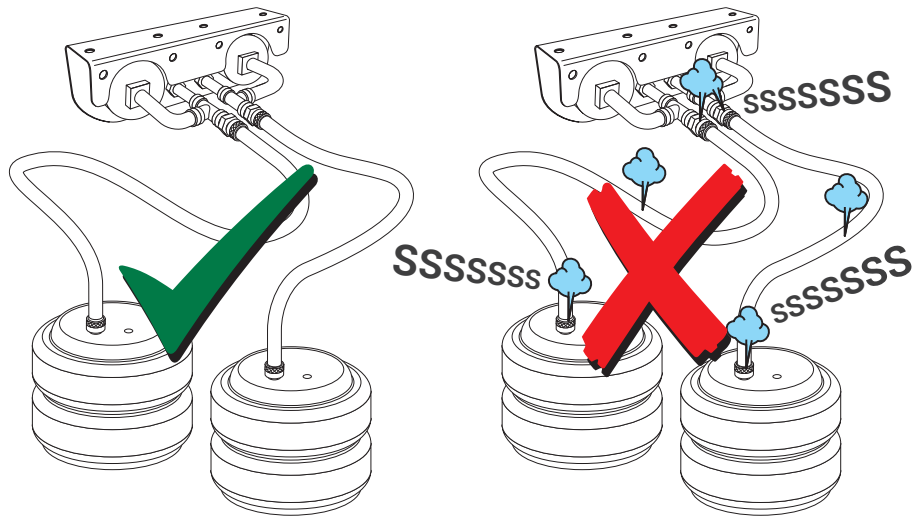

19

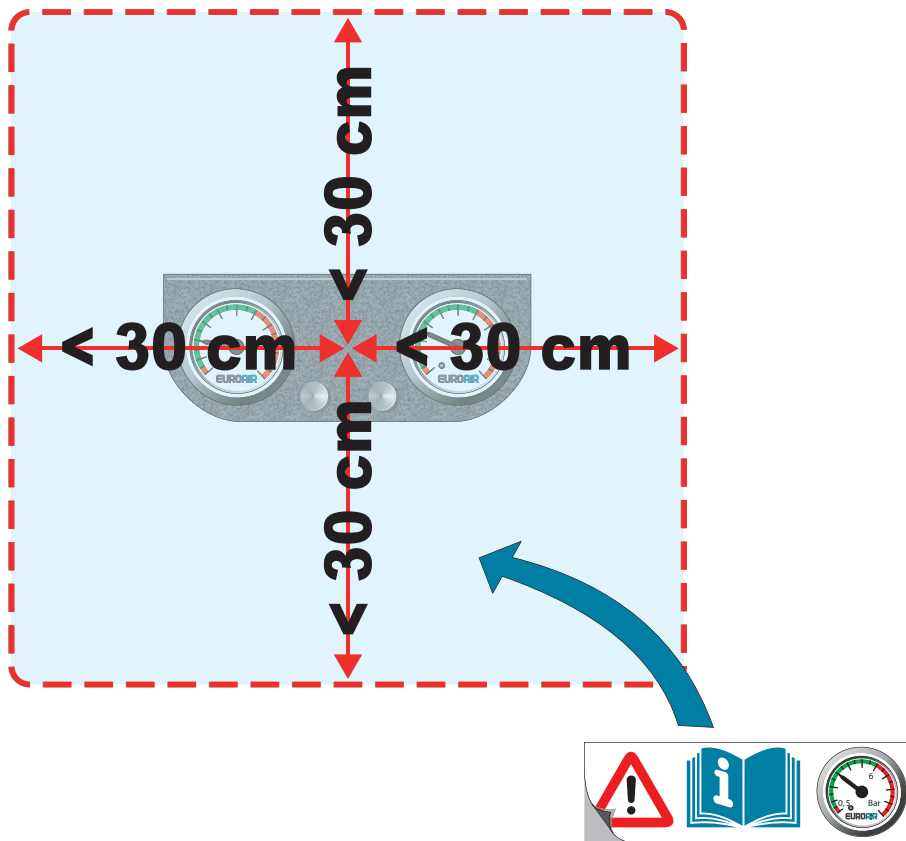

Notes

[illegible]

[illegible]

This image shows a single sheet of white paper with horizontal ruling lines. The lines are evenly spaced and run across the width of the page. There are no margins, text, or other markings on the paper.

EUROAIR

powered by **VB-air**suspension