

JOYROOM



User Manual

4-in-1 Card Reader

Preface

Thank you for choosing our products. Please read this manual carefully to further understand the product. Wish you have a happy experience!

Product introduction

1. With the product, documents, pictures and videos in SD/TF card can be easily transmitted to iOS device. And images, videos and documents in iOS device can also be transmitted to SD card.
2. With the product, images, videos and documents in iOS device can be sent to USB flash drive. And images, videos and documents in USB flash drive can also be saved in iOS device.
3. With the product, pictures and videos in digital cameras can be transmitted to iOS device.
4. The product can be connected to USB devices such as mouse, keyboard, sound card, microphone, electronic organ, USB earphones, etc.
5. Once connected with the iOS devices, the product will also charge for them.

Applicable devices:

Supported devices: iOS pad/iP,
Supported systems: iOS13 system
and above



Applicability

- Reading camera (FAT32/exFAT format, not supporting NTFS format)
- Reading USB flash drive
- Reading SD/TF card
- Connecting USB sound card
- Connecting USB microphone
- Connecting USB earphone
- Connecting USB keyboard
- Connecting USB mouse
- Connecting USB sound console
- Connecting USB electronic organ
- Connecting USB MIDI device
- Including but not limited to above devices

**The following USB devices are not supported:
(working current exceeds 500mAh)**

Hard disk / printer / recorder / portable WiFi / BT
converter / resonance chamber / gamepad

Note:

Some external devices may not support *systems* below iOS13. Please update your device to the highest system, so that you can use it normally.

Parameters

Product size	120±5 * 51 * 11 mm
Input	Lightning (for connecting with iOS device)
Output 1	Lightning (for charging)
Output 2	SD card
Output 3	TF card
Output 4	USB2.0 (for iOS pad/iP, it only supports USB2.0)
Charging current	5V $\overline{=}$ 2A (the current flow depends on the specifications of charger and data cable)

Initial setup

1. Start “USB Accessories” function in “Settings”.

Step 1:
Open “Settings”, find “Face ID and Passcode”.

Step 2:
Open “USB Accessories”.

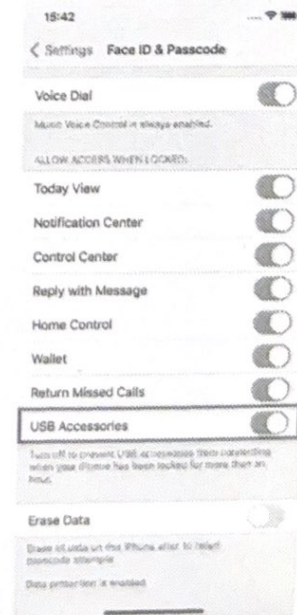

2. Start "Assistive Touch" function in "Settings".

Step 1:

Open "Settings",
find
"Accessibility".

Step 2:

Open "Touch",
find "Assistive
Touch".

Step 3:

Start "Assistive
Touch" function.

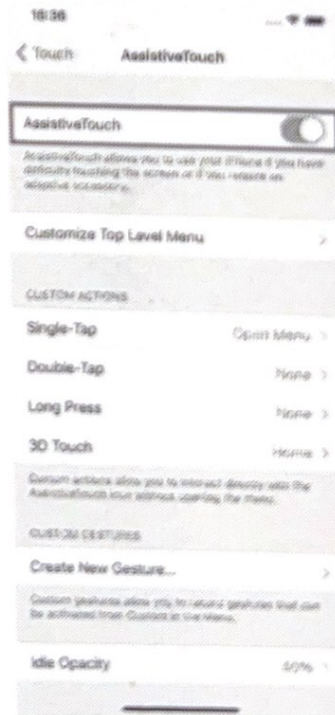
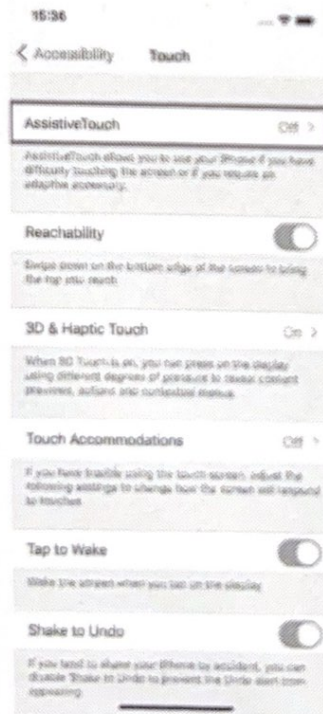
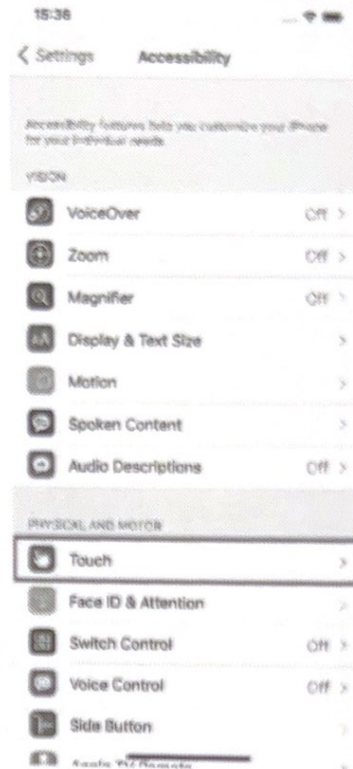
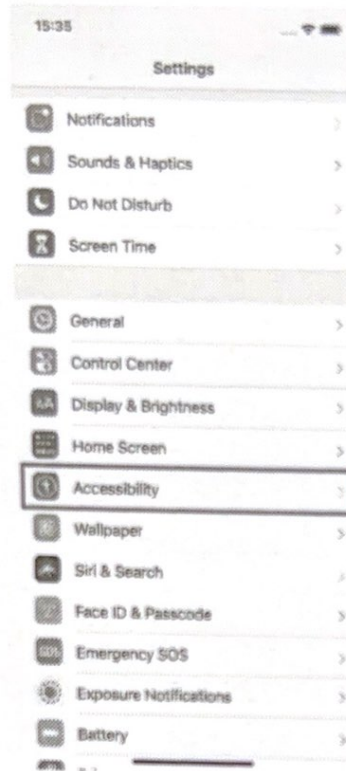

Operation instructions

1. How to transmit the contents in USB flash drive to iOS device.

Step 1: Connect the product with USB flash drive and iOS device correctly.

Step 2: Open "Files" in iOS device.

Step 3: Find "USB Flash Drive" in "Locations".

Step 4: Choose pictures & documents you want to transmit, and save them into the iOS device.

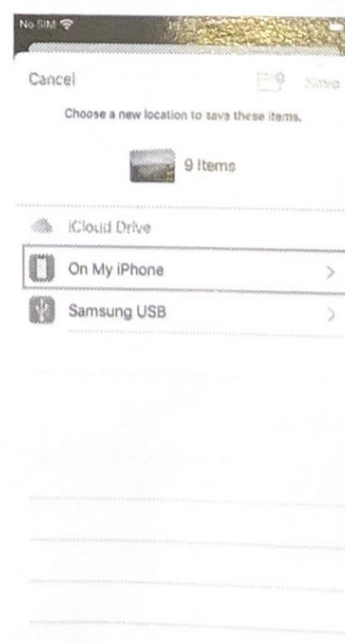
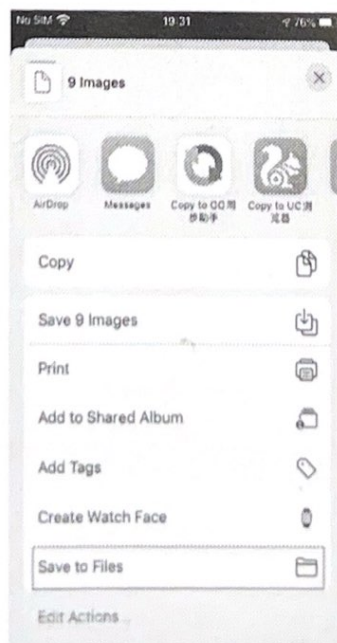
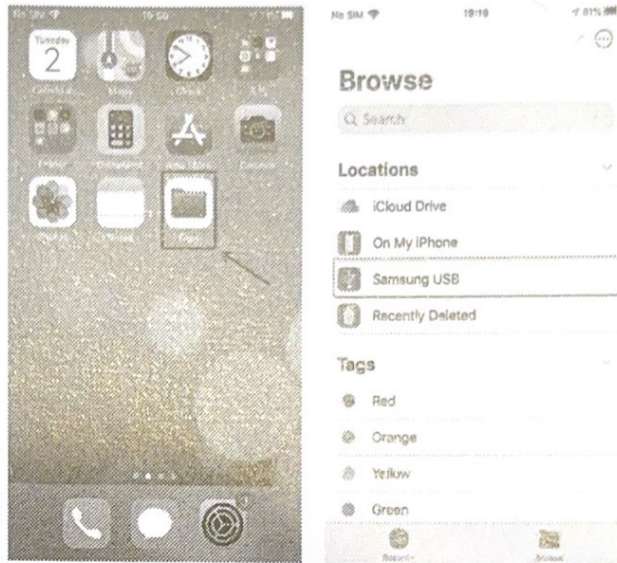

Notes:

- ① When inserting the USB flash drive, the iOS device may need 10s to 15s to read it.
- ② The USB flash drive does not have hot plug function and cannot be plugged repeatedly. Repeated plugging may cause the USB flash drive to be unreadable. You need to restart the mobile phone.
- ③ During use, the USB flash drive will heat up, which is a normal phenomenon.
- ④ Supporting FAT32/exFAT format, not supporting NTFS format.
- ⑤ Supporting USB flash drive with 1TB memory at most.

2. How to transmit the contents in iOS device to USB flash drive.

Step 1: Connect the product with USB flash drive and iOS device correctly.

Step 2: Open "Pictures" in iOS device.

Step 3: Choose pictures & documents you want to transmit.

Step 4: Save them into the USB flash drive.

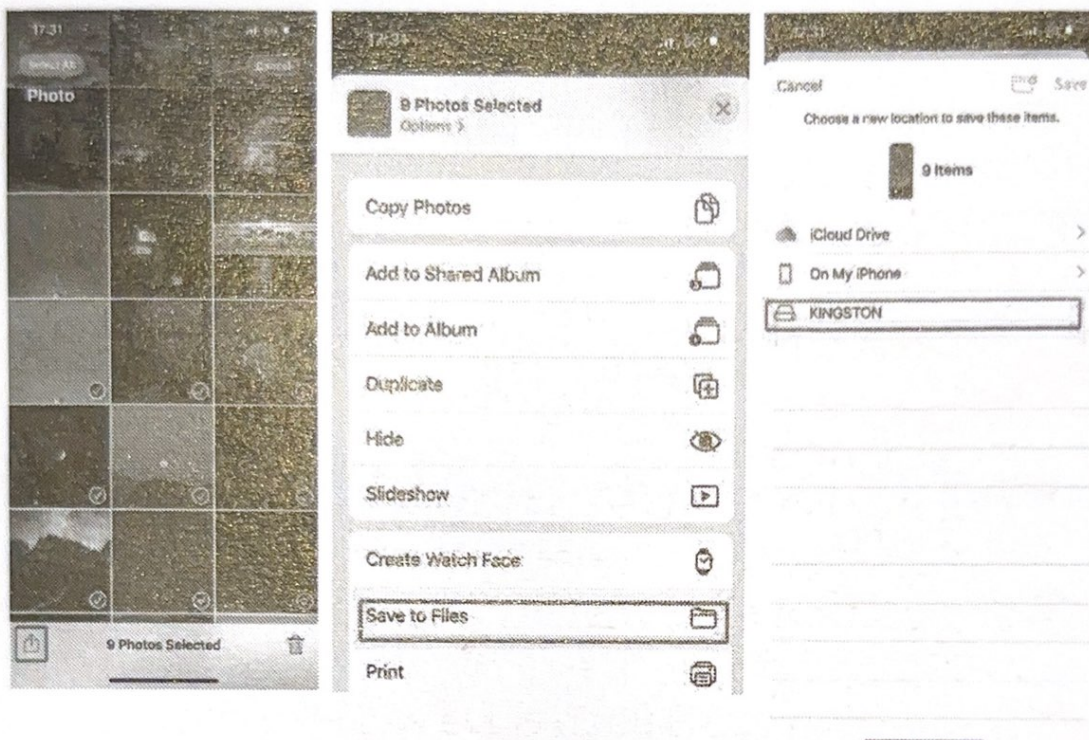

Notes:

- ① When inserting the USB flash drive, the iOS device may need 10s to 15s to read it.
- ② The USB flash drive does not have hot plug function and cannot be plugged repeatedly. Repeated plugging may cause the USB flash drive to be unreadable. You need to restart the mobile phone.
- ③ During use, the USB flash drive will heat up, which is a normal phenomenon.
- ④ Supporting FAT32/exFAT format, not supporting NTFS format.
- ⑤ Supporting USB flash drive with 1TB memory at most.

3. How to transmit the contents in SD/TF card to iOS device.

Please refer to "How to transmit the contents in USB flash drive to iOS device".

4. How to transmit the contents in iOS device to SD/TF card.

Please refer to "How to transmit the contents in iOS device to USB flash drive".

5. How to connect the USB devices.

If the iOS device has finished initial setup, you just need to connect the product with the USB and other devices correctly.

FAQ

The working principle of the product is to take power from iOS device through OTG mode to supply power to USB device, so as to drive the USB device. The maximum allowable current taken from iOS device is 500mAh, therefore, USB devices with power exceeding 500mAh cannot be used. There are many unknown USB devices, we cannot test the product with all USB devices. If you find that it cannot be connected normally, please refer to the following solutions or consult the seller how to deal with it.

1. When using USB devices, are there any requirements for iOS devices?

Please make sure the iOS device has been updated to iOS13 system and above.

2. After connecting the USB flash drive/SD/TF card, why can't the iOS device recognize it?

- ① Please make sure you operated correctly, find the show path of USB flash drive/SD/TF card.
- ② Please disconnect the product from the iOS device/USB flash drive/SD/TF card and try again.
- ③ Please restart the iOS device, and then reconnect it.
- ④ If above steps fail to solve the problem, it may be that the format of USB flash drive/SD/TF card is not supported. You can replace the USB flash drive/SD/TF card and then check whether it can be displayed normally.

3. After connecting the USB flash drive/SD/TF card, why the iOS device cannot play the video/ audio files inside?

- ① Limited by iOS device system, the format of audio/video files must be supported by iOS device.
- ② You can transmit the audio/video files to iOS device and play with other players.

4. After connecting the mouse, why the cursor cannot be displayed normally?

Before connecting the mouse, you need to start the "Assistive Touch" function of the iOS device.

5. After connecting the mouse, why the cursor moves in the opposite direction?

You just need to adjust the direction lock of the iOS device.

6. Why the USB device cannot be connected normally?

- ① Please make sure you operated correctly.
- ② Please disconnect the product from the iOS device/USB device and try again.
- ③ Please restart the iOS device, and then reconnect it.
- ④ If above steps fail to solve the problem, it may be that the power of USB device exceeds 500 mAh, the iOS device fails to supply power for it, thus it cannot be driven.