



4. Drying: Plug in external power supply, press the "touch button"  in the charging case for 2 seconds, and the charging box will enter drying mode. The left and right LED lights will turn off, and the middle LED light will turn blue. The drying temperature is 104±9 °F (40±5 °C), and the drying time is 3 hours.

● Internal power supply charging

1. Charging preparation: If no external power supply is connected, the charging case can charge the hearing aids. Press the fingerprint "touch button"  inside the charging case for 2 seconds. The LED light in the middle of the charging case will flash green, indicating that the case is ready to charge the hearing aids. If the hearing aids are not placed in the charging case, the left and right LED lights turn off, and the middle LED light flashes.

2. Charging: Place the left and right hearing aids into their corresponding charging ports. The left and right LED lights will turn blue, and the middle LED light will turn green.



3. Fully charged: All three LED lights will be green. After 30 seconds, all LED lights will turn off.

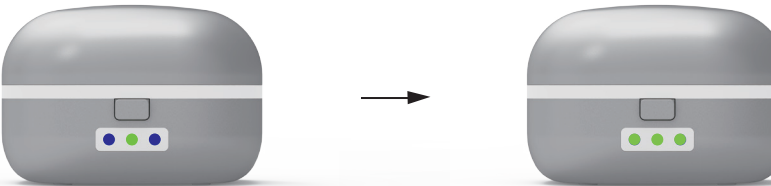

Charging

Fully Charged

4. Turn Off Charging: Press the "touch button"  in the charging case for 2 seconds to turn off the internal power supply charging. All LED lights will then turn off.

● Working Condition Of The Charging Case

	Left light	Middle light	Right light
Case connected, hearing aids not inside	off	Green (flashing)	off
Charging	Blue	Green	Blue
Fully Charged (external power source)	Green	Green	Green
Fully Charged (internal power source)	Green(shut off after 30sec)	Green(shut off after 30sec)	Green(shut off after 30sec)
Drying	off	Blue	off
Drying Complete	Green	Green	Green

Troubleshooting

● Low Sound Or No Sound

1. Adjust the volume control or the mode.
2. Make sure the hearing aids have enough charge.
3. Check if the receiver and microphone are blocked and clean them with the cleaning brush.

● Charging Issue

1. Check if the output of the adapter is 5V/1A or lower, replace the adapter or charging cable if needed.
2. Check if there are any stains on the charging contact points of the hearing aid or the charging case, and wipe them clean with a paper towel or dry cloth.
3. Connect the power supply and unplug the charging cable from the charging case several times.
4. Pick up the hearing aids and put them back into the charging case 2-3 times, and observe if the LED light turns blue.

Hearing Aid User Manual

Turning On/Off And Wearing

Turning On/Off

When you take the hearing aids out of the charging case, they will turn on automatically.

When you put the hearing aids into the charging case, they will turn off automatically.

Choosing ear domes

Please select ear domes that fit the size of your ear canal and ensure they are securely in place.

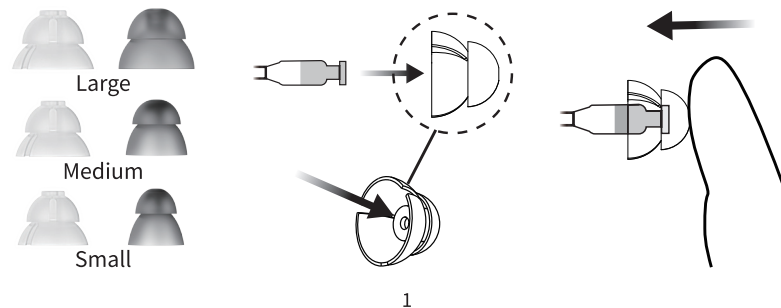

Wearing Hearing Aids

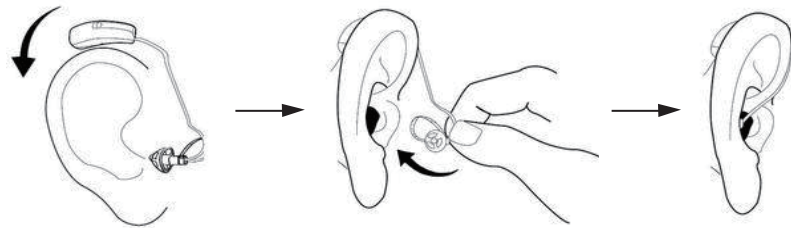

Functional Operation

Product Structure

1. Microphone
2. Up Button/Volume Up+
3. Down Button/Volume Down-/Switching Mode
4. Charging Contact
5. Receiver
6. Ear dome

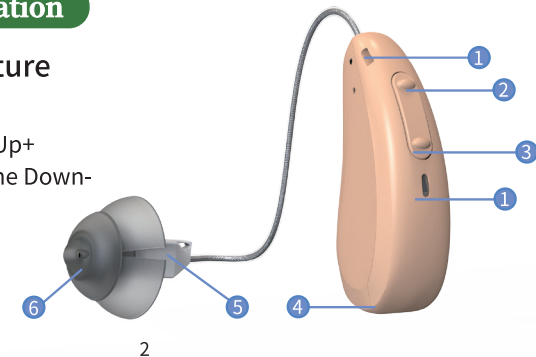

Adjusting Volume

There are 9 levels of volume, press for 1 second to adjust the volume. The "Up Button" is volume up, and the "Down Button" is volume down. For each change in sound level, a beep will be heard. The max and min sound levels will be indicated by 2 beeps.

Switching Mode

There are 4 modes available: Normal, Outdoor, Party, and TV. Press and hold the "Down Button" for 2 seconds to switch modes. You will hear: 1 beep for Normal, 2 beeps for Outdoor, 3 beeps for Party, 4 beeps for TV.

Charging

Charging Case

1. Drying Holes
2. Touch Button
3. Charging Port
4. Open Button
5. LED Light

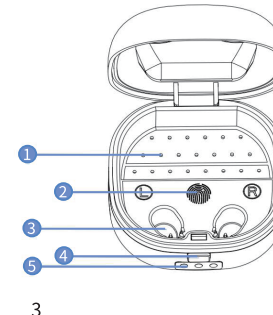

Make sure to close the lid of the charging case after placing the hearing aids inside.

The charging case charges the hearing aids using two methods: it can charge from an external power source or utilize its internal power source.

External power supply charging

1. Preparing to Charge: Take out the Type-C charging cable, connect the 5V/1A adapter to the Type-C port on the charging case and the case will enter standby mode. If the hearing aids are not in the case, the left and right LED lights will turn off, and the middle LED light will flash.

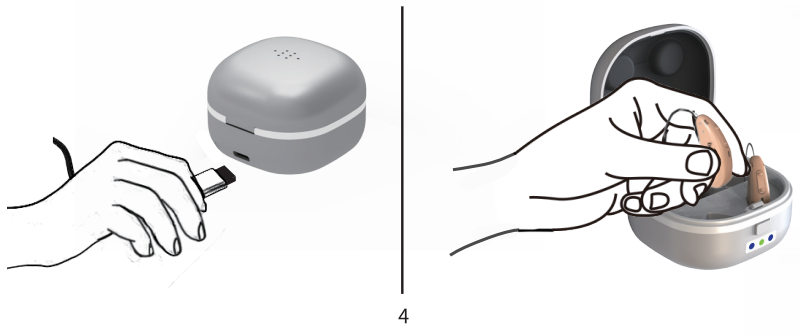

2. Charging Process: Place the left and right hearing aids into the left and right charging ports respectively. The left and right LED lights will be blue, and the middle LED light will be green throughout the charging period.

3. Fully charged: All three LED Lights will be green; After charging, you may unplug the case from the power supply.

