

Thank you for purchasing our
**Cresco 10SW Fertilizer and
Salt Spreader**



**We're delighted to have you as a customer
and are here to help! First off, let's get your
product assembled!**

Table of Contents:

- 1:** Spare Parts
- 2-6:** Assembling your Cresco 10SW
- 7-9:** Slide System Explanation
- 10-13:** How to Use the Cresco 10SW
- 14:** Application Guide for Fertilizer
- 15:** Warranty

Scan for video assembly:



Spare Parts

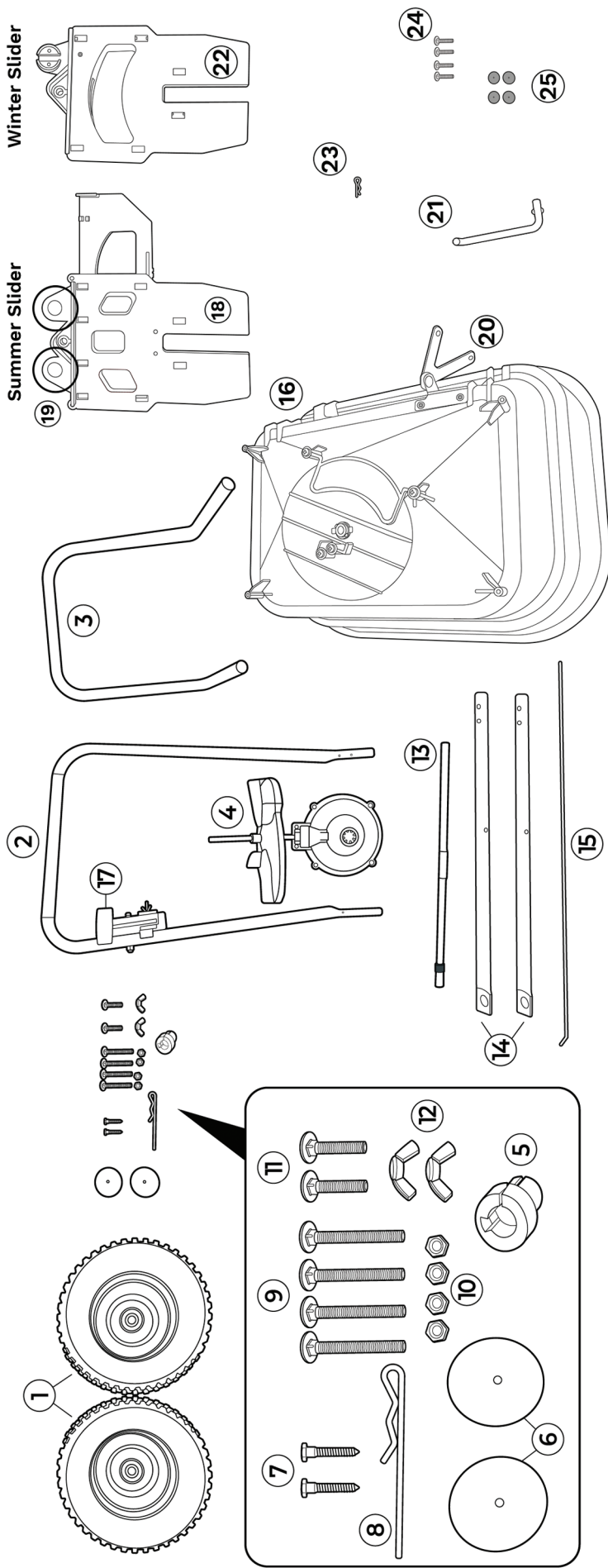

Empty all contents of the box onto a flat surface and count parts to make sure all are there.

CRESCO 10 PARTS LIST:

1. Wheel (X2)
2. Handle Bar
3. Stand
4. Gear box and Impellor
5. Axle bearing (X2) (One is on the axle, the second one is in the parts pack)
6. Plastic Wheel Caps
7. Wheel Cap Screws
8. Agitator
9. M6x60 (X4)
10. M6 Nuts (X4)
11. M6x35 (X2)
12. M6 x Wing Nut (X2)

13. Plastic Wheel Axle (With part 5 attached)
14. Lower Frame (X2)
15. Control Rod
16. Hopper Body
17. Control Lever
18. Summer Slider
19. Adjustors (Left/Right)
20. Pivot Bracket
21. Lower Linkage
22. Winter Slider
23. R-pin Small
24. 4x Screws
25. 4x Washers

Scan to view and purchase spare parts:

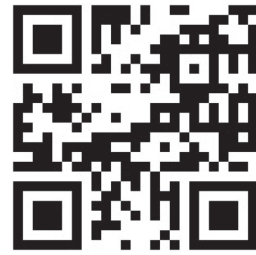

Slide System **Explanation**

Your Cresco spreader comes with two different application sliders.
One is for winter and the other is for summer!

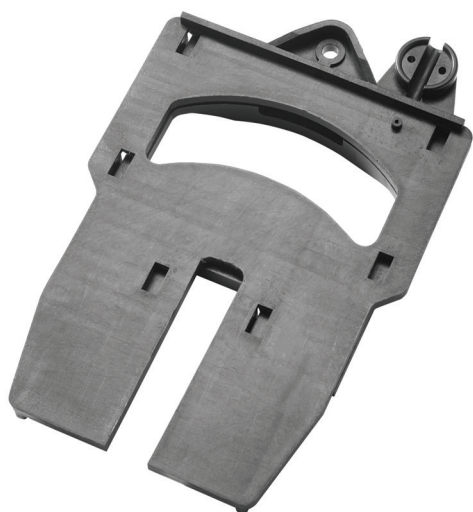

Winter Slider

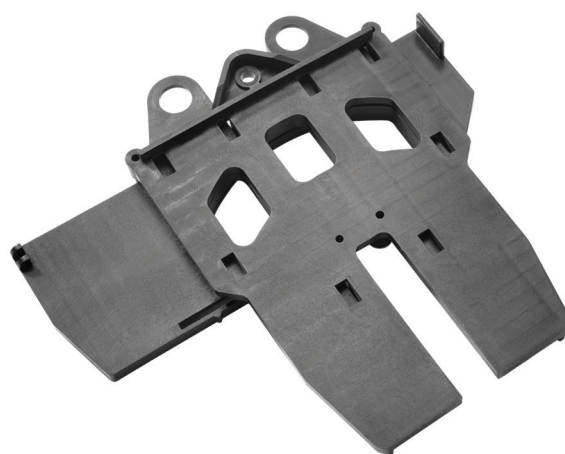

Summer Slider

Please locate and choose your slider.

Assembling your **Cresco 10**

ASSEMBLING THE SLIDER SYSTEM, LINKAGE & LOWER FRAME:

Video instructions available on front page:

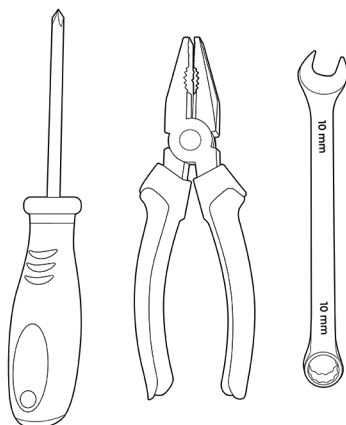

You will need a phillips head screwdriver, one pair of plyers/grips and an m6 metric spanner.

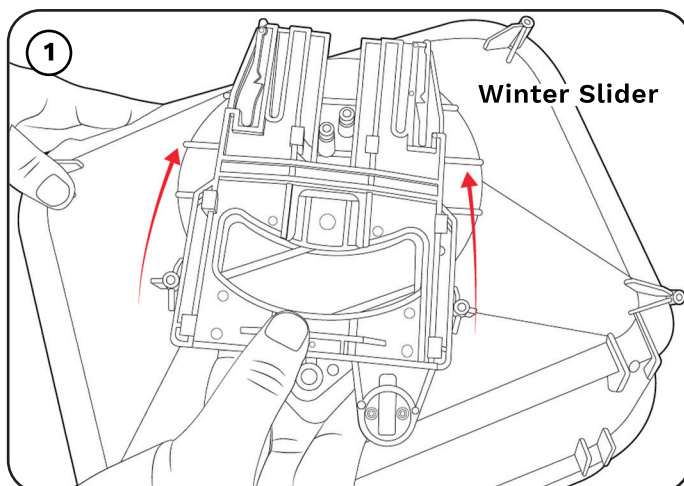

If you are using the spreader for winter, slide the winter application into position as shown above.

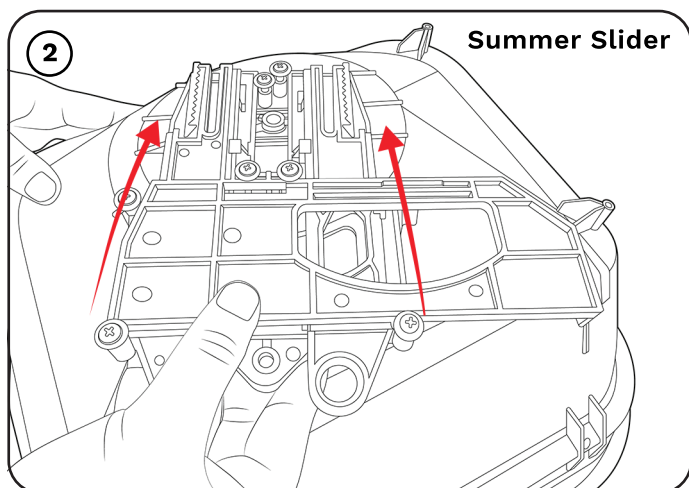

If you are using the spreader for fertiliser or seed, slide the summer application into position as shown above.

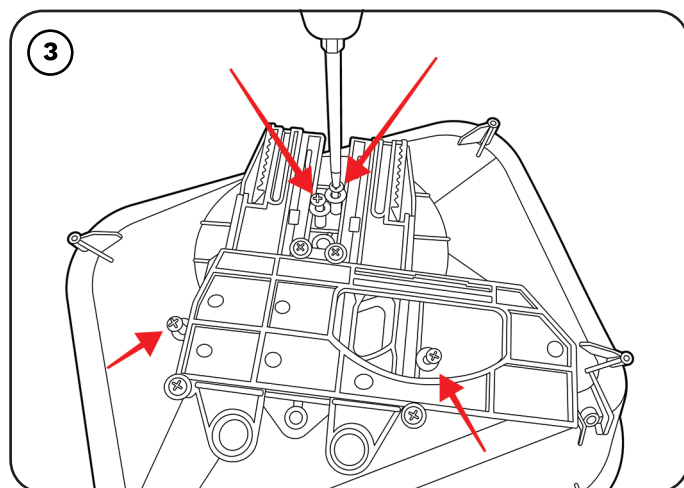

Locate & tighten the 4 screws & washers to fix the required slider (winter or summer) into position. Make sure the screws are not overly tight and the slider can slide backward and forward.

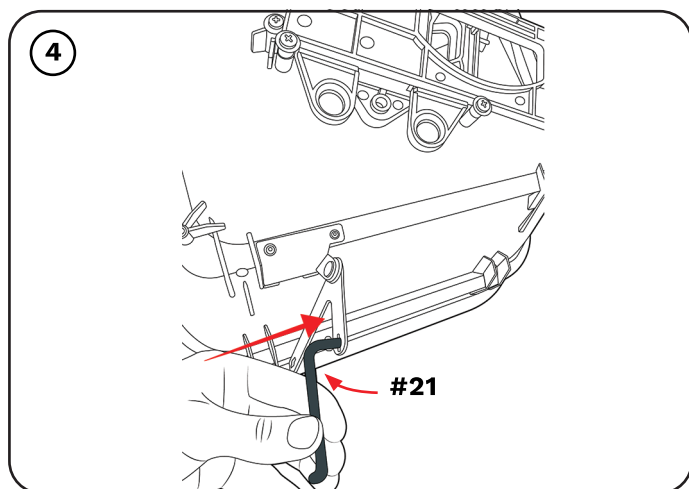

Locate the lower linkage (21) and place it through the pivot bracket (20).

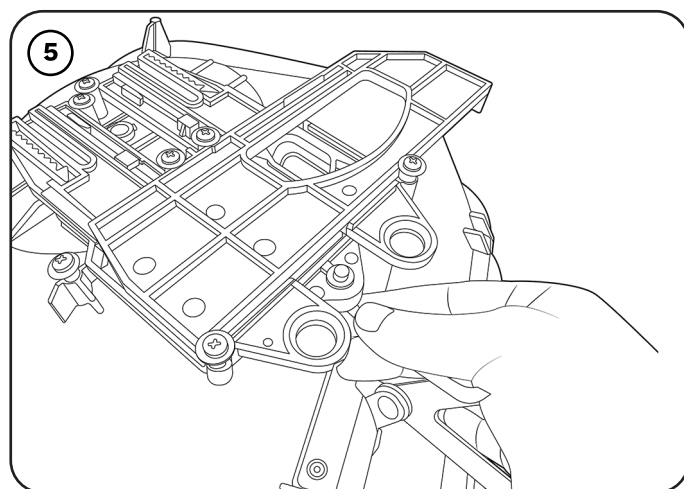

Push the free end of the lower linkage (21) through the centre hole of the chosen slider.

Video Instructions - URL:
<https://crescospreaders.com/product/spreaders/estate/cresco-10sw>

Assembling your **Cresco 10**

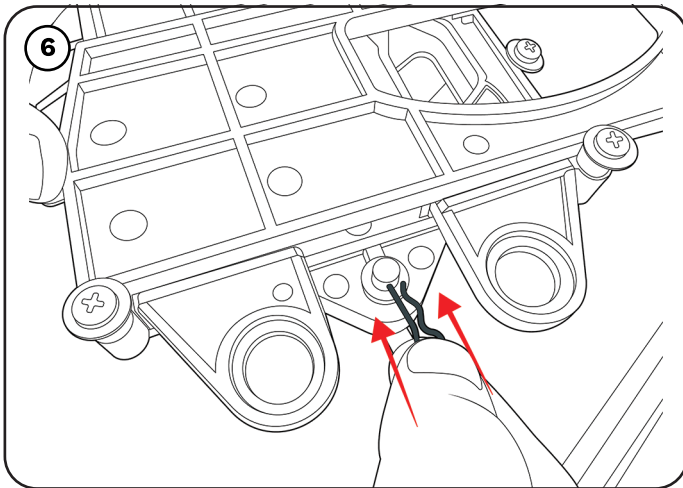

Secure the lower linkage (21) in place using the R pin small as shown.

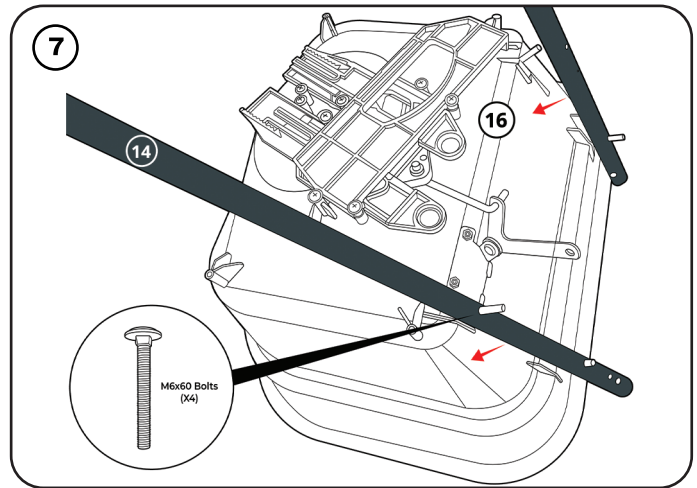

Take the two lower frames (14) and attach them to the hopper body (16) using the M6x60 bolts (9). **SEE NOTE.**

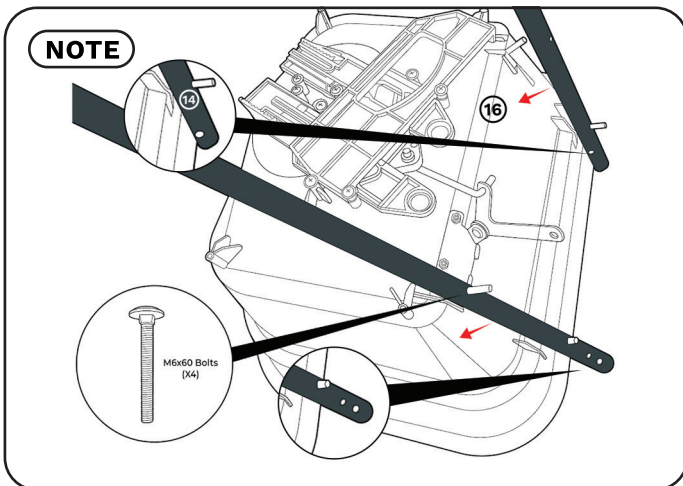

When placing the legs on the hopper, make sure the two holes on the side of the lower frame (Item 14) are on the outside. There should be one hole on the inside.

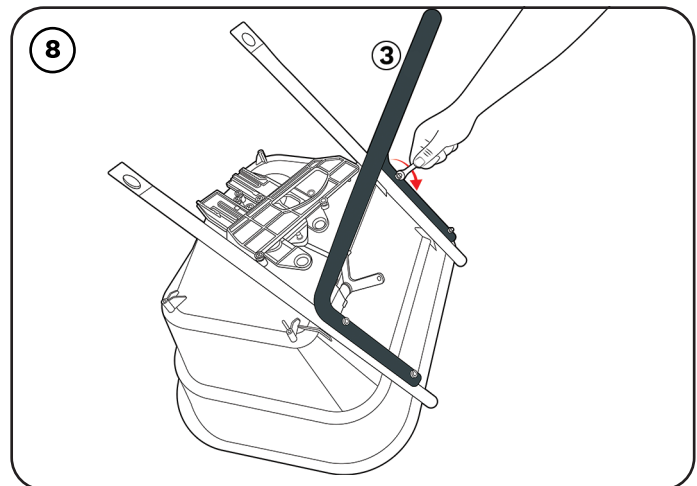

Take the stand (Item 3) and place it into the protruding M6x60 bolts (x4) (Item 9). Tighten with the M6x30 lock nuts (x4) (Item 10).

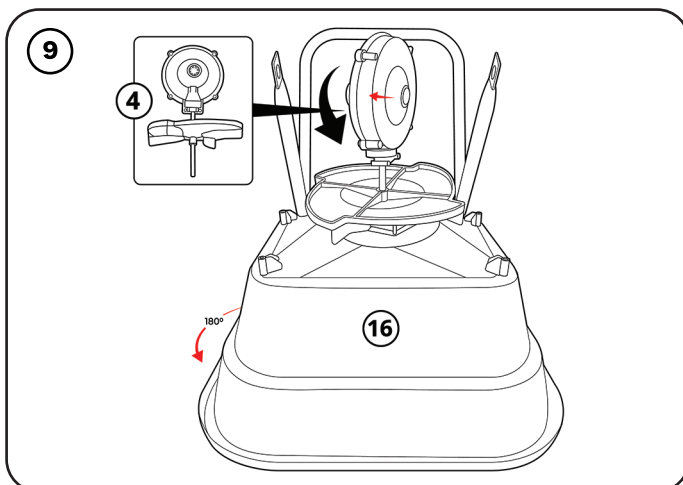

Rotate the hopper body (16) to the position shown. Place the gear box and impeller (4) in the centre hole of the hopper body (16), let it rest there. **Make sure the arrow on the gearbox faces forwards.**

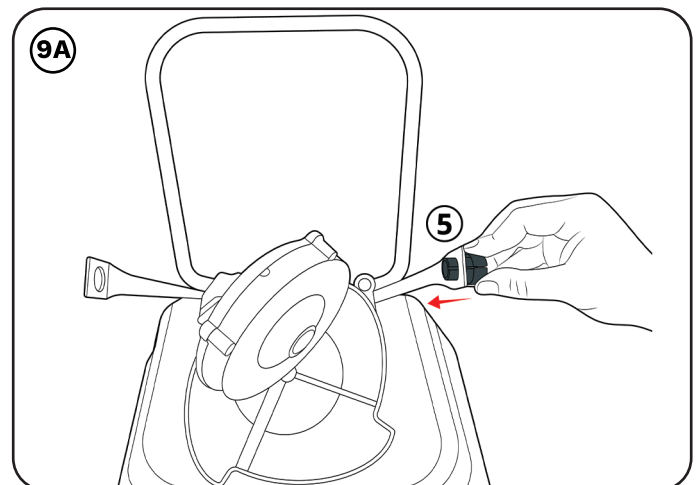

Place the one axle bearing (Item 5) into the hole shown at the bottom of the lower frame (14).

Assembling your **Cresco 10**

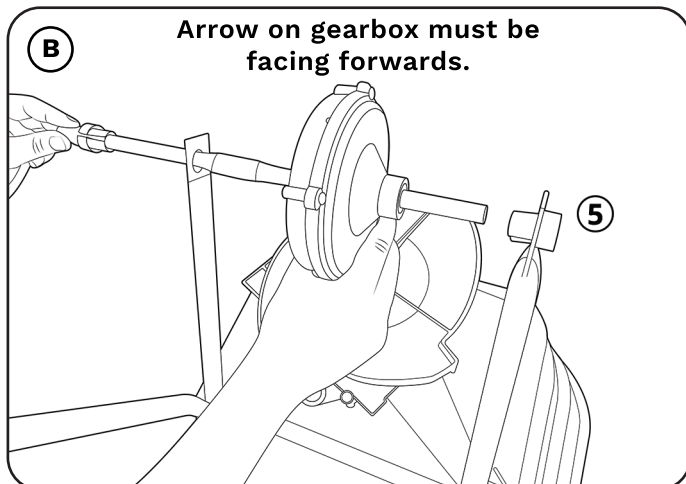

Feed the axle (13) through the hole (without bearing) on the lower legs. Push it through the gearbox and bearing (Item 5) on the other side. **Ensure the axle bearings are firmly in.**

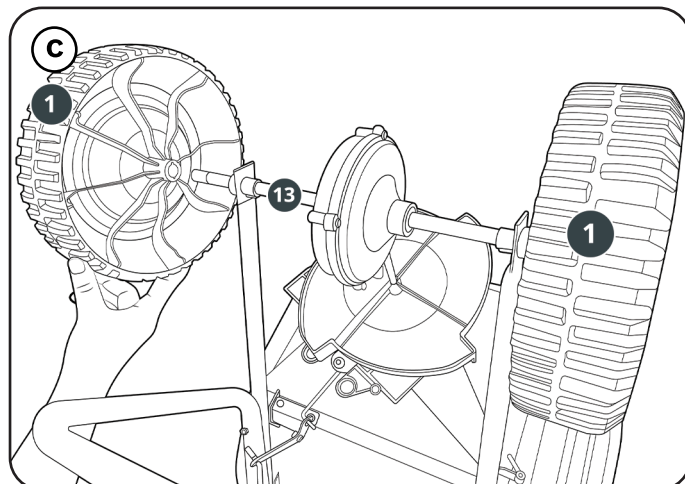

Place both wheels (Item 1) onto the ends of the axle (Item 13).

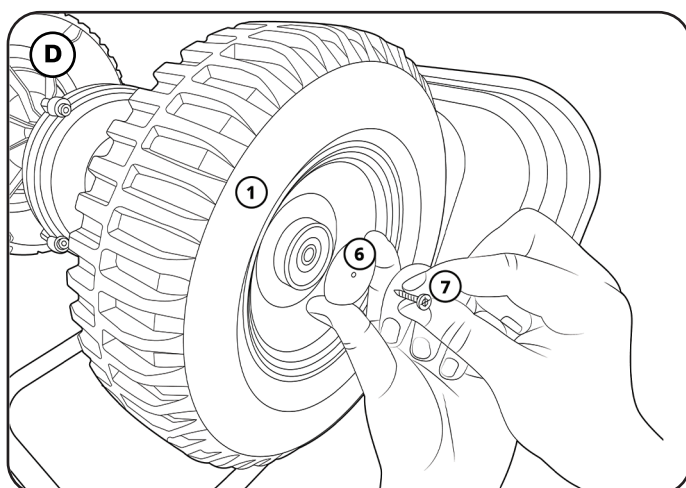

Push the plastic end cap (6) into the centre hole of the axle. Use screwdriver and wheel cap screws (7) to tighten. Complete on both sides.

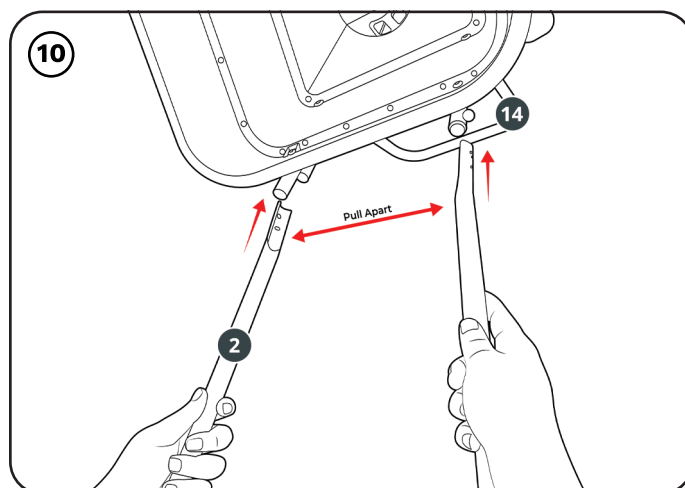

Turn the spreader onto its wheels and ensure they work correctly. Align the holes at the bottom of the handle bar (item 2) with the holes at the top of the lower frame (item 14). You may need to pull the ends apart slightly to place in position.

ASSEMBLING THE HANDLE BAR AND CONTROL ROD:

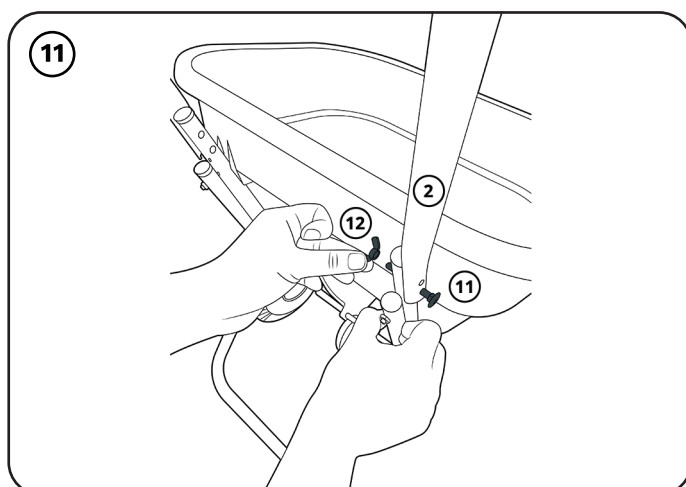

Use M6x35 (11) and M6 wingnuts to tighten as shown. Repeat on both sides.

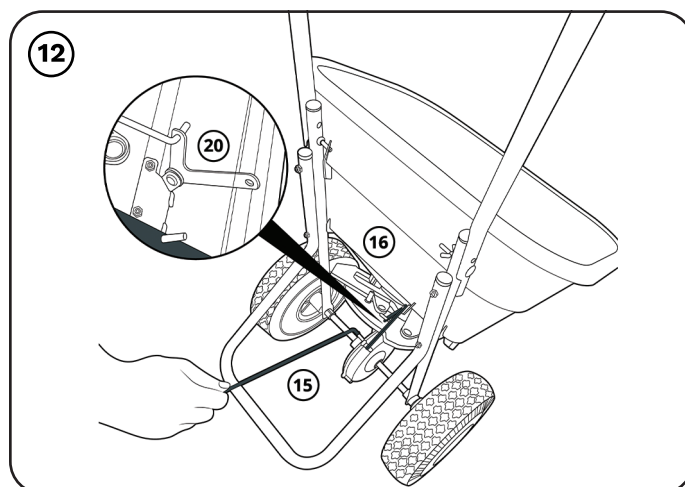

Protruding from the back of the hopper body (item 16) is the pivot bracket (20) pictured above. Clip the L shaped end of the control rod (item 15) into the hole on the pivot bracket (item 20).

Assembling your **Cresco 10**

FINAL TOUCHES:

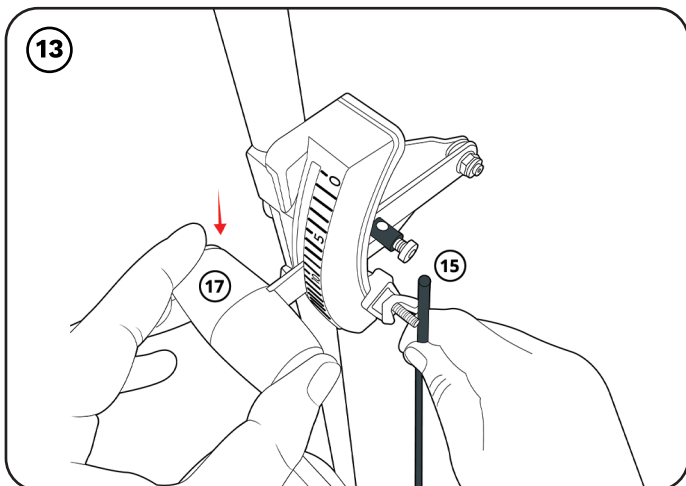

Feed the other end of the control rod (item 15) through the hole of the control lever (17). Make sure you push the control lever all the way to setting 20. Do not tighten into place.

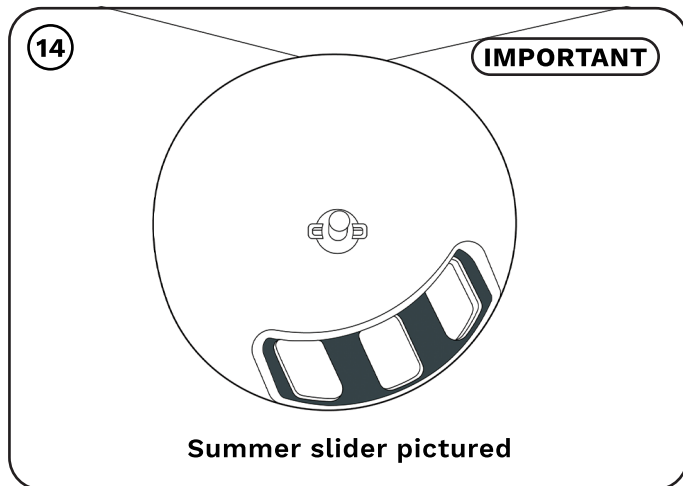

Before tightening the control rod. Make sure the application holes in the hopper are fully open and the control lever is set at 20.

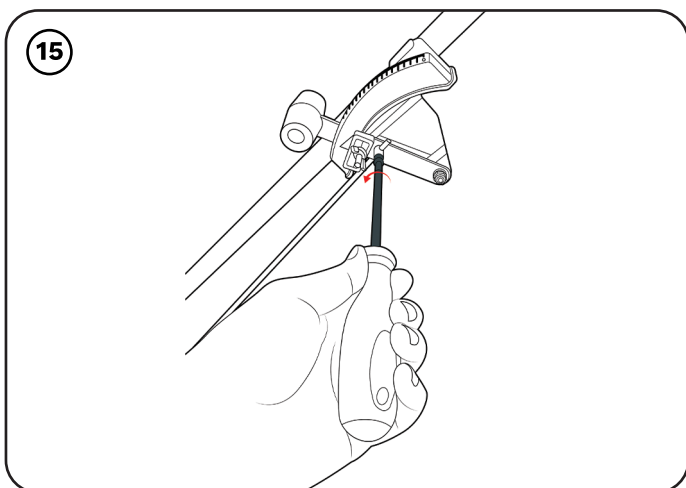

With the hopper aperture fully open (as in figure 13) and the gauge lever set at 20, tighten the screw firmly to secure the control rod.

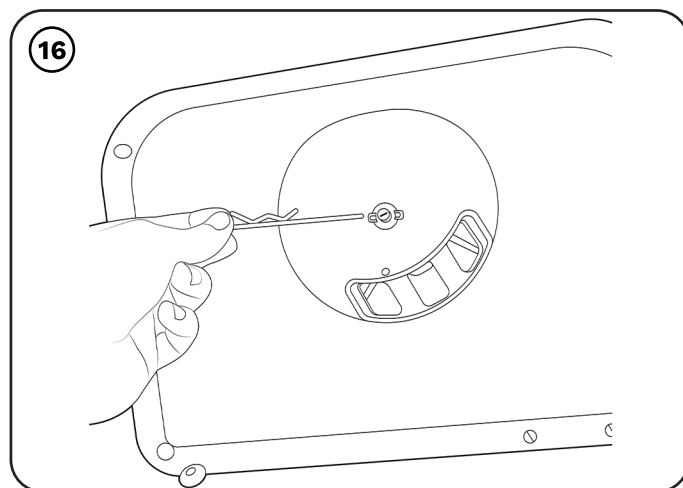

Affix the agitator pin (Item 8) through the impellor shaft inside the hopper.

If at any point you become stuck, please visit our Youtube channel for video instructions and tips.

Slide System **Explanation**

Winter

For spread width 6 meters.



Pavement setting (2 meters).



Ice Melts



Summer

The summer slide system comes with 20 different settings and a border control. This slider provides control over the accuracy of your spreading.

Large/Heavy Materials



Small/Light Materials





















Border Control



To protect your borders simply slide the border control into position to cut off the left hand side of the spread pattern.











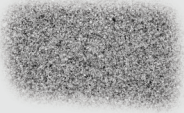

Slide System **Explanation**

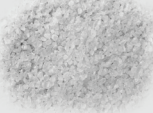

PRODUCT		SUMMER SLIDER	SLIDER ADJUSTER SETTINGS	
	POWDERED OR MICRO GRANULAR FERTILIZER		NO ADJUSTMENT OF EITHER SLIDER RECOMENDED	
	MEDIUM GRANULAR FERTILIZER		NO ADJUSTMENT OF EITHER SLIDER RECOMENDED	
	LARGE GRANULAR FERTILIZER		ADJUSTMENT OF THE LEFT SLIDER RECOMENDED 6-7 CLICKS	
	GRASS SEED OR VERY LIGHT MATERIALS		ADJUSTMENT OF THE RIGHT SLIDER RECOMENDED 3-4 CLICKS	
	PELLETED MATERIALS		ADJUSTMENT OF THE LEFT SLIDER RECOMENDED (SELECT CLOSED)	
	LARGE GRANULAR ICE MELTS		ADJUSTMENT OF THE LEFT SLIDER RECOMENDED (SELECT CLOSED)	

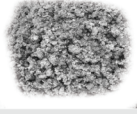
WINTER SLIDER

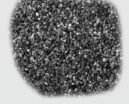
** Please note this chart is a guide only. Due to variations in the spreading characteristics of materials, accurate calibration should be carried out by the operator for each different material being applied. **

	SHARP SAND		FULL OR REDUCED WIDTH SLIDER OPTION RECOMENDED	
	FLOWABLE SAND / SOIL MIX		FULL SLIDER WIDTH USE RECOMENDED	
	COARSE MARINE SALT		FULL OR REDUCED WIDTH SLIDER OPTION RECOMENDED	
	ROCK SALT		FULL SLIDER WIDTH USE RECOMENDED	
	GRIT MATERIALS		FULL SLIDER WIDTH USE RECOMENDED	

WWW.CRESCOSPREADERS.COM

DMMP Limited is not responsible for misapplication due to incorrect use or incorrect calibration of Cresco spreaders, and any other DMMP Limited spreader brands.
For calibration information please refer to "how to calibrate" section on the Cresco website.



How to use the **Cresco 10**

How to Apply Fertilizer to your lawn like a pro in four steps!

Step 1: Understanding the application rate and settings

Step 2: Preparing the Spreader

Step 3: Walking Patterns for the optimum application

Step 4: Cleaning & Maintenance

Step 1: Understand the application rate and settings

Application Rate Settings

Check the back of the fertilizer bag to find out the recommended G/m² and spreader application setting.



If the spreader setting is not on the back of the bag, please get in touch with your fertilizer bag provider.



Set the handle to the correct setting.



If you are unable to find the required Cresco volume setting, please visit,
www.crescospreaders.com

How to use the **Cresco 10**

Spread Pattern Settings

Once you have the correct application rate, you will need to check that the spread of material is even on both sides of the spread pattern.

To balance the spread pattern for your material, check online or with your fertilizer or seed provider.

For a quick reference, please refer to our guide on the previous page.

 CRESCO SLIDE-SYSTEM TECHNOLOGY SETTINGS		 TWO SEASONS. ONE SPREADER.	
PRODUCT		SUMMER SLIDER	SLIDER ADJUSTER SETTINGS
 POWDERED OR MICRO GRANULAR FERTILIZER		NO ADJUSTMENT OF EITHER SLIDER RECOMENDED	
 MEDIUM GRANULAR FERTILIZER		NO ADJUSTMENT OF EITHER SLIDER RECOMENDED	

Step 2: Preparing the Spreader

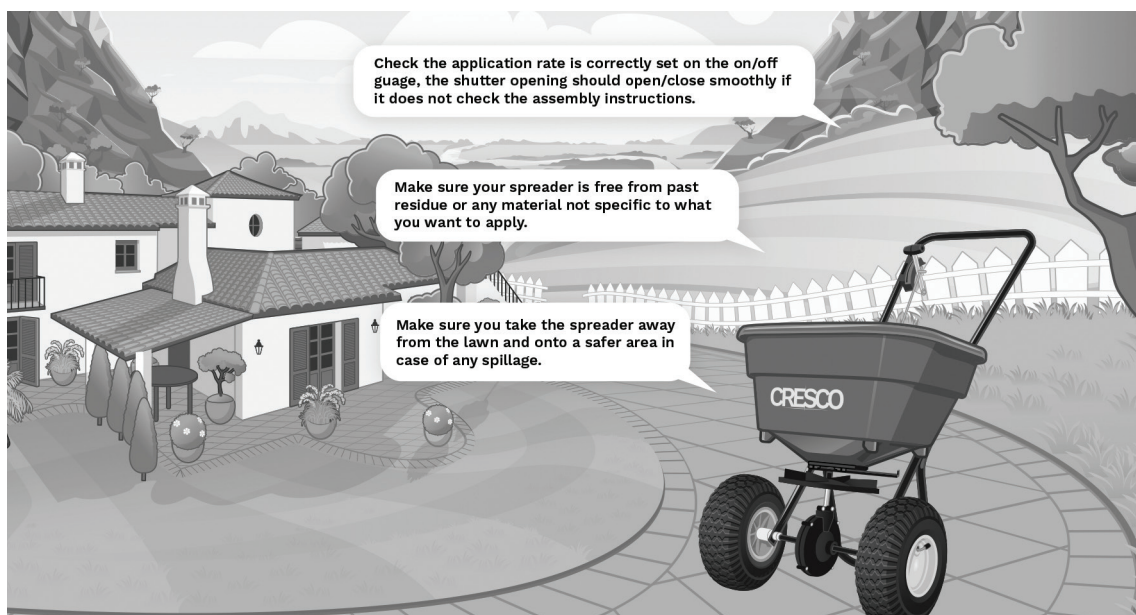

Check the material to be applied is dry and free flowing to ensure it will flow freely through the hopper. Make sure your application rate and spread pattern settings are correct, **close the application hole fully** and then pour in your material.

How to use the **Cresco 10**

Your outlet hole should look like this you pour in any material.



WARNING **Do not pour material in the hopper when the application holes are open as it can lead to spillages or leaks that can damage the area. Do not open the gauge until you are over the area you want to spread and are moving at a brisk walk***

Step 3: Walking Patterns for the optimum application (For Fertilizer Only)

There are two methods of effective spreading, longitudinal fertilizer spreading and cross sectional fertilizer spreading.

When applying fertilizer please make sure you walk at 3mph and keep the hopper in a stable, upright position.

How to use the **Cresco 10**

Longitudinal Fertilizer Spreading

½ the application rate suggested on the back of your fertilizer bag

Cover the area as shown by going over your tire marks left on the previous pass

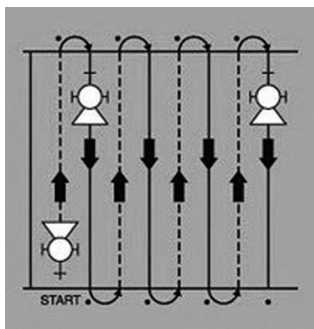

Cross Sectional Fertilizer Spreading

½ the application rate suggested on the back of your fertilizer bag

Cover the area as shown making the second pass at the edge of your spread pattern or where the fertilizer thrown begins to feather.

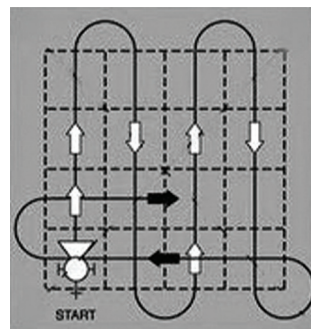

Step 4: Cleaning and Maintenance

CLEANING THE SPREADER THOROUGHLY WILL SIGNIFICANTLY ENHANCE THE LIFESPAN OF YOUR SPREADER AND IMPROVE IT'S ABILITY TO SPREAD EVENLY NEXT TIME YOU USE IT.



Calibration Setting Guide

Speed													
Mph	3												
Kph	4.828												
Metres p/Sec	1.34												
Product		05mm - 1mm				1mm - 2mm				3mm - 5mm			
Width	Metres	3.5	3.5	3.5	3.5	4.0	4.0	4.0	4.0	4.5	4.5	4.5	4.5
Application Rate	Grams /Sq M	20	35	50	50	20	35	50	50	20	35	50	50
Run Time	Secs	10	10	10	10	10	10	10	10	10	10	10	10
Distance	metres	13.4	13.4	13.4	13.4	13.4	13.4	13.4	13.4	13.4	13.4	13.4	13.4
Area	Sq Metres	47	47	47	47	54	54	54	54	60	60	60	60
Target Weight	Grams	938	1,876	3,015	3,015	938	1,876	3,015	3,015	938	1,876	3,015	3,015
Setting		8.5	11	14	14	11	13.5	19.5	13	18	7 Clicks LHS	16 (X2)	7 Clicks LHS
Slider Position		-	-	-	-	-	-	-	7 Clicks LHS	7 Clicks LHS	7 Clicks LHS	7 Clicks LHS	7 Clicks LHS

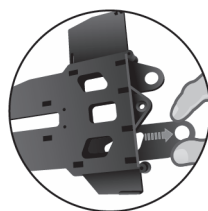

Left hand slider adjuster

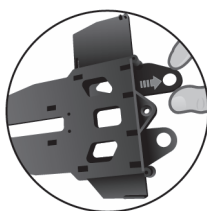

Right hand slider adjuster

LHS (Left hand slider adjuster) is recommended to be engaged when spreading large sized granular materials to provide a more uniform distribution on the left and right side of the spread pattern. Conversely with very light materials (e.g. grass seed) engaging the RHS (Right hand slider adjuster) will be similarly beneficial.

The manufacturer cannot be held responsible for any variations in sq. metre application volumes, or spread width differences, due to possible variations in materials, application conditions at the time and different operator application techniques.

Do not spread Fertiliser or seed materials with the winter slider

This chart should be used as a guide only.



2-Year **Limited Warranty**

DMMP Ltd. warrants this product free of defects in original workmanship and materials for a period of 1-2 Years to the end user with the original dated purchase receipt.

If a manufacturing non-conformance is found, DMMP Ltd. will repair or replace the part(s) or product at its discretion at no charge provided the failure is not the result of incorrect installation, mishandling, misuse, tampering, or normal wear and tear as determined by DMMP Ltd.

DMMP Ltd. at its discretion may require that the part(s) or product be returned along with the original purchase receipt at owners' expense for examination and compliance with the terms of this warranty.

Do not return any product without first receiving authorization from DMMP Ltd. To seek remedy under this warranty, contact DMMP Ltd. at +44 (0)1455 825 400 or email us at info@dmmp.co.uk and describe the nature of the manufacturing defect.

SPECIFIC LIMITATIONS:

This warranty covers only the part(s) or product; any labour charges associated with repair or replacement of nonconformances are specifically excluded.

Due to the corrosive nature of most fertilizers and ice melt products, DMMP Ltd makes no warranty against and specifically excludes part(s) or product degradation or failure due to corrosion or its effects.

To negate the effects of corrosive materials on your product, clean and dry your spreader or seeder thoroughly after each use. As a further preventative measure, coat all metal parts with a light oil or silicon spray.

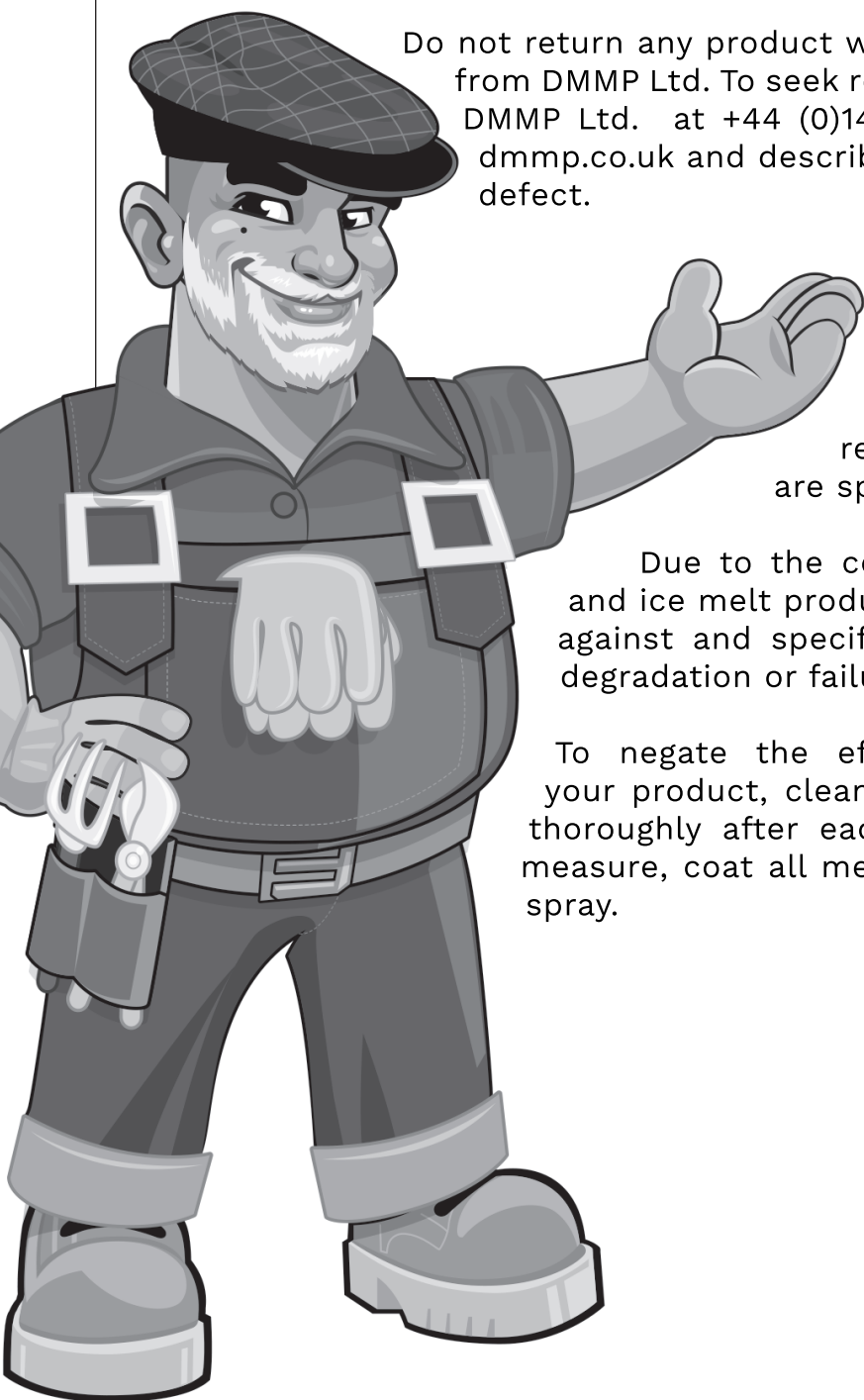

Other Cresco Products

Product / Season		Unique Selling Points		
<div></div> <div>Cresco 1 Code: CR001</div> <div></div>	Ergonomic arm-rest handle for easy holding		Large 2Kg Hopper	
<div></div> <div>Cresco 5 Code: CR005</div> <div></div>	New heavy duty gearbox		Easy to use on/off system	
<div></div> <div>Cresco 8SW Code: CR008SW</div> <div></div>	Thick coating on cable linkage to prevent degradation		Retracatable back stand and folding handlebar for easy storage	
<div></div> <div>Cresco 10SW Code: CR10SW</div> <div></div>	Cushioned on/off lever with solid rod linkage		Large moulded wheels	
<div></div> <div>Cresco 20SW Code: CR20SW</div> <div></div>	Cushioned on/off lever with solid rod linkage		Pneumatic Wheels	
<div></div> <div>Cresco SRS Code: CRSRS</div> <div></div>	Seed Plate Bag Included with 11 Seed Plates		Strong row marker mounting	
<div></div> <div>Heavy Duty Snow Shovel Code: H464P</div> <div></div>	Powder coated steel tubed handle		Large comfortable ergonomic grip	
<div></div> <div>Wide Snow Clearer Code: H611</div> <div></div>	Steel blade		Steel edge to increase cutting power and longevity	
<div></div> <div>3 in 1 Foldable Snow Shovel Code: HZS212</div> <div></div>	Anodised aluminium head		Teloscopic anodised aluminium handle	
<div></div> <div>Cresco Snow Blaster Code: H595</div> <div></div>	Two grip design makes snow removal easy and minimises lifting and stooping		Wave ribbed design reinforces blade strength	
<div></div> <div>Polar Tough Snow Plough Code: YH74900</div> <div></div>	Helps manage snow accumulation		Reduces labour costs compared to a shovel	