



# MWLG 150-12EV

## 12V 150Ah

### Compliance with standards

PN-EN 60896-21:2007  
 PN-EN 60896-22:2007  
 PN-EN 61056-1:2008  
 PN-EN 61056-2:2003(U)  
 PN-E-83016:1999

The maintenance-free **MW Power MWLG** series gel batteries are made in **VRLA-GEL** technology (**gel electrolyte with PVC-SiO<sub>2</sub> separator with internal gas recombination**). They are mainly designed for cyclic operation and where deep discharges occur, e.g. PV installations, electric vehicles, cleaning machines, golf carts and wheelchairs, power supply for electric boats and campers. They can also be used in emergency power supply systems such as UPS, emergency lighting, automation systems. For depth of discharge up to 50% up to 1000 cycles. Design life of up to **12-15 years** for 20-25°C



### Specification

|   |              |          |
|---|--------------|----------|
| Nominal voltage   |              | 12V      |
| Nominal capacity  |              | 150,0 Ah |
| Dimensions<br><br>ABS housing/(UL94-HB)<br>optional UL94-V0 | Length       | 485 mm   |
|   | Width        | 172 mm   |
|   | Height       | 240 mm   |
|   | Total height | 240 mm   |
| Weight  |              | 46,5 kg  |

### Characteristics

|   |                 |              |
|---|-----------------|--------------|
| Capacity for 25°C and cut-off voltage 10,5V | 20h             | 150,0 Ah     |
|   | 10h             | 139,0 Ah     |
|   | 1h              | 82,1 Ah      |
| Internal resistance                         | battery charged | 4 mΩ         |
| Capacity                                    | for +20°C       | 100%         |
|   | for +0°C        | 85%          |
|   | for -15°C       | 65%          |
| Self-discharge                              | 3 months        | 91%          |
|   | 6 months        | 82%          |
|   | 12 months       | 64%          |
| Terminal                                    | Screw M8        |              |
| Charging                                    | Buffer          | 13,50-13,80V |
|   | Cyclical        | 14,20-14,50V |
| Max. charging current                       | 30,0 A          |              |
| Max. discharge current                      | 900 A (5 sec.)  |              |

Working temperatures:  
 Discharge: -20°C ÷ 50°C  
 Charging: -20°C ÷ 50°C  
 Storage: -20°C ÷ 50°C

### Dimensions

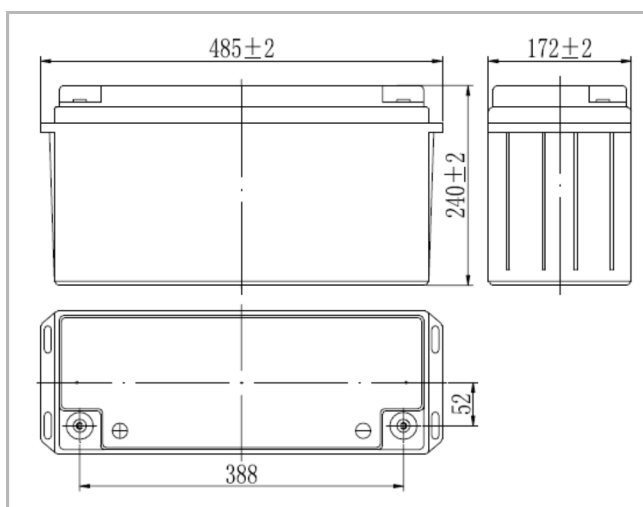

### Discharge characteristics at temp. 25 °C

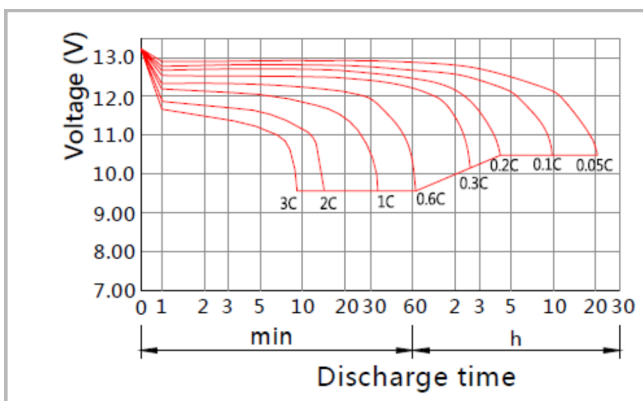

### Terminal

