

STELLA COFFEE TABLE

ASSEMBLY INSTRUCTIONS

Dear Customer,

- This product you have purchased has been subjected to all tests and controls and packed by us before it reaches you.
However, it is possible for some parts to be damaged during transportation. If you encounter such a situation, do not return the entire product and only ask for the damaged part.
You can find the code for the required part on the second page of this manual.
The missing part will be sent to you as soon as possible.
- Before starting the assembly; Check that all parts and accessories in the boxes are intact and complete according to the list.
After cleaning each part with a damp cloth, you can start the assembly.
- If you have purchased more than one product, do not switch to the other product without completing the assembly of a single product, in order to avoid any confusion.
- Never carry products by dragging them. Carry the product with at least two people by lifting and disassembling it when necessary. For long-distance transportation, you should definitely carry the product with its package.
- Surface cleaning of the furniture is very easy. It is enough to wipe it with a damp and soapy cloth or other household cleaning products that are non-abrasive and non-acidic.
- Since furniture is affected by extreme heat, cold and humidity, do not directly expose your furniture to these factors.
- Do not use your furniture for other than its intended purpose.

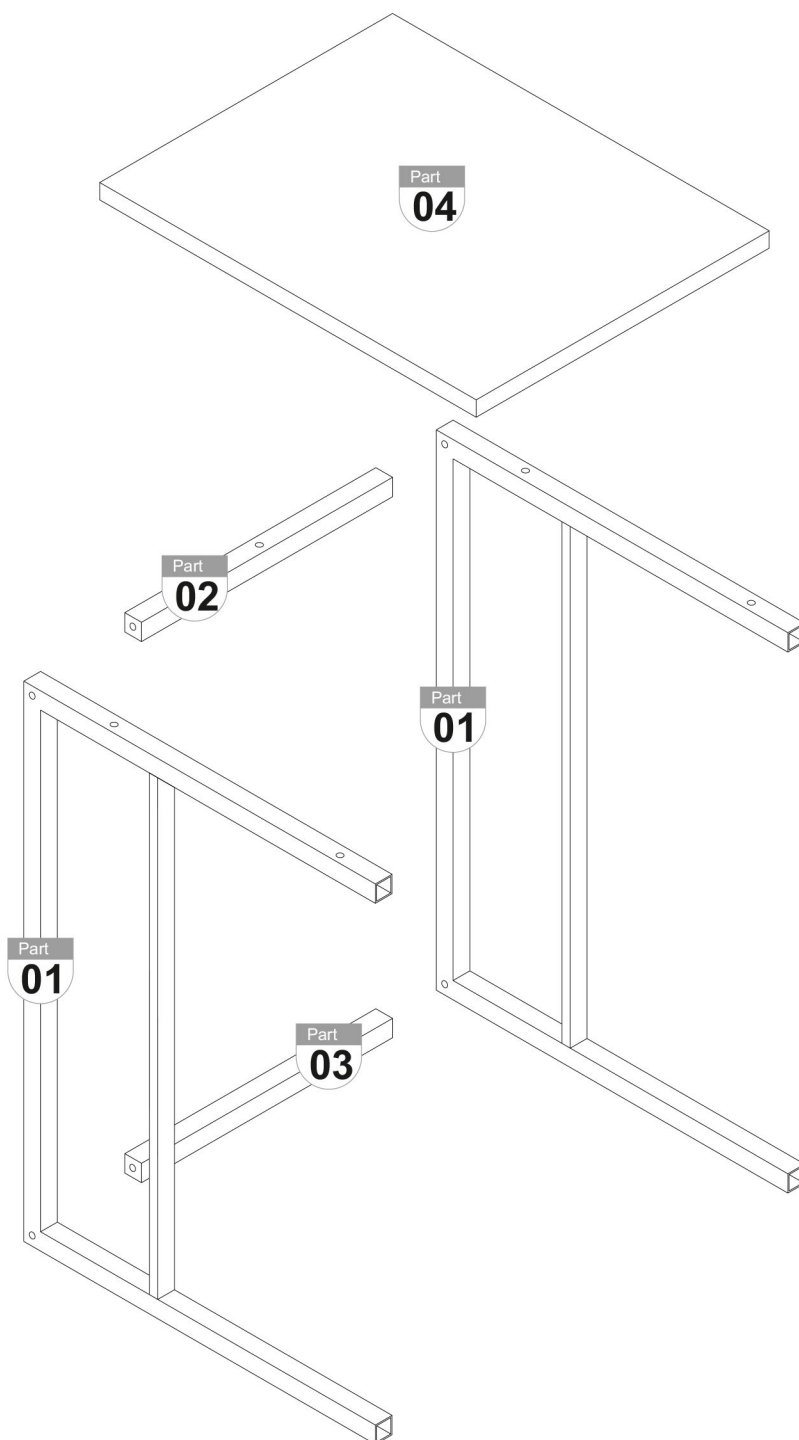

TOOLS REQUIRED

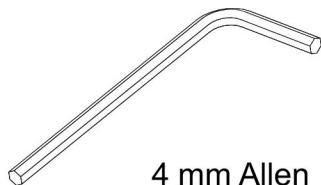

4 mm Allen
Key



Screwdriver

ACCESSORIES LIST

M6 x 50 mm
Hex Socket Head
Screw

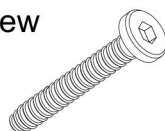

A16

4x

4 x 35 mm
Screw



A03

5x

Rectangle
End Cap
(30x20)

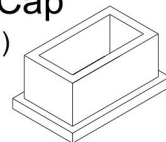

A15

6x

1

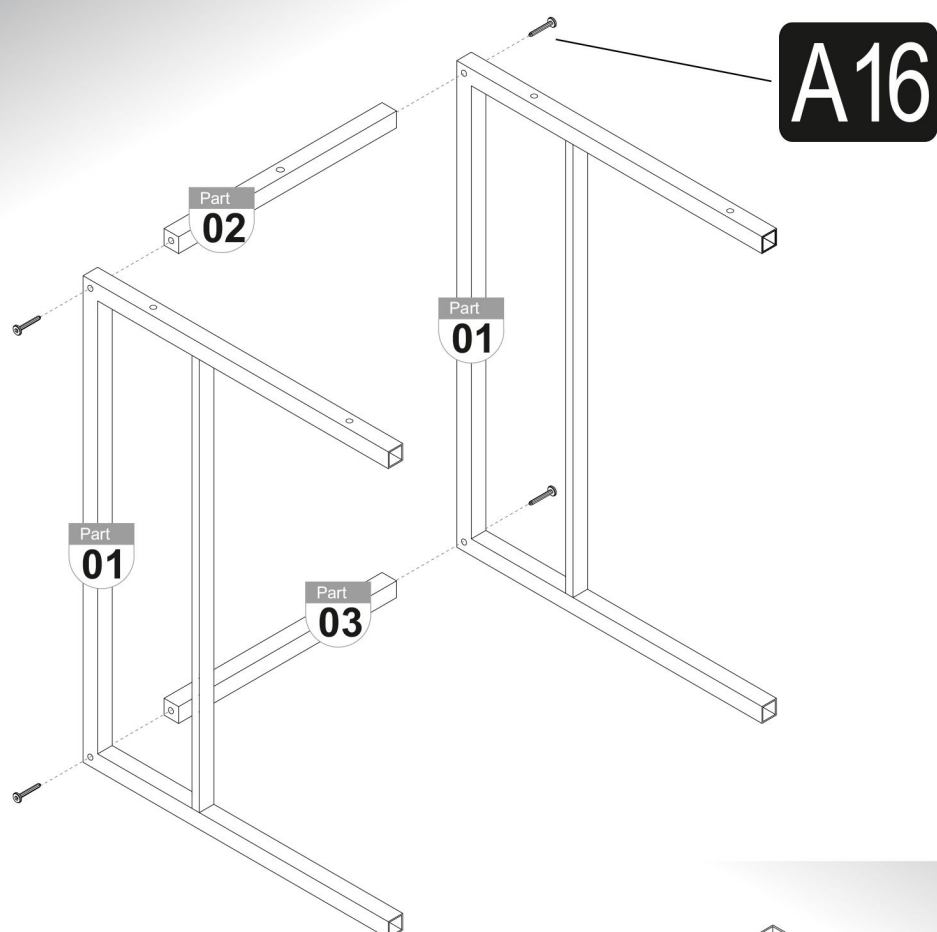

2

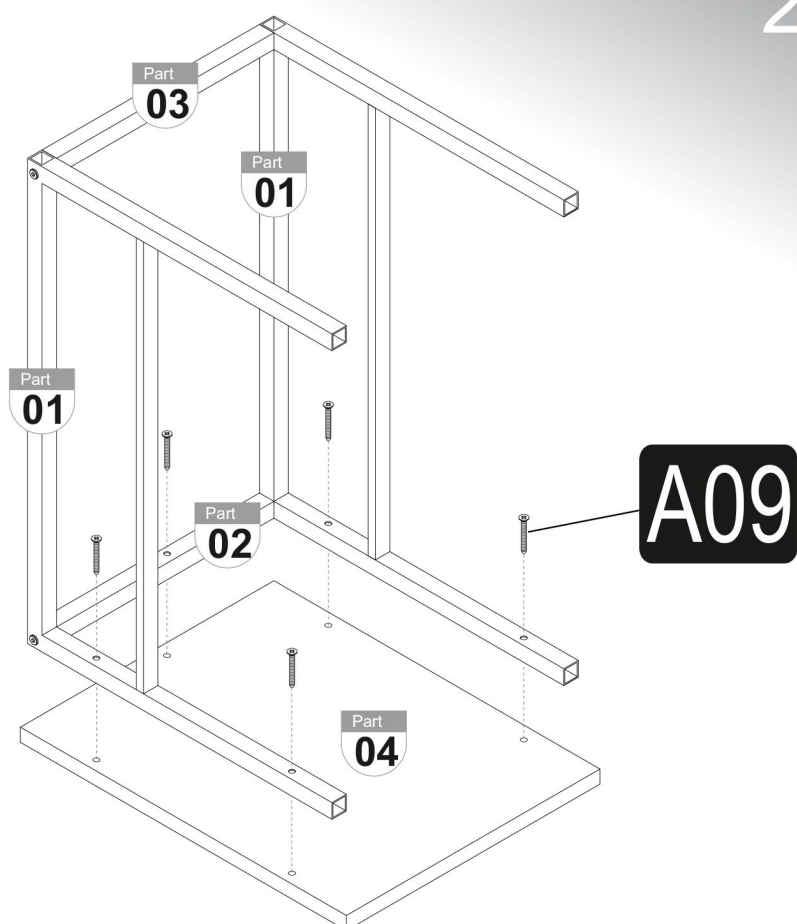

3

3

